

F.A.P. RTE.	SECTION	COUNTY	TOTAL SHEETS	SHEET NO.
317		LIVINGSTON	205	190
STA. 345+50.00		TO STA. 346+17.70		
CONTRACT NO. 66261				
• 25 RS-2 & 26 RS-4				

FINAL SURVEY	DATE
NO. 10	
BY	
APPROVED	
DATE	
NO.	

ORIGINAL SURVEY	DATE
NO. 10	
BY	
APPROVED	
DATE	
NO.	

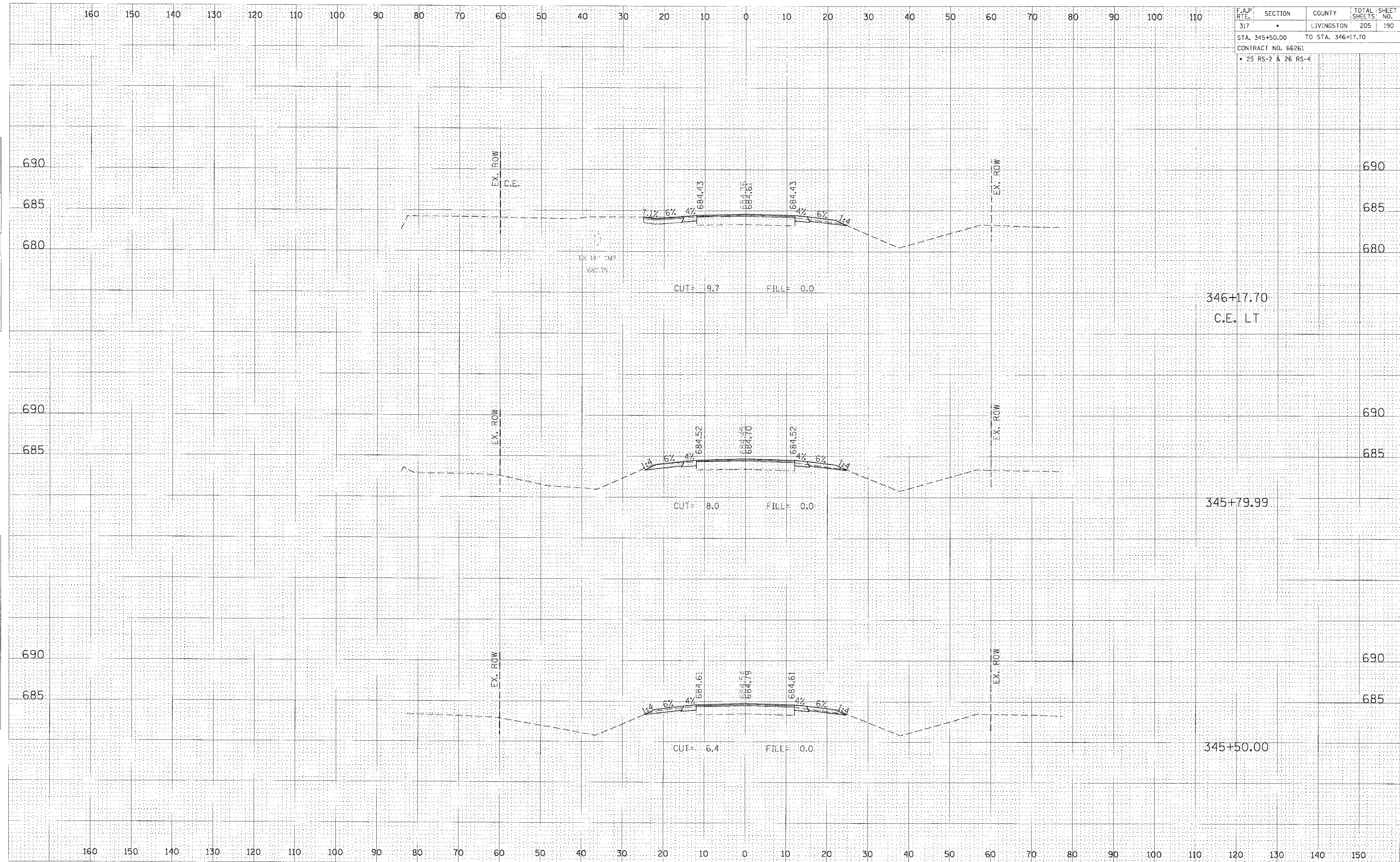

346+17.70
C.E. LT

345+79.99

345+50.00

CROSS SECTION, STA 345+50.00 TO 346+17.70, FAP 317 (US ROUTE 24)