

F.A.P. RTE.	SECTION	COUNTY	TOTAL SHEETS	SHEET NO.
317	*	LIVINGSTON	205	192
STA. 347+75.99		TO STA. 347+97.74		
CONTRACT NO. 66261				
• 25 RS-2 & 26 RS-4				

FINAL SURVEY	SURVEYED	DATE
NO. 1	NO. 1	
NO.	AREAS CHECKED	

ORIGINAL SURVEY	SURVEYED	DATE
NO. 1	NO. 1	
NO.	AREAS CHECKED	

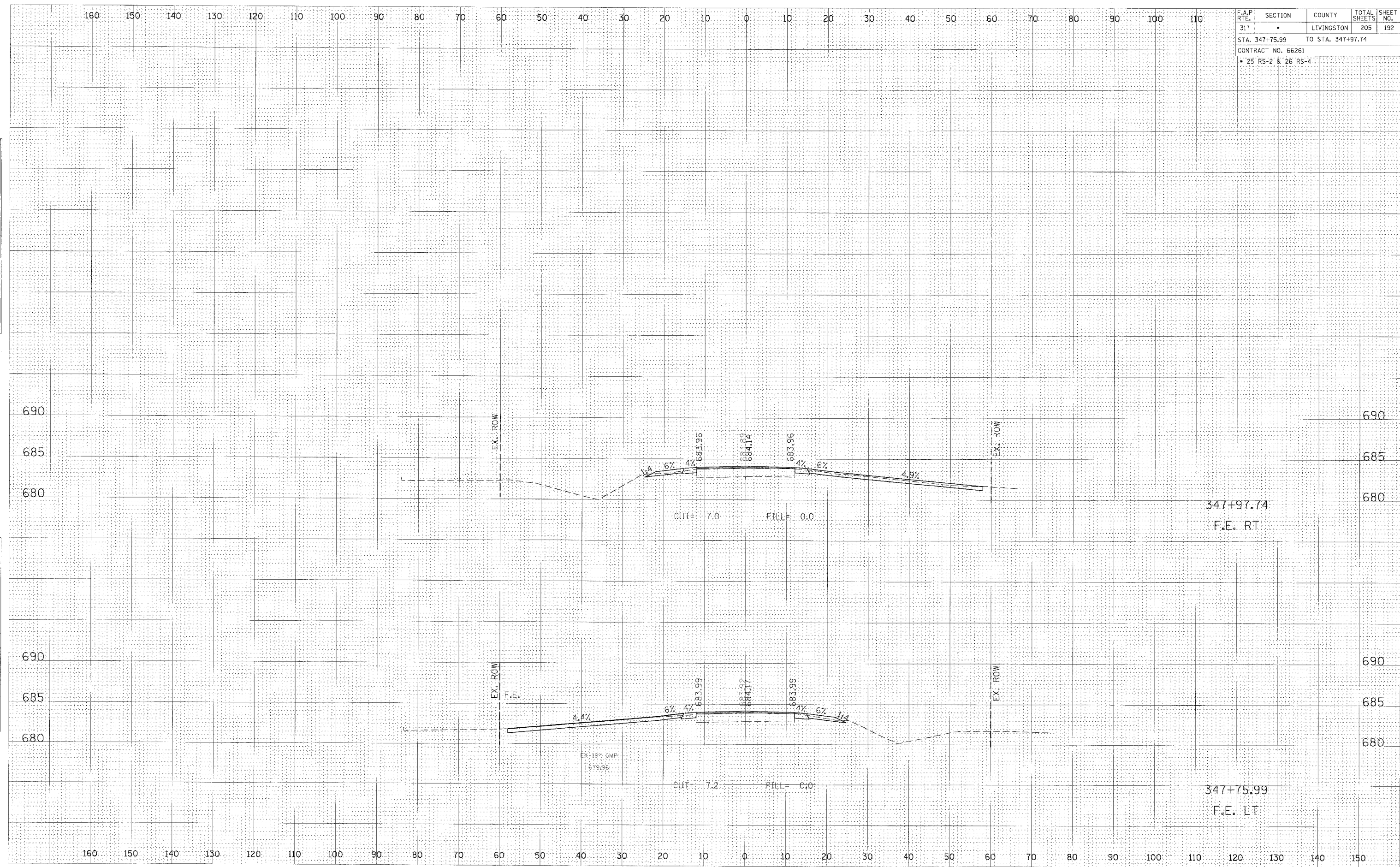

CROSS SECTION, STA 347+75.99 TO 347+97.74, FAP 317 (US ROUTE 24)