

F.A.P. RTE.	SECTION	COUNTY	TOTAL SHEETS	SHEET NO.
317		LIVINGSTON	205	197
STA. 351+50.00		TO STA. 352+00.00		
CONTRACT NO. 66261				
• 25 RS-2 & 26 RS-4				

FINAL	DATE
SURVEY	
PLOTTED	
NOTE BOOK	
AREAS CHECKED	

ORIGINAL	DATE
SURVEY	
PLOTTED	
NOTE BOOK	
AREAS CHECKED	

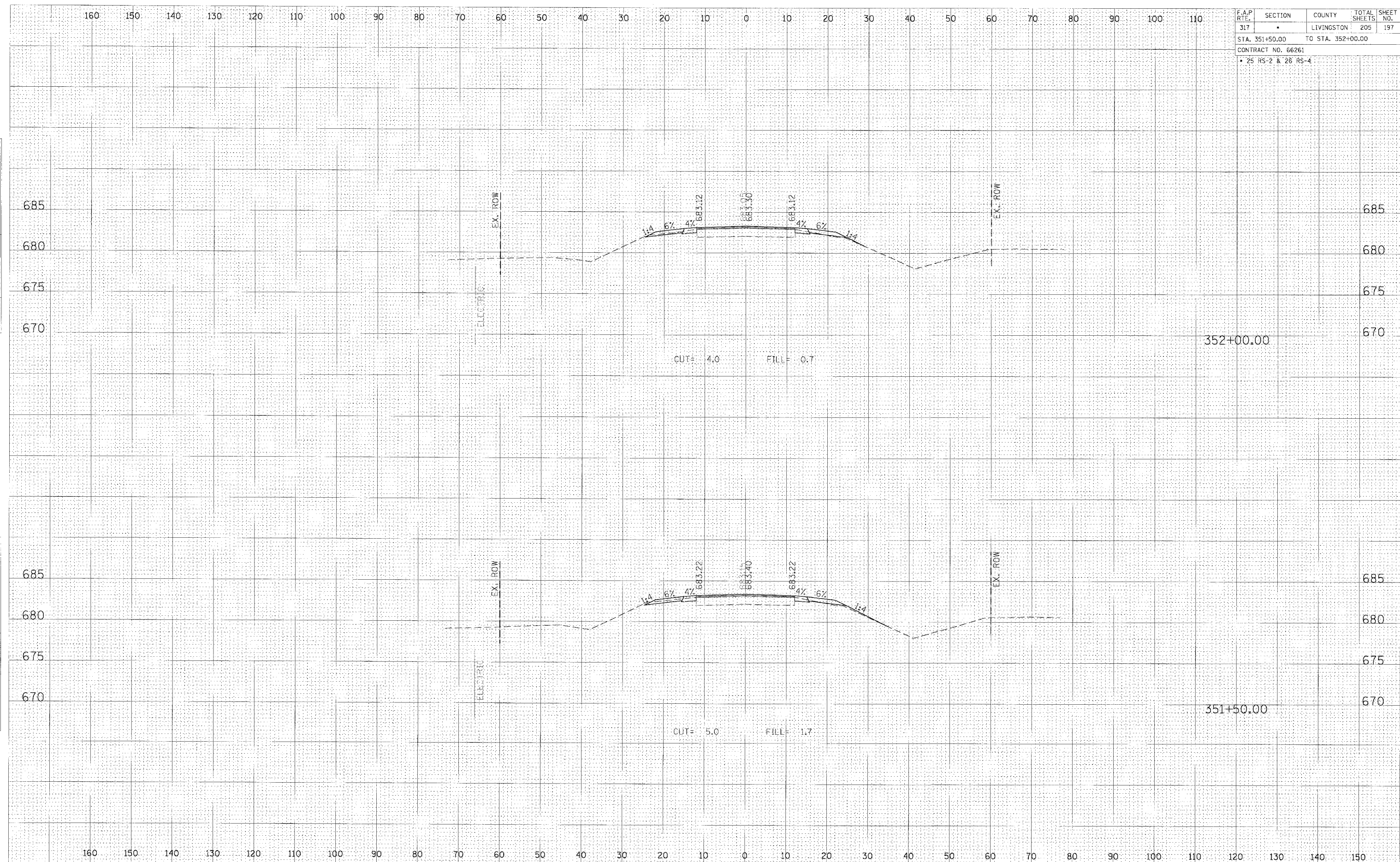

CROSS SECTION, STA 351+50.00 TO 352+00.00, FAP 317 (US ROUTE 24)