

F.A.P. RTE.	SECTION	COUNTY	TOTAL SHEETS	SHEET NO.
317	•	LIVINGSTON	205	203
STA. 357+23.99 TO STA. 357+59.91				
CONTRACT NO. 66261				
• 25 RS-2 & 26 RS-4				

BY _____ DATE _____
 SURVEYED _____
 CHECKED _____
 FINAL SURVEY _____
 NOTE BOOK _____
 NO. _____

BY _____ DATE _____
 SURVEYED _____
 CHECKED _____
 ORIGINAL SURVEY _____
 NOTE BOOK _____
 NO. _____

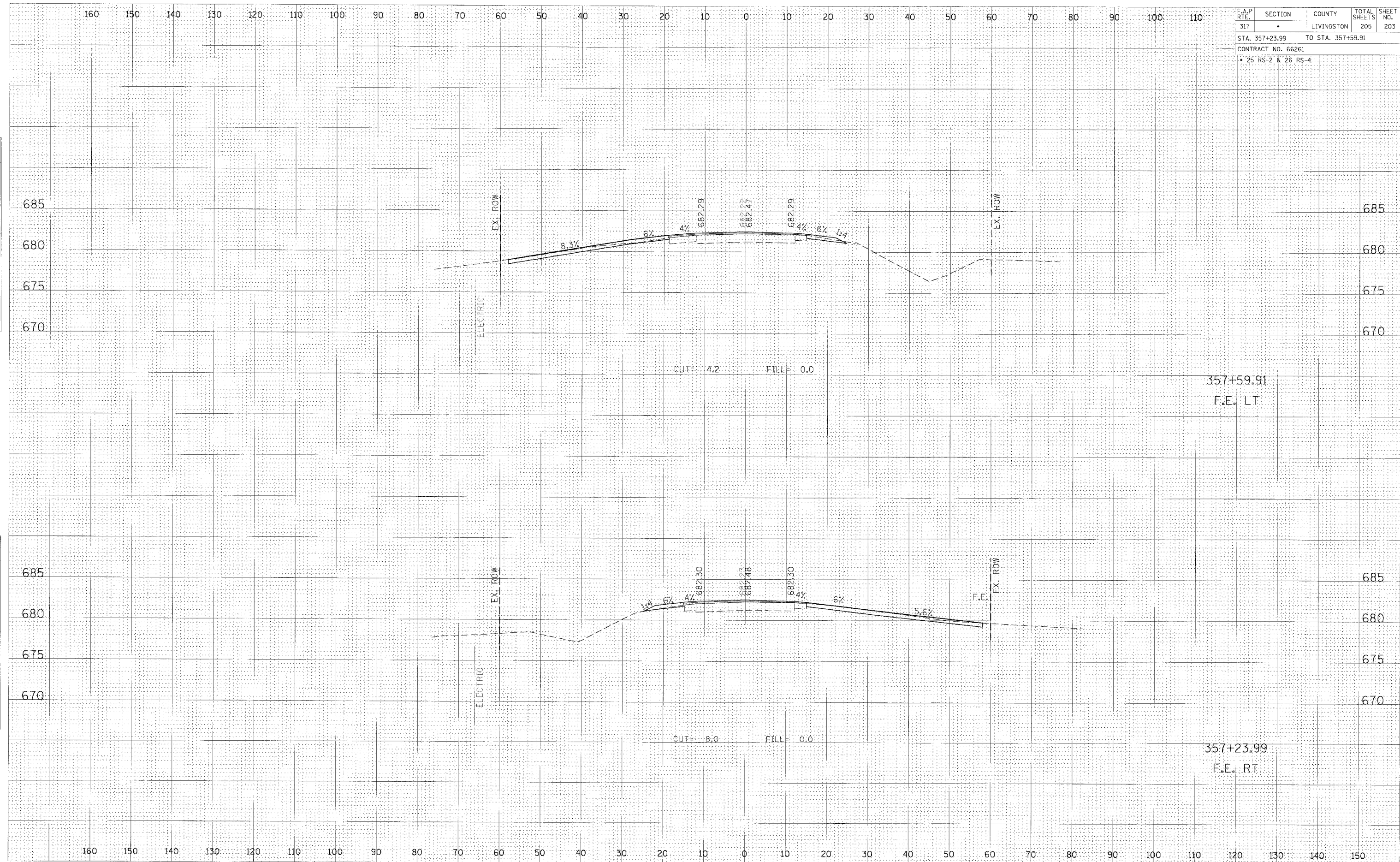

CROSS SECTION, STA 357+23.99 TO 357+59.91, FAP 317 (US ROUTE 24)