

F.A.S. RTE.	SECTION	COUNTY	TOTAL SHEETS	SHEET NO.
1517	IN	MCLEAN	20	7
STA. 377+00		TO STA. 382+00		
FED. ROAD DIST. NO.	ILLINOIS	FED. AID PROJECT		

PLAN	DATE
BY	
REVIEWED	
PLOTTED	
CHECKED	
NO. _____	

PROFILE	DATE
BY	
REVIEWED	
PLOTTED	
CHECKED	
NO. _____	

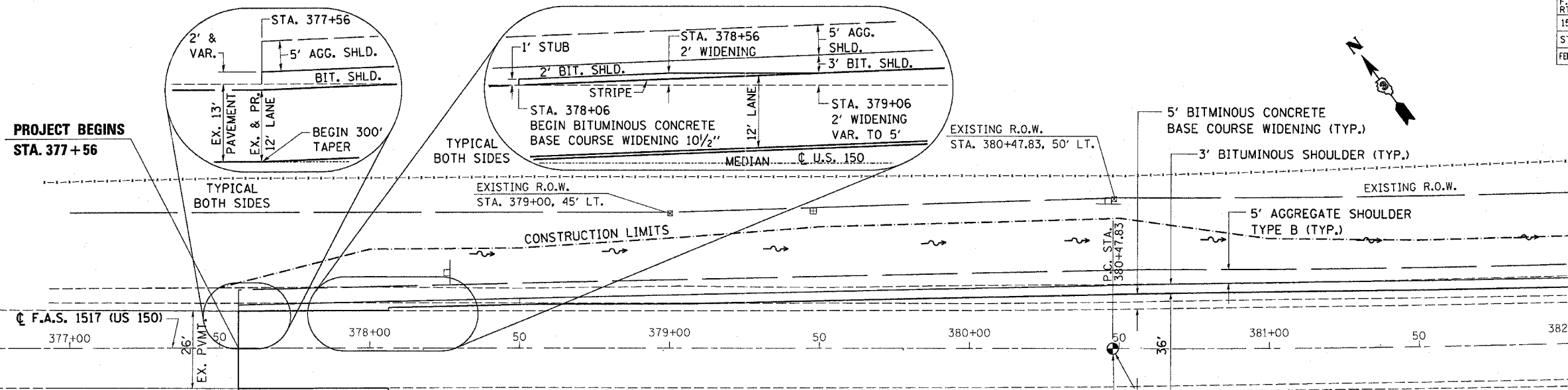

CENTERLINE TIE

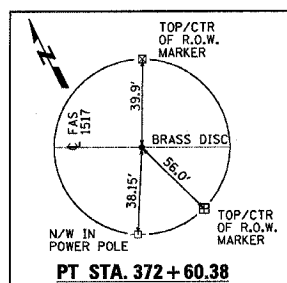

INSTALL FLASHING BEACON ON EXISTING "INTERSECTION AHEAD" SIGN APPROXIMATE STA. 375+75 SEE FLASHING BEACON INSTALLATION PLANS

CENTERLINE TIE

