

F.A.S. RTE.	SECTION	COUNTY	TOTAL SHEETS	SHEET NO.
1517	1N	MCLEAN	20	10
STA. 5+00		TO STA. 9+30		
FED. ROAD DIST. NO.		ILLINOIS		FED. AID PROJECT

TEMPORARY EASEMENT OBTAINED FOR GRADING PURPOSES. WORK INCLUDES REMOVING AND RESETTING A GATE AND TWO PANELS OF WOVEN WIRE FENCE WITH 4 WOOD POSTS, & GRADING AS SHOWN HERE AND IN THE CROSS SECTIONS. THIS WORK WILL NOT BE PAID FOR SEPARATELY BUT WILL BE INCLUDED IN THE CONTRACT UNIT PRICE PER CUBIC YARD FOR EARTH EXCAVATION.

STA. 11+95, 19' LT.
30" PIPE CULVERTS, TYPE 1, CORRUGATED STEEL OR ALUMINUM CULVERT PIPE 12" 2 EACH STEEL END SECTIONS
USFL = 828.1
DSFL = 826.8

PLAN	DATE
DESIGNED	
PLOTTED	
CHECKED	
DATE	

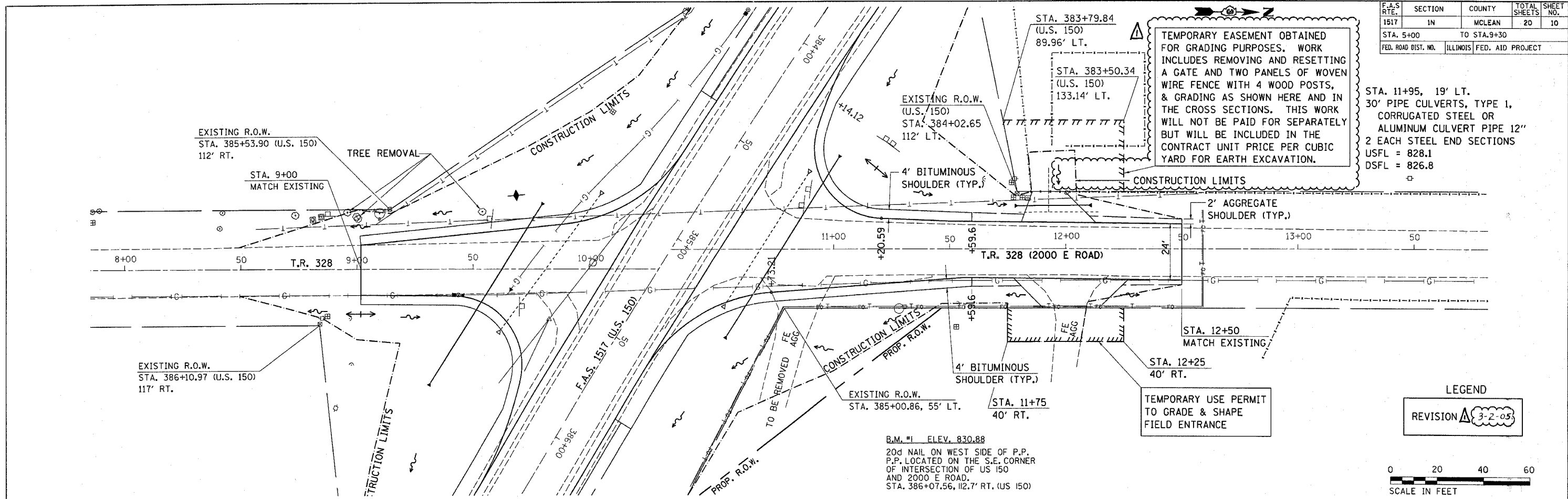

PROFILE	DATE
DESIGNED	
PLOTTED	
CHECKED	
DATE	

