

F.A.S. RTE.	SECTION	COUNTY	TOTAL SHEETS	SHEET NO.
1517	1N	McLEAN	21	1

STATE OF ILLINOIS
DEPARTMENT OF TRANSPORTATION
DIVISION OF HIGHWAYS
**PROPOSED
HIGHWAY PLANS**

F.A.S. ROUTE 1517 (U.S. 150)
SECTION 1N
PROJECT HS-1517(109)
McLEAN COUNTY

INTERSECTION WITH TR 328 (2000 E. RD.), 0.57 MILE NW OF CH 27 AT DOWNS.
INSTALLATION OF LEFT TURN LANES ON U.S. 150 AT TR 328

C-93-007-05

INDEX OF SHEETS

- 1 COVER SHEET
- 2 GENERAL NOTES
- 3 SUMMARY OF QUANTITIES
- 4-5 TYPICAL SECTIONS
- 6 SCHEDULES
- 7-10 PLAN AND PROFILE SHEETS
- 11 PAVEMENT MARKING PLAN SHEET
- 12 FLASHING BEACON INSTALLATIONS PLANS
- 13-14 DETAILS
- 15-21 CROSS SECTIONS

STANDARDS

- BLR-21-6 TYPICAL APPLICATIONS OF TRAFFIC CONTROL DEVICES FOR CONSTRUCTION
- 000001-04 STANDARD SYMBOLS, ABBREVIATIONS AND PATTERNS
- 280001-02 TEMPORARY EROSION CONTROL SYSTEMS
- 482001 BITUMINOUS SHOULDER ADJACENT TO FLEXIBLE PAVEMENT
- 482011-01 BIT. SHOULDER STRIPS/SHOULDERS WITH RS OR WIDENING & RS PROJECTS
- 542401 METAL END SECTION FOR PIPE CULVERTS
- 667101 PERMANENT SURVEY MARKERS
- 701001-01 OFF-ROAD OPERATIONS 2L, 2W, MORE THAN 4.5 m (15') AWAY
- 701006-02 OFF-ROAD OPERATIONS 2L, 2W, 4.5 m (15') TO 600 mm (24") FROM PAVEMENT EDGE
- 701301-02 LANE CLOSURE, 2L, 2W, SHORT TIME OPERATIONS
- 701306-01 LANE CLOSURE, 2L, 2W, SLOW MOVING OPERATIONS DAY ONLY, FOR SPEEDS ≥ 45 MPH
- 701326-02 LANE CLOSURE, 2L, 2W, PAVEMENT WIDENING, FOR SPEEDS ≥ 45 MPH
- 701331-02 LANE CLOSURE, 2L, 2W, WITH RUN-AROUND, FOR SPEEDS ≥ 45 MPH
- 701336-04 LANE CLOSURE, 2L, 2W, WORK AREAS IN SERIES, FOR SPEEDS ≥ 45 MPH
- 702001-05 TRAFFIC CONTROL DEVICES
- 781001-02 TYPICAL APPLICATIONS RAISED REFLECTIVE PAVEMENT MARKERS
- 805001 ELECTRICAL SERVICE INSTALLATION DETAILS
- 880001 SPAN WIRE MOUNTED SIGNALS AND FLASHING BEACON INSTALLATION

DISTRICT 3 NO. (815) 434-6131

PROJECT ENGINEER: DAVE BROVIAK
UNIT CHIEF: MARK JONES
TOWNSHIP: TOWN, DOWNS

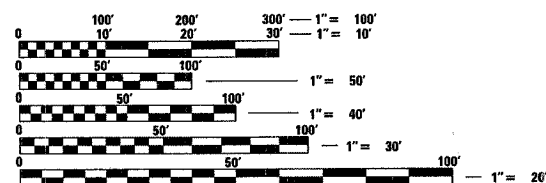

FULL SIZE PLANS HAVE BEEN PREPARED USING STANDARD ENGINEERING SCALES. REDUCED SIZED PLANS WILL NOT CONFORM TO STANDARD SCALES. IN MAKING MEASUREMENTS ON REDUCED PLANS, THE ABOVE SCALES MAY BE USED.

J.U.L.I.E.
JOINT UTILITY LOCATION INFORMATION FOR EXCAVATION
1-800-892-0123

CONTRACT NO. 66533



2004 ADT
U.S. 150 = 8050
P.V. = 92% S.U. = 4% M.U. = 4%
T.R. 328 /2000 E. ROAD = 775

STATE OF ILLINOIS
DEPARTMENT OF TRANSPORTATION
DIVISION OF HIGHWAYS

SUBMITTED December 4, 2004

John P. Kue DISTRICT ENGINEER

February 4, 2005
Mike Hine ENGINEER OF DESIGN AND ENVIRONMENT

February 4, 2005
Victor Maden DIRECTOR, DIVISION OF HIGHWAYS

**PRINTED BY THE AUTHORITY
OF THE STATE OF ILLINOIS**

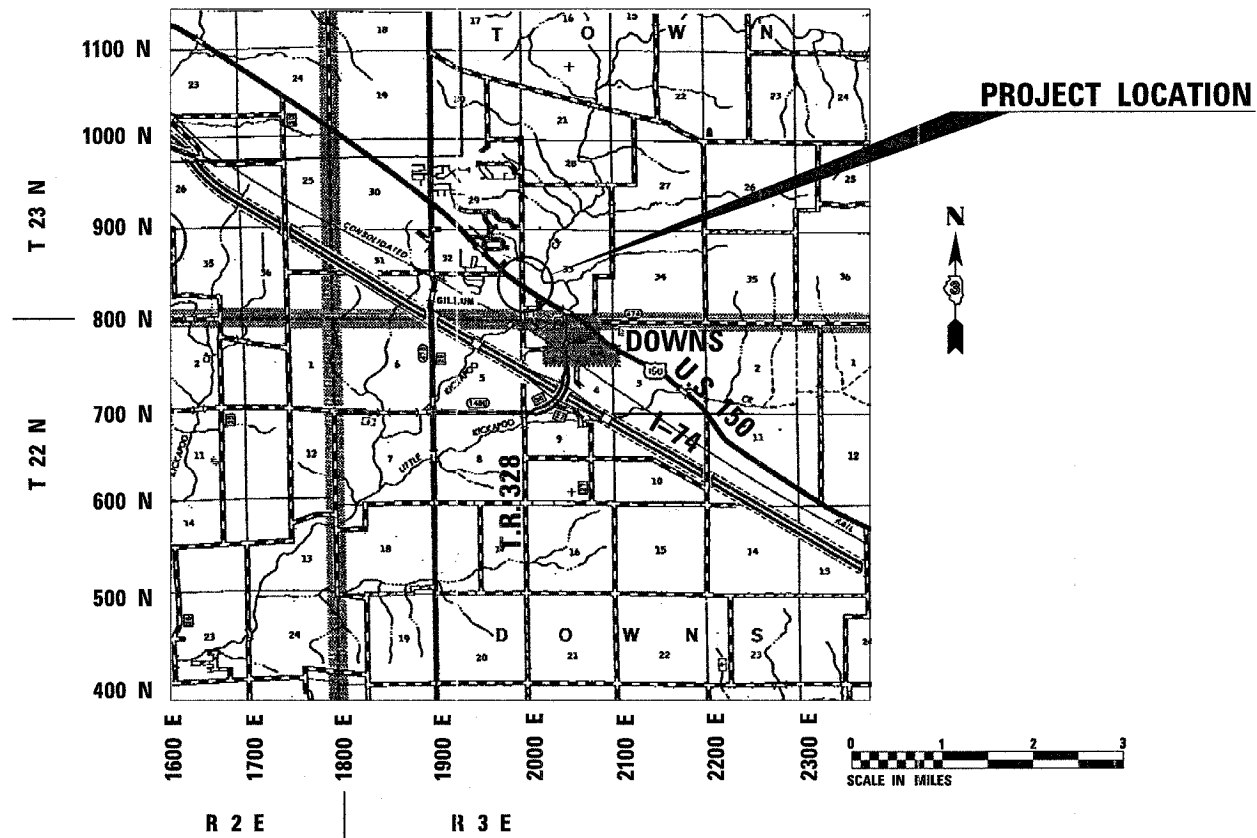

GROSS & NET LENGTH OF PROJECT = 1405 FEET = 0.27 MILE

F.A.S. RTE.	SECTION	COUNTY	TOTAL SHEETS	SHEET NO.
1517	IN	McLEAN	21	2
STA.		TO STA.		
FED. ROAD DIST. NO.		ILLINOIS FED. AID PROJECT		

GENERAL NOTES

(Revised January 1, 2002)

THE THICKNESS OF BITUMINOUS MIXTURES SHOWN ON THE PLANS IS THE NOMINAL THICKNESS. DEVIATIONS FROM THE NOMINAL THICKNESS WILL BE PERMITTED WHEN SUCH DEVIATIONS OCCUR DUE TO IRREGULARITIES IN THE EXISTING SURFACE OR BASE ON WHICH THE BITUMINOUS MIXTURE IS PLACED.

THE BITUMINOUS SURFACE OF ALL MAILBOX TURNOUTS, PRIVATE ENTRANCES, COMMERCIAL ENTRANCES, AND SIDE ROADS SHALL BE MADE NEATLY, IN A WORKMANLIKE MANNER, AND SHALL ACCURATELY CONFORM TO THE SHAPES AND DIMENSIONS SHOWN ON THE PLAN DETAILS. IF REQUIRED BY THE ENGINEER, THE CONTRACTOR SHALL BE REQUIRED TO SAW CUT THE BITUMINOUS SURFACE TO CONFORM TO THE SHAPES AND DIMENSIONS SHOWN ON THE PLAN DETAILS. THIS WORK SHALL BE INCLUDED IN THE COST OF THE BITUMINOUS SURFACE

THE BASE COURSE WIDENING SHALL BE CARRIED THROUGH ALL ENTRANCES, SIDE ROADS, AND MAILBOX TURNOUTS. EXCEPTIONS WILL BE SHOWN ON THE PLANS.

BEFORE ORDERING PIPE CULVERTS OR PIPE DRAINS, THE CONTRACTOR SHALL CONSULT THE ENGINEER FOR EXACT LENGTHS.

AGGREGATE (PRIME COAT): FA 20 MAY BE USED IN ADDITION TO THE GRADATIONS LISTED IN THE 3RD PARAGRAPH OF ARTICLE 1003.03(G) OF THE STANDARD SPECIFICATIONS.

THE ENGINEER WILL BE THE SOLE JUDGE CONCERNING CURING TIME FOR THE VARIOUS BITUMINOUS LIFTS.

FOR STABILIZATION, ALL TYPE III BARRICADES SHALL REQUIRE A MINIMUM OF FOUR SAND BAGS PER BARRICADE.

WHERE SECTION OR SUBSECTION MONUMENTS ARE ENCOUNTERED, THE ENGINEER SHALL BE NOTIFIED BEFORE SUCH MONUMENTS ARE REMOVED. THE CONTRACTOR SHALL PROTECT AND CAREFULLY PRESERVE ALL MONUMENTS UNTIL AN AUTHORIZED SURVEYOR OR AGENT HAS WITNESSED OR OTHERWISE REFERENCED THEIR LOCATION. THE CONTRACTOR SHALL BE RESPONSIBLE FOR HAVING AN AUTHORIZED SURVEYOR REESTABLISH ANY SECTION OR SUBSECTION MONUMENTS DESTROYED BY HIS OPERATIONS.

SEEDING SHALL NOT BE PERMITTED AT ANY TIME WHEN THE GROUND IS FROZEN, WET, OR IN AN UNTILLABLE CONDITION. LOCATIONS TO BE SEEDED WILL BE DETERMINED BY THE ENGINEER.

ONLY THOSE TREES DESIGNATED BY THE ENGINEER OR LISTED IN THE TREE REMOVAL SCHEDULE SHALL BE REMOVED. THE CONTRACTOR SHALL PROTECT ALL REMAINING TREES FROM DAMAGE DUE TO HIS OPERATIONS.

THE FINISHED EARTHWORK SHALL HAVE A VEGETATION SUSTAINING SOIL COVERING THE TOP FOUR INCHES IN AREAS TO BE SEEDED OR SODDED. THE VEGETATION SUSTAINING SOIL REQUIRED WILL NOT BE PAID FOR SEPARATELY BUT SHALL BE INCLUDED IN THE COST OF EARTH EXCAVATION.

ON EXISTING PAVEMENT WHICH MAY BE SUPERELEVATED, THE NEW BITUMINOUS PAVEMENT SHALL BE BUILT WITH THE SAME SUPERELEVATION UNLESS NEW SUPERELEVATION RATES ARE GIVEN ON THE PLANS.

ABANDONED UNDERGROUND UTILITIES THAT CONFLICT WITH CONSTRUCTION SHALL BE DISPOSED OF OUTSIDE THE LIMITS OF THE RIGHT OF WAY ACCORDING TO ARTICLE 202.03 OF THE STANDARD SPECIFICATIONS AND AS DIRECTED BY THE ENGINEER. THIS WORK WILL NOT BE PAID FOR SEPARATELY BUT SHALL BE INCLUDED IN THE COST OF EARTH EXCAVATION.

ANY REFERENCE TO A STANDARD IN THESE PLANS SHALL BE INTERPRETED TO MEAN THE EDITION AS INDICATED BY THE SUBNUMBER LISTED ON THE INDEX OF SHEETS OR THE COPY OF THE STANDARD INCLUDED IN THESE PLANS.

THE FOLLOWING RATES OF APPLICATION HAVE BEEN USED IN CALCULATING PLAN QUANTITIES:

GRANULAR MATERIALS	2.05	TONS / CU YD
BITUMINOUS MAT PRIME COAT	0.08	GAL / SQ YD OR
	0.375	GAL / SQ YD
AGGREGATE PRIME COAT	0.002	TONS / SQ YD
BITUMINOUS RESURFACING	112	LBS / SQ YD / IN
SHORT TERM PAVEMENT MARKING	10	FT / 100 FT OF APPLICATION
MIX FOR CRACKS, JTS & FLGWYS	0.0003	TONS / SQ YD
LEVEL BINDER (HAND METHOD)	0.0005	TONS / SQ YD
SUPPLEMENTAL WATERING	3	GAL / SQ YD / APPLICATION
CALCIUM CHLORIDE	2	LB / SQ YD / APPLICATION
TEMPORARY DITCH CHECKS	9	BALES OR
	5	TONS AGGREGATE

MEMBERS OF JULIE KNOWN TO BE WITHIN THE LIMITS OF THE IMPROVEMENT ARE:

- MEDIAJACOM
- NICOR GAS
- VERIZON
- ILLINOIS POWER

WHENEVER BITUMINOUS SHOULDERS ARE CONSTRUCTED ADJACENT TO A PAVEMENT CONSTRUCTED ON GRANULAR SUBBASE AND ADDITIONAL MATERIAL IS NEEDED TO EXTEND THE IMPROVED SUBGRADE TO THE BOTTOM OF THE BITUMINOUS SHOULDER, THE ADDITIONAL MATERIAL SHALL BE SUBBASE GRANULAR MATERIAL, TYPE C, CONFORMING TO SECTION 311. THE WORK OF CONSTRUCTING THIS ADDITIONAL THICKNESS OF MATERIAL WILL NOT BE PAID FOR SEPARATELY, BUT SHALL BE CONSIDERED AS INCLUDED IN THE CONTRACT UNIT PRICE BID FOR THE ITEM OF THE GRANULAR SUBBASE.

STATE OF ILLINOIS
DEPARTMENT OF TRANSPORTATION
DISTRICT THREE

PREPARED BY: Thomas Sautter
DISTRICT STUDIES & PLANS ENGINEER

DATE: December 9, 2004

EXAMINED BY: Herb J. Dugan
DISTRICT CONSTRUCTION ENGINEER

Keneth Canyon
DISTRICT MATERIALS ENGINEER

Bruce A. Hucker
DISTRICT OPERATIONS ENGINEER

REVISIONS		ILLINOIS DEPARTMENT OF TRANSPORTATION	
NAME	DATE	<p>GENERAL NOTES</p> <p>SCALE: VERT. _____ HORIZ. _____</p> <p>DATE _____ DRAWN BY _____ CHECKED BY _____</p>	

PLOT DATE = 12/09/2004
 FILE NAME = #FILE#
 PLOT SCALE = #SCALE#
 REFERENCE = #REF#

F.A.S. RTE.	SECTION	COUNTY	TOTAL SHEETS	SHEET NO.
1517	IN	MCLEAN	21	3
STA.		TO STA.		
FED. ROAD DIST. NO.		ILLINOIS FED. AID PROJECT		

SUMMARY OF QUANTITIES

CODE NO.	CONSTRUCTION CODE TYPE: I000-1A	UNIT	TOTAL QUANTITY	90% FED. 10% STATE ROADWAY
				I000-1A
20100110	TREE REMOVAL (6 TO 15 UNITS DIAMETER)	UNIT	18	18
20100210	TREE REMOVAL (OVER 15 UNITS DIAMETER)	UNIT	18	18
20200100	EARTH EXCAVATION	CU YD	2535	2535
20800150	TRENCH BACKFILL	CU YD	55	55
25000200	SEEDING, CLASS 2	ACRE	2.0	2.0
25000400	NITROGEN FERTILIZER NUTRIENT	POUND	180	180
25000500	PHOSPHORUS FERTILIZER NUTRIENT	POUND	180	180
25000600	POTASSIUM FERTILIZER NUTRIENT	POUND	180	180
25100115	MULCH, METHOD 2	ACRE	0.75	0.75
25100401	EXCELSIOR BLANKET, SPECIAL	SO YD	1351	1351
25100630	EROSION CONTROL BLANKET	SO YD	3790	3790
25101005	HEAVY DUTY EXCELSIOR BLANKET	SO YD	1745	1745
28000250	TEMPORARY EROSION CONTROL SEEDING	POUND	400	400
28000300	TEMPORARY DITCH CHECKS	EACH	36	36
28000500	INLET AND PIPE PROTECTION	EACH	4	4
31100300	SUB-BASE GRANULAR MATERIAL, TYPE A 4"	SO YD	2544	2544
40200800	AGGREGATE SURFACE COURSE, TYPE B	TON	74	74
40600100	BITUMINOUS MATERIALS (PRIME COAT)	GALLON	521	521
40600300	AGGREGATE (PRIME COAT)	TON	13	13
40600980	BITUMINOUS SURFACE REMOVAL - BUTT JOINT	SO YD	348	348
44001420	BITUMINOUS SHOULDER REMOVAL	FOOT	2781	2781
44300200	STRIP REFLECTIVE CRACK CONTROL TREATMENT	FOOT	2806	2806
48101200	AGGREGATE SHOULDERS, TYPE B	TON	463	463
48202310	BITUMINOUS SHOULDERS SUPERPAVE 5 1/2"	SO YD	963	963
48202410	BITUMINOUS SHOULDERS SUPERPAVE 6 1/2"	SO YD	217	217
50105200	REMOVE EXISTING CULVERTS	EACH	4	4
54200640	PIPE CULVERTS, TYPE I, CORRUGATED STEEL OR ALUMINUM CULVERT PIPE 15"	FOOT	36	36
54200643	PIPE CULVERTS, TYPE I, CORRUGATED STEEL OR ALUMINUM CULVERT PIPE 18"	FOOT	180	180
54213870	STEEL END SECTION 15"	EACH	2	2
54213873	STEEL END SECTIONS 18"	EACH	4	4
54200637	PIPE CULVERTS, TYPE I, CORRUGATED STEEL OR ALUMINUM CULVERT PIPE 12"	FOOT	30	30
66700205	PERMANENT SURVEY MARKERS, TYPE I	EACH	2	2
54213867	STEEL END SECTIONS 12"	EACH	2	2
67000400	ENGINEER'S FIELD OFFICE, TYPE A	CAL MO	3	3
67100100	MOBILIZATION	L SUM	1	1
70100460	TRAFFIC CONTROL AND PROTECTION, STANDARD 701306	L SUM	1	1
70100500	TRAFFIC CONTROL AND PROTECTION, STANDARD 701326	L SUM	1	1
70100600	TRAFFIC CONTROL AND PROTECTION, STANDARD 701336	L SUM	1	1
70101830	TRAFFIC CONTROL AND PROTECTION, STANDARD BLR 21	LSUM	1	1
70103815	TRAFFIC CONTROL SURVEILLANCE	CAL DA	35	35
70300100	SHORT-TERM PAVEMENT MARKING	FOOT	1202	1202

SUMMARY OF QUANTITIES

CODE NO.	CONSTRUCTION CODE TYPE: I000-1A	UNIT	TOTAL QUANTITY	90% FED. 10% STATE ROADWAY
				I000-1A
* 70300210	TEMPORARY PAVEMENT MARKING - LETTERS AND SYMBOLS	SO FT	78	78
* 70300220	TEMPORARY PAVEMENT MARKING - LINE 4"	FOOT	8680	8680
* 70300240	TEMPORARY PAVEMENT MARKING - LINE 6"	FOOT	330	330
* 70300250	TEMPORARY PAVEMENT MARKING - LINE 8"	FOOT	427	427
* 70300260	TEMPORARY PAVEMENT MARKING - LINE 12"	FOOT	278	278
* 70300280	TEMPORARY PAVEMENT MARKING - LINE 24"	FOOT	83	83
70301000	WORK ZONE PAVEMENT MARKING REMOVAL	SO FT	200	200
* 78000100	THERMOPLASTIC PAVEMENT MARKING - LETTERS AND SYMBOLS	SO FT	78	78
* 78000200	THERMOPLASTIC PAVEMENT MARKING - LINE 4"	FOOT	8680	8680
* 78000400	THERMOPLASTIC PAVEMENT MARKING - LINE 6"	FOOT	330	330
* 78000500	THERMOPLASTIC PAVEMENT MARKING - LINE 8"	FOOT	427	427
* 78000600	THERMOPLASTIC PAVEMENT MARKING - LINE 12"	FOOT	278	278
* 78000650	THERMOPLASTIC PAVEMENT MARKING - LINE 24"	FOOT	83	83
* 78100100	RAISED REFLECTIVE PAVEMENT MARKER	EACH	75	75
78300200	RAISED REFLECTIVE PAVEMENT MARKER REMOVAL	EACH	17	17
* 80500200	SERVICE INSTALLATION, TYPE B	EACH	2	2
* 80801500	WOOD POLE, 25 FT., CLASS 5	EACH	2	2
* 81012600	CONDUIT IN TRENCH, 2" DIA., PVC	FOOT	50	50
* 81021330	CONDUIT PUSHED, 2" DIA., PVC	FOOT	80	80
* 81100500	CONDUIT ATTACHED TO STRUCTURE, 1 1/2" DIA., GALVANIZED STEEL	FOOT	30.5	30.5
* 81500200	TRENCH AND BACKFILL FOR ELECTRICAL WORK	FOOT	50	50
* 85800100	FLASHER CONTROLLER	EACH	2	2
* 87301215	ELECTRIC CABLE IN CONDUIT, SIGNAL NO. 14 2C	FOOT	215	215
X3550215	BITUMINOUS BASE COURSE SUPERPAVE, 5 3/4"	SO YD	765	765
X3560144	BITUMINOUS CONCRETE BASE COURSE WIDENING, SUPERPAVE 10 1/2 INCH	SO YD	1357	1357
X4066426	BITUMINOUS CONCRETE SURFACE COURSE, SUPERPAVE, MIX "D", N70	TON	648	648
X4066770	LEVELING BINDER (MACHINE METHOD), SUPERPAVE N70	TON	398	398
* X8801100	SIGNAL HEAD, LED, POLYCARBONATE, 1-FACE, 1-SECTION, POST MOUNTED	EACH	2	2
X4420460	CLASS D PATCHES, TYPE II, 4 3/4 INCH	SO YD	26	26
X3560060	BITUMINOUS CONCRETE BASE COURSE WIDENING, SUPERPAVE, 4 3/4 INCH	SO YD	203	203

* SPECIALTY ITEMS

REVISIONS	
NAME	DATE

ILLINOIS DEPARTMENT OF TRANSPORTATION

SUMMARY OF QUANTITIES

SCALE: VERT. DATE HORIZ. DATE DRAWN BY CHECKED BY

PLOT DATE = 12/14/2004
 FILE NAME = #FILES#
 PLOT SCALE = #SCALE#
 REFERENCE = #REF#

F.A.S. RTE.	SECTION	COUNTY	TOTAL SHEETS	SHEET NO.
1517	IN	MCLEAN	21	4
STA.		TO STA.		
FED. ROAD DIST. NO.		ILLINOIS FED. AID PROJECT		

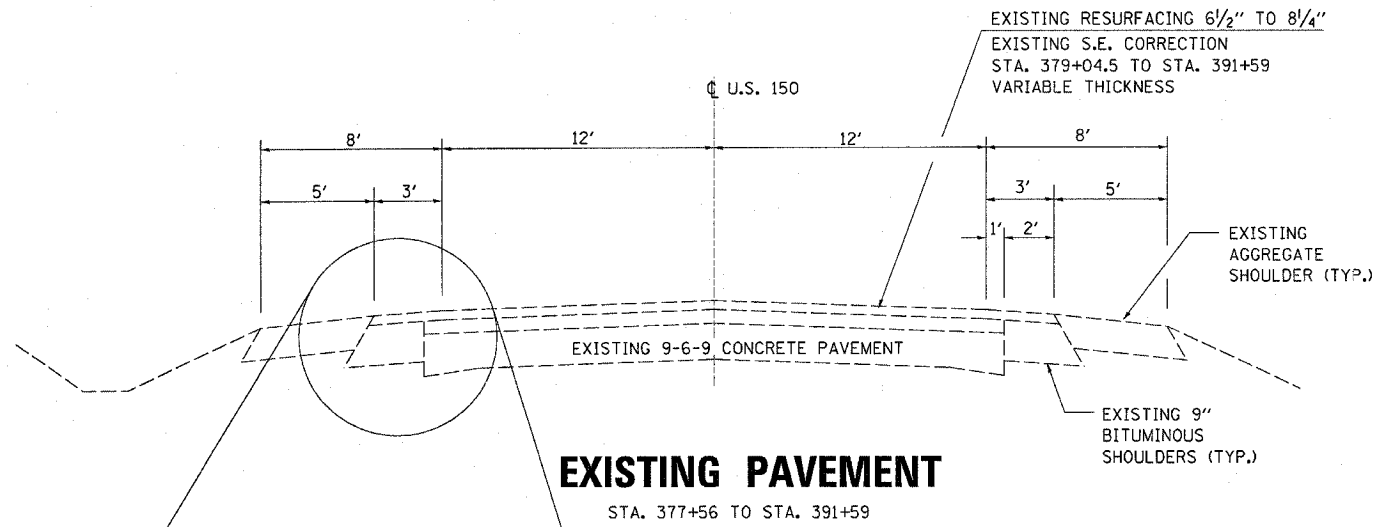

EXISTING PAVEMENT

STA. 377+56 TO STA. 391+59

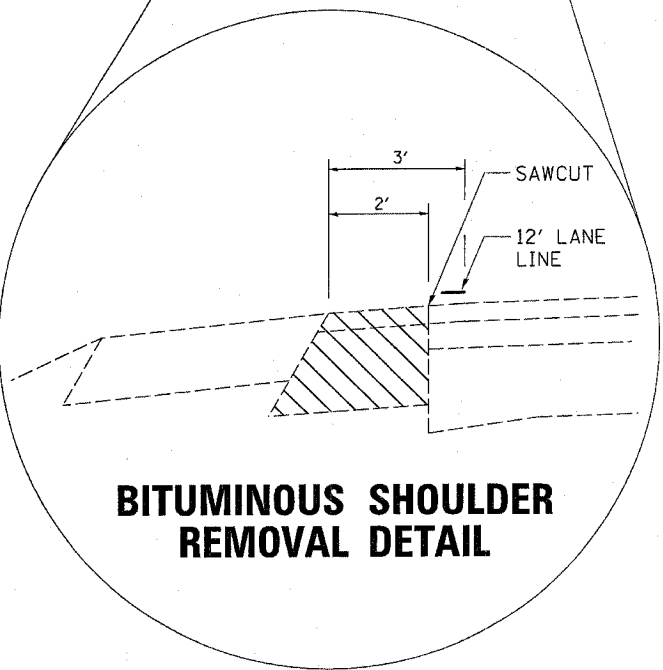

BITUMINOUS SHOULDER REMOVAL DETAIL

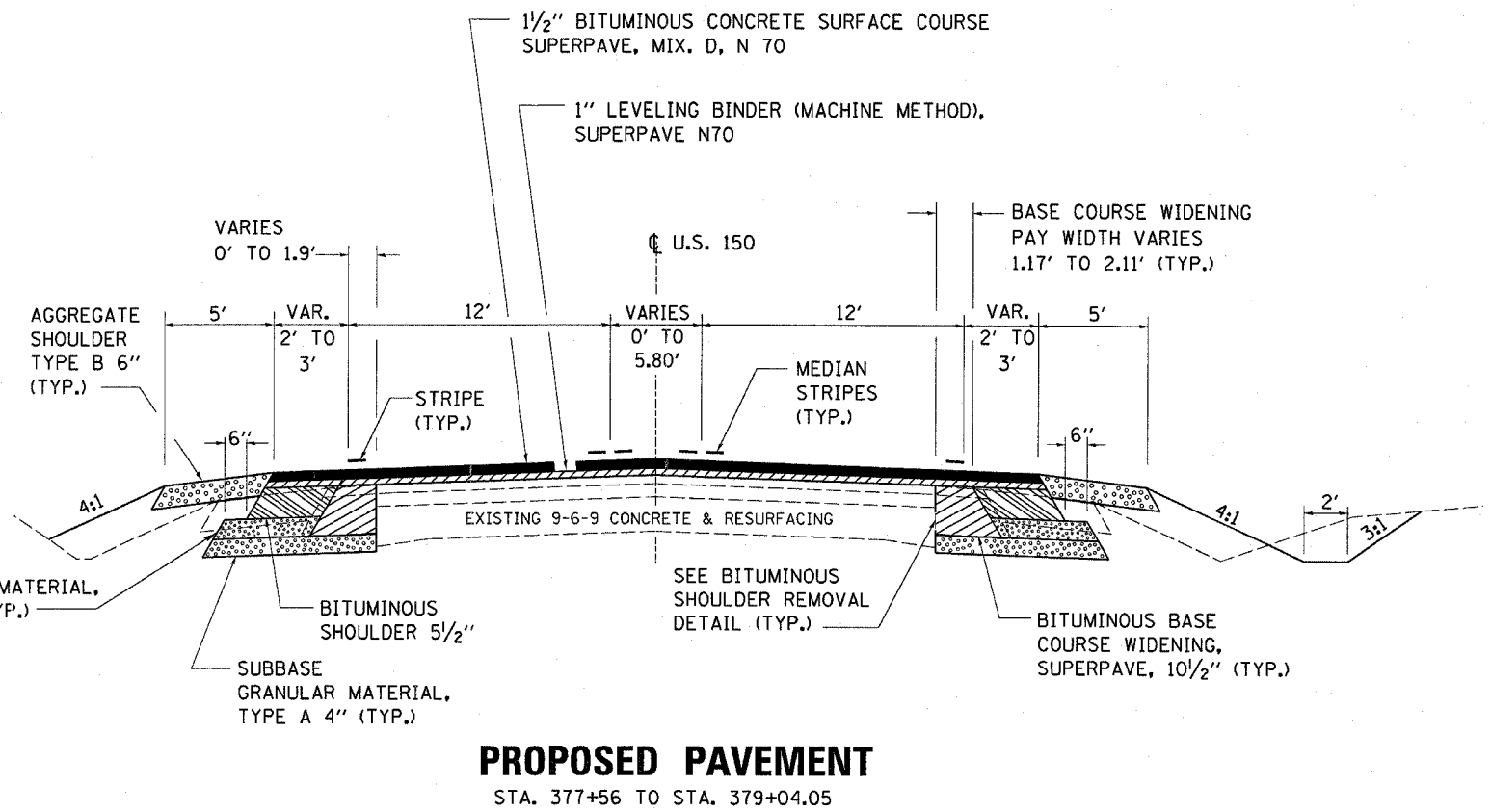

PROPOSED PAVEMENT

STA. 377+56 TO STA. 379+04.05

MIX	AC/PG GRADE	MAXIMUM % RAP*	DESIGN AIR VOIDS	MIXTURE COMPOSITION	PLANT CONTROL LIMITS	FRICTION AGGREGATE	DENSITY TEST METHOD
LEVEL BINDER	PG64-22	15%	4.0% @ N70	IL 9.5	CLASS I		SATISFACTION OF THE ENGINEER
BINDER COURSE							
SURFACE COURSE	PG64-22	10%	4.0% @ N70	IL 12.5 OR IL 9.5	CLASS I	MIXTURE D	CORES
SHOULDER	PG58-22	25%	2.0% @ N50	BAM	NON-CLASS I		* *
PATCHING	PG64-22	25%	4.0% @ N50	IL 19.0	CLASS I		CORES
BASE COURSE AND WIDENING	PG64-22	25%	4.0% @ N50	IL 19.0	CLASS I		CORES
STABILIZED SUBBASE							

* IF RAP OPTION IS SELECTED, THE ASPHALT CEMENT GRADE MAY NEED TO BE ADJUSTED. THIS WILL BE DETERMINED BY THE ENGINEER.

* * MATERIAL SHALL BE COMPACTED TO 93-97 PERCENT OF THE MAXIMUM THEORETICAL DENSITY, EXCEPT THAT THE BOTTOM LIFT SHALL BE COMPACTED TO A MINIMUM OF 91.0 PERCENT. THE MAXIMUM THEORETICAL DENSITY SHALL BE DETERMINED FROM THE MOVING AVERAGE AS SPECIFIED IN THE OC/QA SPECIFICATION.

REVISIONS	
NAME	DATE

ILLINOIS DEPARTMENT OF TRANSPORTATION

TYPICALS

SCALE: VERT. HORIZ. DATE

DRAWN BY CHECKED BY

F.A.S. RTE.	SECTION	COUNTY	TOTAL SHEETS	SHEET NO.
1517	IN	MCLEAN	21	5
STA.		TO STA.		
FED. ROAD DIST. NO.		ILLINOIS FED. AID PROJECT		

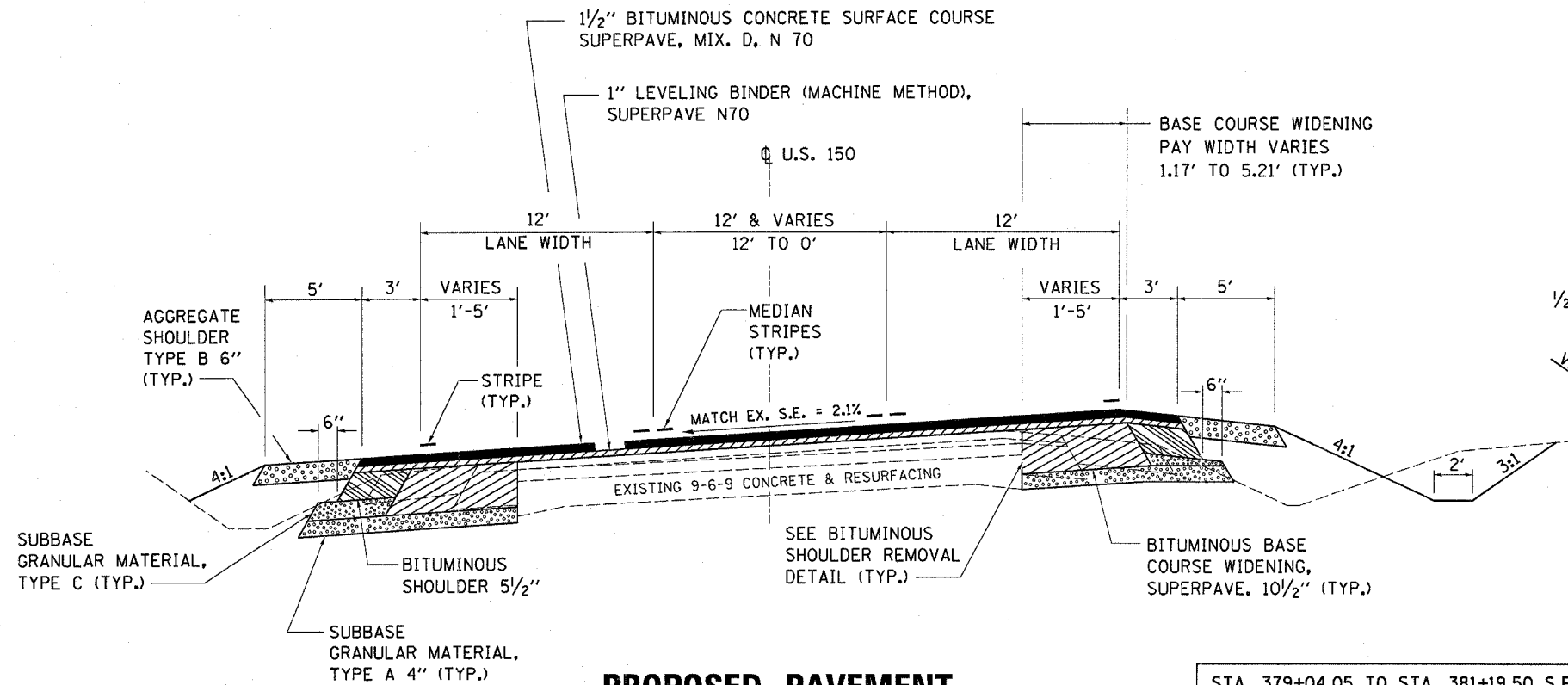

PROPOSED PAVEMENT
STA. 379+04.05 TO STA. 391+59

STA. 379+04.05 TO STA. 381+19.50 S.E. TRANSITION
STA. 381+19.50 TO STA. 389+93.16 FULL S.E.
STA. 389+93.16 TO STA. 392+08.16 S.E. TRANSITION

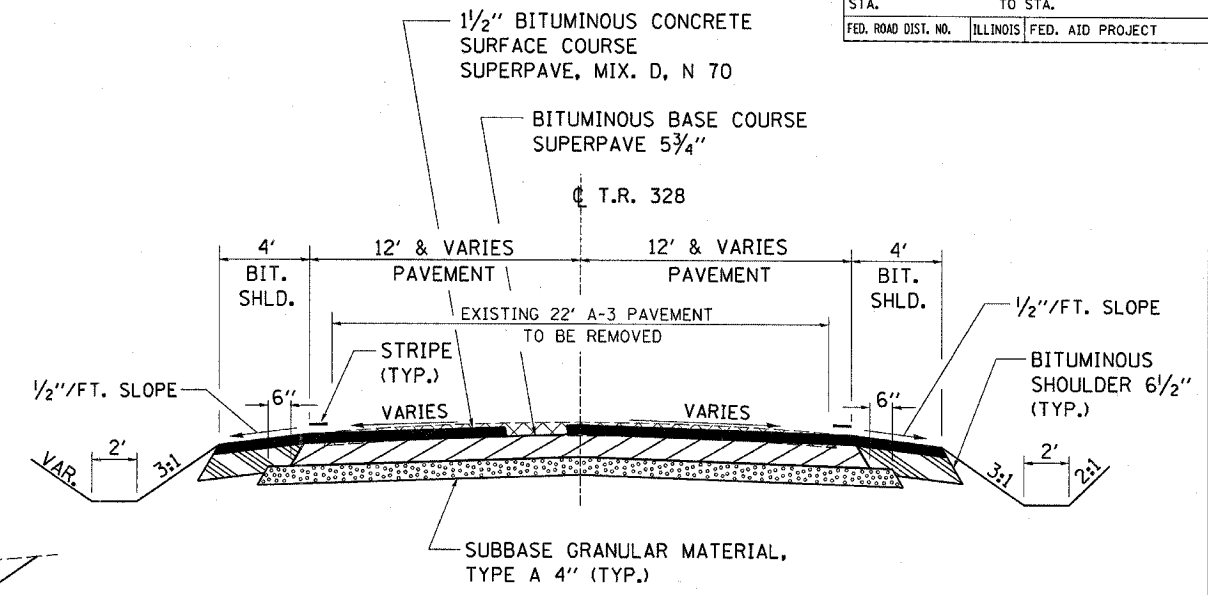

PROPOSED SIDEROAD T.R. 328
T.R. 328 NORTHBOUND STA. 10+51.25 TO STA. 11+59.60

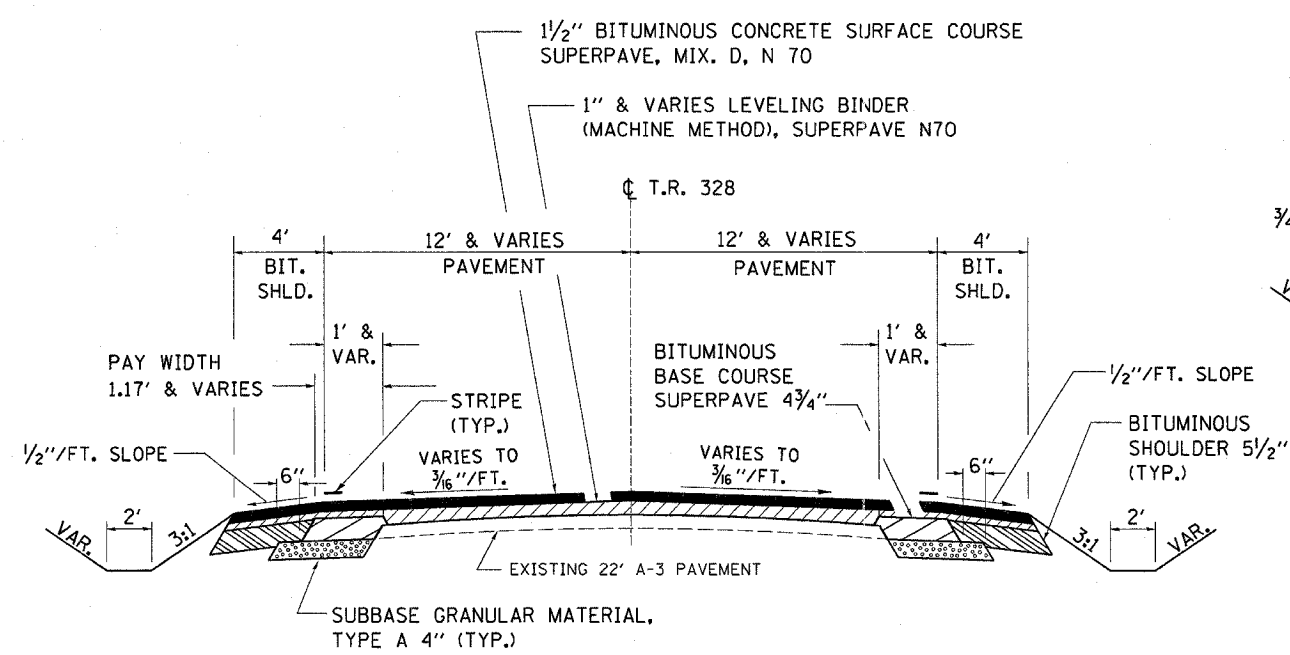

PROPOSED SIDEROAD T.R. 328
T.R. 328 SOUTHBOUND STA. 9+00 TO STA. 10+08.79

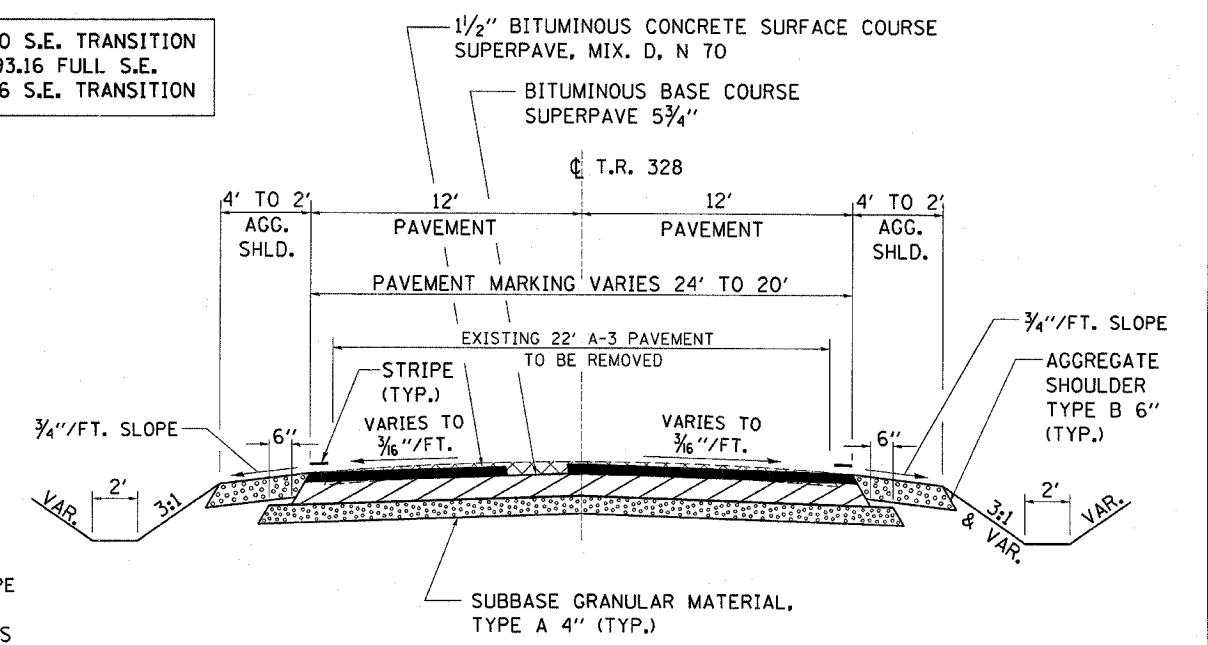

PROPOSED SIDEROAD T.R. 328
T.R. 328 NORTHBOUND STA. 11+59.60 TO STA. 12+50

REVISIONS	
NAME	DATE

ILLINOIS DEPARTMENT OF TRANSPORTATION

TYPICALS

SCALE: VERT. _____
HORIZ. _____

DATE _____

DRAWN BY _____
CHECKED BY _____

F.A.S. RTE.	SECTION	COUNTY	TOTAL SHEETS	SHEET NO.
1517	IN	MCLEAN	21	6
STA.		TO STA.		
FED. ROAD DIST. NO.		ILLINOIS FED. AID PROJECT		

LOCATION	BITUMINOUS MATERIALS (PRIME COAT) (GALLON)	AGGREGATE (PRIME COAT) (TON)	LEVELING BINDER (MACHINE METHOD), SUPERPAVE N70 (TON)	BITUMINOUS CONCRETE SURFACE COURSE, SUPERPAVE, MIX "D" N 70 (TON)	BITUMINOUS SURFACE REMOVAL-BUTT JOINT (SQ YDS)	BITUMINOUS SHOULDERS SUPERPAVE 5 1/2" (SQ YDS)	BITUMINOUS SHOULDERS SUPERPAVE 6 1/2" (SQ YDS)	AGGREGATE SHOULDERS, TYPE B (TONS)	BITUMINOUS BASE COURSE SUPERPAVE, 5 3/4" (SQ YD)
U.S. 150 WEST LEG	223	5	185	276	174	510	0	234	0
U.S. 150 EAST LEG	195	5	161	243	174	453	0	208	0
T.R. 328 NORTH LEG	42	1	6	75	0	0	112	21	765
T.R. 328 SOUTH LEG	61	2	46	54	0	0	105	0	0
TOTALS	521	13	398	648	348	963	217	463	765

LOCATION STATION	REMOVE EXISTING CULVERTS (EACH)	TRENCH BACKFILL (CU YD)	REMARKS
T.R. 328 9+83.3 2.6' LT	1	13.3	18 INCH CMP, 65 FEET
T.R. 328 10+70.7 2.6 LT	1	10.5	18 INCH CMP, 66 FEET
T.R. 328 11+95.3 14.6 LT	1		15 INCH CMP, 33 FEET
U.S. 150 383+78.6 30.7 RT	1		15 INCH CMP, 54 FEET
TOTAL	4	* 23.8	

* SUBTOTAL

LOCATION STA TO STA	SUB-BASE GRANULAR MATERIAL, TYPE A 4" (SQ YD)	STRIP REFLECTIVE CRACK CONTROL TREATMENT (FOOT)	BITUMINOUS CONCRETE BASE COURSE WIDENING, SUPERPAVE, 10 1/2" (SQ YD)	BITUMINOUS BASE COURSE WIDENING, SUPERPAVE, 4 3/4" (SQ YD)
U.S. 150 WEST LEG	772	1506	727	0
U.S. 150 EAST LEG	771	1300	630	0
T.R. 328 SOUTH LEG	211	0	0	203
T.R. 328 NORTH LEG	790	0	0	0
TOTAL	2544	2806	1357	203

LOCATION STA TO STA	TREE REMOVAL 6 TO 15 UNITS DIAMETER UNIT	TREE REMOVAL OVER 15 UNITS DIAMETER UNIT
U.S. 150 385+28/73 RT	11	
U.S. 150 385+28/73 RT	7	
U.S. 150 385+53/115 RT		18
TOTAL	18	18

LOCATION STA TO STA	HEAVY DUTY EXCELSIOR BLANKET (SQ YD)	EXCELSIOR BLANKET, SPECIAL (SQ YD)	EROSION CONTROL BLANKET (SQ YD)	INLET AND PIPE PROTECTION (EACH)	TEMPORARY DITCH CHECKS (EACH)
U.S. 150 WEST LEG	0	0	3063	1	18
U.S. 150 EAST LEG	1745	1351	0	0	18
T.R. 328 SOUTH LEG	0	0	482	1	0
T.R. 328 NORTH LEG	0	0	245	2	0
TOTAL	1745	1351	3790	4	36

LOCATION STATION	PIPE CULVERTS, TYPE 1, CORR. STEEL OR ALUM. CULVERT PIPE 12" (FOOT)	STEEL END SECTIONS 12" (EACH)	PIPE CULVERTS, TYPE 1, CORR. STEEL OR ALUM. CULVERT PIPE 15" (FOOT)	STEEL END SECTIONS 15" (EACH)	PIPE CULVERTS, TYPE 1, CORR. STEEL OR ALUM. CULVERT PIPE 18" (FOOT)	STEEL END SECTIONS 18" (EACH)	TRENCH BACKFILL (CU YD)
T.R. 328 11+95, LT	28	2					
T.R. 328 10+82, CL					90	2	20.6
T.R. 328 9+62, CL					90	2	10.9
U.S. 150 383+71, 40' RT			36	2			
TOTAL	28	2	36	2	180	4	* 31.5

* SUBTOTAL

LOCATION STATION	AGGREGATE SURFACE COURSE TYPE B (TONS)
U.S. 150 383+71.3/30.6RT	38
T.R. 328 11+95/LT	18
T.R. 328 12+08/RT	18
TOTAL	74

LOCATION STA TO STA	DISTANCE (FEET)	EARTH EXCAVATION (CU YD)	EARTH EXCAVATION ADJUSTED FOR SHRINKAGE (CU YD)	EMBANKMENT (CU YD)	EARTHWORK BALANCE WASTE (+) OR SHORTAGE (-) (CU YD)
U.S. 150 377+50 TO 385+00	750	842	632	632	0
U.S. 150 385+50 TO 392+00	650	859	644	574	70
T.R. 328 8+50 TO 10+00	150	191	143	1	142
T.R. 328 11+00 TO 13+00	200	643	482	0	482
TOTAL	1750	2535	1901	1207	695

COLUMN 4 = EARTH EXCAVATION ADJUSTED USING SHRINKAGE FACTOR OF 25%

LOCATION STATION	CLASS D PATCHES TYPE II 4 3/4" (SQ YD)
U.S. 150 385+50, 40' RT	5
U.S. 150 385+50, 40' RT	5
U.S. 150 385+50, 58' RT	8
U.S. 150 385+50, 58' RT	8
TOTAL	26

LOCATION U.S. 150 STA 377+56 TO STA 391+59	SEEDING CLASS 2 (ACRE)	NITROGEN FERTILIZER NUTRIENT (POUND)	PHOSPHORUS FERTILIZER NUTRIENT (POUND)	POTASSIUM FERTILIZER NUTRIENT (POUND)	MULCH METHOD 2 (ACRE)	TEMPORARY EROSION CONTROL SEEDING (POUND)
TOTALS	2.00	180	180	180	0.75	400

LOCATION STA TO STA	THERMOPLASTIC MARKING SCHEDULE							RAISED REFLECTIVE PAVEMENT MARKER (EACH)	RAISED REFLECTIVE PAVEMENT MARKER REMOVAL (EACH)
	LETTERS AND SYMBOLS WHITE (SQ FT)	LINE 4 INCH YELLOW (FOOT)	LINE 4 INCH WHITE (FOOT)	LINE 6 INCH WHITE (FOOT)	LINE 8 INCH WHITE (FOOT)	LINE 12 INCH WHITE (FOOT)	LINE 24 INCH WHITE (FOOT)		
T.R. 328 9+80 RT							43		
T.R. 328 10+70 LT							40		
T.R. 328 9+00 TO 12+50			630	80					
U.S. 150 377+56 TO 381+10						130			
U.S. 150 377+56 TO 391+59	78	5398	2652	250				75	17
U.S. 150 380+58 TO 384+58					266				
U.S. 150 386+60 TO 389+55					161				
U.S. 150 387+10 TO 391+59						148			
SUBTOTALS	78	5398	3282	330	427	278	83	75	17
TOTALS	78	8680	330	427	278	83	75	17	

LOCATION STA TO STA	SHORT TERM PAVEMENT MARKING (FOOT)	WORK ZONE PAVEMENT MARKING REMOVAL (SQ FT)
U.S. 150 377+56 TO 391+59	1146	191
T.R. 328 10+80 TO 12+50	34	6
T.R. 328 9+00 TO 10+07.5	22	3
TOTAL	1202	200

LOCATION STATION	PC	PT
380+47.83	1	
390+64.83		1
TOTAL	1	1

NAME	DATE

ILLINOIS DEPARTMENT OF TRANSPORTATION

SCHEDULES

SCALE: VERT. DATE: HORIZ. DATE: DRAWN BY: CHECKED BY:

F.A.S. RTE.	SECTION	COUNTY	TOTAL SHEETS	SHEET NO.
1517	IN	MCLEAN	20	7
STA. 377+00		TO STA. 382+00		
FED. ROAD DIST. NO.	ILLINOIS	FED. AID PROJECT		

PLAN	DATE
BY	
REVISIONS	
NO.	

PROFILE	DATE
BY	
REVISIONS	
NO.	

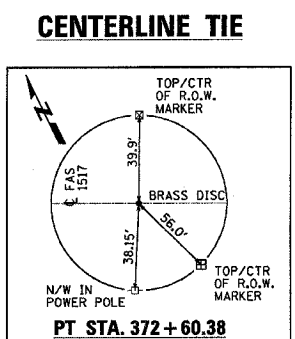
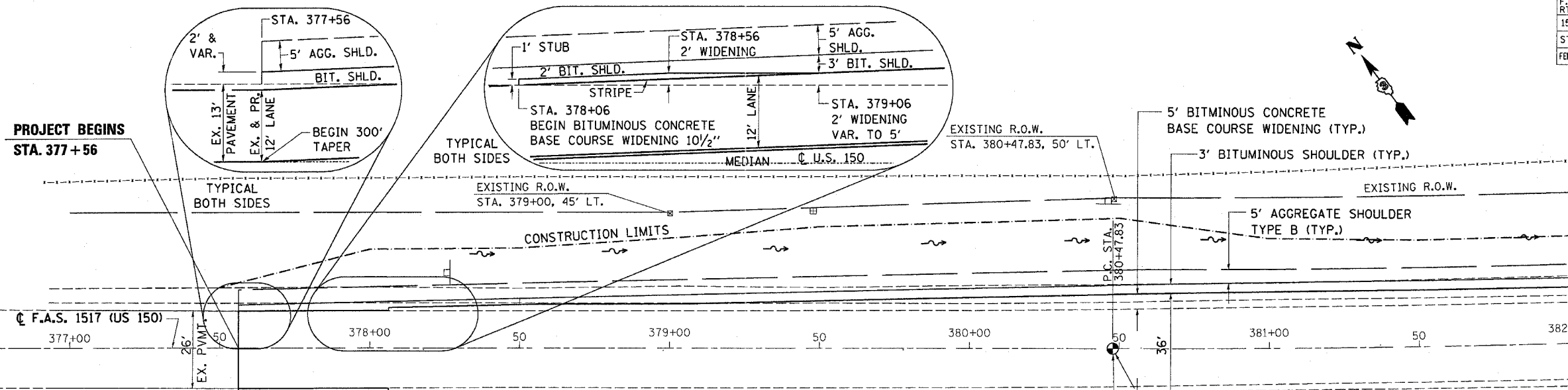

INSTALL FLASHING BEACON ON EXISTING "INTERSECTION AHEAD" SIGN APPROXIMATE STA. 375+75 SEE FLASHING BEACON INSTALLATION PLANS

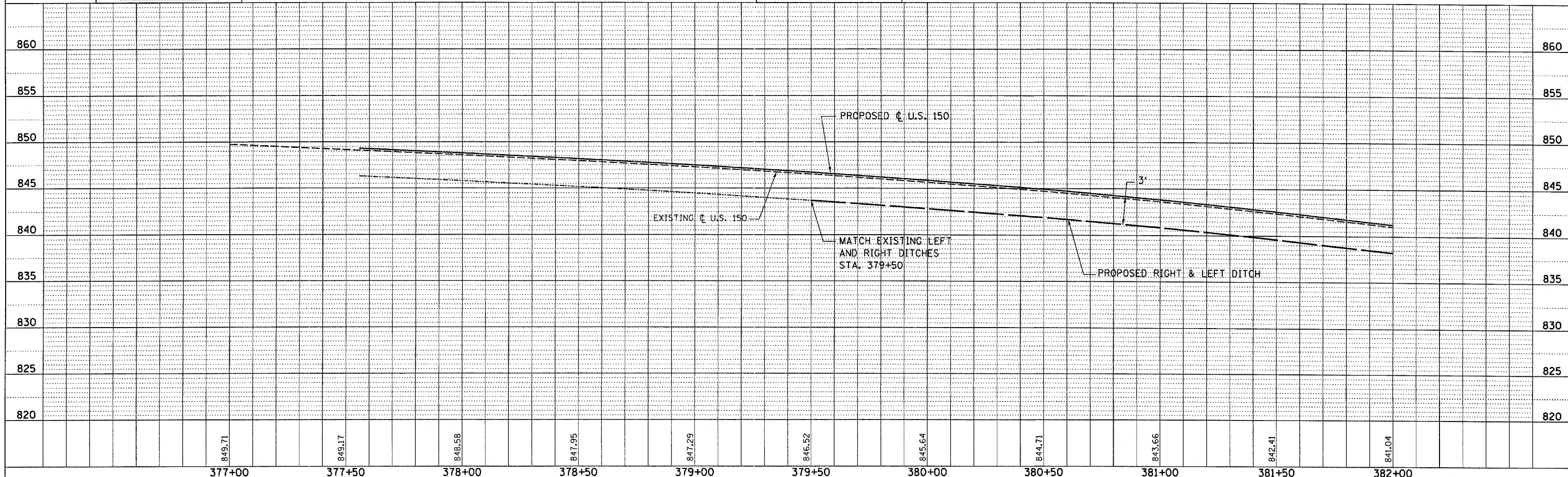
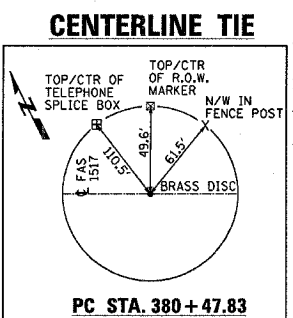

F.A.S. RTE.	SECTION	COUNTY	TOTAL SHEETS	SHEET NO.
1517	IN	MCLEAN	20	8
STA. 382+00		TO STA. 388+00		
FED. ROAD DIST. NO.	ILLINOIS	FED. AID PROJECT		

DATE	BY

DATE	BY

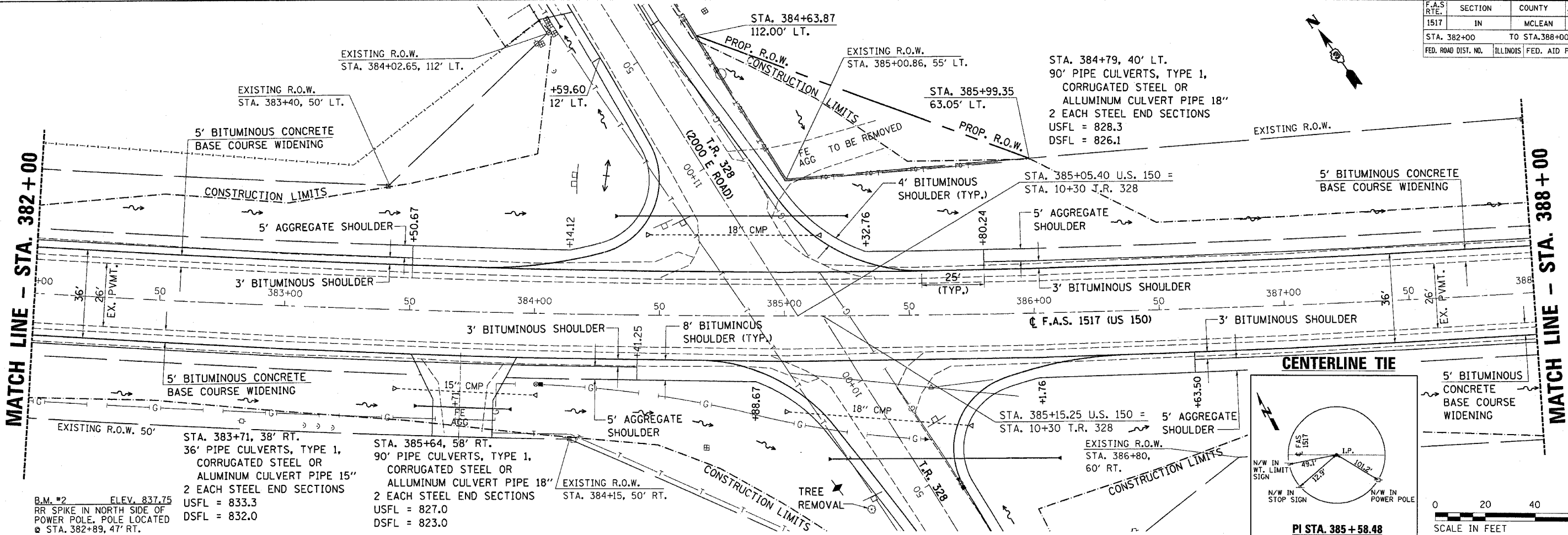

STA. 382+00 TO STA. 388+00
PLAN & PROFILE

F.A.S. RTE.	SECTION	COUNTY	TOTAL SHEETS	SHEET NO.
1517	IN	MCLEAN	20	9
STA. 388+00 TO STA. 394+00				
FED. ROAD DIST. NO. ILLINOIS FED. AID PROJECT				

MATCH LINE - STA. 338 + 00

PLAN	SURVEYED	DATE
	PLOTTED	
	CHECKED	
	BY	
	NO. OF WAY CHECKED	
	ADD FILE NAME	

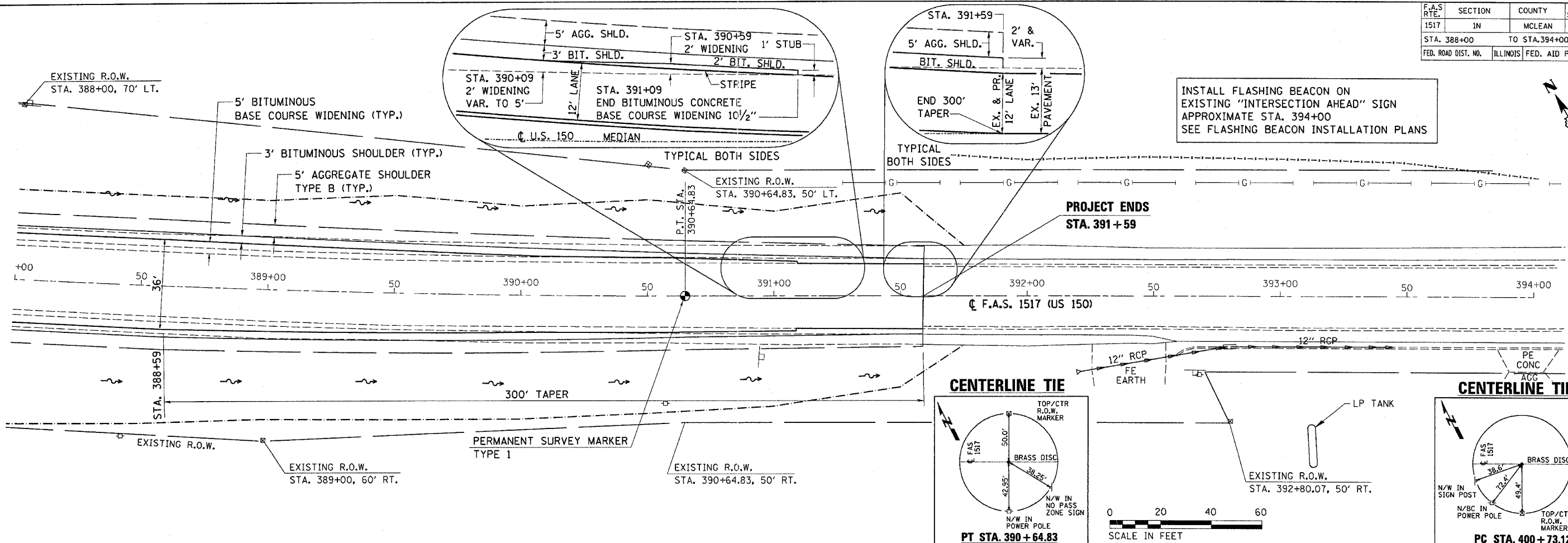

INSTALL FLASHING BEACON ON EXISTING "INTERSECTION AHEAD" SIGN APPROXIMATE STA. 394+00 SEE FLASHING BEACON INSTALLATION PLANS



PROFILE	SURVEYED	DATE
	PLOTTED	
	CHECKED	
	BY	
	NO. OF WAY CHECKED	
	STRUCTURE NOTATIONS CHFD	

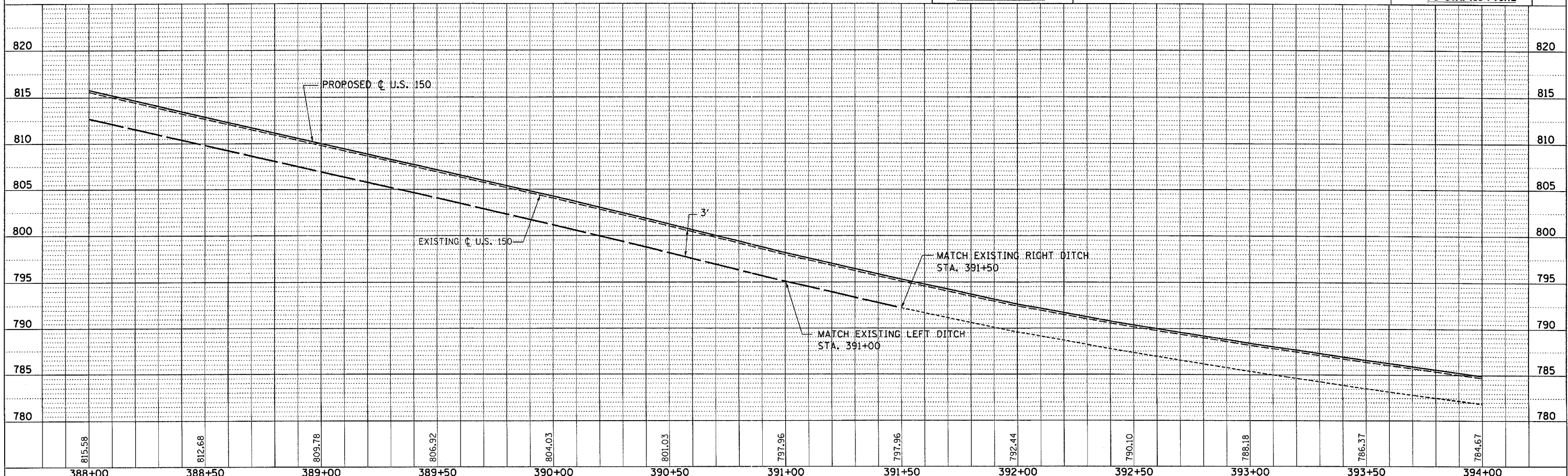

**STA. 388 + 00 TO STA. 394 + 00
PLAN & PROFILE**

F.A.S. RTE.	SECTION	COUNTY	TOTAL SHEETS	SHEET NO.
1517	1N	MCLEAN	20	10
STA. 5+00		TO STA. 9+30		
FED. ROAD DIST. NO.		ILLINOIS		FED. AID PROJECT

TEMPORARY EASEMENT OBTAINED FOR GRADING PURPOSES. WORK INCLUDES REMOVING AND RESETTING A GATE AND TWO PANELS OF WOVEN WIRE FENCE WITH 4 WOOD POSTS, & GRADING AS SHOWN HERE AND IN THE CROSS SECTIONS. THIS WORK WILL NOT BE PAID FOR SEPARATELY BUT WILL BE INCLUDED IN THE CONTRACT UNIT PRICE PER CUBIC YARD FOR EARTH EXCAVATION.

STA. 11+95, 19' LT.
30" PIPE CULVERTS, TYPE 1, CORRUGATED STEEL OR ALUMINUM CULVERT PIPE 12" 2 EACH STEEL END SECTIONS
USFL = 828.1
DSFL = 826.8

PLAN	DATE
DESIGNED	
PLOTTED	
GRADES CHECKED	
STRUCTURE NOTATIONS OK'D	
NOTE BOOK NO.	
CADD FILE NAME	

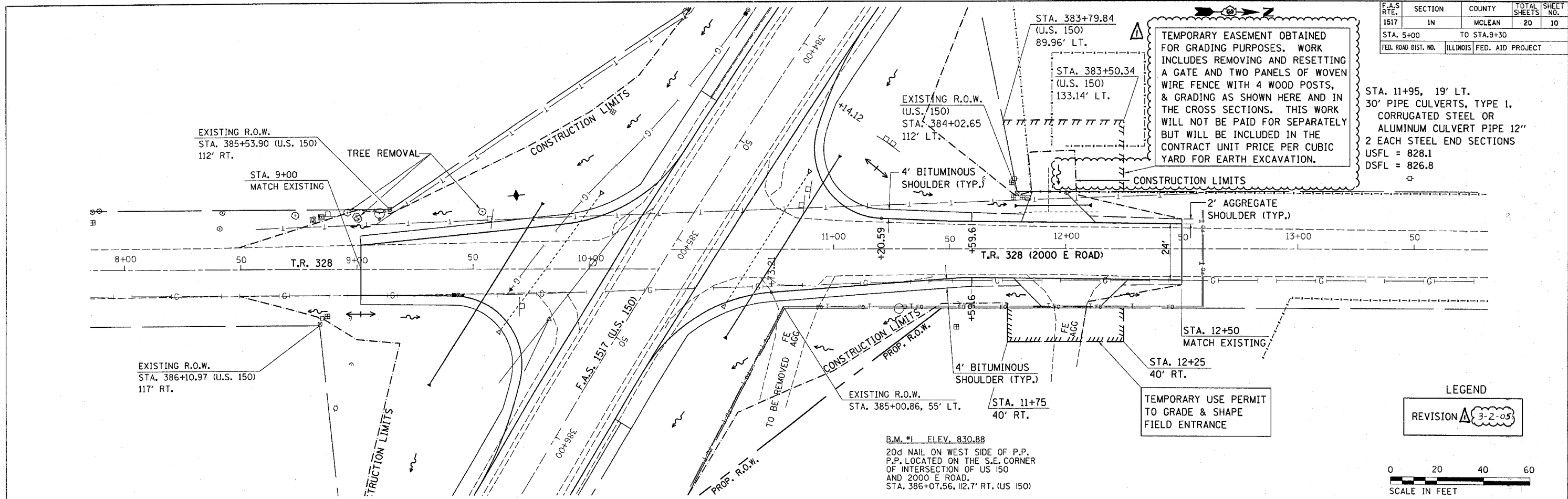

LEGEND
 REVISION Δ 3-2-05

SCALE IN FEET

PROFILE	DATE
DESIGNED	
PLOTTED	
GRADES CHECKED	
STRUCTURE NOTATIONS OK'D	
NOTE BOOK NO.	

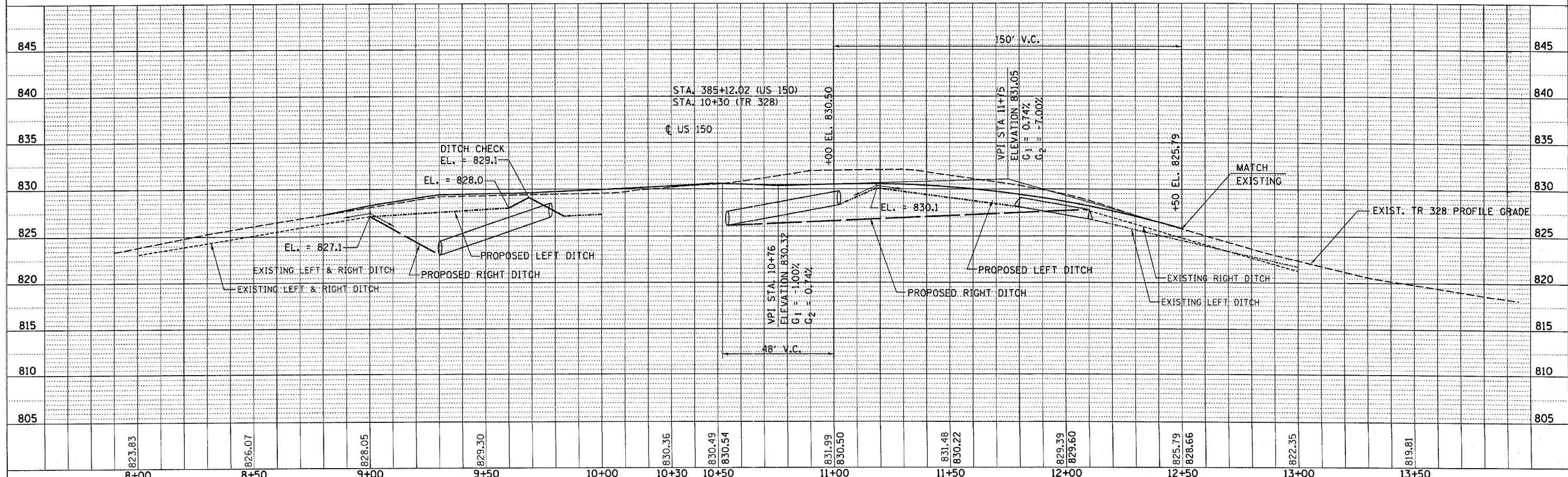

F.A.S. RTE.	SECTION	COUNTY	TOTAL SHEETS	SHEET NO.
1517	IN	MCLEAN	21	11
STA. TO STA.		FED. ROAD DIST. NO. ILLINOIS FED. AID PROJECT		

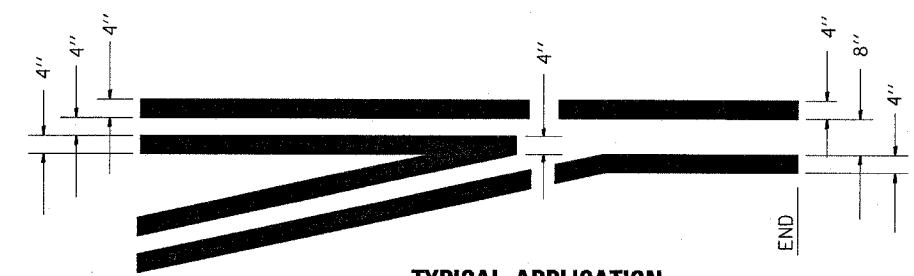
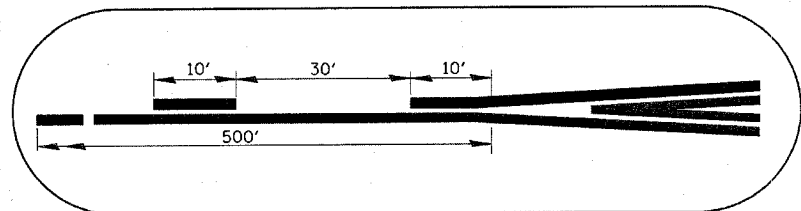
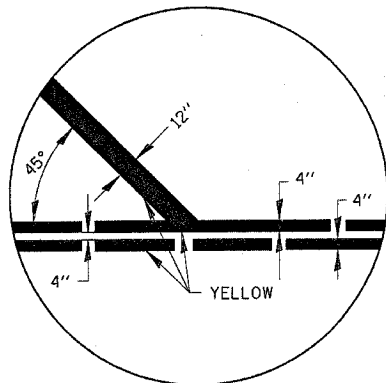

EXISTING HORIZONTAL CURVE DATA
 P.I. STA= 385+58.48
 P.C. STA= 380+47.83
 P.T. STA= 390+64.83
 $\Delta = 12^\circ 52' 55''$
 $T = 510.65'$
 $R = 4523.35'$
 $D = 1^\circ 16' 00''$
 $L = 1017.00'$
 $E = 28.73'$
 $S.E. = 0.021 \text{ FT/FT}$
 S.E. ATTAINED STA. 379+04.50 TO STA. 381+19.50
 S.E. REMOVED STA. 389+93.16 TO STA. 392+08.16

2-CTR. CURVE
 $R1 = 30'$
 $R2 = 175'$
 $O/S = 6.5'$

SEE DETAILS FOR APPROACH PAVEMENT MARKING

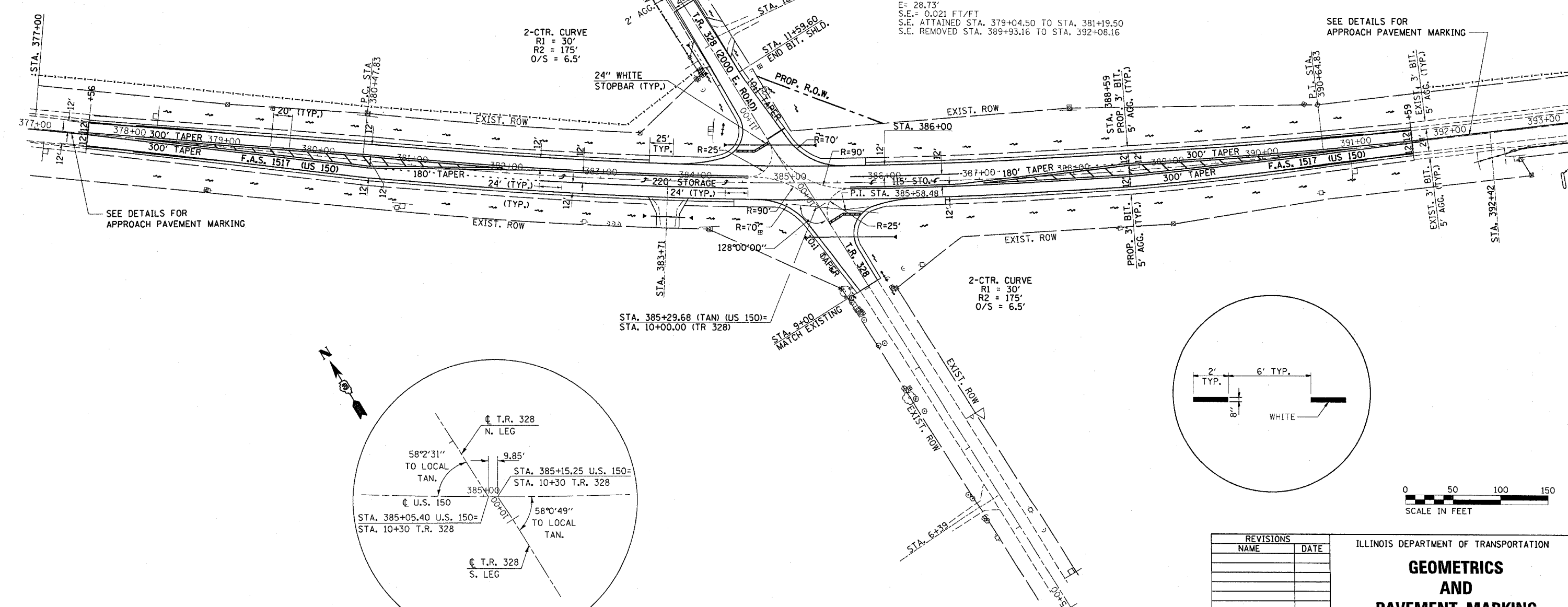

SEE DETAILS FOR APPROACH PAVEMENT MARKING

STA. 385+29.68 (TAN) (US 150)=
 STA. 10+00.00 (TR 328)

2-CTR. CURVE
 $R1 = 30'$
 $R2 = 175'$
 $O/S = 6.5'$

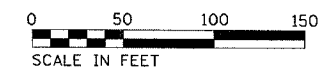
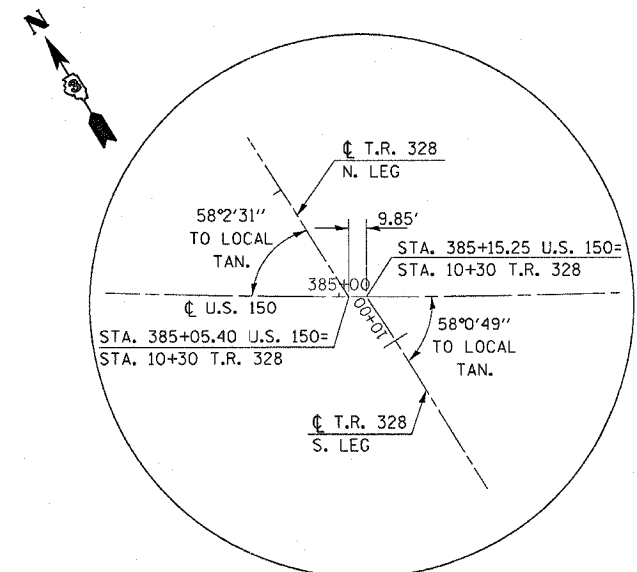
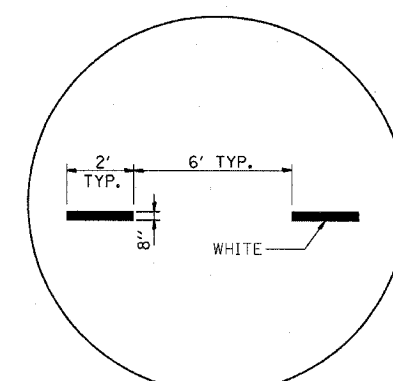

REVISIONS	
NAME	DATE

ILLINOIS DEPARTMENT OF TRANSPORTATION
GEOMETRICS AND PAVEMENT MARKING
 SCALE: VERT. _____
 DATE _____ HORIZ. _____
 DRAWN BY _____
 CHECKED BY _____

F.A.S. RTE.	SECTION	COUNTY	TOTAL SHEETS	SHEET NO.
1517	IN	MCLEAN	21	12
STA.		TO STA.		
FED. ROAD DIST. NO.	ILLINOIS	FED. AID PROJECT		

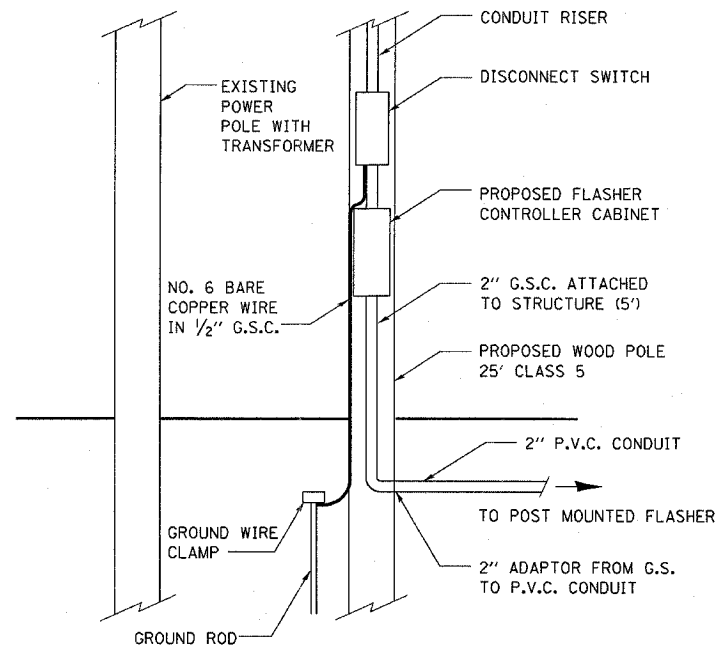
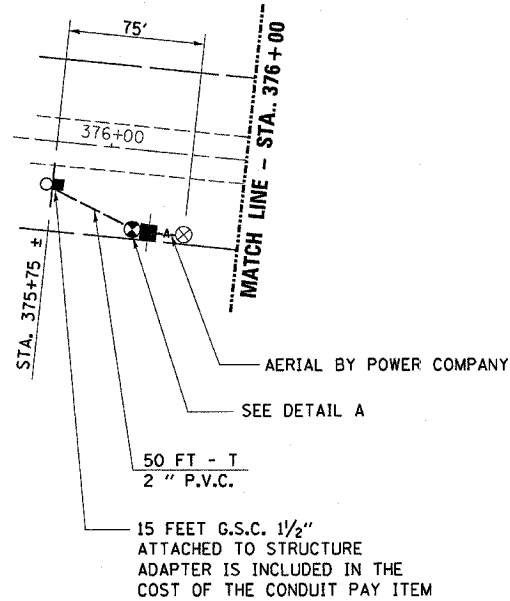

LEGEND

	EXISTING WOOD POLE
	PROPOSED WOOD POLE, 25 FT, CLASS 5
	PROPOSED FLASHER CONTROLLER
	PROPOSED SERVICE INSTALLATION, TYPE B
	PROPOSED HANDHOLE
	PROPOSED CONDUIT IN TRENCH OR PUSHED
	PROPOSED 12" YELLOW FLASHER ON "INTERSECTION AHEAD" SIGNS

INSTALL FLASHING BEACON ON EXISTING "INTERSECTION AHEAD" SIGN APPROXIMATE STA. 375+70

INSTALL FLASHING BEACON ON EXISTING "INTERSECTION AHEAD" SIGN APPROXIMATE STA. 394+00

MATCH LINE - STA. 376+00

MATCH LINE - STA. 393+20

CONSTRUCTION NOTES

1. THE CONTRACTOR SHALL VERIFY THE EXACT LOCATION OF ALL UNDERGROUND UTILITIES PRIOR TO BEGINNING CONSTRUCTION (J.U.L.I.E.: 800-892-0123)
2. ALL CONDUIT IN TRENCH SHALL BE P.V.C. ALL CONDUIT PUSHED SHALL BE P.V.C. CONDUIT ATTACHED TO STRUCTURES SHALL BE GALVANIZED STEEL.
3. A 1/4" DIAMETER CONTINUOUS NYLON ROPE SHALL BE FURNISHED AND LEFT IN PLACE IN ALL CONDUITS BETWEEN FLASHERS AND CONTROLLER AND SHALL BE INCLUDED IN THE COST OF THE RESPECTIVE CONDUIT PAY ITEM.
4. THE TRAFFIC SIGNAL SECTION AT THE ILLINOIS DEPARTMENT OF TRANSPORTATION SHALL BE NOTIFIED AT (815) 434-6131 AT LEAST 72 HOURS PRIOR TO TURNING ON ANY FLASHER OR CONTROLLER UNITS.
5. THE CONTRACTOR SHALL BE RESPONSIBLE FOR OBTAINING ELECTRICAL SERVICE FOR THE TRAFFIC SIGNAL. THE CONTRACTOR SHALL CONTACT THE UTILITY COMPANY PRIOR TO BEGINNING WORK TO OBTAIN THE UTILITY COMPANY REQUIREMENTS FOR THE SERVICE INSTALLATION.
6. NO ADDITIONAL COMPENSATION WILL BE ALLOWED FOR PLACING CONDUIT AT DEPTHS GREATER THAN THE 2 FOOT MINIMUM TO AVOID OBSTACLES SUCH AS UNDERGROUND UTILITIES.
7. THE ELECTRICAL CONDUCTORS FOR ALL TRAFFIC SIGNAL HEADS SHALL BE SOLID, SOFT COPPER.
8. THE CONTRACTOR IS RESPONSIBLE FOR THE COST OF UNCOVERING OR HAND DIGGING AROUND UTILITIES AS NECESSARY. THIS SHALL BE INCLUDED IN THE COST OF THE CONDUIT PAY ITEM.
9. ALL THREADS OF BOLTS USED IN ASSEMBLY OF TRAFFIC SIGNAL COMPONENTS SHALL BE COATED WITH A NON-LEAD BASED ANTI-SEIZE COMPOUND, SIMILAR TO LEAD PLATE, PRIOR TO ASSEMBLY.
10. THE CONTRACTOR SHALL TAKE CARE TO DELIVER ALL CONTROLLER MANUALS WITH EACH CONTROLLER SUPPLIED.
11. ALL SODDED AREAS DISTURBED BY THE CONTRACTOR SHALL BE RESTORED WITH NEW SOD TO THE SATISFACTION OF THE ENGINEER. ALL GRASS DISTURBED BY THE CONTRACTOR SHALL BE RESTORED BY SEEDING.
12. THE SIGNAL HEAD SHALL BE 12" YELLOW L.E.D. POLYCARBONATE.
13. ALL CONDUIT ADAPTERS SHALL BE INCLUDED IN THE COST OF CONDUIT PAY ITEMS.

ELECTRICAL LOAD INFORMATION

COMPONENT	NUMBER	WATTAGE	BURN TIME (%)
FLASHER	2	17	50
FLASHER CONTROLLER	2	6	100

15.5 FEET G.S.C. 1/2" ATTACHED TO STRUCTURE ADAPTER IS INCLUDED IN THE COST OF THE CONDUIT PAY ITEM

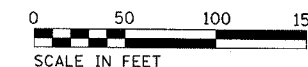
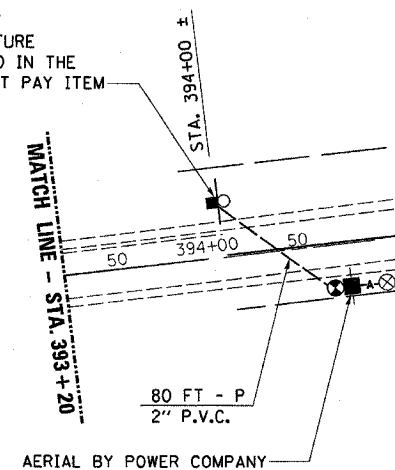

REVISIONS

NAME	DATE

ILLINOIS DEPARTMENT OF TRANSPORTATION

FLASHING BEACON PLAN

SCALE: VERT. DATE

DRAWN BY CHECKED BY

F.A.S. RTE.	SECTION	COUNTY	TOTAL SHEETS	SHEET NO.
1517	IN	MCLEAN	21	13
STA.		TO STA.		
FED. ROAD DIST. NO.		ILLINOIS FED. AID PROJECT		

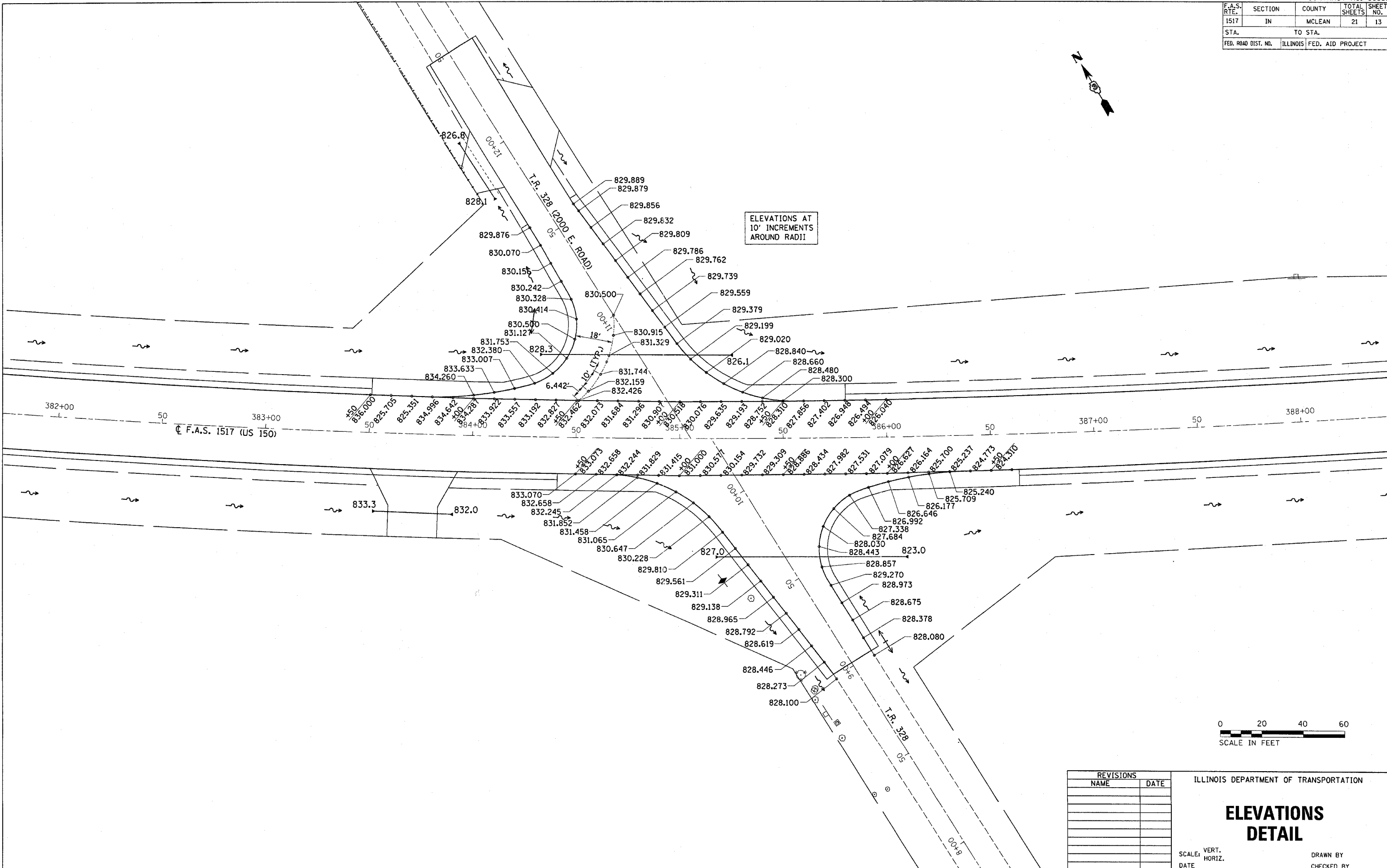
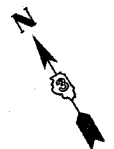

ELEVATIONS AT 10' INCREMENTS AROUND RADII

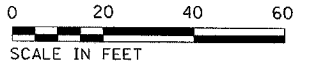

REVISIONS	
NAME	DATE

ILLINOIS DEPARTMENT OF TRANSPORTATION

ELEVATIONS DETAIL

SCALE: VERT.
HORIZ.
DATE

DRAWN BY
CHECKED BY

F.A.S. RTE.	SECTION	COUNTY	TOTAL SHEETS	SHEET NO.
1517	IN	MCLEAN	21	14
STA.	TO STA.			
FED. ROAD DIST. NO.	ILLINOIS FED. AID PROJECT			

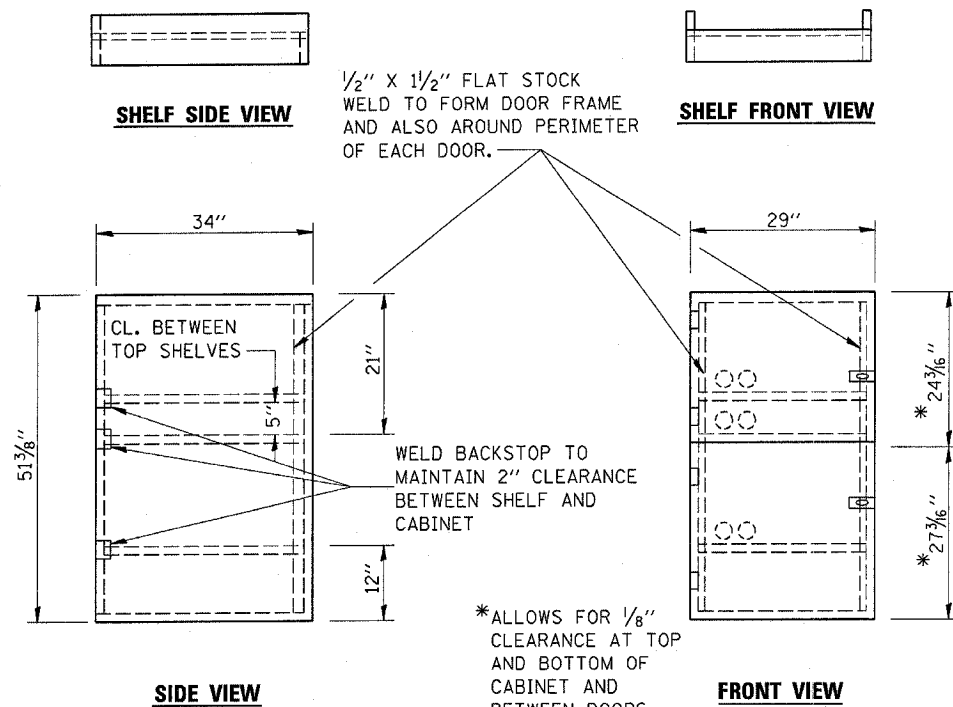

- NOTES:
1. USE 16 GAUGE STEEL FOR CABINET.
 2. THE TOP SHELF SHALL SLIDE IN OR OUT WITH THE TOP DOOR OPEN.
 3. ALL HINGES AND HASPS WILL BE WELDED TO THE CABINET.
 4. ALL EDGES SHALL BE GROUND SMOOTH.
 5. TWO (2" DIA.) ACCESS HOLES WILL BE REQUIRED FOR EACH SHELF.
 6. CABINET SHALL BE PAINTED WITH TWO COATS OF FLAT PAINT.
 7. 2 EACH MATCHING KEY PADLOCKS, WITH 3 KEYS PROVIDED, MASTER MODEL 3 T OR EQUIVALENT.
 8. 4 EACH PLAIN STEEL, NON-REMOVABLE PIN, NO HOLE 4"X4" SQUARE CORNER HINGES TO BE WELDED ON.
 9. 2 EACH EXTRA HEAVY, PLAIN STEEL, FIXED STAPLE, NO HOLE, 7 1/4" HASPS TO BE WELDED ON.

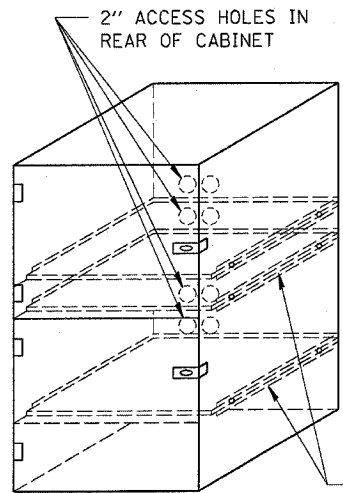

FLAT STOCK DIMENSIONS VARY DEPENDING ON TYPE OF ROLLER ASSEMBLY.

LOCKABLE COMPUTER CABINET

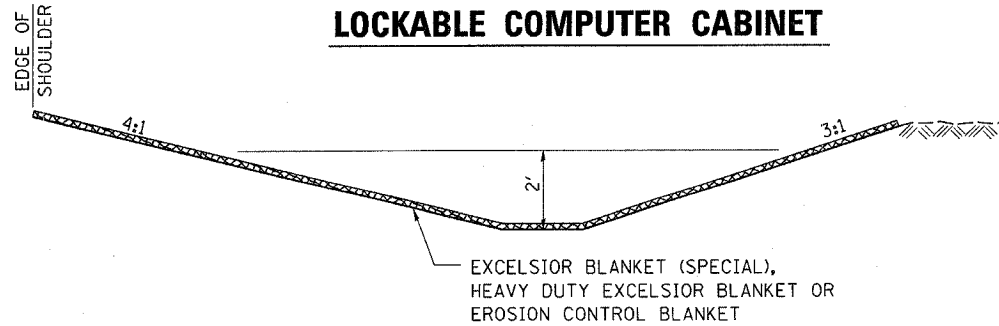

EROSION CONTROL BLANKETS

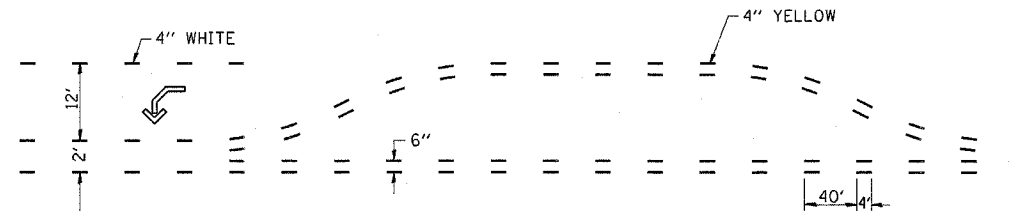
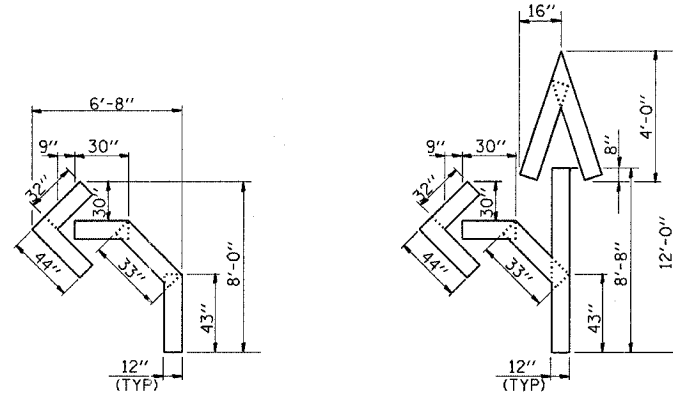

SHORT-TERM PAVEMENT MARKING FOR MEDIANS AND ARROWS

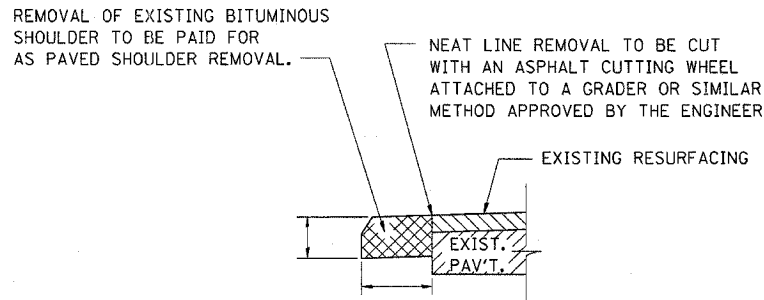

REMOVAL OF EXISTING BITUMINOUS SHOULDER

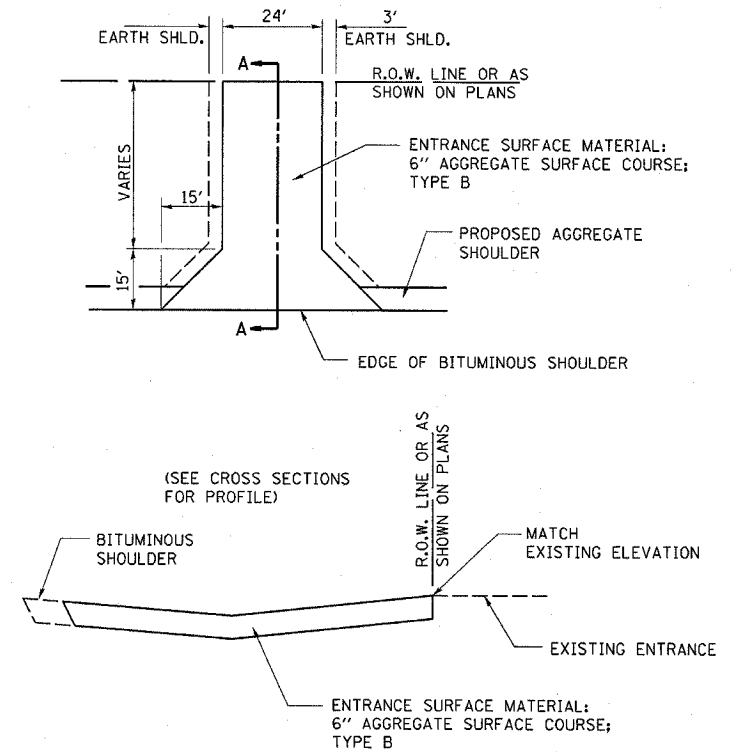

FIELD ENTRANCE DETAIL

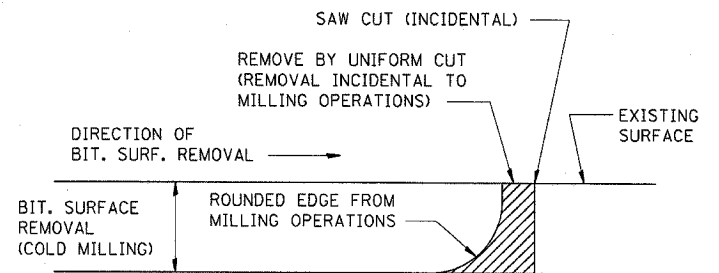

NOTE: WHEN MILLING OPERATIONS PRODUCE A ROUNDED EDGE, THEN A SAW CUT SHALL BE USED TO MANUFACTURE A PERPENDICULAR EDGE AS SHOWN IN THE DETAIL. THE ENGINEER SHALL BE THE SOLE JUDGE CONCERNING THE USE OF THIS DETAIL.

BITUMINOUS DETAIL AT BUTT JOINTS

REVISIONS		ILLINOIS DEPARTMENT OF TRANSPORTATION
NAME	DATE	
		DRAWN BY CHECKED BY

SCALE: VERT. DATE
 HORIZ. DATE

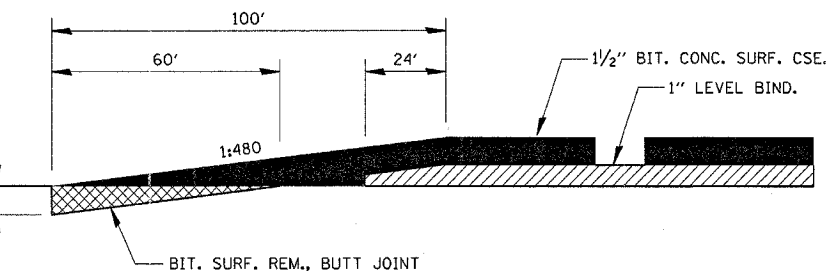

TAPER DETAIL AT BUTT JOINT

F.A.S. RTE	SECTION	COUNTY	TOTAL SHEETS	SHEET NO.
1517	IN	McLEAN	21	15
STA. 377+00		TO STA. 380+00		
FED. ROAD DIST. NO. ILLINOIS FED. AID PROJECT				

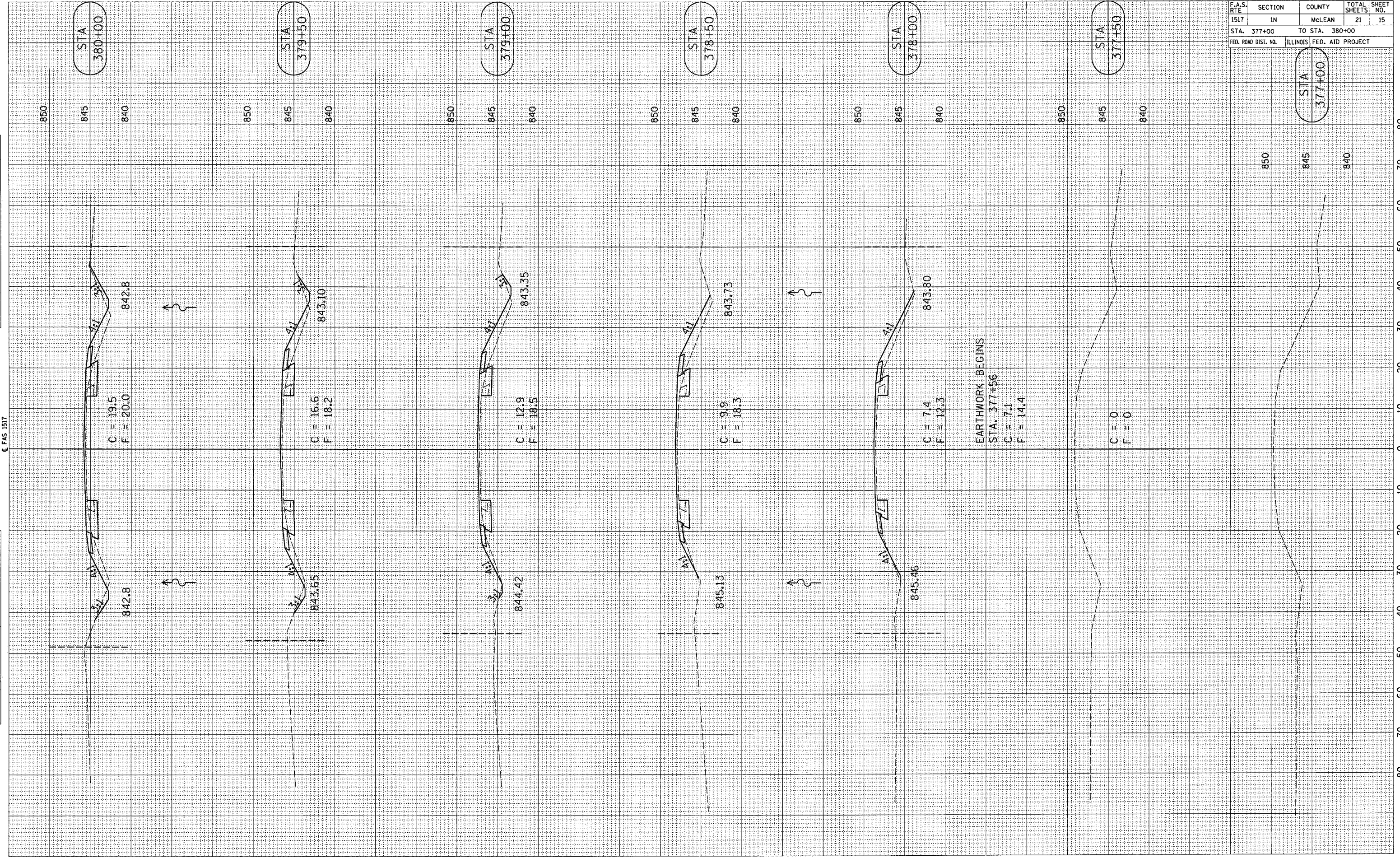

STA 377+00

STA 377+50

STA 378+00

STA 378+50

STA 379+00

STA 379+50

STA 380+00

C = 19.5
F = 20.0

C = 16.6
F = 18.2

C = 12.9
F = 18.5

C = 9.9
F = 18.3

C = 7.4
F = 12.3

EARTHWORK BEGINS
STA. 377+56
C = 7.1
F = 14.4

C = 0
F = 0

842.8

843.65

844.42

845.13

845.46

842.8

843.10

843.35

843.73

843.80

850

845

840

80

70

60

50

40

30

20

10

0

10

20

30

40

50

60

70

80

DATE	BY

DATE	BY

EAS 1517

F.A.S. RTE	SECTION	COUNTY	TOTAL SHEETS	SHEET NO.
1517	IN	McLEAN	21	16
STA. 380+50		TO STA. 383+50		
FED. ROAD DIST. NO.	ILLINOIS	FED. AID PROJECT		

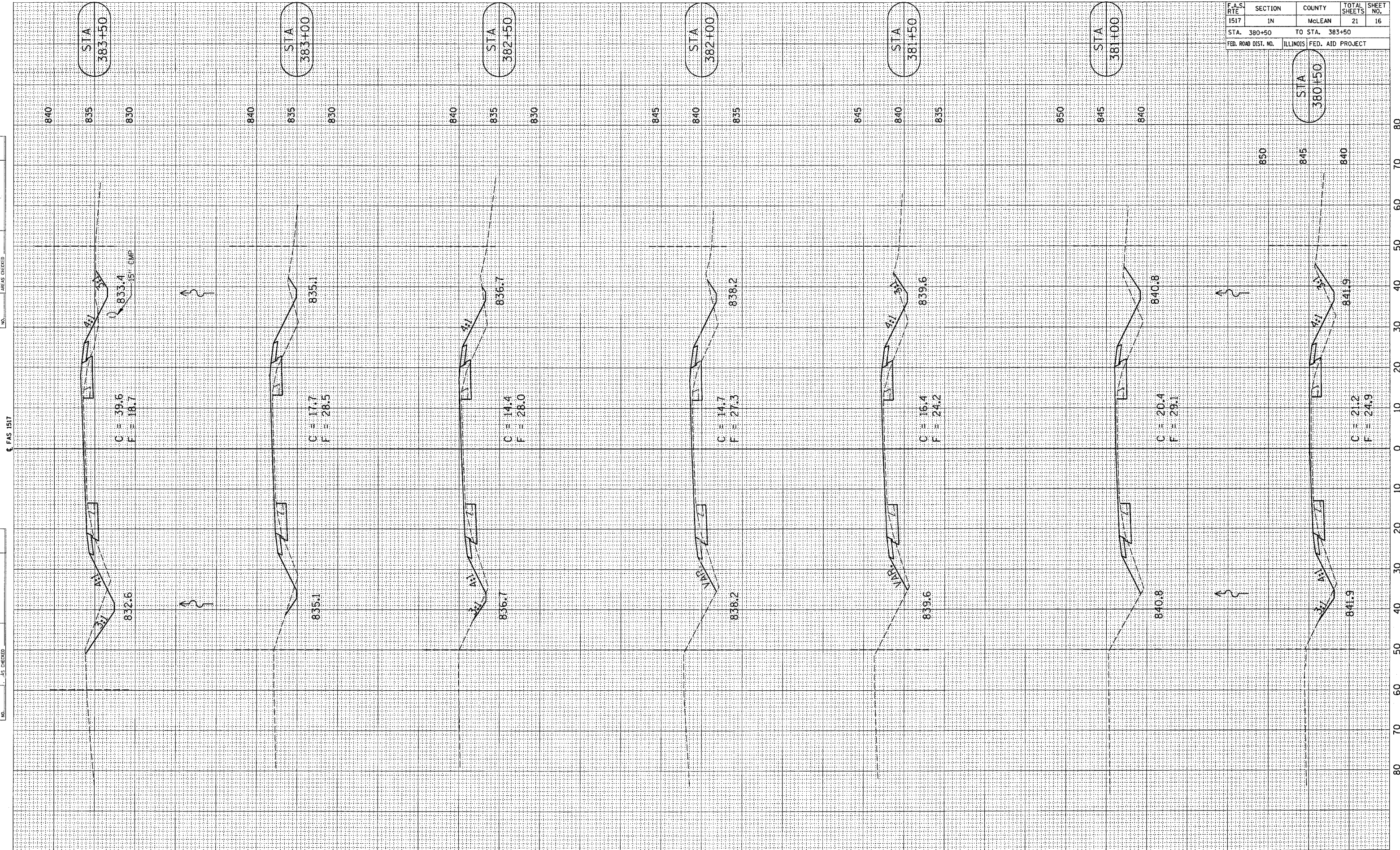

FAS 1517

DATE	BY
DATE	BY

SURVEYED
 FINAL SURVEY
 NOTE BOOK
 TEMPORARY AREAS
 AREAS CHECKED

DATE	BY
DATE	BY

ORIGINAL SURVEY
 NOTE BOOK
 AS CHECKED

F.A.S. RTE	SECTION	COUNTY	TOTAL SHEETS	SHEET NO.
1517	IN	McLEAN	21	17

STA. 383+71 TO STA. 386+50
FED. ROAD DIST. NO. ILLINOIS FED. AID PROJECT

BY	DATE

ORIGINAL SURVEY
DATE
NOTE BOOK
NO.

BY	DATE

FINAL SURVEY
DATE
NOTE BOOK
NO.

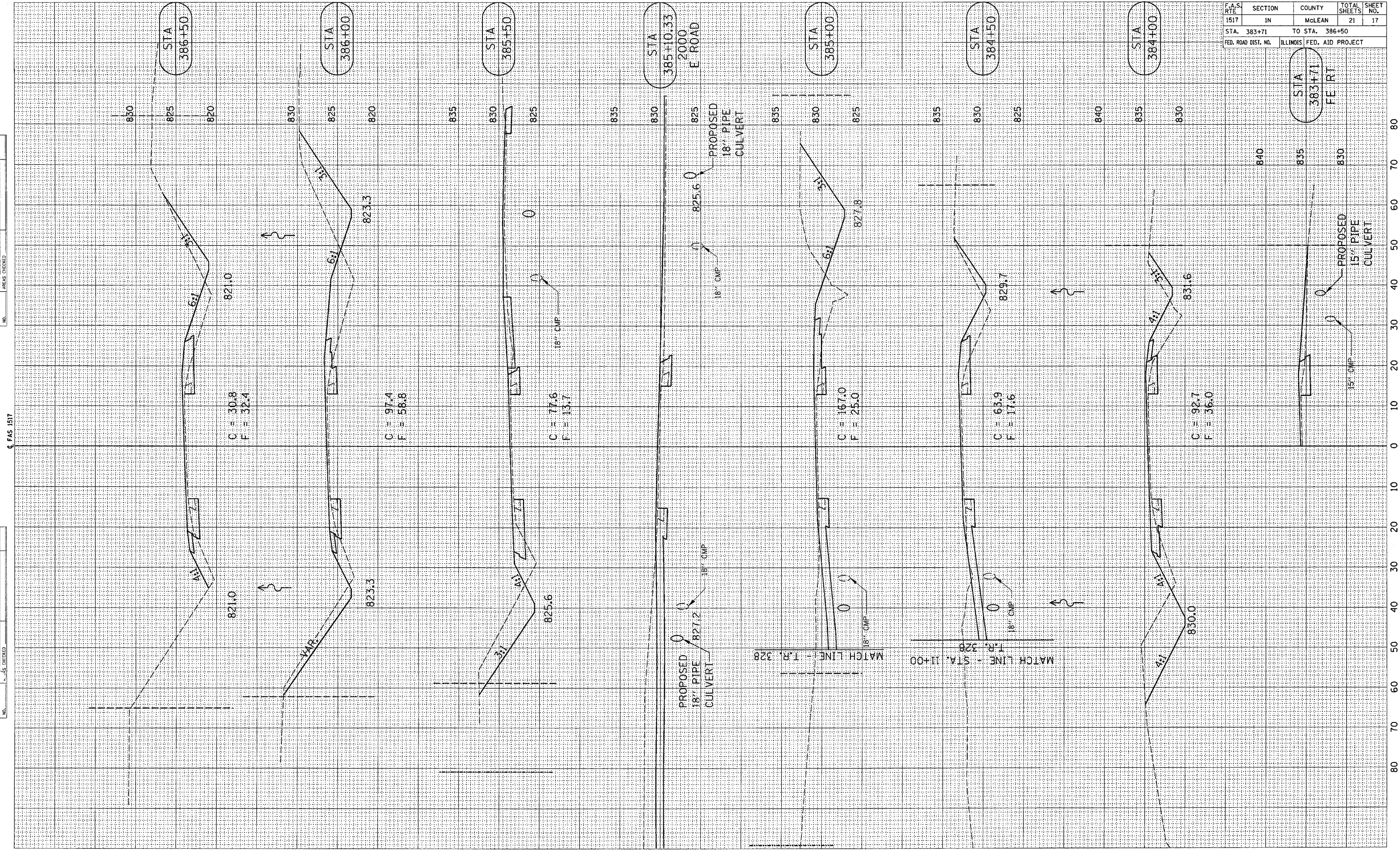

F.A.S. RTE	SECTION	COUNTY	TOTAL SHEETS	SHEET NO.
1517	IN	MCLEAN	21	18
STA. 387+00		TO STA. 390+00		
FED. ROAD DIST. NO.		ILLINOIS FED. AID PROJECT		

BY _____ DATE _____

FINAL SURVEY SURVEYED PLOTTED NOTE BOOK TEMPLATE NO. _____

NO. _____

AREAS CHECKED

BY _____ DATE _____

ORIGINAL SURVEY SURVEYED PLOTTED NOTE BOOK TEMPLATE NO. _____

NO. _____

CHECKED

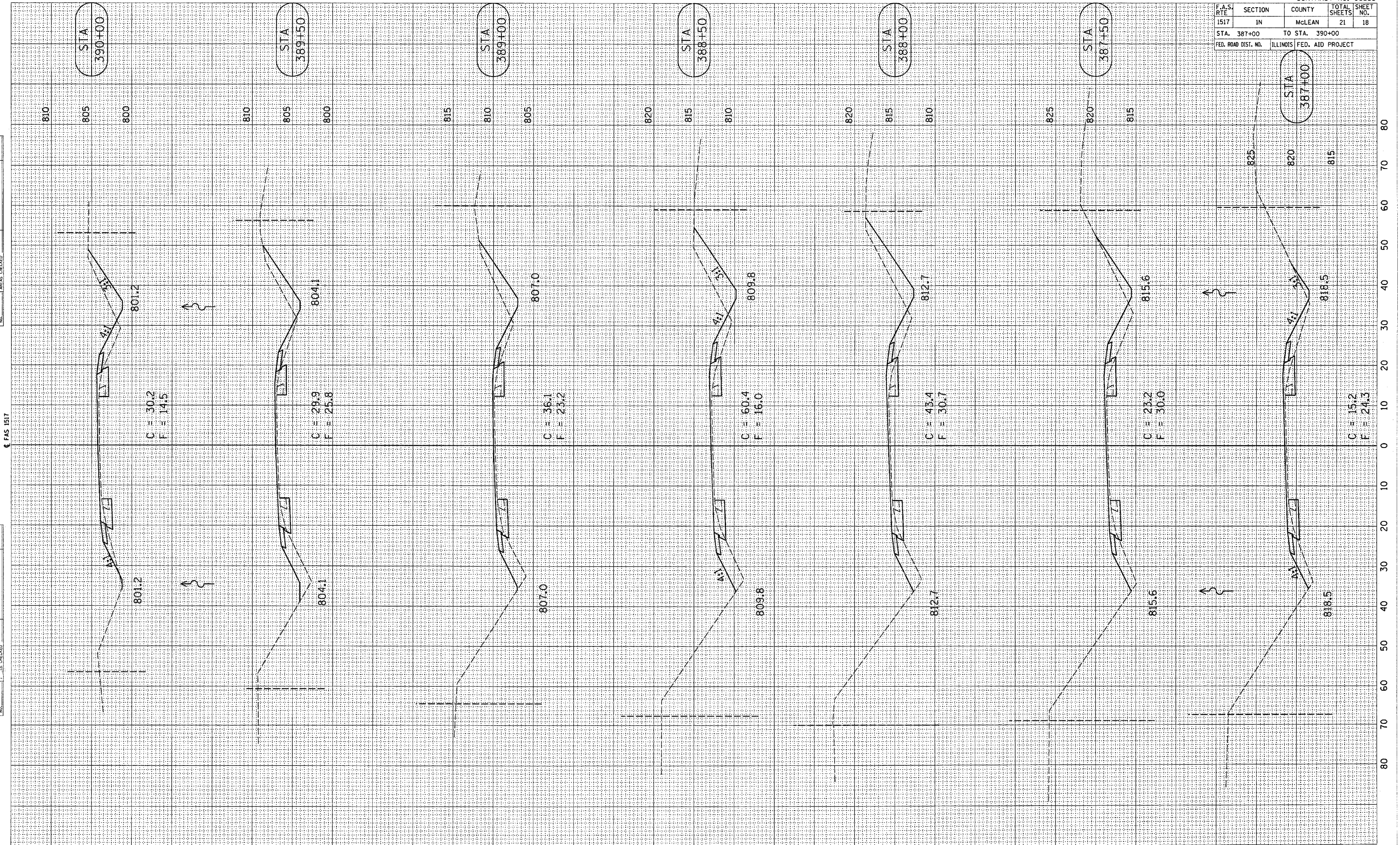

F.A.S. ROUTE 1517 CROSS SECTIONS

F.A.S. RTE	SECTION	COUNTY	TOTAL SHEETS	SHEET NO.
1517	IN	McLEAN	21	19
STA. 390+50		TO STA. 393+00		
FED. ROAD DIST. NO.		ILLINOIS FED. AID PROJECT		

DATE: _____ BY: _____
 SURVEYED: _____
 ORIGINAL SURVEY: _____
 NOTE BOOK: _____
 NO.: _____
 AREAS CHECKED: _____

DATE: _____ BY: _____
 SURVEYED: _____
 ORIGINAL SURVEY: _____
 NOTE BOOK: _____
 NO.: _____
 AREAS CHECKED: _____

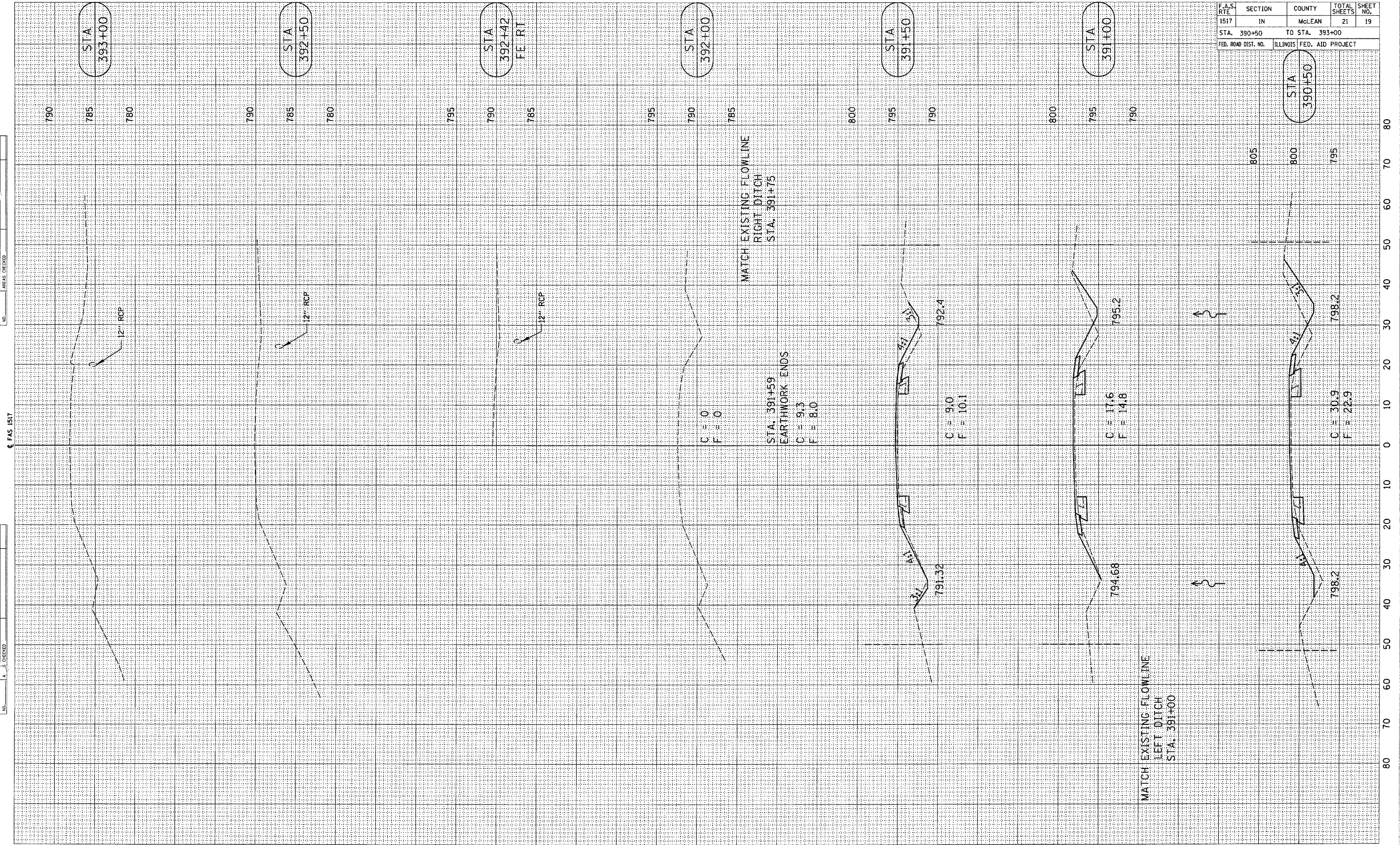

6 FAS 1517

F.A.S. RTE	SECTION	COUNTY	TOTAL SHEETS	SHEET NO.
1517	IN	McLEAN	21	20
STA. 5+00		TO STA. 10+00		
FED. ROAD DIST. NO.	ILLINOIS	FED. AID PROJECT		

BY _____ DATE _____

FINAL SURVEY SURVEYED _____
 NOTE BOOK _____
 AREAS CHECKED _____

BY _____ DATE _____

ORIGINAL SURVEY SURVEYED _____
 NOTE BOOK _____
 IS CHECKED _____

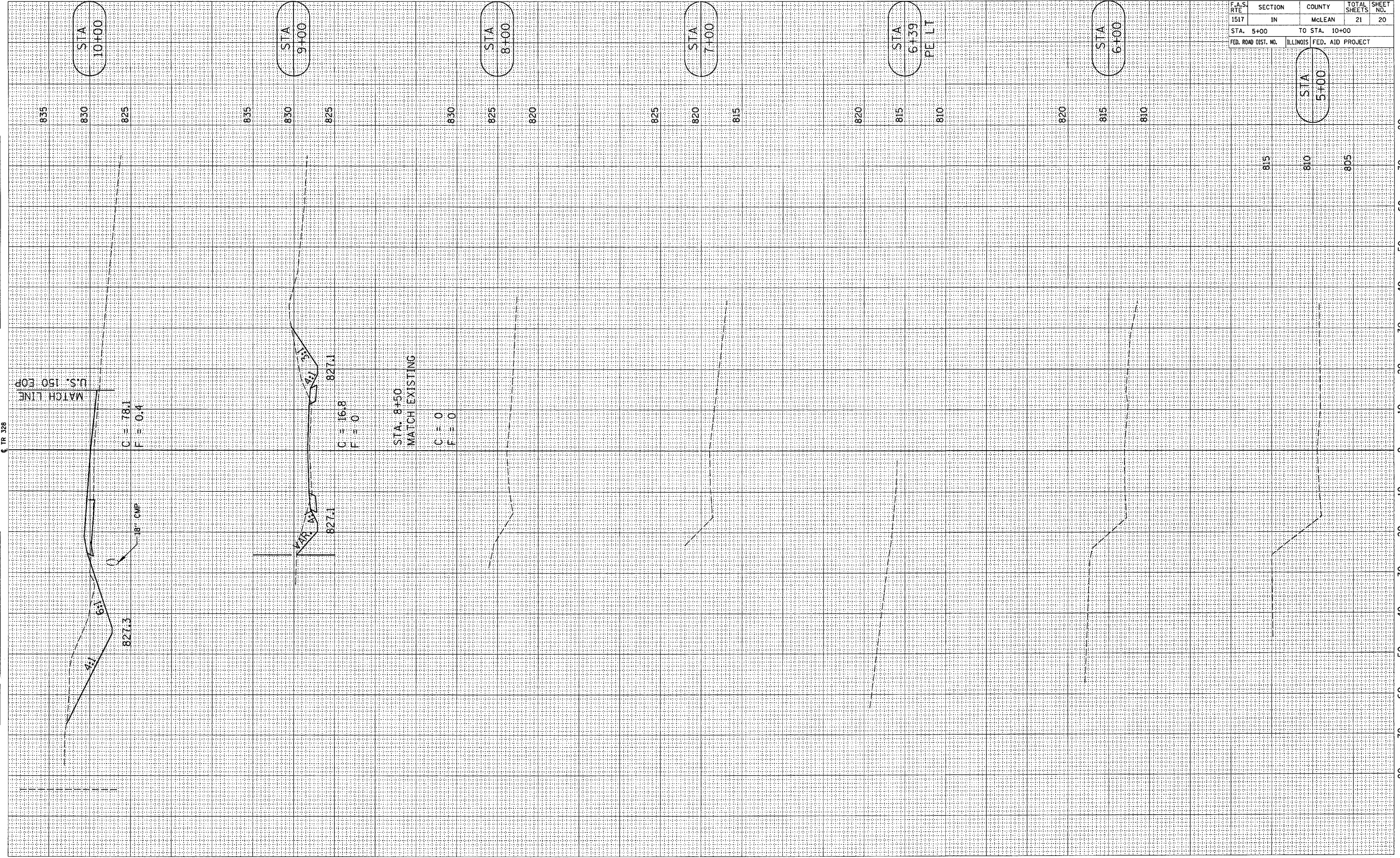

TR 328

F.A.S. DATE	SECTION	COUNTY	TOTAL SHEETS	SHEET NO.
1517	IN	McLEAN	21	21
STA. 10+91		TO STA. 15+00		
FED. ROAD DIST. NO.		ILLINOIS	FED. AID PROJECT	

DATE _____ BY _____
 SURVEYED _____
 ORIGINAL SURVEY _____
 NOTE BOOK _____
 NO. _____

DATE _____ BY _____
 SURVEYED _____
 ORIGINAL SURVEY _____
 NOTE BOOK _____
 NO. _____

