

F.A.P. RTE.	SECTION	COUNTY	TOTAL SHEETS	SHEET NO.
681	118 N	IROQUOIS	30	1

P-93-027-04
D-93-016-05

INDEX OF SHEETS

- 1 COVER SHEET
- 2 GENERAL NOTES, STANDARDS, INDEX OF SHEETS
- 3.-4. SUMMARY OF QUANTITIES
- 5.-6. SCHEDULES
- 7 TYPICAL SECTIONS
- 8 ALIGNMENT SHEET
- 9 EXISTING AND PROPOSED PLAN
- 10 INTERSECTION LAYOUT
- 11 DRAINAGE PLAN
- 12 PAVEMENT MARKING PLAN
- 13 EROSION CONTROL PLAN
- 14.-15. LIGHTING DETAIL PLAN
- 16 PROPOSED SIGNING PLAN
- 17 ISLAND PAVEMENT DETAIL
- 18 CAST IN PLACE WINGWALL DETAIL
- 19 CONCRETE COLLAR DETAIL
- 20 FIELD TILE DETAIL
- 21.-23. DETAILS
- 24.-30. CROSS-SECTIONS

STATE OF ILLINOIS
DEPARTMENT OF TRANSPORTATION
DIVISION OF HIGHWAYS
**PROPOSED
HIGHWAY PLANS**

FAP ROUTE 681 (US 45)
SECTION 118 N
PROJECT HS-0681(029)
IROQUOIS COUNTY

C-93-009-05

INTERSECTION RADIUS WIDENING AND CONVERSION
TO 4 WAY STOP WITH FLASHERS AND BEACON
WITH THE ADDITION OF HIGHWAY LIGHTING

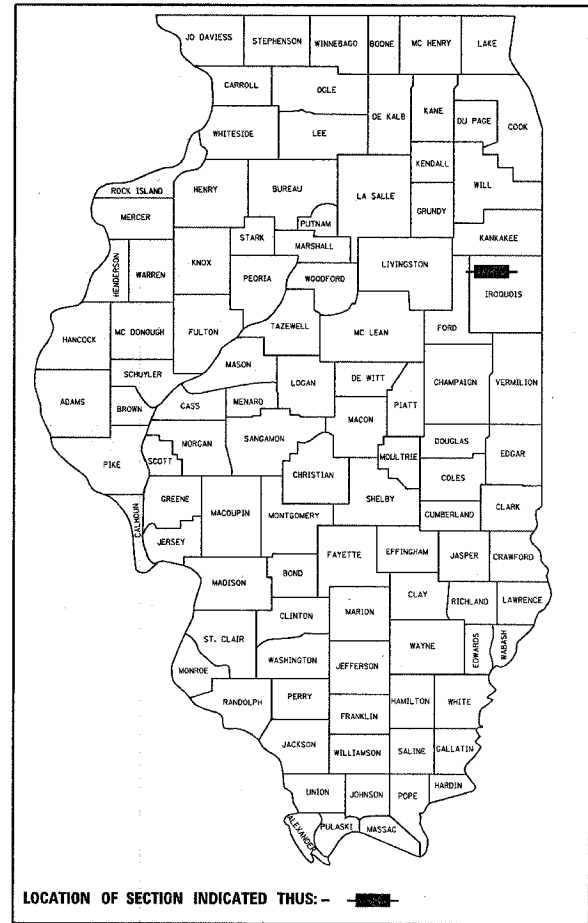

HIGHWAY CLASSIFICATION
RURAL MINOR ARTERIAL
ADT INFORMATION
YR 2005 = 3750
P.C. 86.6% S.U. 7.0% M.U. 6.4%
CLASS II TRUCK ROUTE

STATE OF ILLINOIS
DEPARTMENT OF TRANSPORTATION
DIVISION OF HIGHWAYS
SUBMITTED FEB 15 20 05
Shirley L. Mounts
DEPUTY DIRECTOR OF HIGHWAYS, REGION ENGINEER
March 25, 2005
Mike Nene
ENGINEER OF DESIGN AND ENVIRONMENT
March 25, 2005
Victoria Mader
DIRECTOR OF HIGHWAYS, CHIEF ENGINEER

**PRINTED BY THE AUTHORITY
OF THE STATE OF ILLINOIS**

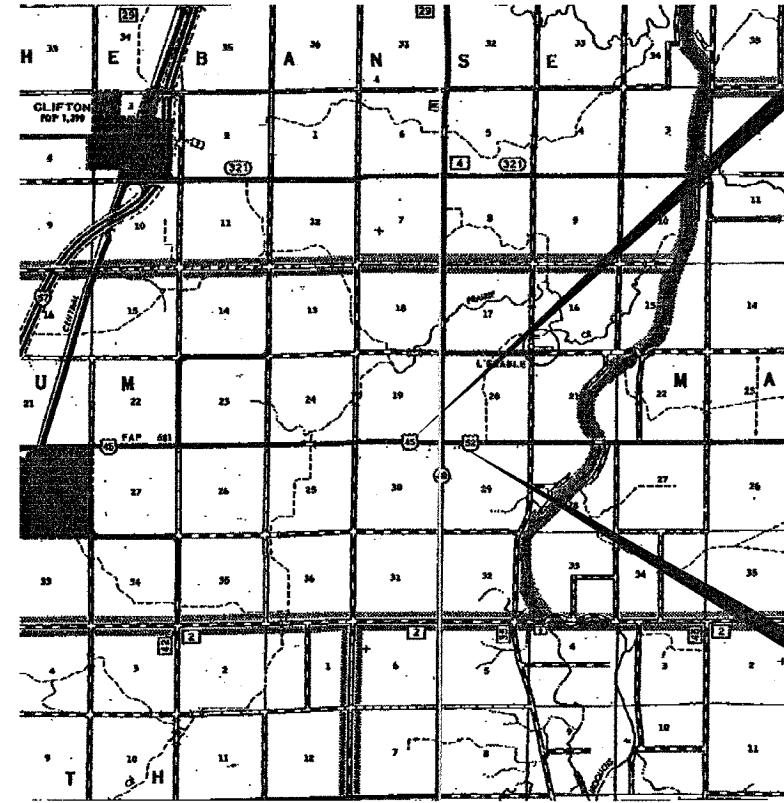

PROJECT BEGINS
STATION 240+00

PROJECT ENDS
STATION 244+00

NET AND GROSS LENGTH OF IMPROVEMENT = 1000 FT = .19 MI

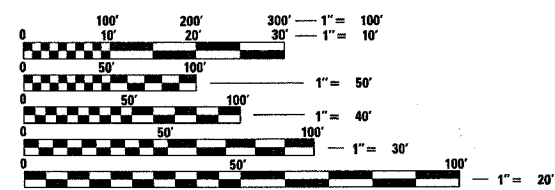

FULL SIZE PLANS HAVE BEEN PREPARED USING STANDARD
ENGINEERING SCALES. REDUCED SIZED PLANS WILL NOT
CONFORM TO STANDARD SCALES. IN MAKING MEASUREMENTS
ON REDUCED PLANS, THE ABOVE SCALES MAY BE USED.

J.U.L.I.E.
JOINT UTILITY LOCATION INFORMATION FOR EXCAVATION
1-800-892-0123

PROJECT ENGINEER: DAVE BROVIAK
SQUAD LEADER: SCOTT A FERGUSON

CONTRACT NO. 66534

2/10/2005 c:\pro\jects\ep02704\cover.sht.dgn