

F.A. RTE.	SECTION	COUNTY	TOTAL SHEETS	SHEET NO.
74	(72-71R-3)	PEORIA	1360	144
STA.		TO STA.		
FED. ROAD DIST. NO.		ILLINOIS	FED. AID PROJECT	

MAINTENANCE OF TRAFFIC STAGES

- STAGE 3-1
- STAGE 3-2 ← THIS STAGE
- STAGE 3-3
- STAGE 3-4

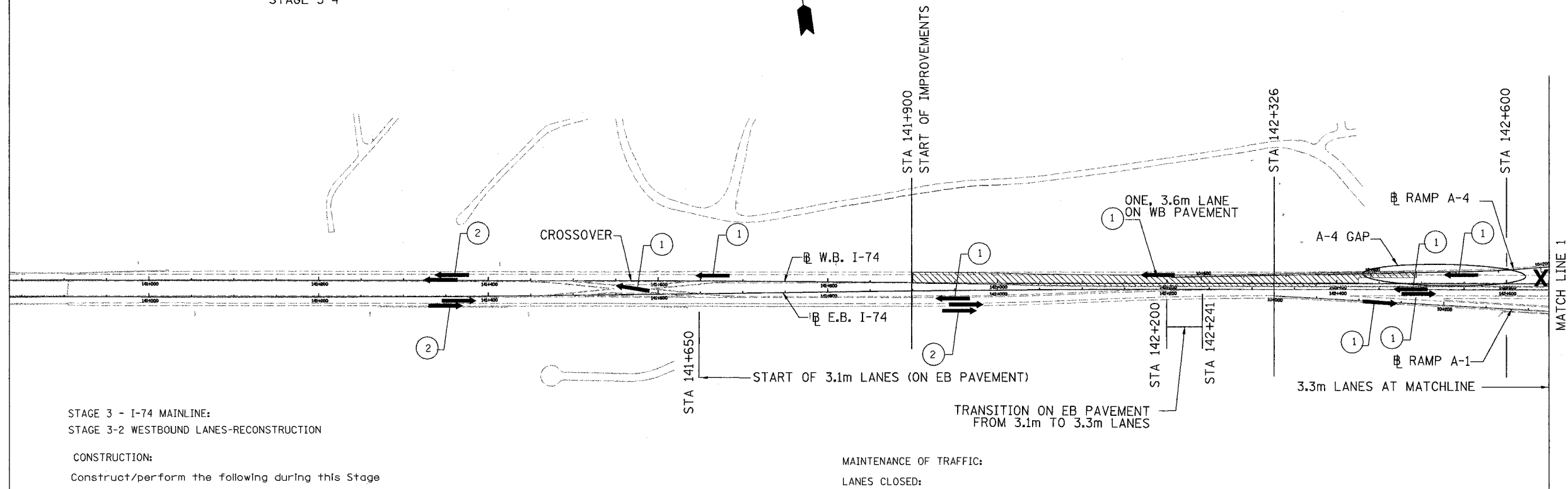

STAGE 3 - I-74 MAINLINE:
STAGE 3-2 WESTBOUND LANES-RECONSTRUCTION

CONSTRUCTION:

Construct/perform the following during this Stage

1. Start or continue the work described under #3 of the previous stage
2. The proposed westbound roadway and shoulder pavementS within the A-4 Gap, between Sta 142+326 and Sta 142+600.
3. The remaining portion of the ramp and ramp shoulder pavement for A-4 as indicated on the Proposed Roadway Plans.
4. Temporary pavement between existing Ramp A-4 and existing (or proposed) WB pavement, between Sta 142+640 to Sta 142+660, as shown on these Stage 3-2 MOT Plans.
5. Permanent pavement markings within completed sections of the WB and Ramp pavements.

MAINTENANCE OF TRAFFIC:

LANES CLOSED:

-Similar to STAGE 3-1 with exceptions as noted in the, LANES OPEN description.

LANES OPEN:

-Similar to STAGE 3-1 with addition of the westbound outside lane on the proposed & existing westbound pavement, between Sta. 141+450 and Sta. 142+200 for Ramp A-4 traffic use.

1. Maintain MOT of Stage 3-1 with exception around Ramp A-4.

2. Redirect the one lane of Ramp A-4 traffic along the ramp and westbound pavements, using substaging, and discontinue use of the connection to the eastbound pavement.

a. SubStage 1 - Place A-4 traffic on existing ramp and proposed westbound pavement (built in the previous stage), as shown in the Stage 3-2 Substage 1 MOT Plans (for construction of the WB lanes, WB outside shoulder and a temporary pavement connection between Ramp A-4 and the westbound pavement).

b. SubStage 2 - Place A-4 traffic on the temporary pavement (built in Substage 1) and the westbound pavement, as shown in the Stage 3-2 Substage 2 MOT Plans (for construction of the balance of the proposed ramp and shoulder pavement for A-4).

LEGEND

- TEMPORARY PAVEMENT
- CONSTRUCTION THIS STAGE
- CONSTRUCTED IN PRECEDING STAGES
- NUMBER OF TRAFFIC LANES DURING THIS STAGE
- DIRECTION OF TRAFFIC
- LANE CLOSED

NOTE:

MOT LEGEND & PLAN DEPICT ITEMS TO BE CONSTRUCTED PER STAGE. REMOVALS TO FACILITATE CONSTRUCTION MAY NOT BE INDICATED, BUT THEY ARE IMPLIED. REMOVALS OF EXISTING ITEMS ARE INDICATED IN THE EXISTING ROADWAY PLANS.

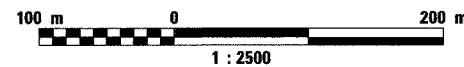

REVISIONS	
NAME	DATE

ILLINOIS DEPARTMENT OF TRANSPORTATION
MAINTENANCE OF TRAFFIC
FAI ROUTE 74 (I-74 WB)
SCHEMATIC
STAGE 3-2

DATE 11/12/04
DRAWN BY CADD
CHECKED BY KJW

