

F.A. RTE.	SECTION	COUNTY	TOTAL SHEETS	SHEET NO.
74	(72-7)R-3	PEORIA	1360	253
STA. 39+500.000		TO STA. 39+850.000		
FED. ROAD DIST. NO.	ILLINOIS	FED. AID PROJECT		

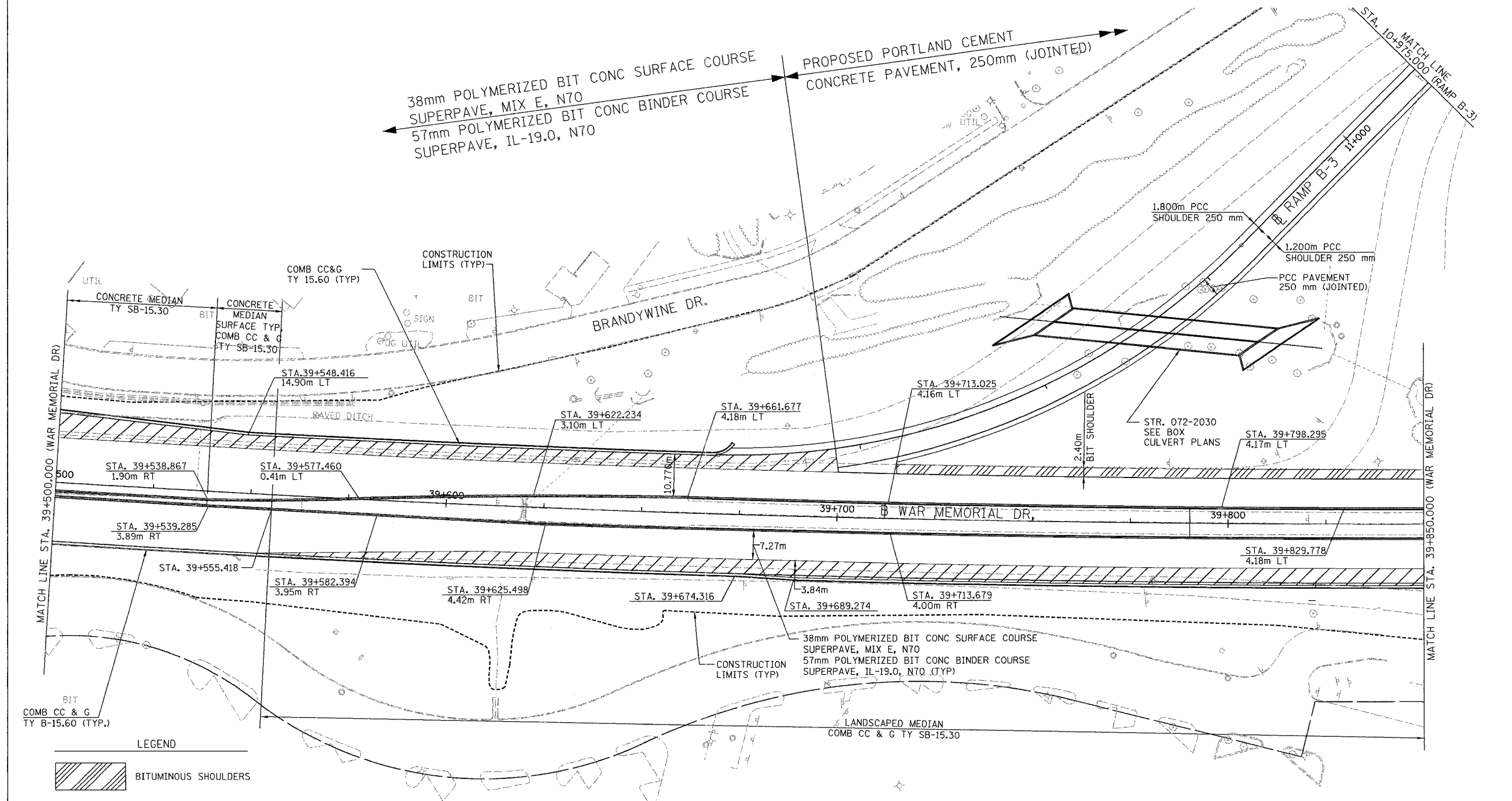
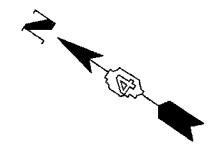

MATCH LINE STA. 39+500.000 (WAR MEMORIAL DR)

MATCH LINE STA. 39+850.000 (WAR MEMORIAL DR)

LEGEND

	BITUMINOUS SHOULDERS
	PAVEMENT WIDENING

NOTE:  
1. SEE INTERSECTION DETAIL SHEETS.

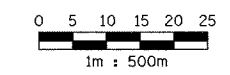

**PARSONS**  
TRANSPORTATION GROUP  
Engineers and Planners

REVISIONS	
NAME	DATE

ILLINOIS DEPARTMENT OF TRANSPORTATION  
**PROPOSED ROADWAY PLAN**  
WAR MEMORIAL DRIVE  
STA. 39+500.000 - STA. 39+850.000  
DRAWN BY CADD  
CHECKED BY KJW  
DATE 11/12/04