

F.A. RTE.	SECTION	COUNTY	TOTAL SHEETS	SHEET NO.
74	(72-7)R-3	PEORIA	1360	302
STA. 38+965.067		TO STA. 39+150.000		
FED. ROAD DIST. NO.		ILLINOIS FED. AID PROJECT		

LEGEND

EXISTING	PROPOSED	
○	○	INLET
○	○	MANHOLE
○	○	CATCH BASIN
↕	↕	SAG
↕	↕	SUMMIT
→	→	STORM SEWER FLOW DIRECTION
→	→	DITCH FLOW DIRECTION
→	→	DITCH CHECK
▭	▭	RIPRAP
—	—	PIPE UNDERDRAIN
—	—	STORM SEWER
---	---	DITCH PROFILE LINE
---	---	PIPE CULVERTS
---	---	GRADING AND SHAPING DITCHES
---	---	PAVED DITCH
---	---	HEADWALL
---	---	PRECAST REINFORCED CONC. END SECTION
—OHP—		ELECTRICAL OVERHEAD
—W—		WATER
—G—		GAS
—T—		TELEPHONE
→	→	SANITARY SEWER

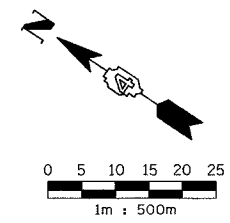
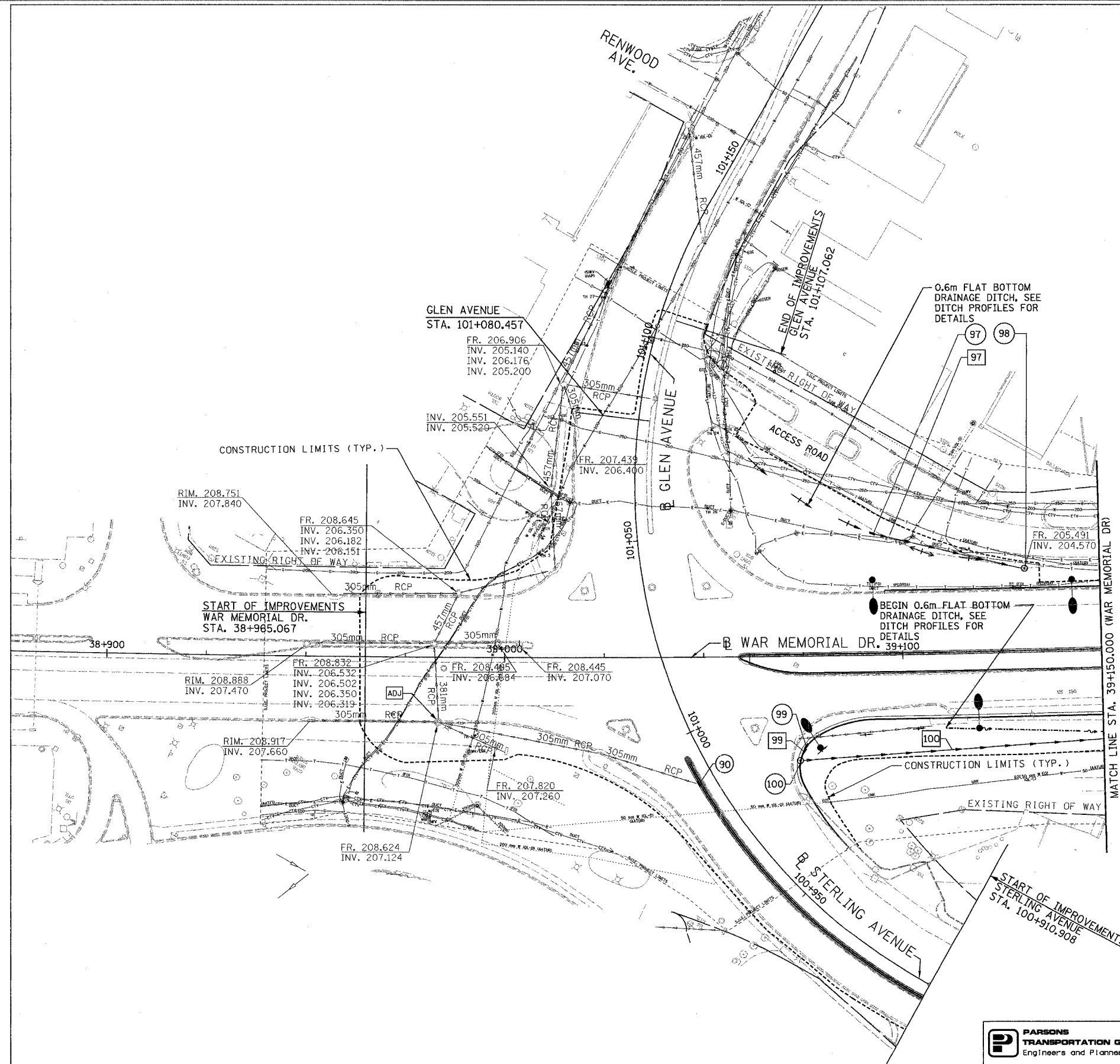

REVISIONS	
NAME	DATE

ILLINOIS DEPARTMENT OF TRANSPORTATION
DRAINAGE AND UTILITY PLAN
 WAR MEMORIAL DRIVE
 STA. 38+965.067 - STA. 39+150.000
 DRAWN BY CADD
 CHECKED BY KJW
 DATE 11/12/04

