

F.A. RTE.	SECTION	COUNTY	TOTAL SHEETS	SHEET NO.
74	(72-71R-3)	PEORIA	1360	407
STA.		TO STA.		
FED. ROAD DIST. NO.		ILLINOIS FED. AID PROJECT		

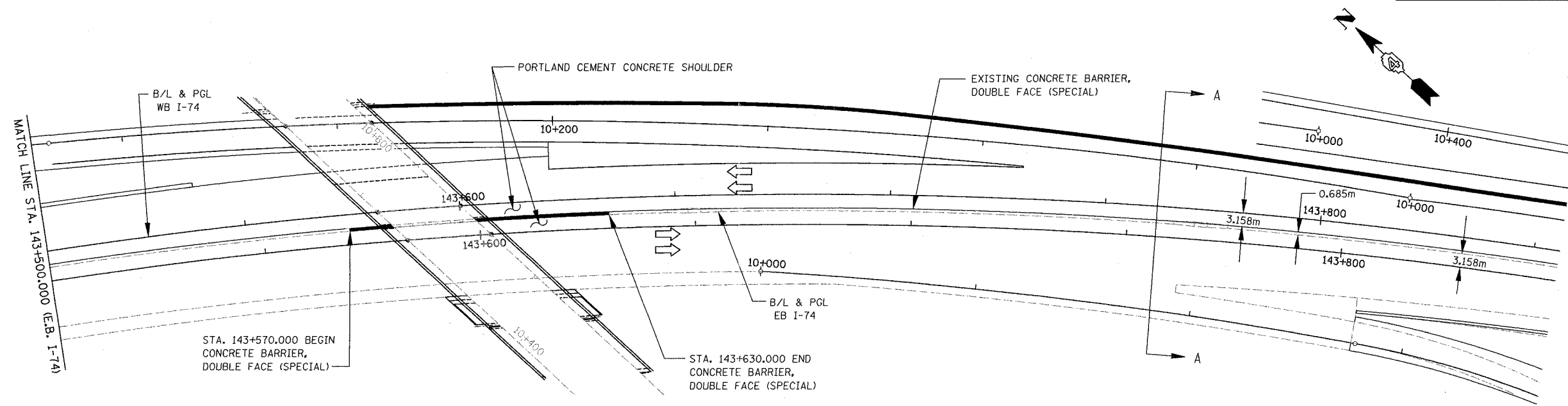

I-74 WB STATION	ELEVATIONS					I-74 EB STATION
	5	4	3	2	1	
143+574.159	190.759	190.623	191.976	190.681	190.798	143+570.000
143+579.189	190.712	190.576	191.929	190.634	190.751	143+575.000
143+584.219	190.665	190.529	191.882	190.587	190.704	143+580.000
143+589.249	190.618	190.482	191.836	190.541	190.658	143+585.000
143+594.279	190.571	190.435	191.789	190.494	190.611	143+590.000
143+599.309	190.524	190.388	191.742	190.447	190.564	143+595.000
143+604.339	190.477	190.341	191.696	190.401	190.517	143+600.000
143+609.369	190.430	190.294	191.649	190.354	190.471	143+605.000
143+614.399	190.383	190.247	191.602	190.307	190.424	143+610.000
143+619.429	190.336	190.200	191.556	190.261	190.377	143+615.000
143+624.459	190.289	190.153	191.509	190.214	190.331	143+620.000
143+629.489	190.242	190.106	191.462	190.167	190.284	143+625.000
143+634.519	190.195	190.059	191.415	190.120	190.237	143+630.000
143+639.550	190.148	190.012	191.369	190.074	190.191	143+635.000
143+644.580	190.101	189.965	191.322	190.027	190.144	143+640.000
143+649.610	190.054	189.918	191.275	189.980	190.097	143+645.000
143+654.640	190.007	189.871	191.229	189.934	190.050	143+650.000
143+659.670	189.960	189.824	191.182	189.887	190.004	143+655.000
143+664.700	189.913	189.777	191.135	189.840	189.957	143+660.000
143+669.730	189.866	189.731	191.089	189.794	189.910	143+665.000
143+674.760	189.819	189.684	191.042	189.747	189.864	143+670.000
143+679.790	189.772	189.637	190.995	189.700	189.817	143+675.000
143+684.820	189.725	189.590	190.948	189.653	189.770	143+680.000
143+689.850	189.678	189.543	190.902	189.607	189.724	143+685.000
143+694.880	189.631	189.496	190.855	189.560	189.677	143+690.000
143+699.910	189.584	189.449	190.808	189.513	189.630	143+695.000
143+704.940	189.537	189.402	190.762	189.467	189.583	143+700.000

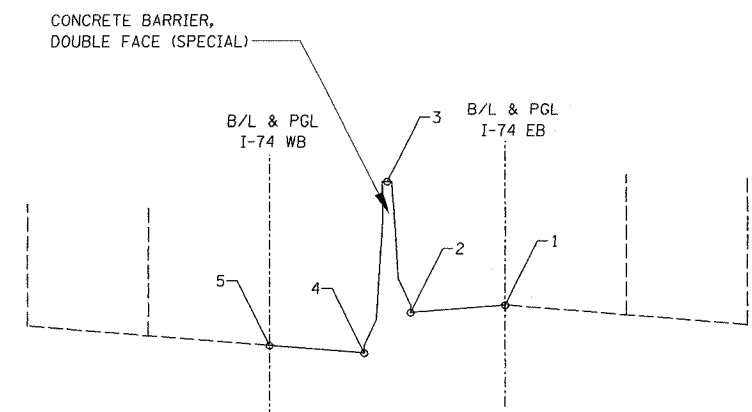

SECTION A - A

- NOTES:
1. BARRIER BASE WIDTH EQUALS 0.685m
  2. BARRIER HEIGHT EQUALS 1.295m ON HIGH SIDE OF SHOULDER. ON LOW SIDE OF SHOULDER, HEIGHT EQUALS DIFFERENCE BETWEEN SHOULDER ELEVATION AND TOP OF BARRIER ELEVATION.
  3. BARRIER ON LOW SIDE OF SHOULDER RETAINS GM-SHAPE TO 1.295m HIGH THEN PROVIDES VERTICAL FACE TO ACHIEVE REQUIRED HEIGHT. SEE CONCRETE BARRIER, DOUBLE FACE (SPECIAL) DETAIL.

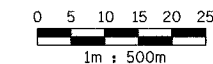

REVISIONS	
NAME	DATE

ILLINOIS DEPARTMENT OF TRANSPORTATION  
**CONCRETE BARRIER ELEVATIONS**  
 FAI ROUTE 74 (I-74) (WB)  
 STA. 143+500.000 - STA. 143+850.000



DRAWN BY CADD  
 CHECKED BY MWP  
 DATE 11/12/04