

F.A. RTE.	SECTION	COUNTY	TOTAL SHEETS NO.	SHEET NO.
74	(72-73R-3)	PEORIA	1360	713
STA. TO STA.		ILLINOIS FED. AID PROJECT		

THE LOCATIONS OF EXISTING WATER MAINS, GAS MAINS, SEWERS, ELECTRIC POWER LINES, TELEPHONE LINES AND OTHER UTILITIES AS SHOWN ON THE PLANS ARE BASED ON CAREFUL FIELD INVESTIGATION AND THE BEST INFORMATION AVAILABLE, BUT THEY ARE NOT GUARANTEED, UNLESS ELEVATIONS ARE SHOWN. --- ALL UTILITY LOCATIONS SHOWN ON THE CROSS SECTIONS ARE BASED ON THE APPROXIMATE DEPTH SUPPLIED BY THE UTILITY COMPANY. IT SHALL BE THE CONTRACTOR'S RESPONSIBILITY TO ASCERTAIN THEIR EXACT LOCATION FROM THE UTILITY COMPANIES AND BY FIELD INSPECTION.

PROPOSED UTILITY RELOCATIONS ARE NOT SHOWN ON THE CROSS SECTIONS. SEE THE PROPOSED DRAINAGE & UTILITY PLANS AND UTILITY PERMITS/AGREEMENTS FOR LOCATION OF PROPOSED UTILITIES, ACTUAL FIELD LOCATION MAY VARY FROM PLANS.

NOTE:
THE RAMP PORTIONS OF ADJACENT RAMP ARE INCLUDED FOR CONVENIENCE. SEE RESPECTIVE CROSS SECTIONS FOR FULL SECTIONAL VIEWS OF THE RAMP.

DATE	BY

DESIGNED BY: _____
 CHECKED BY: _____
 DRAWN BY: _____
 DATE: _____

PROFESSIONAL TRANSMITTALION ENGINEER
 ENGINEERS AND ARCHITECTS

DATE	BY

DESIGNED BY: _____
 CHECKED BY: _____
 DRAWN BY: _____
 DATE: _____

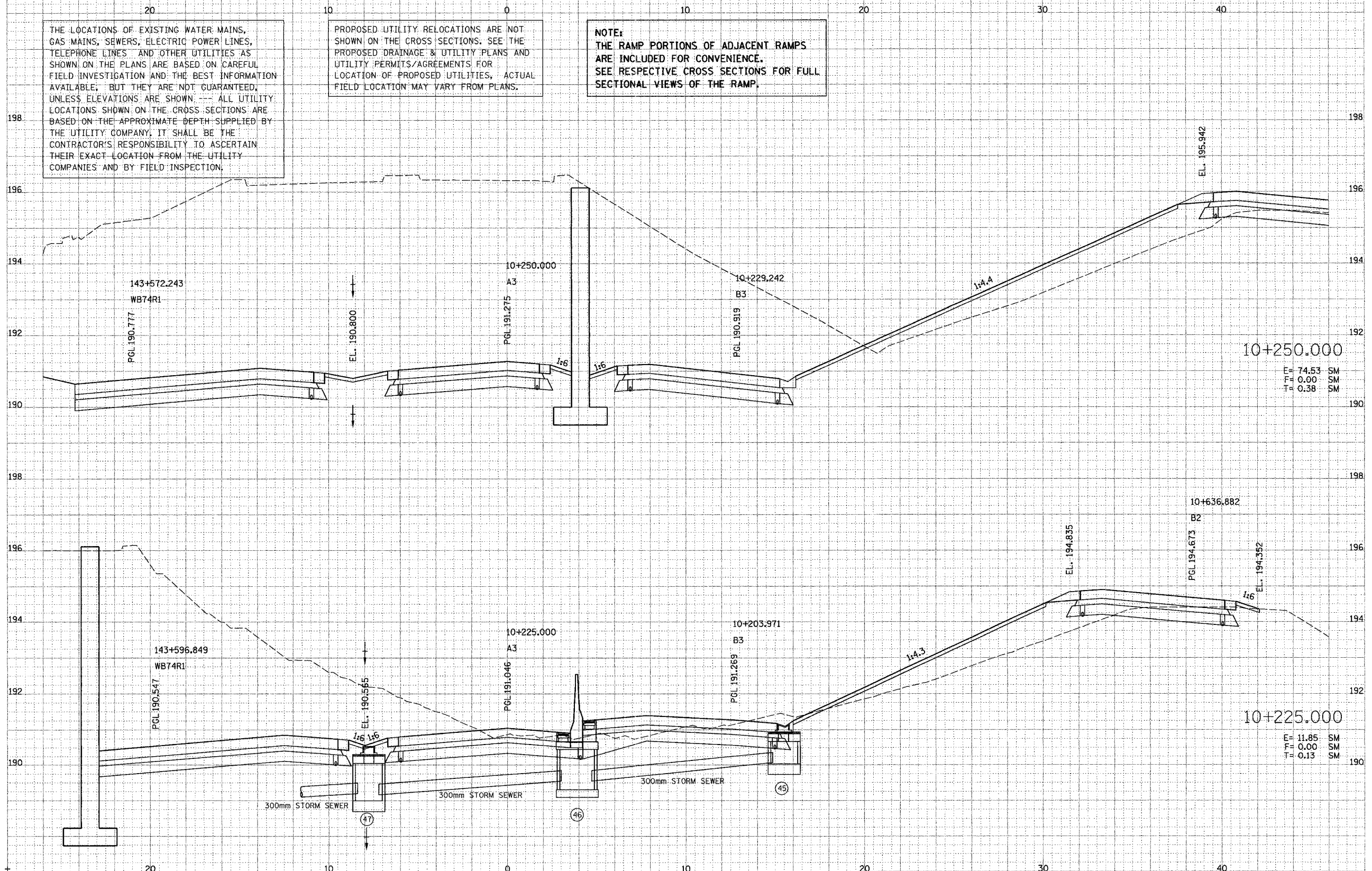

RAMP-A3