

F.A. RTE.	SECTION	COUNTY	TOTAL SHEETS	SHEET NO.
74	(72-TX-3)	PEORIA	1260	815
STA.		TO STA.		
FED. ROAD DIST. NO.		ILLINOIS FED. AID PROJECT		

DATE	
BY	
CHECKED	
DESIGNED	
PLANNED	
APPROVED	

JAMES B. TRANSGURATION, P.E.
 ENGINEERS and PLANNERS

DATE	
BY	
CHECKED	
DESIGNED	
PLANNED	
APPROVED	

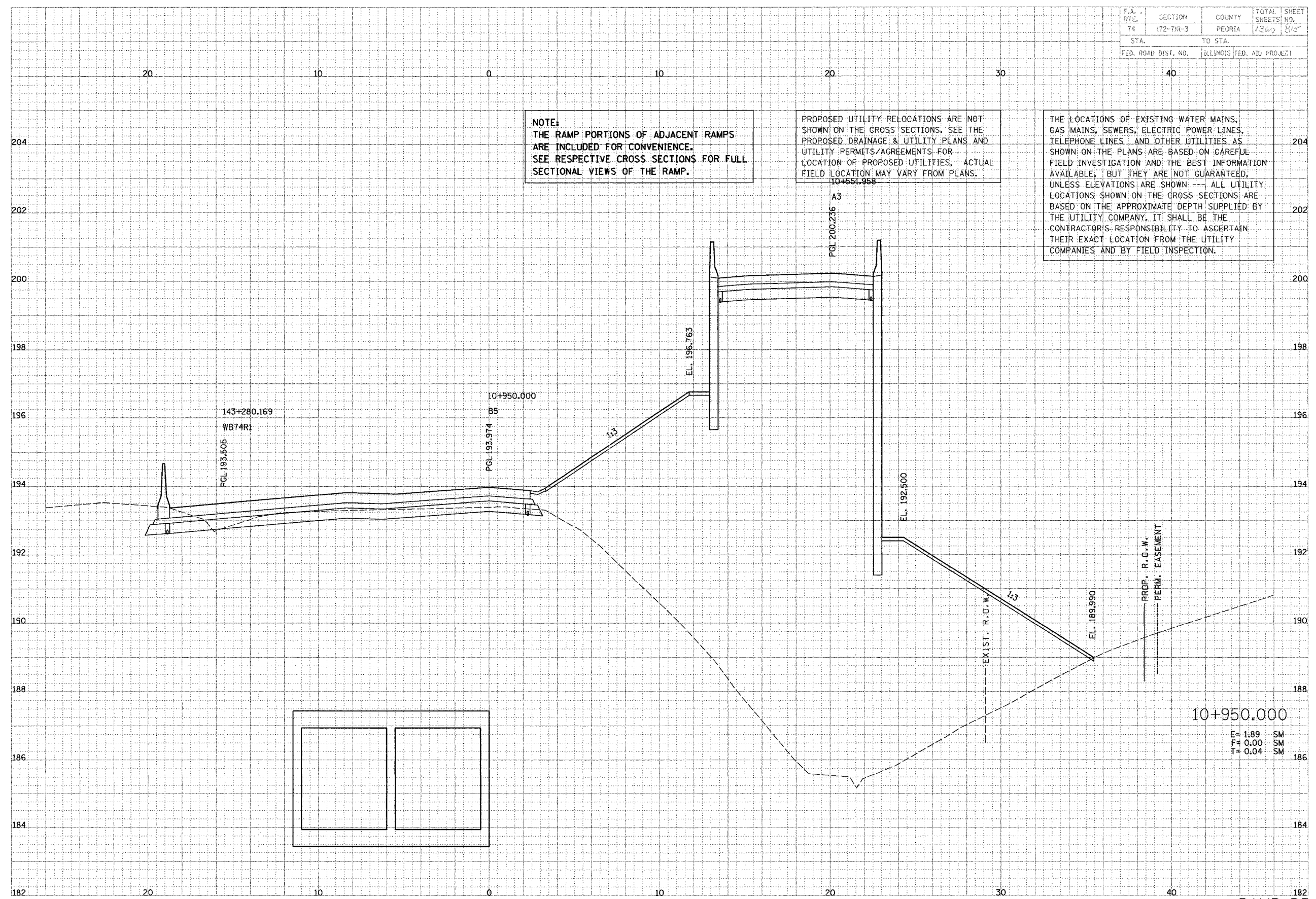

NOTE:
 THE RAMP PORTIONS OF ADJACENT RAMP
 ARE INCLUDED FOR CONVENIENCE.
 SEE RESPECTIVE CROSS SECTIONS FOR FULL
 SECTIONAL VIEWS OF THE RAMP.

PROPOSED UTILITY RELOCATIONS ARE NOT
 SHOWN ON THE CROSS SECTIONS. SEE THE
 PROPOSED DRAINAGE & UTILITY PLANS AND
 UTILITY PERMITS/AGREEMENTS FOR
 LOCATION OF PROPOSED UTILITIES. ACTUAL
 FIELD LOCATION MAY VARY FROM PLANS.

THE LOCATIONS OF EXISTING WATER MAINS,
 GAS MAINS, SEWERS, ELECTRIC POWER LINES,
 TELEPHONE LINES AND OTHER UTILITIES AS
 SHOWN ON THE PLANS ARE BASED ON CAREFUL
 FIELD INVESTIGATION AND THE BEST INFORMATION
 AVAILABLE, BUT THEY ARE NOT GUARANTEED,
 UNLESS ELEVATIONS ARE SHOWN. ALL UTILITY
 LOCATIONS SHOWN ON THE CROSS SECTIONS ARE
 BASED ON THE APPROXIMATE DEPTH SUPPLIED BY
 THE UTILITY COMPANY. IT SHALL BE THE
 CONTRACTOR'S RESPONSIBILITY TO ASCERTAIN
 THEIR EXACT LOCATION FROM THE UTILITY
 COMPANIES AND BY FIELD INSPECTION.

10+950.000
 E = 1.89 SM
 F = 0.00 SM
 T = 0.04 SM