

F.A.I. RTE.	SECTION	COUNTY	TOTAL SHEETS	SHEET NO.
74	(12-71R-3	PEORIA	1360	713
STA. 144+718		TO STA. 145+050		
FED. ROAD DIST. NO.		ILLINOIS FED. AID PROJECT		

TRAFFIC CONTROL	
HIGHWAY STANDARD	701400
HIGHWAY STANDARD	701401
HIGHWAY STANDARD	701406
HIGHWAY STANDARD	701411
HIGHWAY STANDARD	701426
HIGHWAY STANDARD	701446
HIGHWAY STANDARD	702001
PROJECT STANDARD	701403 174

- NOTES:
1. ALL REQUIRED PAVEMENT MARKINGS MUST BE IN PLACE PRIOR TO SHIFTING TRAFFIC.
 2. SEE DESIGN SECTION 1 MAINTENANCE OF TRAFFIC PLANS FOR ADDITIONAL INFORMATION REGARDING ADVANCED SIGNING REQUIRED FOR LANE CLOSURES ALONG THE WESTBOUND LANES NORTH OF DESIGN SECTION 2.

MAINTENANCE OF TRAFFIC LEGEND

WORK ZONE	EX TEMPORARY CONCRETE BARRIER
TRAFFIC FLOW DIRECTION	PR TEMPORARY CONCRETE BARRIER
LANE(S) CLOSED	VERTICAL PANEL
ARROW BOARD	BARRICADE TYPE I OR TYPE II OR DRUM
DRUM WITH STEADY BURNING MONODIRECTIONAL LIGHT	SIGN
TYPE III BARRICADE WITH FLASHING LIGHT	CONSTRUCTION SPEED LIMIT SIGN
TYPE III BARRICADE	FLAGGER WITH TRAFFIC CONTROL SIGN
	BARRICADE OR DRUM WITH STEADY BURNING MONODIRECTIONAL LIGHT
	BARRICADE OR DRUM WITH FLASHING LIGHT

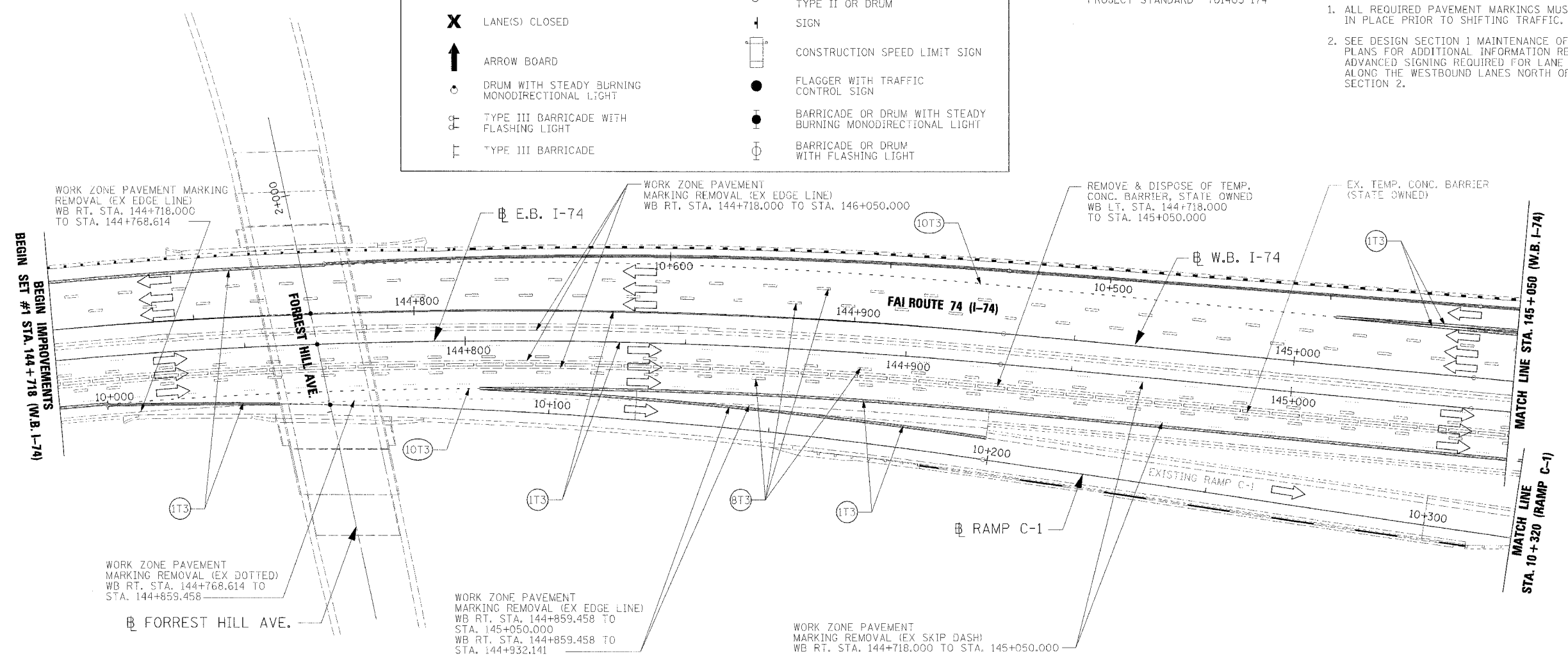

- (T3) 100 mm SOLID, PAVEMENT MARKING TAPE, TYPE III (WHITE)
WB LT. STA. 144+718.000 TO STA. 145+050.000
WB RT. STA. 144+718.000 TO STA. 144+768.614
WB RT. STA. 144+814.836 TO STA. 145+050.000
WB RT. STA. 144+814.836 TO STA. 144+932.141
WB LT. STA. 145+008.626 TO STA. 145+050.000
WB LT. STA. 145+008.626 TO STA. 145+050.000
- (T3) 100 mm SOLID, PAVEMENT MARKING TAPE, TYPE III (YELLOW)
WB STA. 144+718.000 TO STA. 145+050.000
WB RT. STA. 144+718.000 TO STA. 145+050.000
- (T33) 150 mm SKIP DASH, PAVEMENT MARKING TAPE, TYPE III (WHITE)
WB LT. STA. 144+718.000 TO STA. 145+050.000
WB LT. STA. 144+718.000 TO STA. 145+050.000
WB RT. STA. 144+718.000 TO STA. 145+050.000
WB RT. STA. 144+718.000 TO STA. 145+050.000
- (T33) 200 mm DOTTED, PAVEMENT MARKING TAPE, TYPE III (WHITE)
WB RT. STA. 144+729.058 TO STA. 144+814.836
WB LT. STA. 144+780.039 TO STA. 145+008.626

PAVEMENT MARKING LEGEND

(1X)	100 (4) SOLID
(2X)	150 (6) SOLID
(3X)	200 (8) SOLID
(4X)	300 (12) SOLID
(5X)	600 (24) SOLID
(6X)	100 (4) DOUBLE SOLID
(7X)	100 (4) SKIP DASH
(8X)	150 (6) SKIP DASH
(9X)	200 (8) SKIP DASH
(10X)	200 (8) DOTTED
(11X)	LETTERS AND ARROWS

RAISED REFLECTIVE PAVEMENT MARKERS

1	< ONE-WAY CRYSTAL MARKER AT 24.38 m(80') CENTERS
2	< ONE-WAY CRYSTAL MARKER AT 12.19 m(40') CENTERS
3	< ONE-WAY CRYSTAL MARKER AT 6.10 m(20') CENTERS
4	< ONE-WAY AMBER MARKER AT 12.19 m(40') CENTERS
5	< TWO-WAY AMBER MARKER AT 12.19 m(40') CENTERS FOR SPEEDS LESS THAN 45 MPH
6	< TWO-WAY AMBER MARKER AT 24.38 m(80') CENTERS FOR SPEEDS GREATER THAN 45 MPH

WHERE "X" DESIGNATES:

E = EPOXY	== WHITE
P = PAINT	== YELLOW
T = THERMOPLASTIC	
U = POLYUREA	
TP = TEMPORARY PAVEMENT MARKING	
T3 = PAVEMENT MARKING TAPE, TYPE III	
W3 = WET TEMPORARY PAVEMENT MARKING TAPE, TYPE III	

All dimensions are in millimeters (inches) unless otherwise shown.

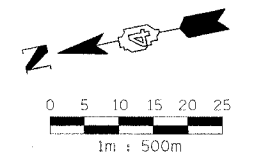

REVISIONS	
NAME	DATE



ILLINOIS DEPARTMENT OF TRANSPORTATION

MAINTENANCE OF TRAFFIC
STAGE 3-4
WB STA. 144+718 - STA. 145+050

DATE 11/23/04

DRAWN BY RBY
CHECKED BY LSA