

F.A.I. RTE.	SECTION	COUNTY	TOTAL SHEETS	SHEET NO.
74	(72-7)R-3	PEORIA	1360	769
STA. 145+050		TO STA. 145+390		
FED. ROAD DIST. NO.		ILLINOIS FED. AID PROJECT		

NOTES:

1. SEE PERMANENT SIGNING PLANS FOR ADDITIONAL INFORMATION.
2. SEE APPLICABLE MAINTENANCE OF TRAFFIC STANDARDS FOR ADDITIONAL SIGNING REQUIREMENTS.
3. ALL PERMANENT SIGNING FOR WB I-74 SHALL BE INSTALLED PRIOR TO SHIFTING TRAFFIC AT THE CONCLUSION OF STAGE 3-4.

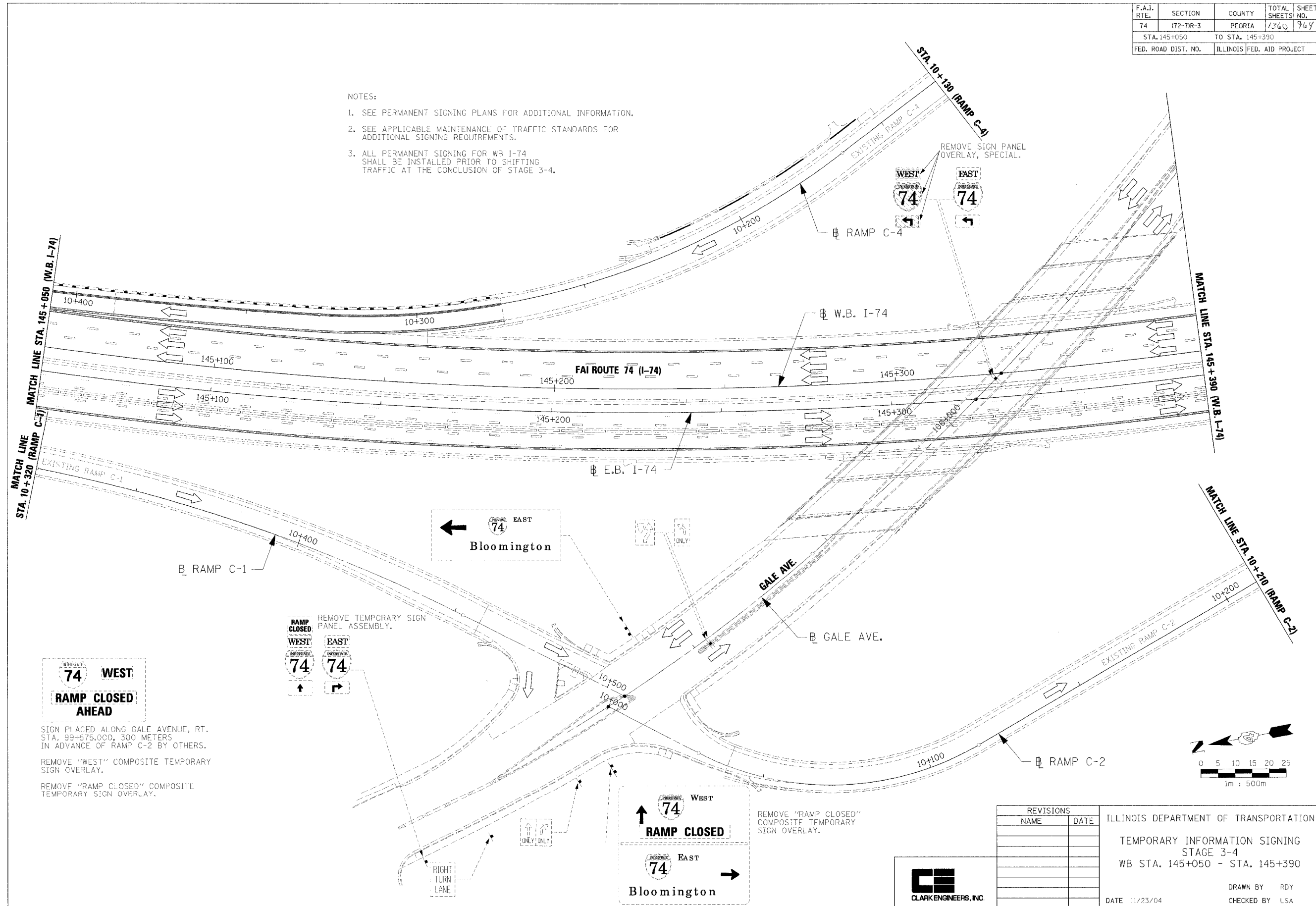

WEST
RAMP CLOSED AHEAD

SIGN PLACED ALONG GALE AVENUE, RT. STA. 99+575.000, 300 METERS IN ADVANCE OF RAMP C-2 BY OTHERS.

REMOVE "WEST" COMPOSITE TEMPORARY SIGN OVERLAY.

REMOVE "RAMP CLOSED" COMPOSITE TEMPORARY SIGN OVERLAY.

RAMP CLOSED
WEST
74
EAST
74

REMOVE TEMPORARY SIGN PANEL ASSEMBLY.

WEST
74
RAMP CLOSED
EAST
74
Bloomington

REMOVE "RAMP CLOSED" COMPOSITE TEMPORARY SIGN OVERLAY.

REVISIONS	
NAME	DATE

ILLINOIS DEPARTMENT OF TRANSPORTATION
 TEMPORARY INFORMATION SIGNING
 STAGE 3-4
 WB STA. 145+050 - STA. 145+390

DATE 11/23/04
 DRAWN BY RDY
 CHECKED BY LSA

