

All Dimensions are in millimeters (mm) unless noted otherwise.

** See Culvert Cross Section Sheet 10 of 15 for Invert El. location.

See Sheet 8 of 15 for details at ends of Culvert Extension and wall opening for 600 φ pipe.

STATE OF ILLINOIS
DEPARTMENT OF TRANSPORTATION

ROUTE NO.	SECTION	COUNTY	TOTAL SHEETS	SHEET NO.	SHEET NO. 5 of 15 SHEETS
F.A.I. 74	*	PEORIA	1360	1027	
FED. ROAD DIST. NO. 7	BALTIMORE	FED. AID PROJECT			

* (72-7)R-3 Contract 68200

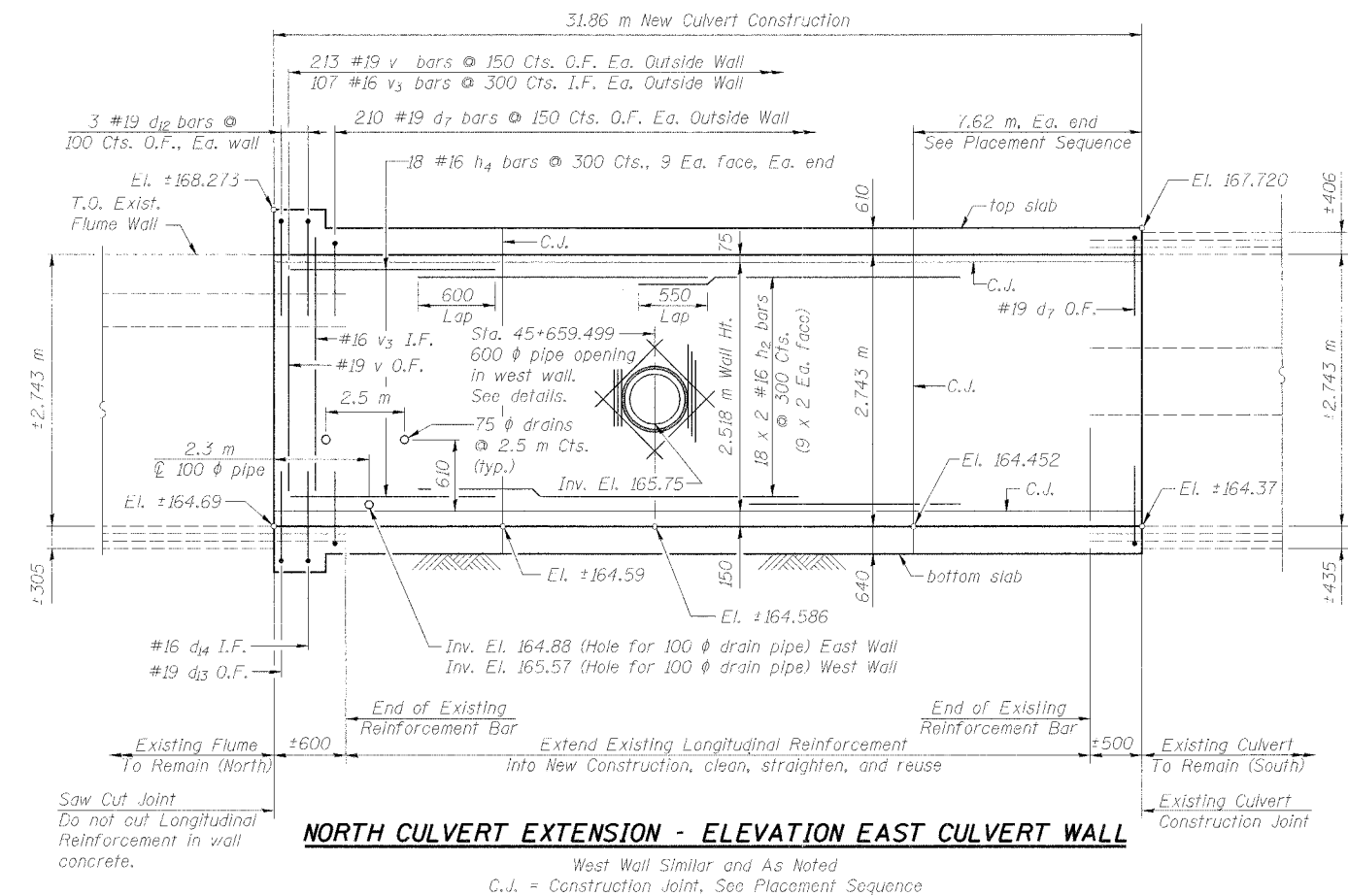
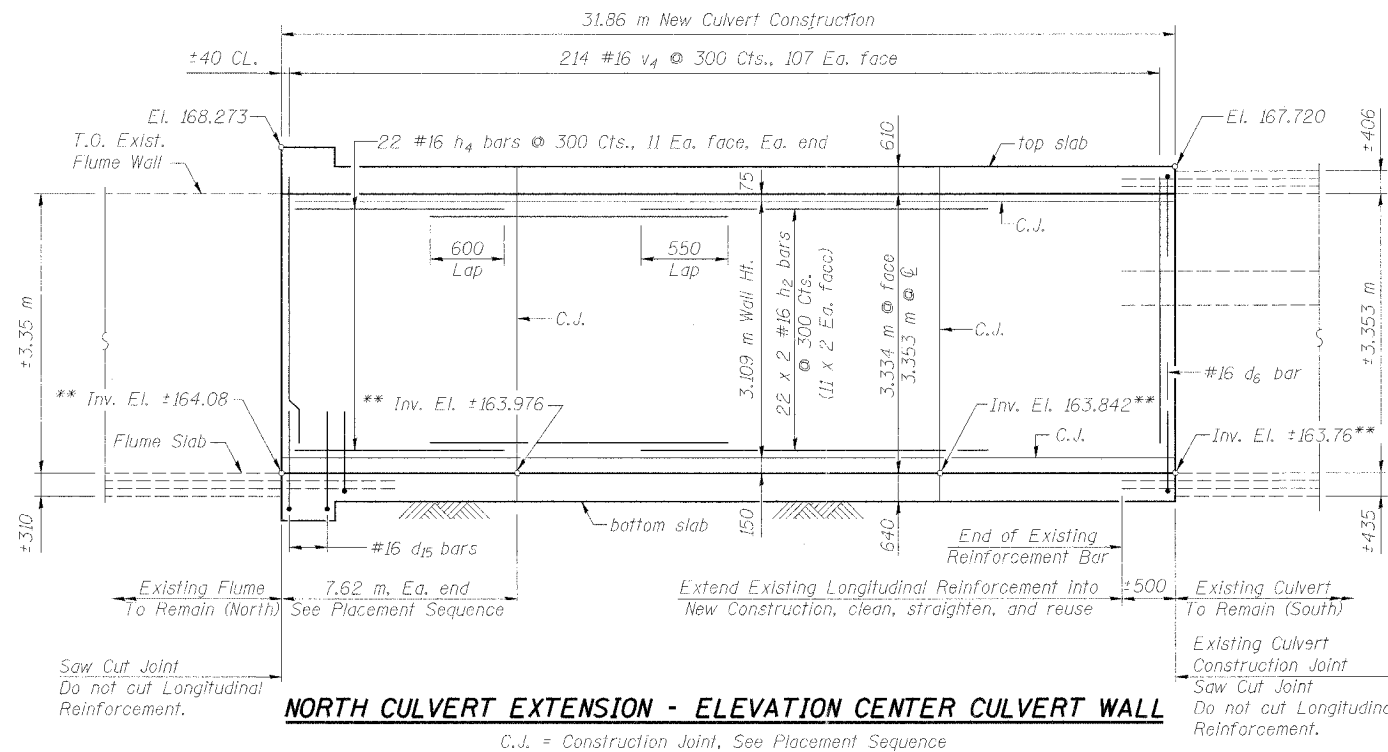

PLACEMENT SEQUENCE

- Center portion of walls are placed first.
- 7 days shall pass between time of center portion placement and end portions of culvert walls.

**EAST, CENTER & WEST WALL ELEVATION
NORTH CULVERT EXTENSION
RAMP C-3 OVER DRY RUN CREEK
F.A.I. ROUTE 74(I-74) SECTION (72-7)R-3
PEORIA COUNTY
STATION 10+277.51 TO
STA. 10+441.66 (RAMP C-3)
STRUCTURE NUMBER 072-2005**

DESIGNED	LLV
CHECKED	PJL
DRAWN	MGM
CHECKED	LLV



111 NE Jefferson Ave.
Peoria, Illinois 61602
Ph(309)676-8464
FAX(309)676-5445

13/07/05 07:14:53 AM