

TYPICAL URBAN ENTRANCE

QUANTITY URBAN ENTRANCE	
Section B'-B' to B-B=	m ³ /m (cu. yd./ft.)
Section C-C to B'-B' + B-B to A-A=	m ³ (cu. yd.)

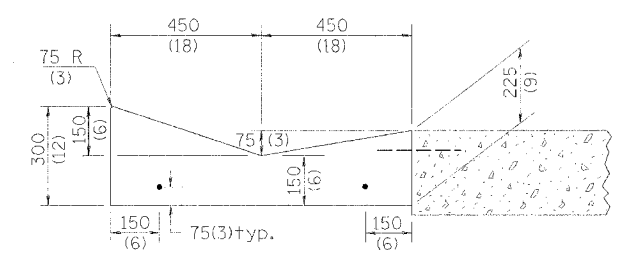

SECTION A-A & C-C

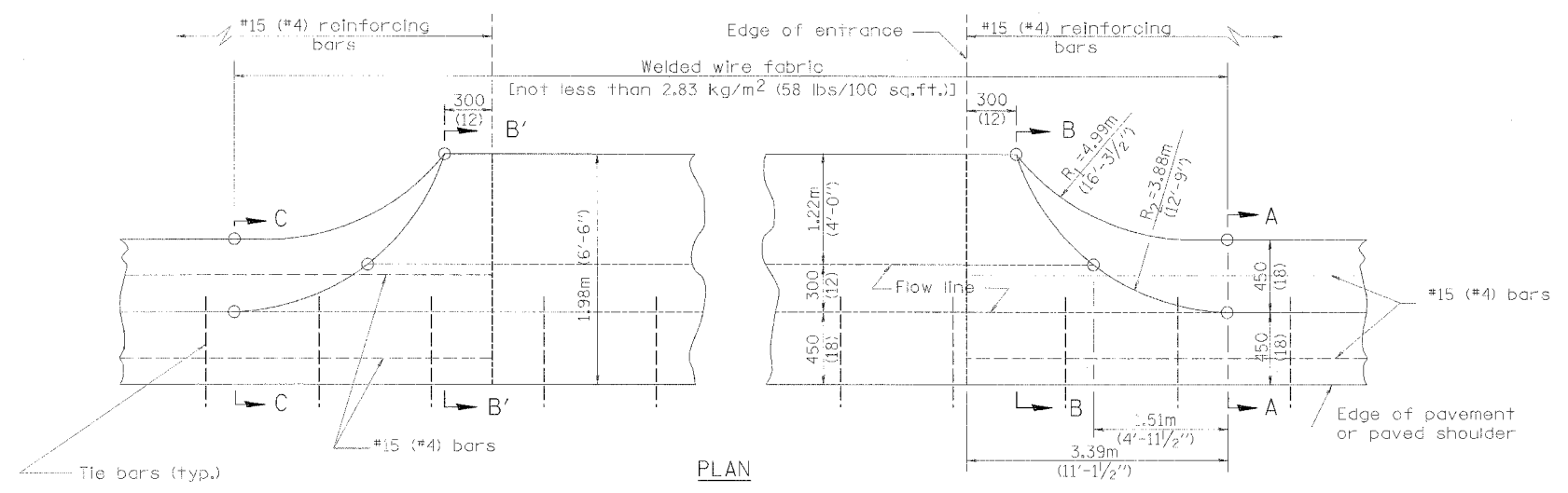

TYPICAL RURAL ENTRANCE

QUANTITY RURAL ENTRANCE	
Section B'-B' to B-B=	m ³ /m (cu. yd./ft.)
Section C-C to B'-B' + B-B to A-A=	m ³ (cu. yd.)

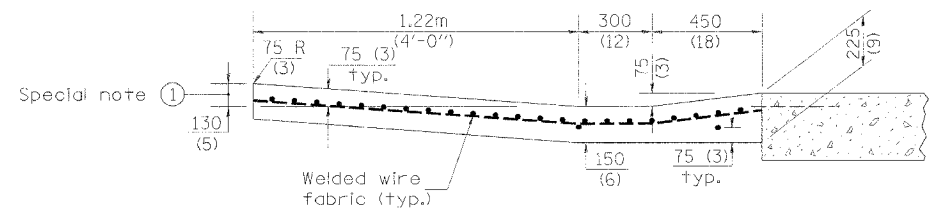

SECTION B-B & B'-B'

- SPECIAL NOTES:**
- ① Section B-B & B'-B': 125 (5) is the normal dimension. If specified in the plans, the following shall be used for improved entrance match-up: Minimum - 75 (3) Maximum - 225 (9)

QUANTITIES	
CALC. BY:	DATE:
CHECKED BY:	DATE:
QUANTITY CALCULATIONS ARE ON FILE AT THE DISTRICT 4 OFFICE; BUREAU OF PROJECT IMPLEMENTATION; DOCUMENTATION SECTION	

ENTRANCE

All dimensions are in millimeters (inches) unless otherwise noted.

ILLINOIS DEPARTMENT OF TRANSPORTATION
DISTRICT CADD STANDARD

**TYPE A GUTTER, (MODIFIED)
(INLET, OUTLET & ENTRANCE)**

CADD STANDARD 606101-D4 SHEET 3 OF 3
SCALE: NOT DRAWN TO SCALE DRAWN BY CADD
DATE: **DATE** CHECKED BY: