

F.A.I. RTE.	SECTION	COUNTY	TOTAL SHEETS	SHEET NO.
74	(72-71R-3)	PEORIA	1360	1146
STA.		TO STA.		
FED. ROAD DIST. NO.		ILLINOIS FED. AID PROJECT		

BY: [Signature]
 DATE: [Blank]
 CHECKED BY: [Signature]
 DATE: [Blank]
 PROJECT NO. [Blank]
 SHEET NO. [Blank]

CLARK ENGINEERS, INC.

BY: [Signature]
 DATE: [Blank]
 CHECKED BY: [Signature]
 DATE: [Blank]
 PROJECT NO. [Blank]
 SHEET NO. [Blank]

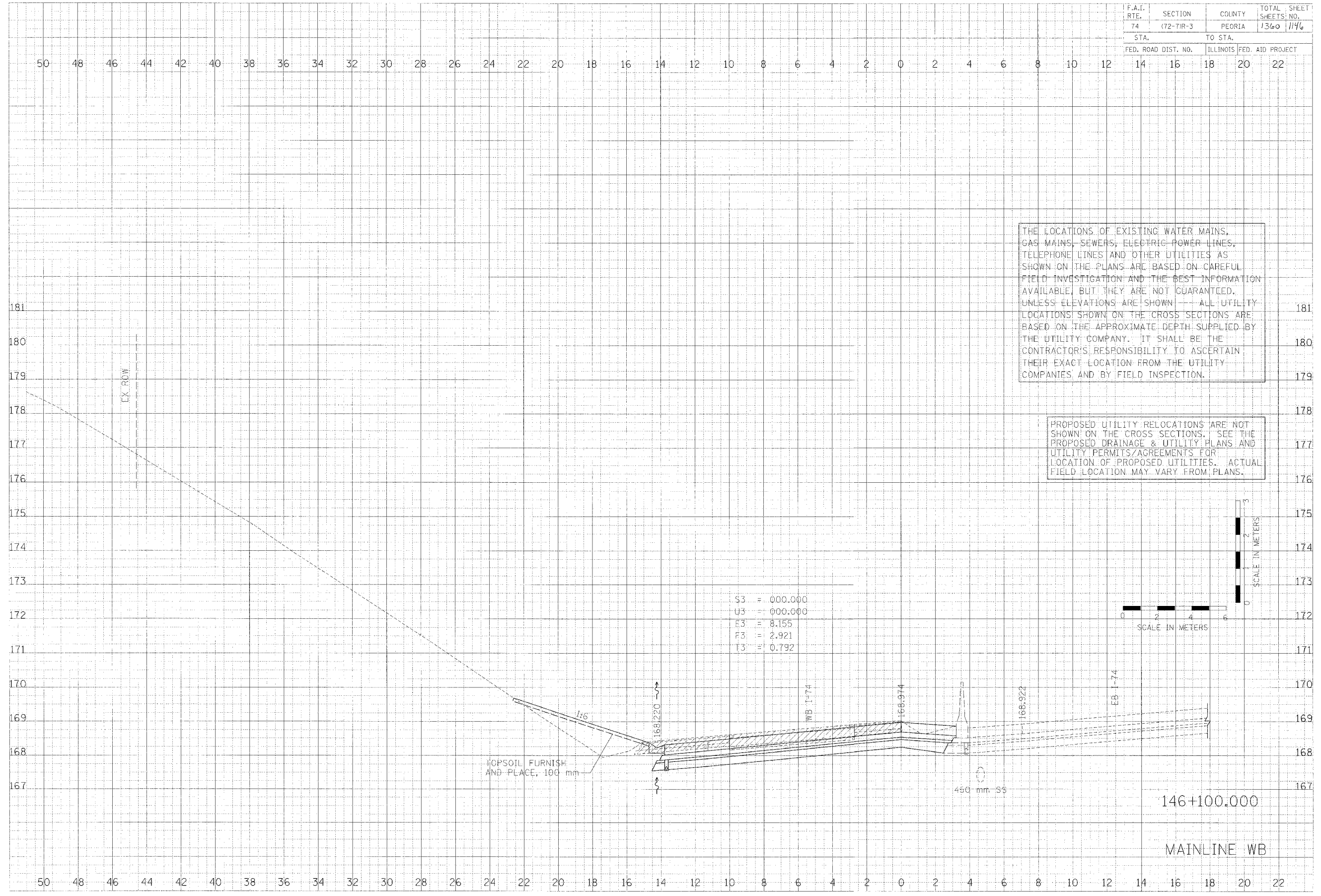

S3 = 000.000
 U3 = 000.000
 E3 = 8.155
 F3 = 2.921
 T3 = 0.792

THE LOCATIONS OF EXISTING WATER MAINS, GAS MAINS, SEWERS, ELECTRIC POWER LINES, TELEPHONE LINES AND OTHER UTILITIES AS SHOWN ON THE PLANS ARE BASED ON CAREFUL FIELD INVESTIGATION AND THE BEST INFORMATION AVAILABLE, BUT THEY ARE NOT GUARANTEED, UNLESS ELEVATIONS ARE SHOWN. ALL UTILITY LOCATIONS SHOWN ON THE CROSS SECTIONS ARE BASED ON THE APPROXIMATE DEPTH SUPPLIED BY THE UTILITY COMPANY. IT SHALL BE THE CONTRACTOR'S RESPONSIBILITY TO ASCERTAIN THEIR EXACT LOCATION FROM THE UTILITY COMPANIES AND BY FIELD INSPECTION.

PROPOSED UTILITY RELOCATIONS ARE NOT SHOWN ON THE CROSS SECTIONS. SEE THE PROPOSED DRAINAGE & UTILITY PLANS AND UTILITY PERMITS/AGREEMENTS FOR LOCATION OF PROPOSED UTILITIES. ACTUAL FIELD LOCATION MAY VARY FROM PLANS.

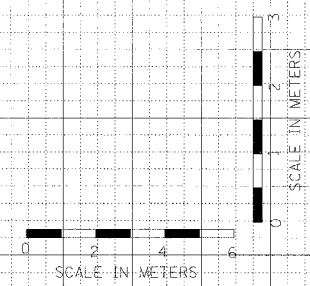

TOPSOIL FURNISH AND PLACE, 100 mm

450 mm SS

146+100.000

MAINLINE WB