

|                       |          |                           |              |           |
|-----------------------|----------|---------------------------|--------------|-----------|
| F.A.I. RTE.           | SECTION  | COUNTY                    | TOTAL SHEETS | SHEET NO. |
| 74                    | 172-7B-3 | PEORIA                    | 1360         | 1353      |
| STA. 140+900.05       |          | TO STA. 141+175.00        |              |           |
| FED. ROAD DIST. NO. 4 |          | ILLINOIS FED. AID PROJECT |              |           |

68200

9

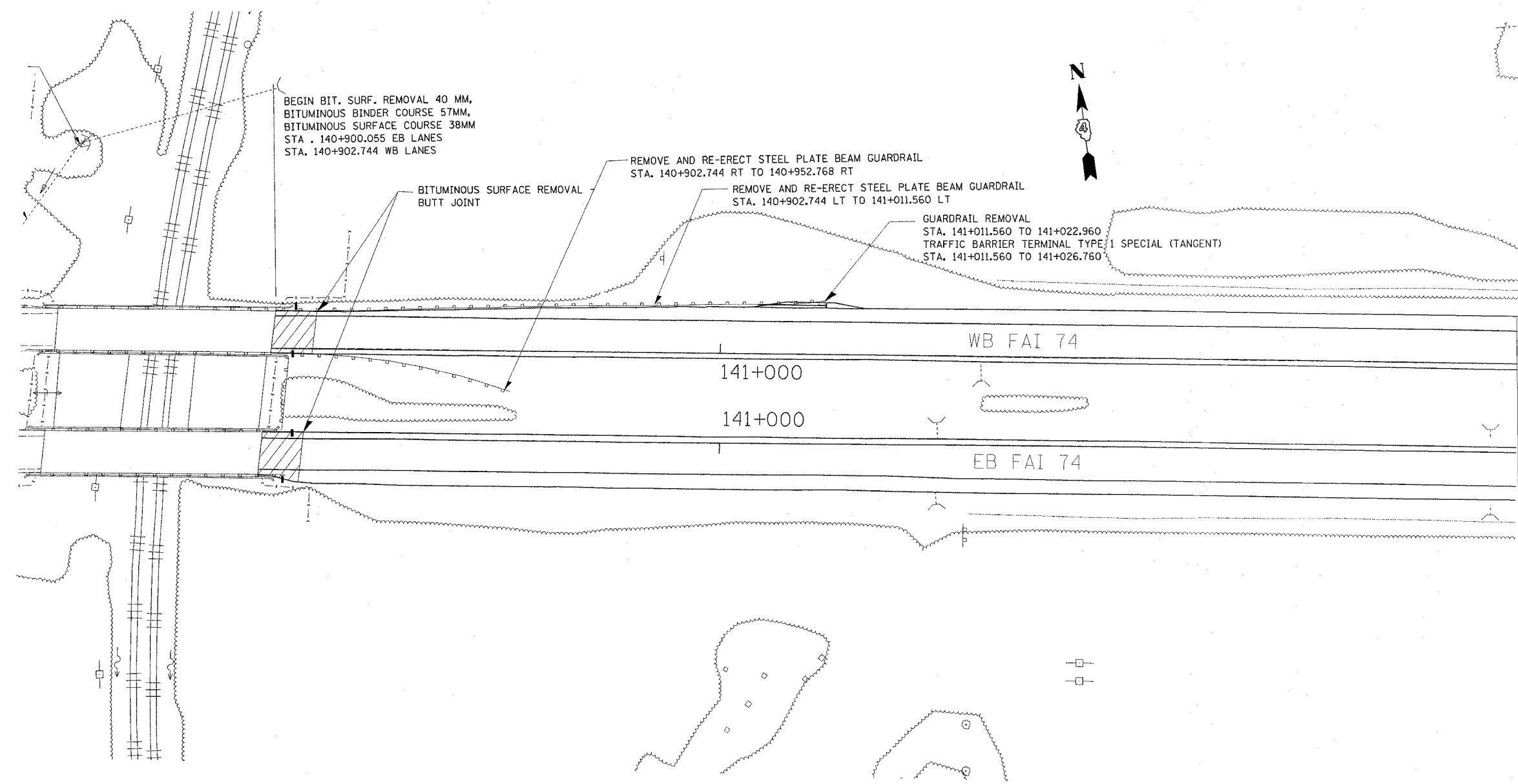

cr:projects-174wb-plan.w.dgn

| REVISIONS |      |
|-----------|------|
| NAME      | DATE |
|           |      |
|           |      |
|           |      |
|           |      |
|           |      |
|           |      |

ILLINOIS DEPARTMENT OF TRANSPORTATION

PROPOSED ROADWAY PLAN

DATE 6/21/04

DRAWN BY CEM  
CHECKED BY CEM