

68383

F.A.P.	SECTION	COUNTY	TOTAL SHEETS	SHEET NO.
693	*	TAZEWELL	56	1

\* D4 CULVERT EXT. / REPAIR 2005-2

D-94-016-04

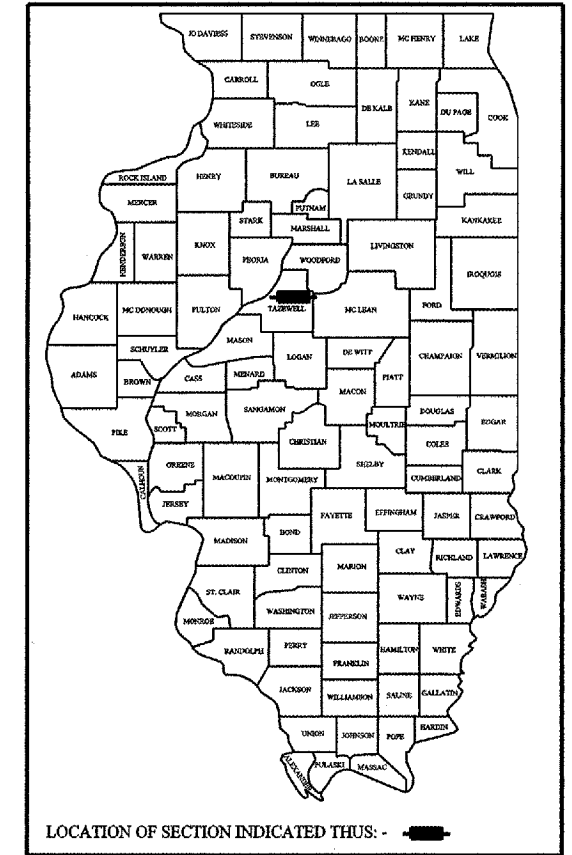

STATE OF ILLINOIS  
DEPARTMENT OF TRANSPORTATION  
DIVISION OF HIGHWAYS

**PROPOSED  
HIGHWAY PLANS**

F.A.P. ROUTE 693 (IL. ROUTE 9)  
D4 CULV EXT / REPAIR 2005-2  
TAZEWELL COUNTY  
C-94-024-04

INDEX OF SHEETS

1. COVER SHEET
2. COMMITMENT & GENERAL NOTES
3. STATUS OF UTILITIES
- 4 - 5. SUMMARY OF QUANTITIES
- 6 - 8. TYPICAL SECTIONS
- 9 - 12. SCHEDULE OF QUANTITIES
- 13 - 20. EXISTING & PROPOSED PLAN SHEET
- 21 - 28. CULVERT EXTENSION DETAILS
- 29 - 31. BORING LOG
- 32 - 51. CROSS SECTIONS
52. RIPRAP DITCH FOR EROSION PROTECTION
- 53 - 56. CADD STANDARDS:
  - 205001-D4
  - 542001-D4
  - 630101-D4

LIST OF STANDARDS

- 280001-02 635006-02 701301-02
- 542301 635011-01 702001-05
- 542401 701006-02 666001
- 630001-05 701011-01
- 635001 701201-02

SCALES

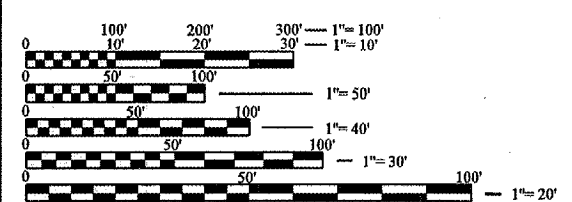

FULL SIZE PLANS HAVE BEEN PREPARED USING STANDARD ENGINEERING SCALES. REDUCED SIZED PLANS WILL NOT CONFORM TO STANDARD SCALES. IN MAKING MEASUREMENTS ON REDUCED PLANS, THE ABOVE SCALES MAY BE USED.

J.U.L.I.E.  
JOINT UTILITY LOCATION INFORMATION FOR EXCAVATION  
1-800-892-0123

CONTRACT NO. 68383  
CATALOG NO. 032840-00D

LOCATION 2  
STA. 720+00 TO STA. 726+00

LOCATION 1  
STA. 581+00 TO STA. 587+00

LOCATION 3  
STA. 733+00 TO STA. 738+50

LOCATION 4  
STA. 857+00 TO STA. 862+50

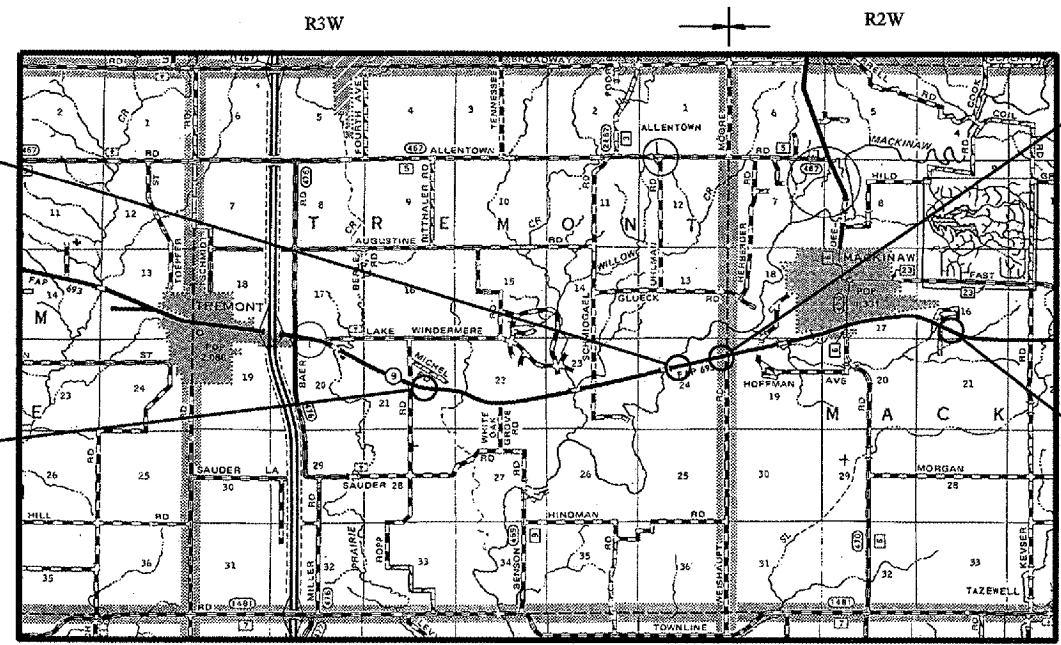

GROSS LENGTH OF SECTION = 28,150.00 FEET = 5.331 Mi  
NET LENGTH OF SECTION = 2,300.00 FEET = 0.436 Mi

**N.P.D.E.S.  
REQUIRED**

PRINTED BY THE AUTHORITY OF THE STATE OF ILLINOIS



EXPIRES: 11/30/2005

STATE OF ILLINOIS  
DEPARTMENT OF TRANSPORTATION  
DIVISION OF HIGHWAYS

SUBMITTED 2-8-05  
*Joseph E. Crowe Jr.*  
REGIONAL ENGINEER

March 25, 05  
*Mike Hene*  
ENGINEER OF DESIGN AND ENVIRONMENT

March 25, 05  
*Vester Modler*  
DIRECTOR, DIVISION OF HIGHWAYS

PROJECT ENGINEER: M. ADDIS 309-671-3454

DESIGNER: LEONEL CRESPO 309-671-3459