

68383

F.A.P. RTE.	SECTION	COUNTY	TOTAL SHEETS	SHEET NO.
693	*	TAZEWELL	14	14
STA. 581+00		TO STA. 587+00		
FDL ROAD DIST. NO. 4		ILLINOIS FED. AID PROJECT		

* D4 CULVERT EXT. / REPAIR 2005-2

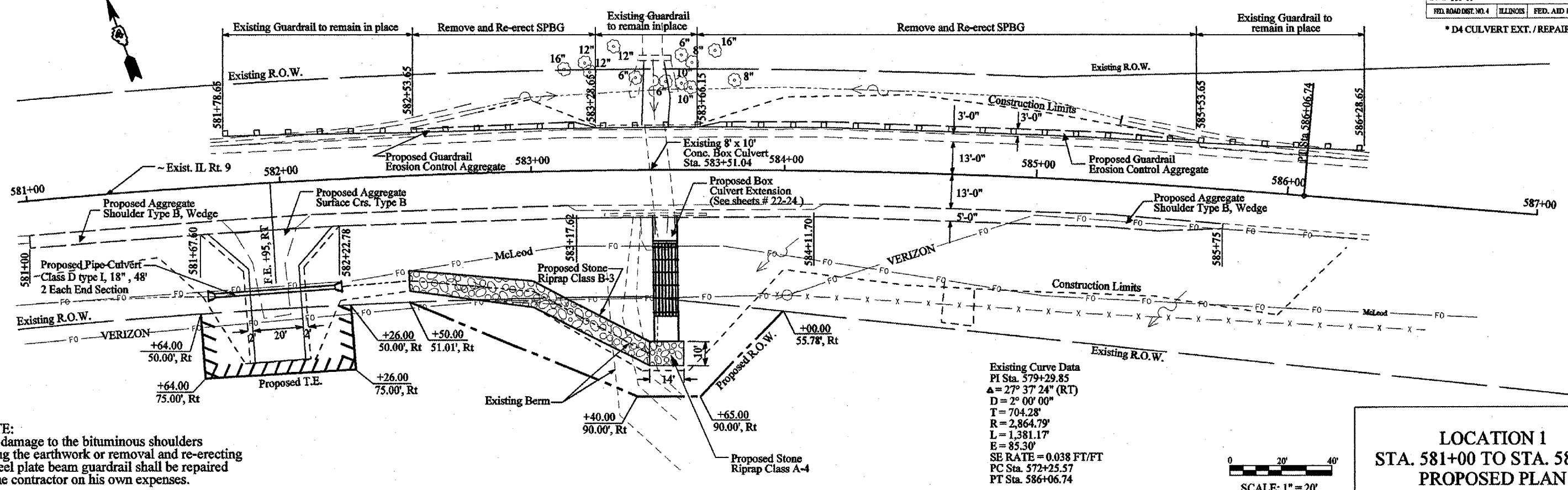

NOTE:
Any damage to the bituminous shoulders during the earthwork or removal and re-erecting of steel plate beam guardrail shall be repaired by the contractor on his own expenses.

Existing Curve Data
 PI Sta. 579+29.85
 $\Delta = 27^\circ 37' 24''$ (RT)
 $D = 2^\circ 00' 00''$
 $T = 704.28'$
 $R = 2,864.79'$
 $L = 1,381.17'$
 $E = 85.30'$
 $SE\ RATE = 0.038\ FT/FT$
 PC Sta. 572+25.57
 PT Sta. 586+06.74

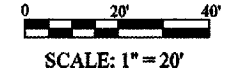

LOCATION 1
STA. 581+00 TO STA. 587+00
PROPOSED PLAN

PLAN	DATE

PROFILE	DATE

