

68383

F.A.P. RTE.	SECTION	COUNTY	TOTAL SHEETS	SHEET NO.
693		TAZEWELL	20	20
STA. 856+50		TO STA. 862+50		
FED. ROAD DIST. NO.	ILLINOIS	FED. AID PROJECT		
* D4 CULVERT EXT. / REPAIR 2005-2				

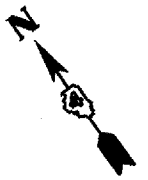

PLAN	DATE
REVISIONS	
NOTED	
NO. 1	

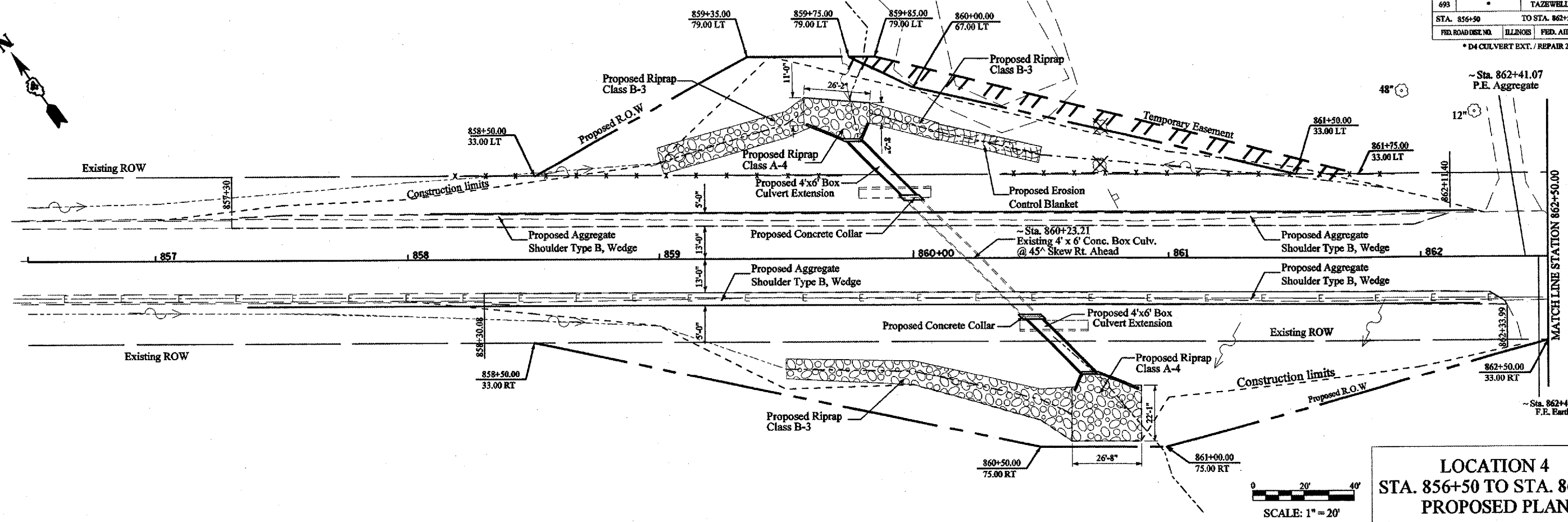

LOCATION 4
STA. 856+50 TO STA. 862+50
PROPOSED PLAN

PROFILE	DATE
REVISIONS	
NOTED	
NO. 1	

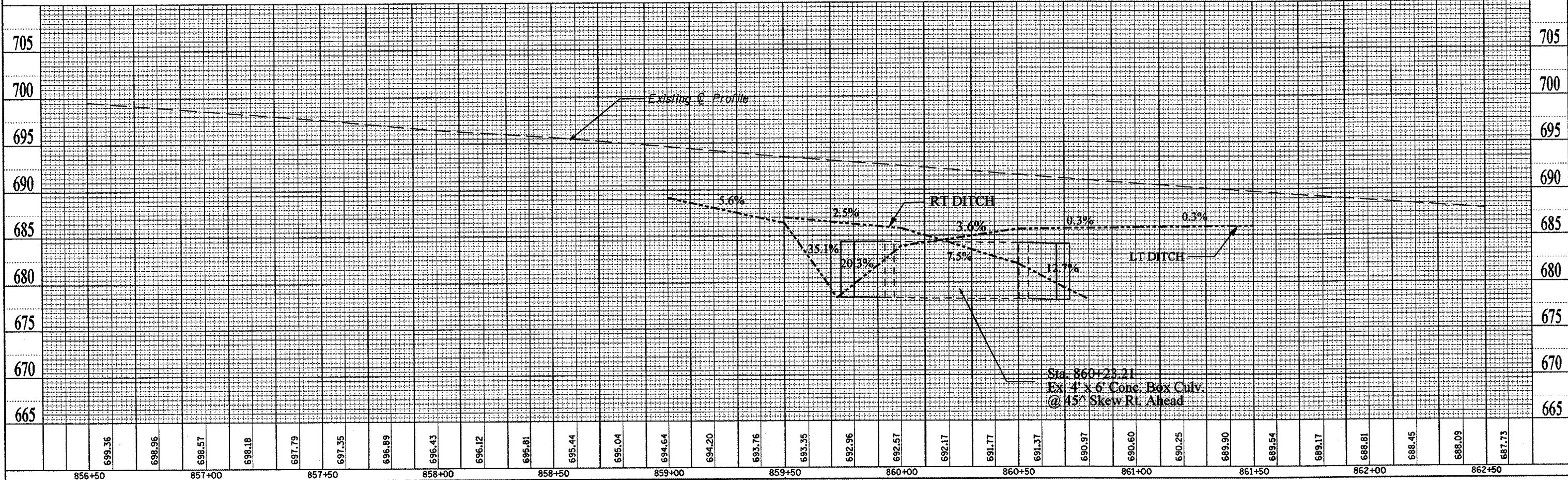

Sta. 860+23.21
Ex. 4' x 6' Conc. Box Culv.
@ 45° Skew Rt. Ahead