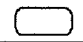
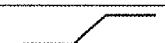

68382

F.A.P. RTE.	SECTION	COUNTY	TOTAL SHEETS	SHEET NO.
693	*	TAZEWELL		24
STA. 581+00		TO STA. 587+00		
FED. ROAD DIST. NO. 4	ILLINOIS	FED. AID PROJECT		

* D4 CULVERT EXT. / REPAIR 2005-2

BILL OF MATERIAL

Bar	No.	Size	Length	Shape
a ₁	95	#7	11'-0"	
a ₂	41	#4	9'-4"	—————
a ₃	8	#5	9'-4"	—————
d	20	#4	4'-2"	—————
d ₁	10	#5	11'-2"	—————
h	11	#6	10'-9"	—————
h ₁	14	#5	39'-0"	—————
h ₂	20	#7	13'-6"	—————
h ₉	11	#4	10'-9"	—————
*h ₁₀₋₁₉	20	#7	variable	—————
v	40	#4	9'-11"	—————
*v ₁	114	#4	2'-7"	—————
*v ₂₋₃₉	78	#4	variable	—————
*v ₄₀₋₅₀	22	#4	variable	—————
stirrups	30	#4	4'-6"	
**	6	#6	9'-4"	—————
Z	10	#5	3'-9"	
			QTY.	
Reinforcement Bars			Pound	5,919
Class SI Concrete			Cu. Yd.	37.8
3/4" dia. Expansion Bolts			Each	26

* See Reinforcement Bars Diagram for Length

GENERAL NOTES:

The Reinforcement Bars shall conform to Section 508 of The Standard Specifications.

Reinforcement Bars and Class SI Concrete will be paid for separately.

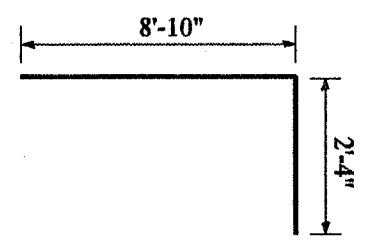
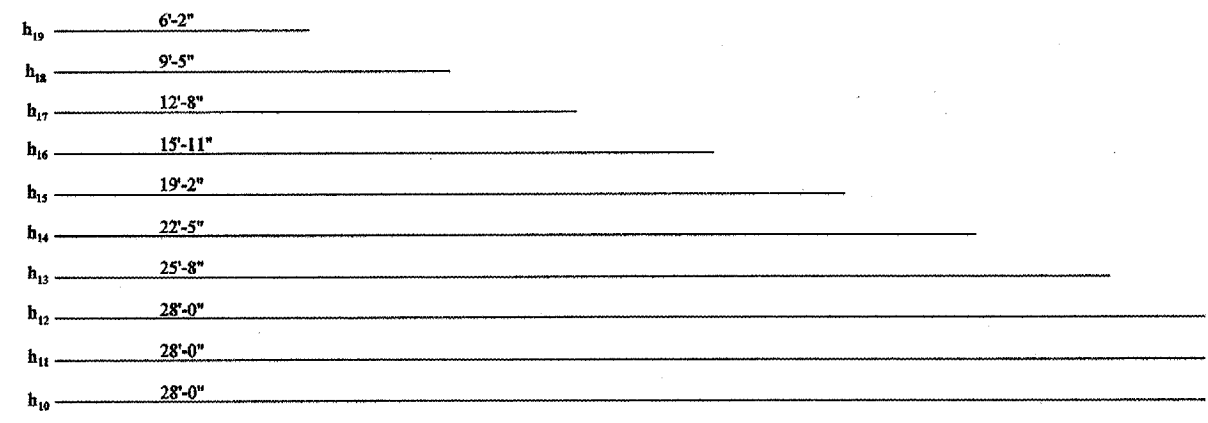
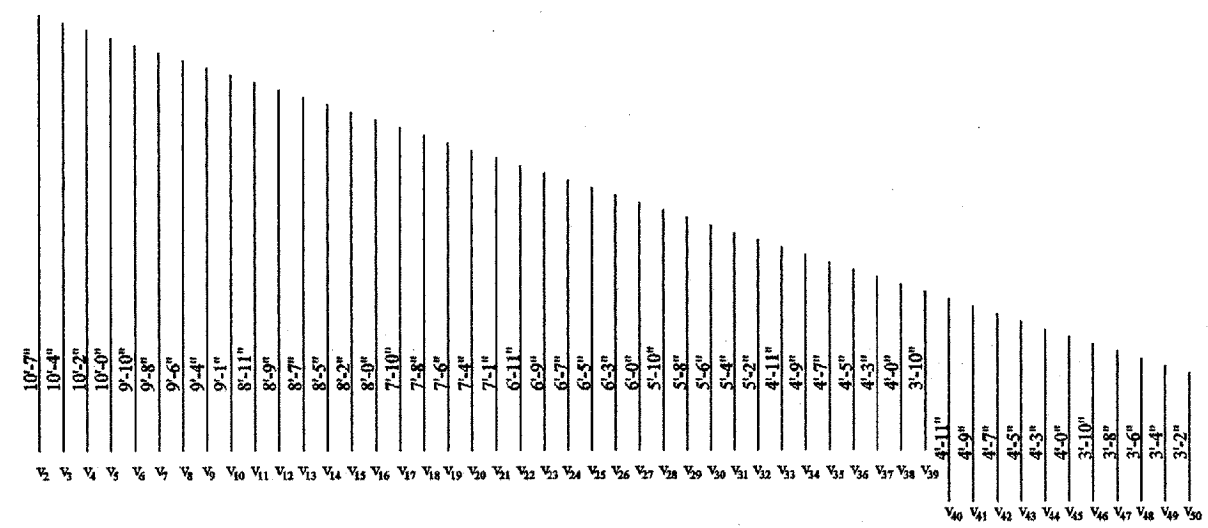

BAR "d₁"

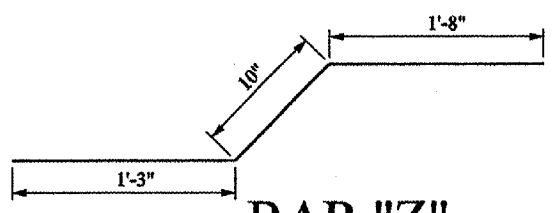

BAR "Z"

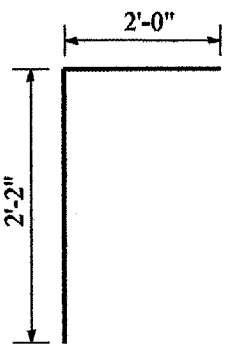

BAR "d"

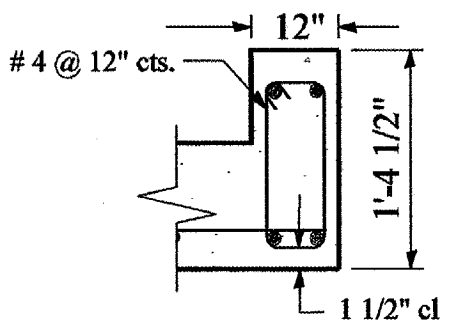

STIRRUPS DETAIL

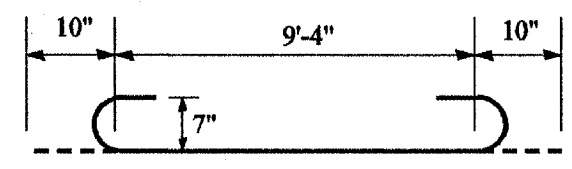

BAR "a₁"

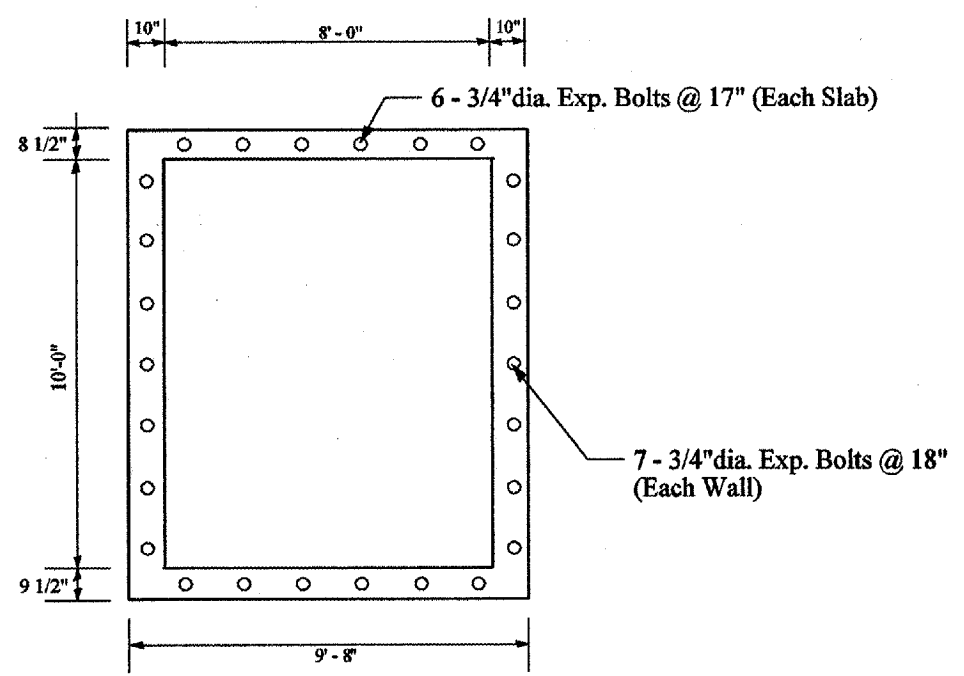

SECTION THRU THE BARREL

CULVERT EXTENSION DETAILS
STA. 583+51.04

DATE	BY
REVISIONS	
NOTED	
CHECKED	
DESIGNED	
DATE	BY

DATE	BY
REVISIONS	
NOTED	
CHECKED	
DESIGNED	
DATE	BY