

68383

F.A. RTE.	SECTION	COUNTY	TOTAL SHEETS	SHEET NO.
693	*	TAZEWELL		47
* D4 CULVERT EXT. / REPAIR 2005-2				
FED. ROAD DIST. NO.	ILLINOIS	FED. AID PROJECT		

UNLESS ELEVATIONS ARE SHOWN  
ALL UTILITY LOCATIONS SHOWN ON THE CROSS SECTIONS  
ARE BASED ON THE APPROXIMATE DEPTH SUPPLIED BY  
THE UTILITY COMPANY

DATE	
BY	
REVISION	
NO.	

DATE	
BY	
REVISION	
NO.	

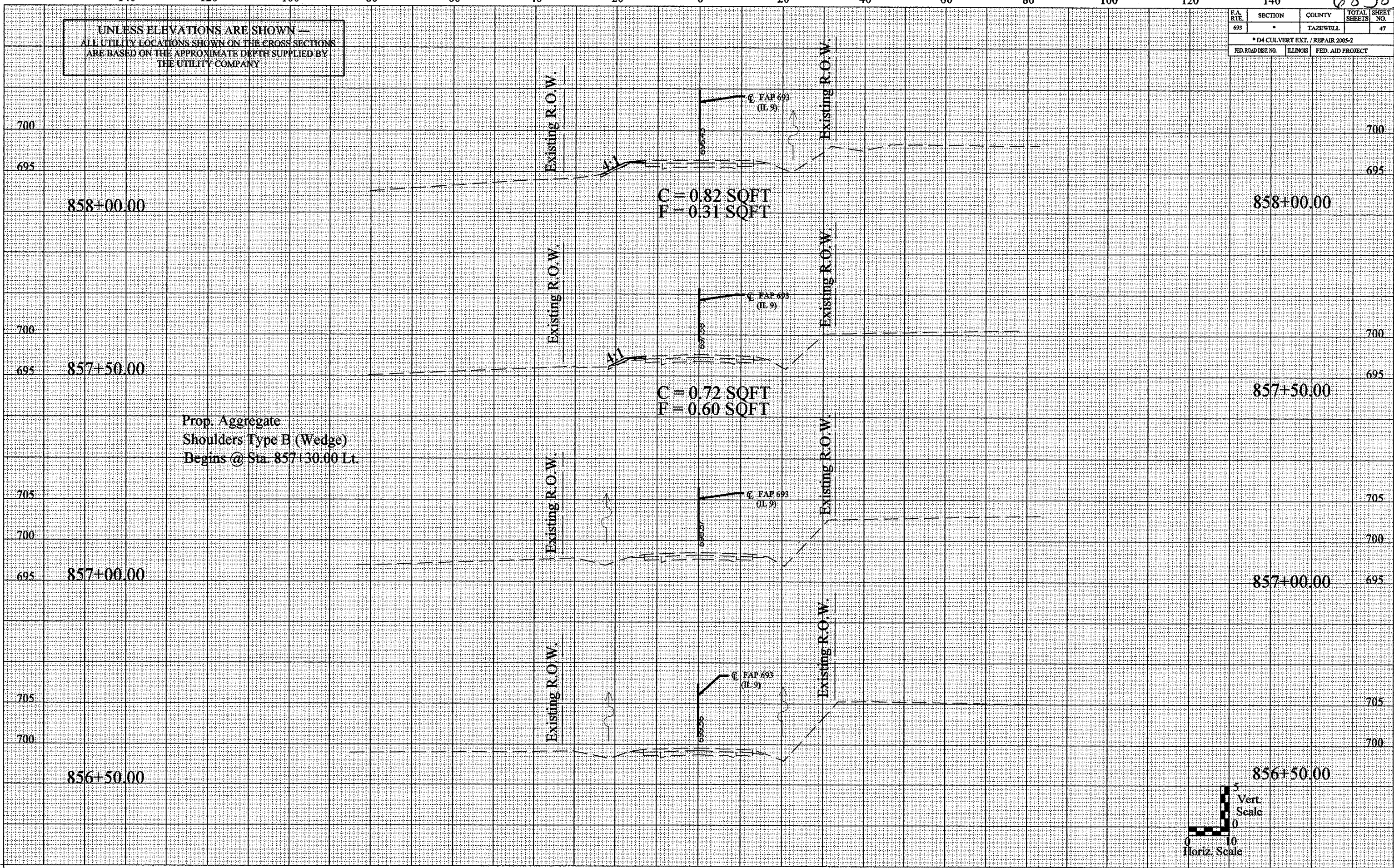

Prop. Aggregate  
Shoulders Type B (Wedge)  
Begins @ Sta. 857+30.00 Lt.

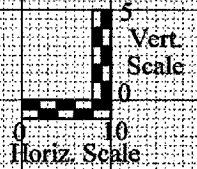

140 120 100 80 60 40 20 0 20 40 60 80 100 120 140