

(217)465-4181

DESIGNER: MATT MURPHY

PROJECT ENGINEER: KENSIL GARNETT

SQUAD LEADER: ROBERT NELSON

FAP ROUTE	SECTION	COUNTY	TOTAL SHEETS	SHEET NO.
FAP 811	225Q	CHAMPAIGN	22	1

CONTRACT NO. 70437
D-95-078-04

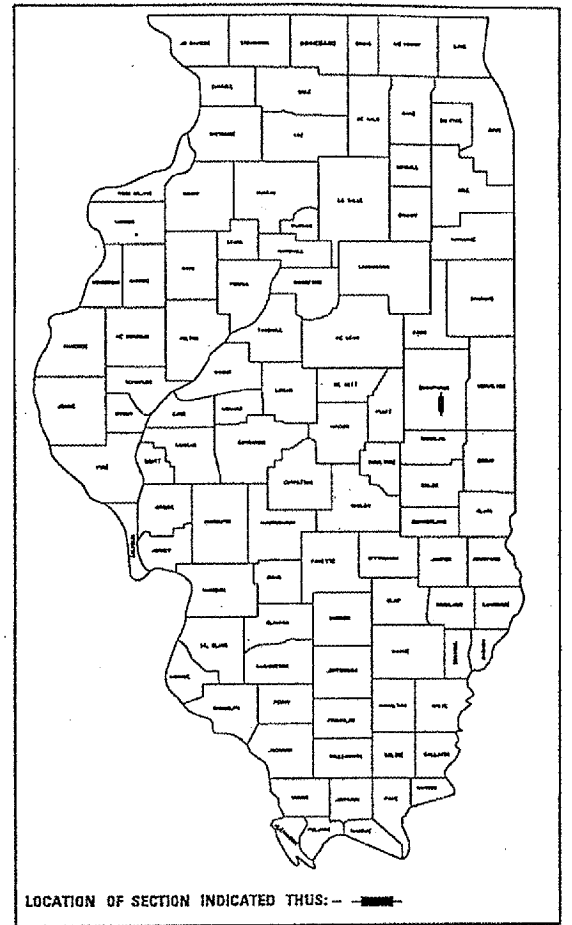

STATE OF ILLINOIS
DEPARTMENT OF TRANSPORTATION
DIVISION OF HIGHWAYS

PLANS FOR PROPOSED
HIGHWAY IMPROVEMENT

FOR INDEX OF SHEETS, SEE SHEET NO. 2
FOR SUMMARY OF QUANTITIES, SEE SHEET NO. 5

PLAN: 20 SCALE
PROFILE HORIZ. N/A
PROFILE VERT. N/A
CROSS SECTIONS
HORIZONTAL: N/A VERTICAL: N/A

FAP ROUTE 811 (MATTIS AVENUE)
SECTION (225Q)
CHAMPAIGN COUNTY
PROJECT HS-0811 - (005)

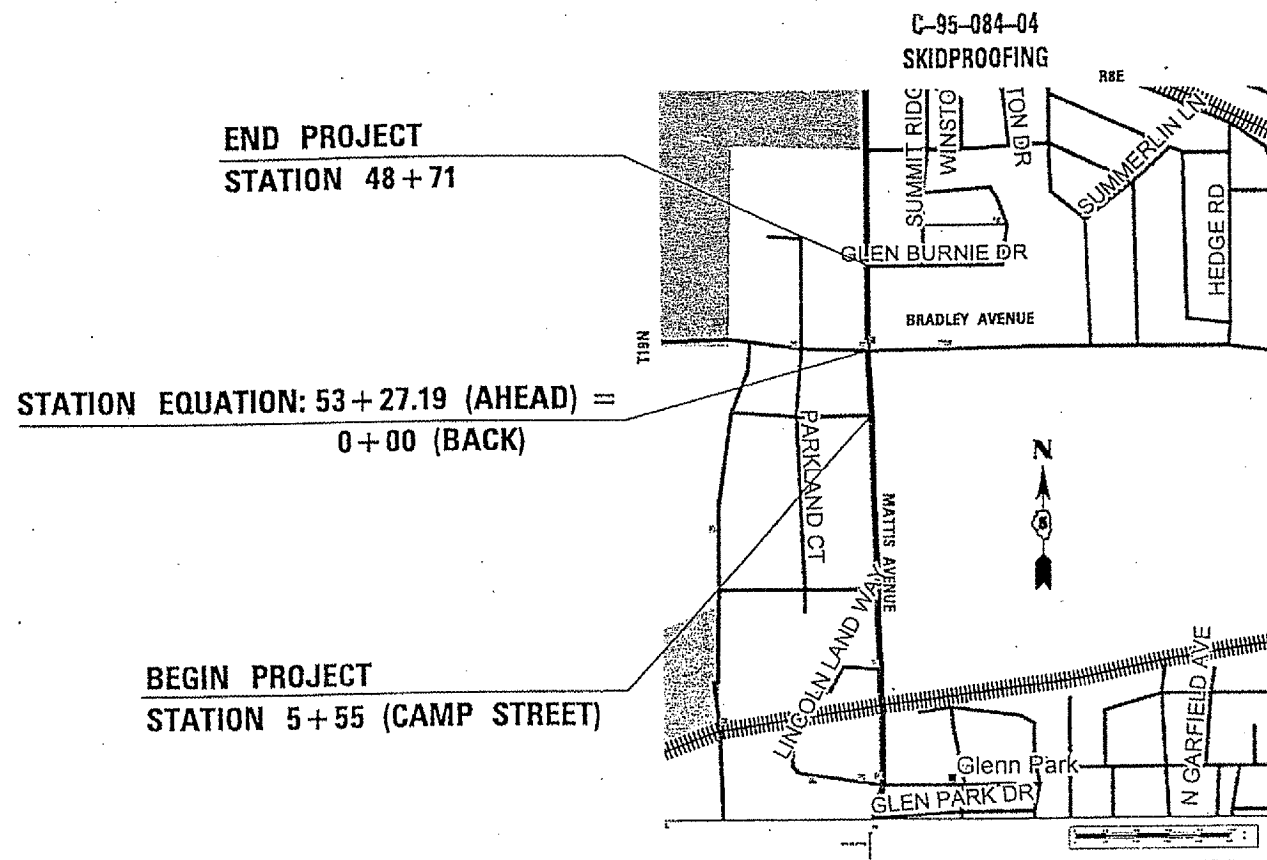

TRAFFIC DATA
ADT = 27,400 (2001)

DESIGN DESIGNATION
URBAN OTHER PRINCIPAL ARTERIAL

CONTRACT NO. 70437

TOTAL LENGTH OF SECTION & PROJECT = 1011.19 FEET = 0.192 MILES
NET LENGTH OF SECTION & PROJECT = 1011.19 FEET = 0.192 MILES

STATE OF ILLINOIS
DEPARTMENT OF TRANSPORTATION
DIVISION OF HIGHWAYS

SUBMITTED: Feb 20 05
EXAMINED: March 25 20 05
APPROVED: March 25 20 05

DIRECTOR OF HIGHWAYS, REGION THREE ENGINEER
ENGINEER OF DESIGN AND ENVIRONMENT
DIRECTOR OF HIGHWAYS, CHIEF ENGINEER

FOR UNDERGROUND UTILITY LOCATIONS CALL
TOLL FREE J.U.L.I.E. TELEPHONE NO.
1-800-892-0123

U.S. DEPARTMENT OF TRANSPORTATION
FEDERAL HIGHWAY ADMINISTRATION

APPROVED _____ DATE _____
DIVISION ADMINISTRATOR

PRINTED BY AUTHORITY OF THE STATE OF ILLINOIS

HIGHWAY STANDARDS

000001-04 STANDARD SYMBOLS, ABBREVIATIONS AND PATTERNS
 001006 DECIMAL OF AN INCH AND OF A FOOT
 442201-01 CLASS C AND D PATCHES
 701602-02 URBAN CLOSURE, MULTILANE, 2W WITH BI-DIRECTIONAL
 LEFT TURN LANE
 701426-02 MULTILANE INTERMITTENT OR MOVING OPERATION
 701701-04 URBAN LANE CLOSURE, MULTILANE INTERSECTION
 702001-05 TRAFFIC CONTROL DEVICES
 780001-01 TYPICAL PAVEMENT MARKINGS
 781001-02 TYPICAL APPLICATIONS FOR RAISED REFLECTIVE
 PAVEMENT MARKERS
 886001 DETECTOR LOOP INSTALLATIONS
 886006 TYPICAL LAYOUTS FOR DETECTOR LOOPS

INDEX OF SHEETS

SHEET	ITEM
1	COVER SHEET
2	INDEX OF SHEETS/LIST OF HIGHWAY STANDARDS
3-4	GENERAL NOTES
5	SUMMARY OF QUANTITIES
6	EXISTING TYPICAL CROSS SECTION
6	PROPOSED TYPICAL CROSS SECTION
7-9	SCHEDULES
10-13	PLAN SHEETS
14	DETAIL PAVEMENT PATCHING (PARTIAL DEPTH)
15	DETAIL FOR MILLING AT INTERSECTION
16	DETAIL FOR DETECTOR LOOP LOCATIONS
17-22	DETAIL TYPICAL APPLICATIONS OF PAVEMENT MARKINGS AND MARKERS

F.A.P. RTE.	SECTION	COUNTY	TOTAL SHEETS	SHEET NO.
811	(2250)	CHAMPAIGN	22	2

CONTRACT NO. 70437

F.A.P. RTE.	SECTION	COUNTY	TOTAL SHEETS	SHEET NO.
811	(2250)I	CHAMPAIGN	22	3

CONTRACT NO. 70437

GENERAL NOTES

G. N. -100
ENGLISH UNITS OF MEASUREMENT SHALL GOVERN OVER AND SUPERSEDE ANY METRIC UNITS SHOWN IN THIS CONTRACT. WHERE INCLUDED, METRIC UNITS ARE FOR INFORMATION ONLY.

G. N. -406
THE QUANTITIES INCLUDED IN THE PLANS FOR BITUMINOUS CONCRETE RESURFACING ARE INTENDED TO GIVE THE COVERAGE SHOWN ON THE TYPICAL CROSS SECTIONS. IT IS NOT INTENDED TO INCREASE THE THICKNESS OF THE BITUMINOUS MIXTURE IN ORDER TO USE ALL OF THE QUANTITIES INCLUDED IN THE CONTRACT. DESIGN THICKNESS CAN BE BACK CALCULATED BY USING THE CONVERSION FACTOR OF 1 INCH THICKNESS = 112 POUNDS/SQUARE YARD.

G. N. -406H

MIXTURE REQUIREMENTS

The following mixture requirements are applicable for this project:

Location(s):	Mattis at Bradley
Mixture Use(s):	Surface
AC/PG:	SBS PG 70-22
RAP %: (Max)	0
Design Air Voids:	4.0% @ Ndes=90
Mixture Composition: (Gradation Mixture)	IL 9.5 or IL 12.5
Friction Aggregate:	Mix F

G. N. -442B -- PATCHING SCHEDULES
THE PATCHING SCHEDULES INCLUDED IN THE PLANS REPRESENT THE BEST INFORMATION AVAILABLE AT THE TIME OF COMPLETION OF THE PLANS FOR LETTING. VARIATIONS IN LOCATION AND SIZES OF BOTH FULL-DEPTH AND PARTIAL-DEPTH PATCHES MAY OCCUR.

G. N. -442C -- PARTIAL DEPTH PATCHING DIMENSIONS
FOR PARTIAL DEPTH PAVEMENT PATCHING, THE MINIMUM SIZE OF ANY PATCH SHALL BE 4 FT BY 4 FT. IF THE REPAIR OF ANY SMALLER AREAS IS REQUIRED, THAT WORK SHALL BE DESIGNATED AS "PAVEMENT CLEANING" AND WILL BE PAID FOR IN ACCORDANCE WITH ARTICLE 109.04.

F.A.P. RTE.	SECTION	COUNTY	TOTAL SHEETS	SHEET NO.
811	(2250)I	CHAMPAIGN	22	4

CONTRACT NO. 70437

GENERAL NOTES (CONT.)**G. N. -703A**

SHORT TERM PAVEMENT MARKING SHALL BE APPLIED TO THE PAVEMENT AFTER ANY OF THE FOLLOWING: COLD MILLING AND/OR PLACING BITUMINOUS MATERIALS (PRIME COAT), LEVELING BINDER (MACHINE METHOD), BINDER AND SURFACE COURSES. SHORT TERM PAVEMENT MARKING PLACED ON THE SURFACE, SHALL COINCIDE WITH THE FINAL PAVEMENT STRIPING. SHORT TERM PAVEMENT MARKING PLACED PRIOR TO THE SURFACE SHALL COINCIDE WITH THE EXISTING PAVEMENT MARKINGS. USE 4 FEET PER 40 FEET (OR 10% PER STATION).

G. N. -781

RAISED REFLECTIVE PAVEMENT MARKERS SHALL BE PLACED IN ACCORDANCE WITH STANDARD 781001, AND THE DETAILS SHOWN IN THE PLANS. IF THERE IS ANY DISCREPENCY BETWEEN THE STANDARD AND THE DETAILS IN THE PLANS, THE DETAILS IN THE PLANS SHALL GOVERN. THE FINAL PAVEMENT MARKINGS SHALL BE IN PLACE PRIOR TO PLACING THE RAISED REFLECTIVE PAVEMENT MARKERS AND THE RAISED REFLECTIVE PAVEMENT MARKERS SHALL BE PLACED MIDWAY IN THE 30 FOOT (9 m) SPACE BETWEEN THE DASHED CENTERLINE STRIPES (WHEN APPLICABLE).

G. N. -873

EXISTING DETECTOR LOOPS IN THE AREAS OF PROPOSED SURFACE REMOVAL SHALL BE REPLACED PER THE EXISTING SIZE AND LOCATION EXCEPT AS NOTED IN THE PLANS. EXISTING DETECTOR LOOPS SHALL BE DISCONNECTED AT THE GULFBOX JUNCTION OR HANDHOLE PRIOR TO COLD MILLING AT THAT RESPECTIVE LOCATION. NEW DETECTOR LOOPS SHALL BE CONNECTED TO THE RESPECTIVE EXISTING AMPLIFIER. IN GENERAL, ADVANCED DETECTOR LOOPS FOR DILEMMA ZONE PROTECTION LOCATED AT THE SAME STATION SHALL BE GROUPED TOGETHER ON A COMMON AMPLIFIER. PRESENCE LOOPS SHALL BE GROUPED BY LANE ON A COMMON AMPLIFIER. DETECTOR LOOPS SHALL NOT BE WIRED IN SERIES. WHERE IT IS NECESSARY TO INSTALL MORE THAN ONE LOOP LEAD-IN IN A CONDUIT, LEAD-INS SHARING THE SAME CONDUIT SHALL BE ON A COMMON AMPLIFIER.

COMMITMENTS: THERE ARE NO COMMITMENTS FOR THIS PROJECT.

SUMMARY OF QUANTITIES

F.A.P. RTE.	SECTION	COUNTY	TOTAL SHEETS	SHEET NO.
811	(2250)I	CHAMPAIGN	22	5

CONTRACT NO. 70437

LOCATION OF WORK:

CHAMPAIGN COUNTY
 URBAN
 ROADWAY
 FAP 811
 STA: 5+55
 STA: 48+71
 10 80% STATE
 90 10% FEDERAL
 I000-2A

CONSTRUCTION TYPE CODE:

CODE NO	ITEM	UNIT	TOTAL QUANTITY	
40600100	BITUMINOUS MATERIALS (PRIME COAT)	GALLON	664.0	664.0
40600300	AGGREGATE (PRIME COAT)	TON	14.0	14.0
40600990	TEMPORARY RAMP	SQ YD	329.0	329.0
44201789	CLASS D PATCHES, TYPE II, THICKNESS 12 INCH	SQ YD	88.0	88.0
60255500	MANHOLES TO BE ADJUSTED	EACH	4.0	4.0
67100100	MOBILIZATION	L SUM	1.0	1.0
70102632	TRAFFIC CONTROL AND PROTECTION, STANDARD 701602	L SUM	1.0	1.0
70102635	TRAFFIC CONTROL AND PROTECTION, STANDARD 701701	L SUM	1.0	1.0
70300100	SHORT-TERM PAVEMENT MARKING	FT	1,618.0	1,618.0
70301000	WORK-ZONE PAVEMENT MARKING REMOVAL	SQ FT	267.0	267.0
* 78000100	THERMOPLASTIC PAVEMENT MARKING - LETTERS AND SYMBOLS	SQ FT	203.0	203.0
* 78000200	THERMOPLASTIC PAVEMENT MARKING - LINE 4"	FOOT	2,608.0	2,608.0
* 78000400	THERMOPLASTIC PAVEMENT MARKING - LINE 6"	FOOT	965.0	965.0
* 78000600	THERMOPLASTIC PAVEMENT MARKING - LINE 12"	FOOT	90.0	90.0
* 78000650	THERMOPLASTIC PAVEMENT MARKING - LINE 24"	FOOT	202.0	202.0
* 78100100	RAISED REFLECTIVE PAVEMENT MARKER	EACH	78.0	78.0
* 78300200	RAISED REFLECTIVE PAVEMENT MARKER REMOVAL	EACH	78.0	78.0
78300500	PAINT PAVEMENT MARKING REMOVAL	SQ FT	473.0	473.0
* 88600100	DETECTOR LOOP, TYPE I	FOOT	1,002.0	1,002.0
X4066548	POLYMERIZED BITUMINOUS CONCRETE SURFACE COURSE, SUPERPAVE, MIX "F", N90	TON	651.0	651.0
X4401705	PARTIAL DEPTH REMOVAL	SQ YD	166.0	166.0
X4409400	BITUMINOUS SURFACE REMOVAL 1 3/4"	SQ YD	6,639.0	6,639.0
X7015005	CHANGEABLE MESSAGE SIGN	CAL DA	28.0	28.0
Z0004800	BITUMINOUS MIXTURE FOR PATCHING	TON	72.0	72.0

* SPECIALITY ITEMS

F.A.P. RTE.	SECTION	COUNTY	TOTAL SHEETS	SHEET NO.
811	(2250)	CHAMPAIGN	22	6

CONTRACT NO. 70437

EXISTING TYPICAL CROSS SECTION

MATTIS AVENUE
 STA. 5+55 TO STA. 0+00 (BK)
 STA. 53+27.19 (AH) TO STA. 48+71

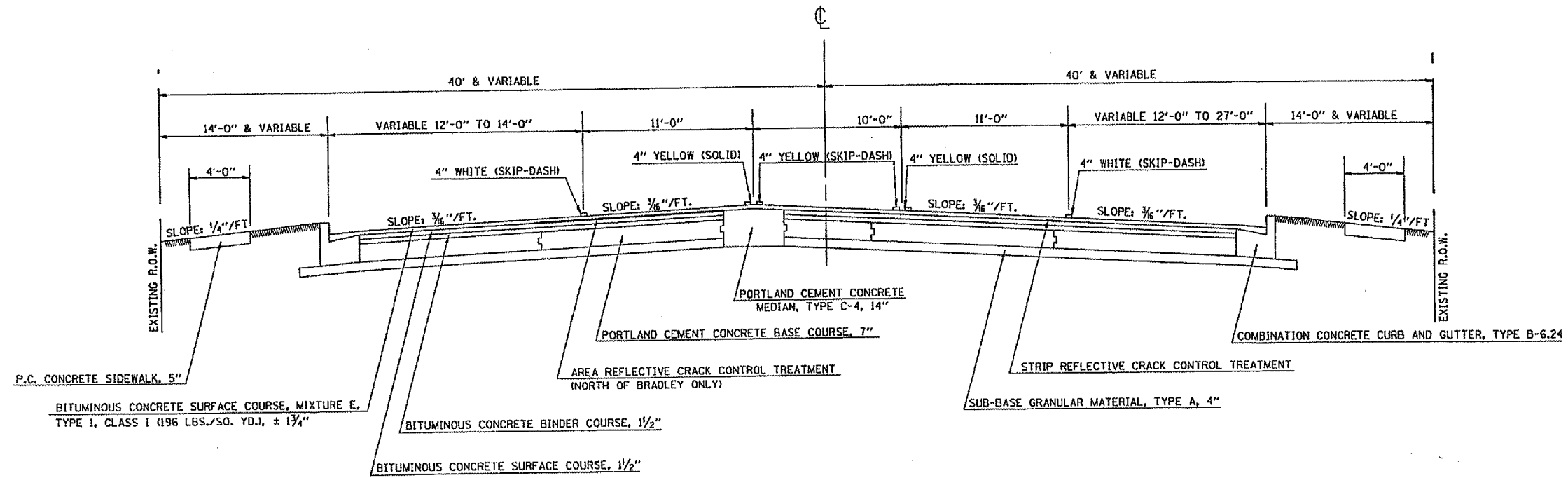

PROPOSED TYPICAL CROSS SECTION

MATTIS AVENUE
 STA. 5+55 TO STA. 0+00 (BK)
 STA. 53+27.19 (AH) TO STA. 48+71

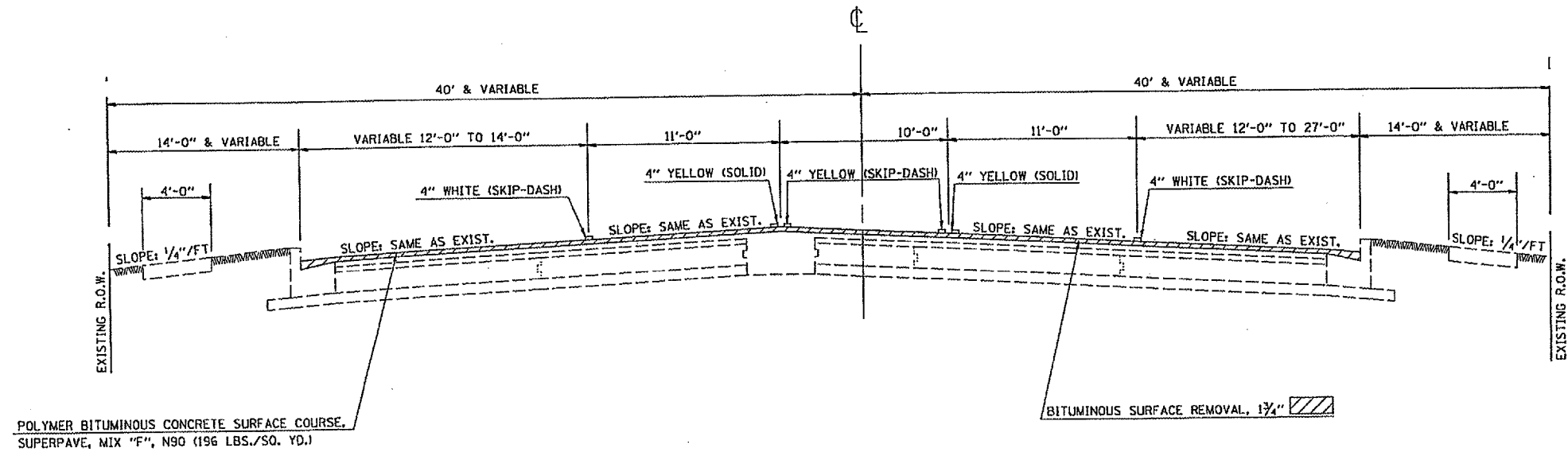

F.A.P. RTE.	SECTION	COUNTY	TOTAL SHEETS	SHEET NO.
811	(2250)I	CHAMPAIGN	22	7

CONTRACT NO. 70437

SCHEDULE OF QUANTITIES

TABULATION OF PARTIAL DEPTH PAVEMENT PATCHING

STATION	DIRECTION	EXISTING OVERLAY THICKNESS (INCHES)	LANE	LENGTH (FT)	WIDTH (FT)	PARTIAL DEPTH REMOVAL (SQ. YDS.)	BITUMINOUS MIXTURE FOR PATCHING (TON)
5+25	NB	4.75	TURN	4	12	5.3	2.3
5+25	NB	4.75	PASSING	4	12	5.3	2.3
5+25	NB	4.75	DRIVING	4	12	5.3	2.3
5+25	SB	4.75	PASSING	4	12	5.3	2.3
5+25	SB	4.75	DRIVING	4	12	5.3	2.3
4+60	SB	4.75	PASSING	4	12	5.3	2.3
4+60	SB	4.75	DRIVING	4	12	5.3	2.3
51+27	NB	4.75	PASSING	6	12	8.0	3.5
51+27	NB	4.75	DRIVING	6	12	8.0	3.5
51+27	SB	4.75	PASSING	6	12	8.0	3.5
51+27	SB	4.75	DRIVING	6	12	8.0	3.5
50+86	NB	4.75	PASSING	4	12	5.3	2.3
50+86	SB	4.75	PASSING	4	12	5.3	2.3
50+86	SB	4.75	DRIVING	4	12	5.3	2.3
50+39	NB	4.75	PASSING	4	12	5.3	2.3
50+39	NB	4.75	DRIVING	4	12	5.3	2.3
50+39	SB	4.75	PASSING	4	12	5.3	2.3
50+39	SB	4.75	DRIVING	4	12	5.3	2.3
49+99	NB	4.75	PASSING	4	12	5.3	2.3
49+99	NB	4.75	DRIVING	4	12	5.3	2.3
49+60	NB	4.75	PASSING	6	12	8.0	3.5
49+60	NB	4.75	DRIVING	6	12	8.0	3.5
48+95	SB	4.75	PASSING	4	12	5.3	2.3
48+95	SB	4.75	DRIVING	4	12	5.3	2.3
48+71	NB	4.75	PASSING	4	12	5.3	2.3
48+71	NB	4.75	DRIVING	4	12	5.3	2.3
48+71	SB	4.75	PASSING	4	12	5.3	2.3
48+71	SB	4.75	DRIVING	4	12	5.3	2.3

SHEET TOTALS 165.3 71.7

USE 166 72
(SQ. YDS.) (TON)

F.A.P. RTE.	SECTION	COUNTY	TOTAL SHEETS	SHEET NO.
811	(2250)I	CHAMPAIGN	22	8

CONTRACT NO. 70437

SCHEDULE OF QUANTITIES

THERMOPLASTIC PAVEMENT MARKING

STATION TO STATION	LETTERS & SYMBOLS (SQ. FOOT)	4" WHITE (FOOT)	4" YELLOW (FOOT)	6" WHITE (FOOT)	12" WHITE (FOOT)	24" WHITE (FOOT)
5+55 0+00	140.4	436.0	1090.0	563.0	90.0	98.0
0+00 48+71	62.6	200.0	882.0	402.0	0.0	104.0
LINE TOTAL:	203.0	636.0	1972.0	965.0	90.0	202.0

MANHOLES TO BE ADJUSTED

STATION	OFF-SET	EACH
1+28	30' -0" LT.	1
0+30	27' -0" LT.	1
52+88	CENTER LINE	1
50+02	CENTER LINE	1
TOTAL =		4 EACH

TABULATION OF CLASS D PAVEMENT PATCHING

STATION	DIRECTION	LANE	LENGTH (FT)	WIDTH (FT)	PATCH AREA (SQ. YDS.)
4+24	NB	TURN	6	12	8.0
4+24	NB	PASSING	6	12	8.0
4+24	NB	DRIVING	6	12	8.0
4+24	SB	PASSING	6	12	8.0
4+24	SB	DRIVING	10	12	13.3
49+42	SB	TURN	6	12	8.0
49+42	SB	PASSING	6	12	8.0
49+42	SB	DRIVING	8	12	10.7
49+42	NB	PASSING	6	12	8.0
49+42	NB	DRIVING	6	12	8.0

SECTION TOTAL 88.0
(SQ. YDS.)

DETECTOR LOOPS, TYPE I

STATION	DIRECTION	LANE	LOOP LENGTH (FEET)	LEAD - I LENGTH (FEET)	TOTAL LENGTH (FEET)
LOOP SIZES 6' X 6'					
1+71.00	NORTHBOUND	PASSING	24.0	20.0	44.0
1+71.00	NORTHBOUND	DRIVING	24.0	30.0	54.0
0+93.00	NORTHBOUND	TURN	24.0	43.0	67.0
0+78.00	NORTHBOUND	TURN	24.0	43.0	67.0
0+78.00	NORTHBOUND	PASSING	24.0	31.0	55.0
0+78.00	NORTHBOUND	DRIVING	24.0	21.0	45.0
0+63.00	NORTHBOUND	TURN	24.0	44.0	68.0
0+63.00	NORTHBOUND	PASSING	24.0	35.0	59.0
0+63.00	NORTHBOUND	DRIVING	24.0	25.0	49.0
52+60.00	SOUTHBOUND	TURN	24.0	35.0	59.0
52+60.00	SOUTHBOUND	PASSING	24.0	25.0	49.0
52+60.00	SOUTHBOUND	DRIVING	24.0	15.0	39.0
52+58.00	SOUTHBOUND	R. TURN	24.0	5.0	29.0
52+45.50	SOUTHBOUND	TURN	24.0	35.0	59.0
52+45.50	SOUTHBOUND	PASSING	24.0	26.0	50.0
52+45.50	SOUTHBOUND	DRIVING	24.0	12.0	36.0
52+31.00	SOUTHBOUND	PASSING	24.0	38.0	62.0
51+60.00	SOUTHBOUND	PASSING	24.0	17.0	41.0
51+60.00	SOUTHBOUND	DRIVING	24.0	5.0	29.0

LOOP SIZES 6' X 12'

0+67.00	SOUTHBOUND	R. TURN	36.0	5.0	41.0
---------	------------	---------	------	-----	------

TOTALS = 1002.0

SCHEDULE OF QUANTITIES

PAVEMENT MARKING REMOVAL SCHEDULE

F.A.P. RTE.	SECTION	COUNTY	TOTAL SHEETS	SHEET NO.
811	(2250)I	CHAMPAIGN	22	9

CONTRACT NO. 70437

STATION	OFFSET	STATION	OFFSET	LENGTH	WIDTH	AREA SQ. FT.
52+64	45.8' RT	52+66	30.5' RT.	14.5'	6"	7.3
52+68	43.5' RT	52+73	27.5' RT	17.0'	6"	8.5
52+68	43.5' RT	53+27.19(AH)	44.5' RT	53.5'	6"	26.8
0+00(BK)	44.5' RT	0+46.5	49.5' RT	48.0'	6"	24.0
52+68	49.5' RT	53+27.19(AH)	50.0' RT	54.0'	6"	27.0
0+00(BK)	50.0' RT	0+45	54.5' RT	46.5'	6"	23.0
53+20	55.0' RT	53+27.19(AH)	55.0' RT	7.2'	24"	14.4
0+46.5	27.5' RT	0+46.5	49.0' RT	22.0'	6"	11.0
0+52.5	27.5' RT	0+52.5	48.8' RT	20.0'	6"	10.0
52+63.3	42.3' LT	52+70	26.5' LT	14.5'	6"	7.3
52+68	26.5' LT	52+70	39.5' LT	13.5'	6"	6.8
52+68	39.5' LT	53+27.19(AH)	38.5' LT	56.0'	6"	28.0
52+70	47.1' LT	53+27.19(AH)	45.5' LT	56.0'	6"	28.0
52+81	57.8' LT	53+27.19(AH)	49.0' LT	46.5'	24"	93.0
0+00(BK)	49.0' LT	0+05	49.0' LT	4.8'	24"	9.6
0+00(BK)	39.9' LT	0+58.3	61.0' LT	58.0'	6"	29.0
0+00(BK)	38.5' LT	0+57.5	52.5' LT	57.5'	6"	28.8
0+30.5	27.0' LT	0+31.2	65.0' LT	31.0'	6"	15.5
0+31.2	65.0' LT	0+52.0	40.5' LT	24.0'	6"	12.0
0+29.5	55.0' LT	0+39.5	45.0' LT	6.0'	12"	6.0
0+39.5	45.0' LT	0+42	44.0' LT	3.5'	12"	3.5
0+29.5	36.0' LT	0+39.5	35.5' LT	13.0'	12"	13.0
0+39.5	26.0' LT	0+46.5	43.5' LT	10.5'	12"	10.5
0+29.5	36.0' LT	0+39.5	26.5' LT	13.5'	12"	13.5
0+39.5	26.0' LT	0+50.5	40.5' LT	16.5'	12"	16.5

TOTAL = 473.00

TEMPORARY RAMP

STATION	OFFSET	STATION	OFFSET	SQ. YDS.
5+55.00	28.00' LT.	5+55.00	28.00' RT.	37.33
0+65.70	57.60' LT.	0+43.20	27.00' LT.	23.97
0+43.20	27.00' LT.	0+00.00	27.00' LT. (AH)	28.80
53+27.19	27.00' LT. (BK)	52+23.00	27.00' LT.	69.46
1+20.00	28.40' RT.	0+00.00	28.40' RT. (AH)	80.00
53+27.19	28.40' RT. (BK)	52+70.00	28.40' RT.	38.13
52+70.00	28.40' RT.	52+59.60	45.10' RT.	13.26
48+71.00	28.00' LT.	48+71.00	28.00' LT.	37.33

TOTAL = 328.28

USE = 329

F.A.P. RTE.	SECTION	COUNTY	TOTAL SHEETS	SHEET NO.
811	(2250)I	CHAMPAIGN	22	10

CONTRACT NO. 70437



STRIPING KEY	
YELLOW	WHITE
1 4" SKIP-DASH	7 4" SKIP-DASH
2 4" SOLID	8 4" SOLID
3 12" DIAGONAL	9 12" DIAGONAL
4 4" DOUBLE (NARROW)	10 6" CROSS WALK
5 4" DOUBLE (WIDE)	11 24" STOP BAR
6 RESERVED	12 8" SOLID
	13 4" LANE LINE EXTENSIONS
	14 RESERVED

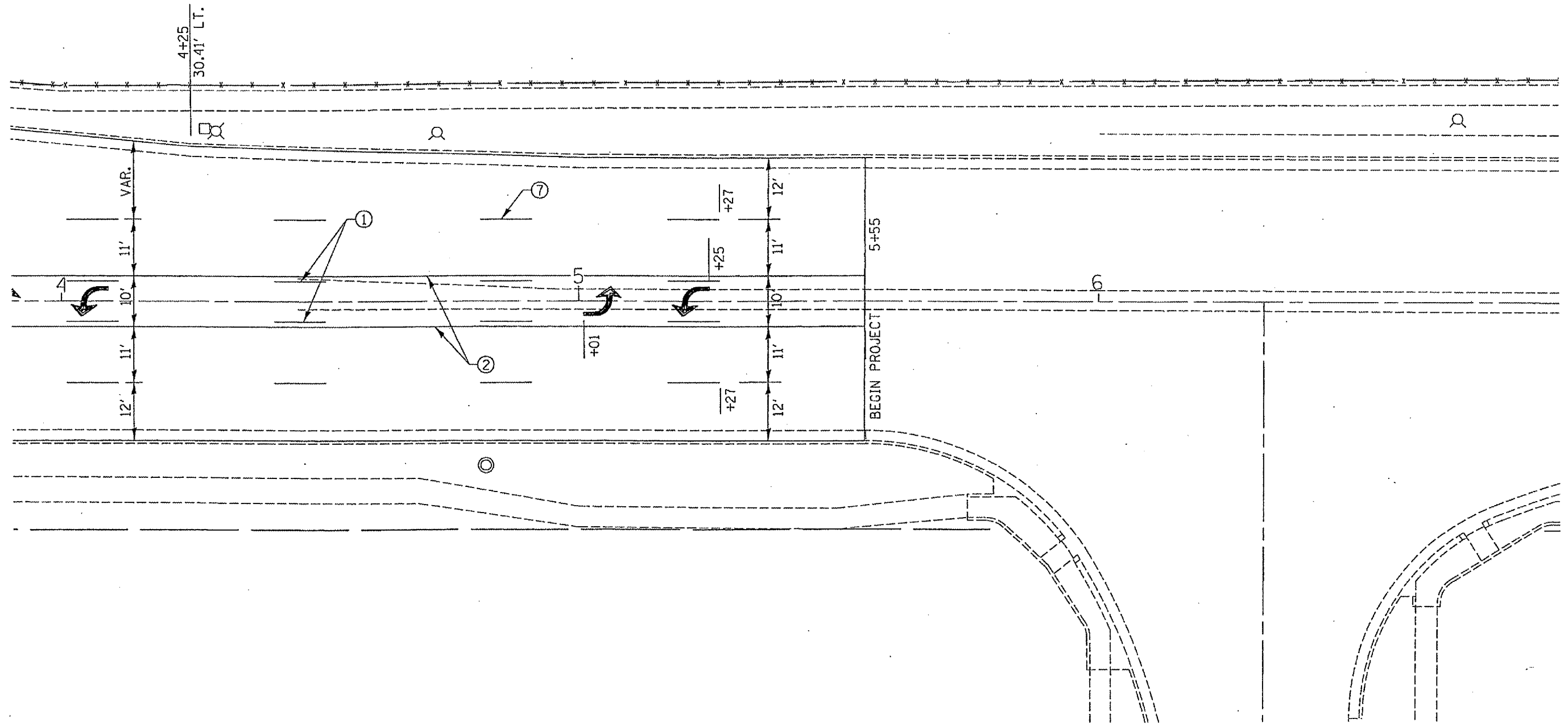

F.A.P. RTE.	SECTION	COUNTY	TOTAL SHEETS	SHEET NO.
811	(2250)I	CHAMPAIGN	22	11

CONTRACT NO. 70437



STRIPING KEY	
YELLOW	WHITE
1 4" SKIP-DASH	7 4" SKIP-DASH
2 4" SOLID	8 4" SOLID
3 12" DIAGONAL	9 12" DIAGONAL
4 4" DOUBLE (NARROW)	10 6" CROSS WALK
5 4" DOUBLE (WIDE)	11 24" STOP BAR
6 RESERVED	12 8" SOLID
	13 4" LANE LINE EXTENSIONS
	14 RESERVED

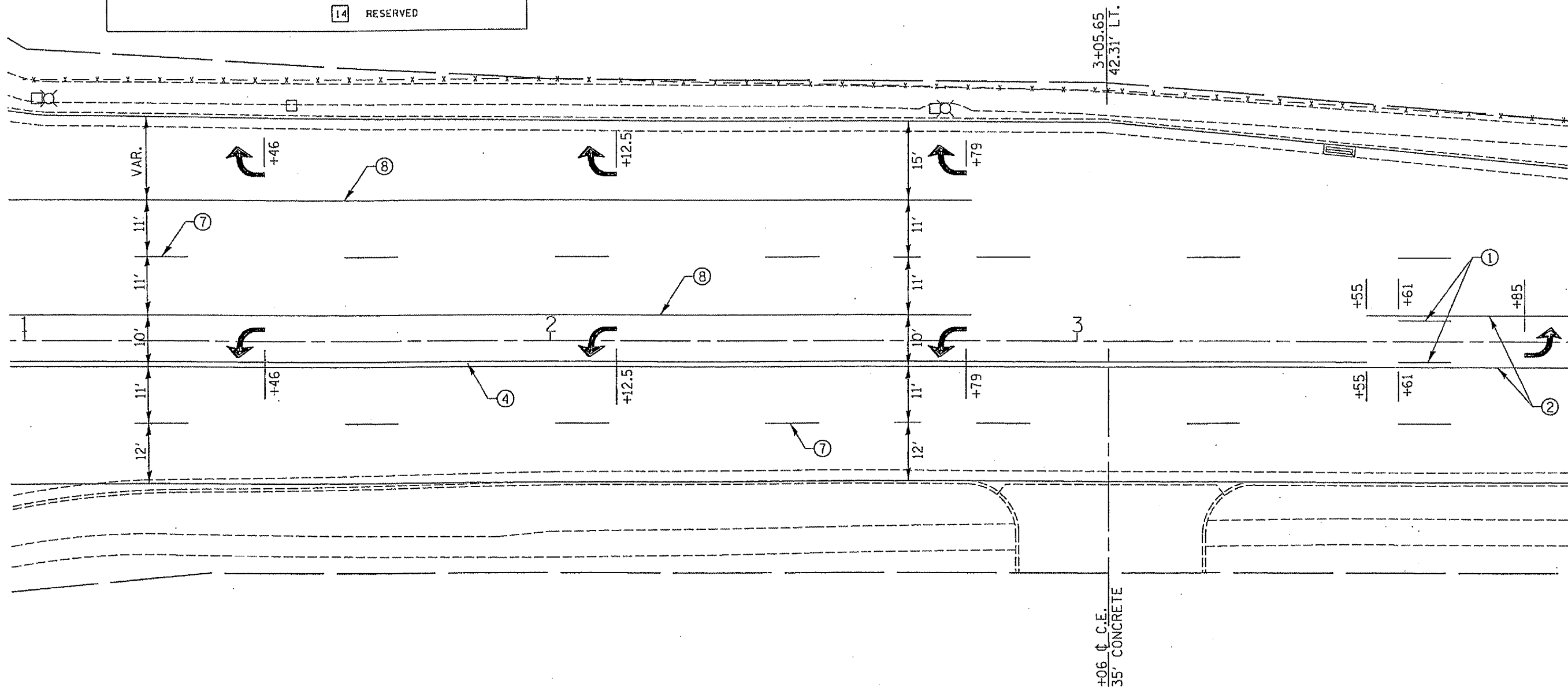

F.A.P. RTE.	SECTION	COUNTY	TOTAL SHEETS	SHEET NO.
811	(2250)I	CHAMPAIGN	22	12

CONTRACT NO. 70437

STRIPING KEY

YELLOW		WHITE	
1	4" SKIP-DASH	7	4" SKIP-DASH
2	4" SOLID	8	4" SOLID
3	12" DIAGONAL	9	12" DIAGONAL
4	4" DOUBLE (NARROW)	10	6" CROSS WALK
5	4" DOUBLE (WIDE)	11	24" STOP BAR
6	RESERVED	12	8" SOLID
		13	4" LANE LINE EXTENSIONS
		14	RESERVED



STATION 53+27.19 (BK) =
STATION 0+00.00 (AH)

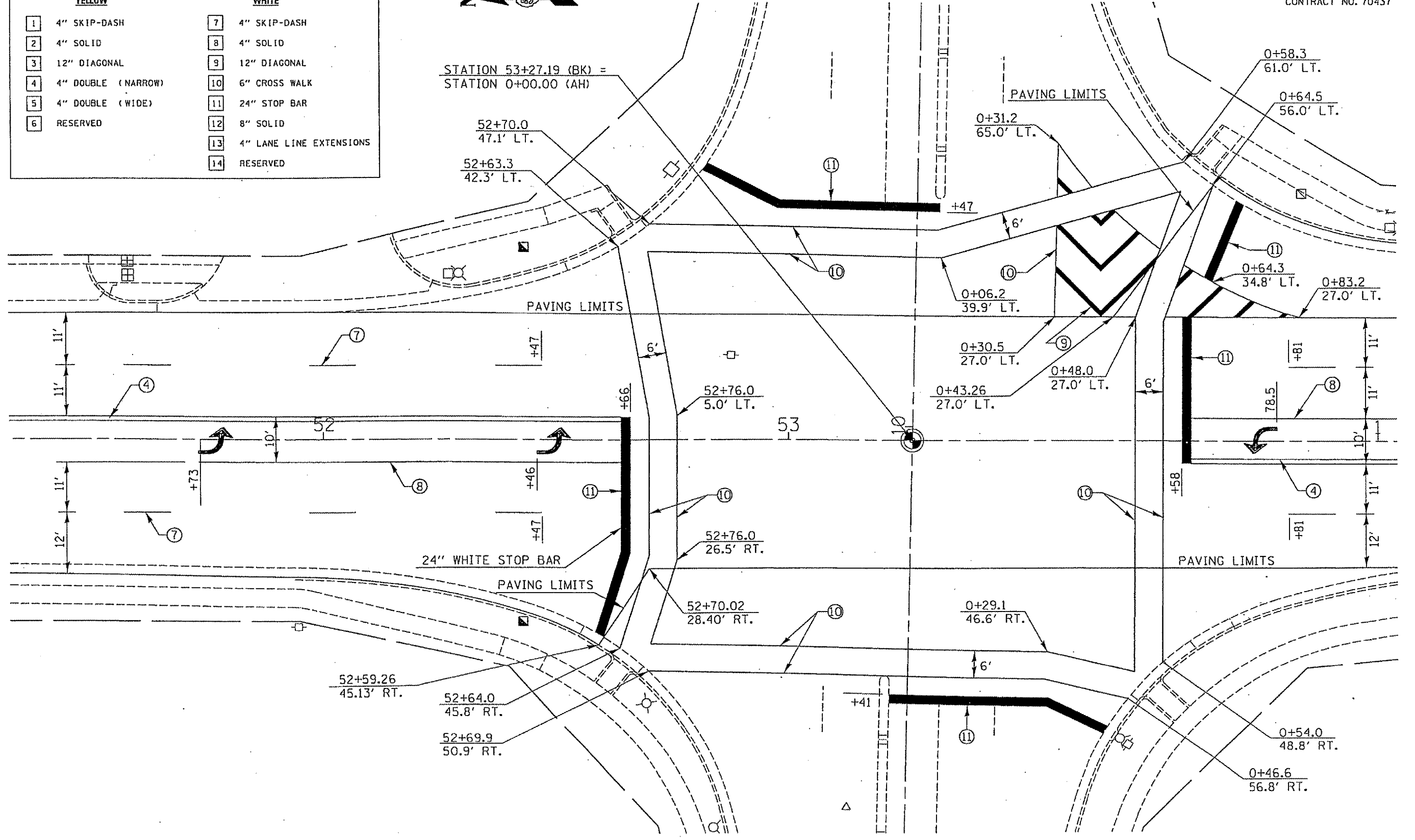

F.A.P. RTE.	SECTION	COUNTY	TOTAL SHEETS	SHEET NO.
811	(2250)I	CHAMPAIGN	22	13

CONTRACT NO. 70437



STRIPING KEY	
YELLOW	WHITE
1 4" SKIP-DASH	7 4" SKIP-DASH
2 4" SOLID	8 4" SOLID
3 12" DIAGONAL	9 12" DIAGONAL
4 4" DOUBLE (NARROW)	10 6" CROSS WALK
5 4" DOUBLE (WIDE)	11 24" STOP BAR
6 RESERVED	12 8" SOLID
	13 4" LANE LINE EXTENSIONS
	14 RESERVED

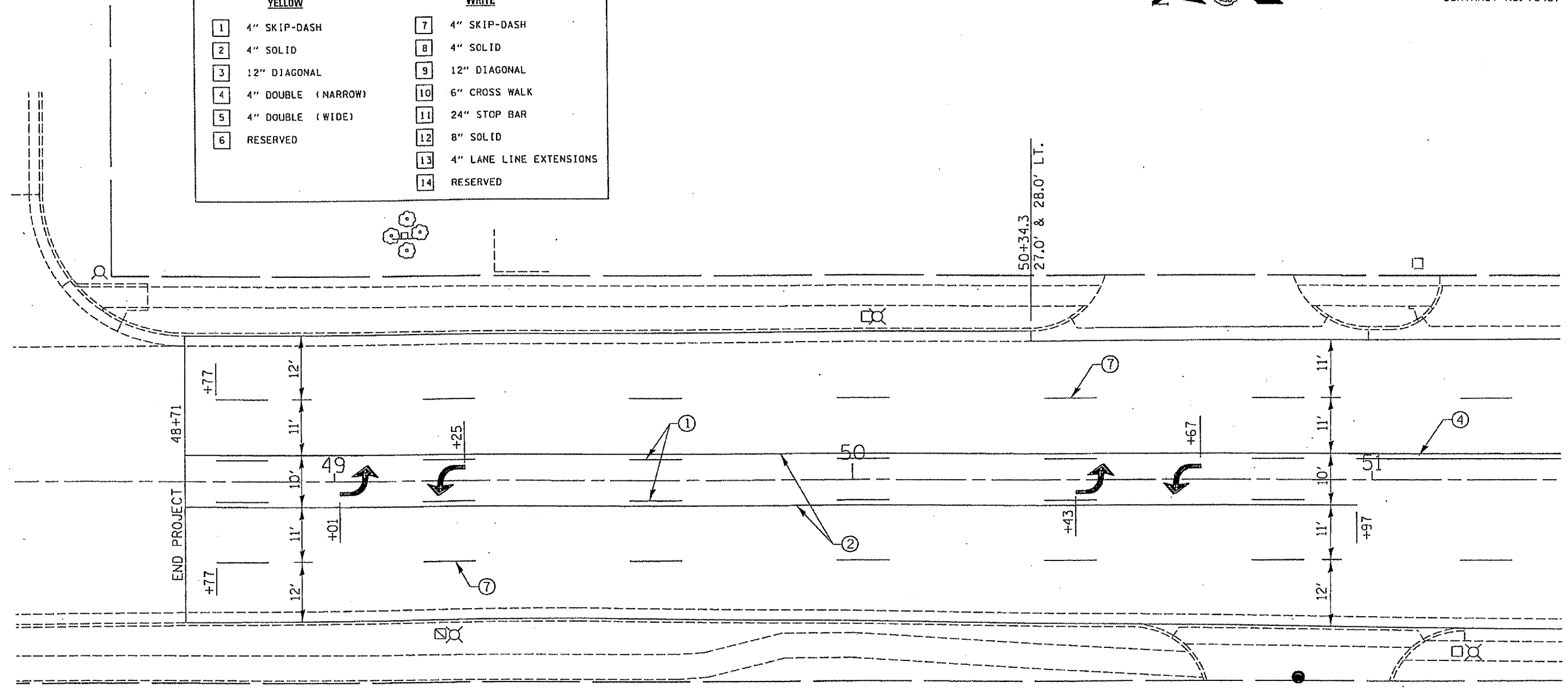

F.A.P. RTE.	SECTION	COUNTY	TOTAL SHEETS	SHEET NO.
811	(2250)I	CHAMPAIGN	22	14

CONTRACT NO. 70437

PAVEMENT PATCHING (PARTIAL DEPTH)

(PREVIOUSLY RESURFACED JOINTED P.C.C. PAVEMENT)

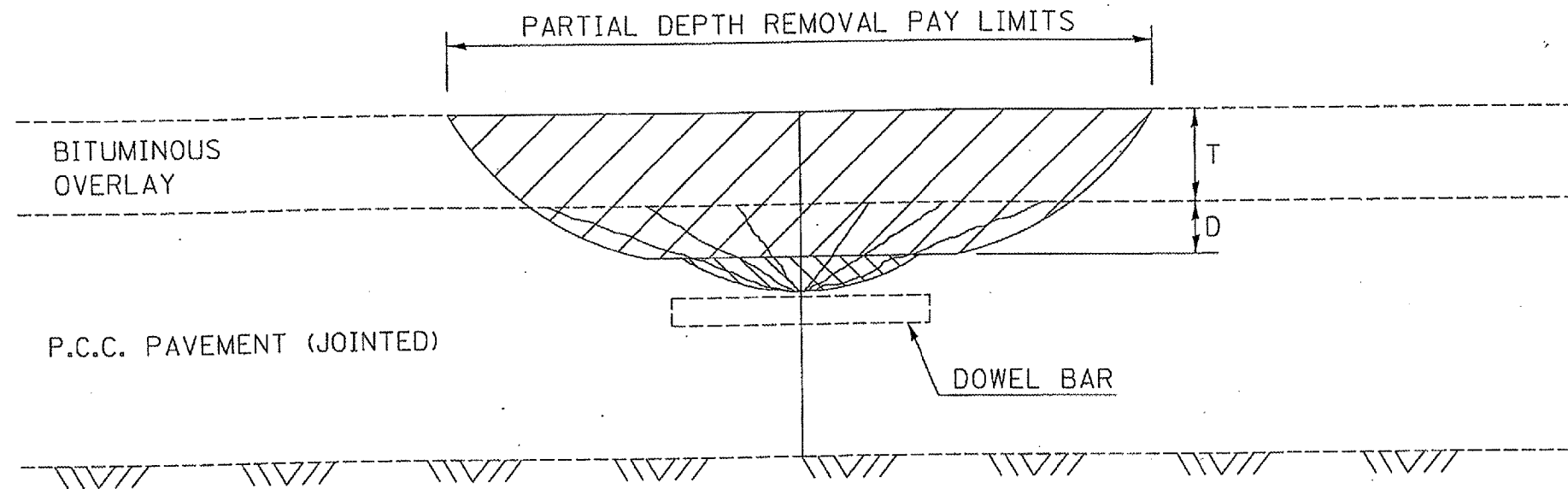

GENERAL NOTES

ALL VOLUME OF REMOVAL LIMITS TO BE REPLACED WITH BITUMINOUS MIXTURE FOR PATCHING.

T = THICKNESS OF BITUMINOUS OVERLAY(S). SEE TYPICAL CROSS SECTIONS.

D = DEPTH OF MACHINE REMOVAL INTO EXISTING P.C.C. PAVEMENT (3" (75 mm) ± OR TO SOUND CONCRETE).

JOINT LOCATION SHOWN - OTHER LOCATIONS SIMILAR.

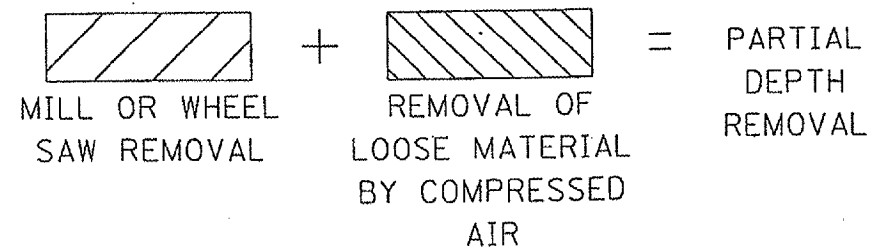

	NAME	DATE	REVISIONS	
DESIGNED	D.L.P.	2/99	NAME	DATE
CHECKED	J.M.S.	2/99	D.L.P.	03/99
CADD NO.	C-5.01		K.A.G.	06/03

ALL DIMENSIONS ARE IN INCHES (MILLIMETERS) UNLESS OTHERWISE SHOWN.

F.A.P. RTE.	SECTION	COUNTY	TOTAL SHEETS	SHEET NO.
811	(2250)I	CHAMPAIGN	22	15

CONTRACT NO. 70437

DETAIL FOR MILLING AT INTERSECTION

STATION 53+27.19 (BK) =
STATION 0+00.00 (AH)

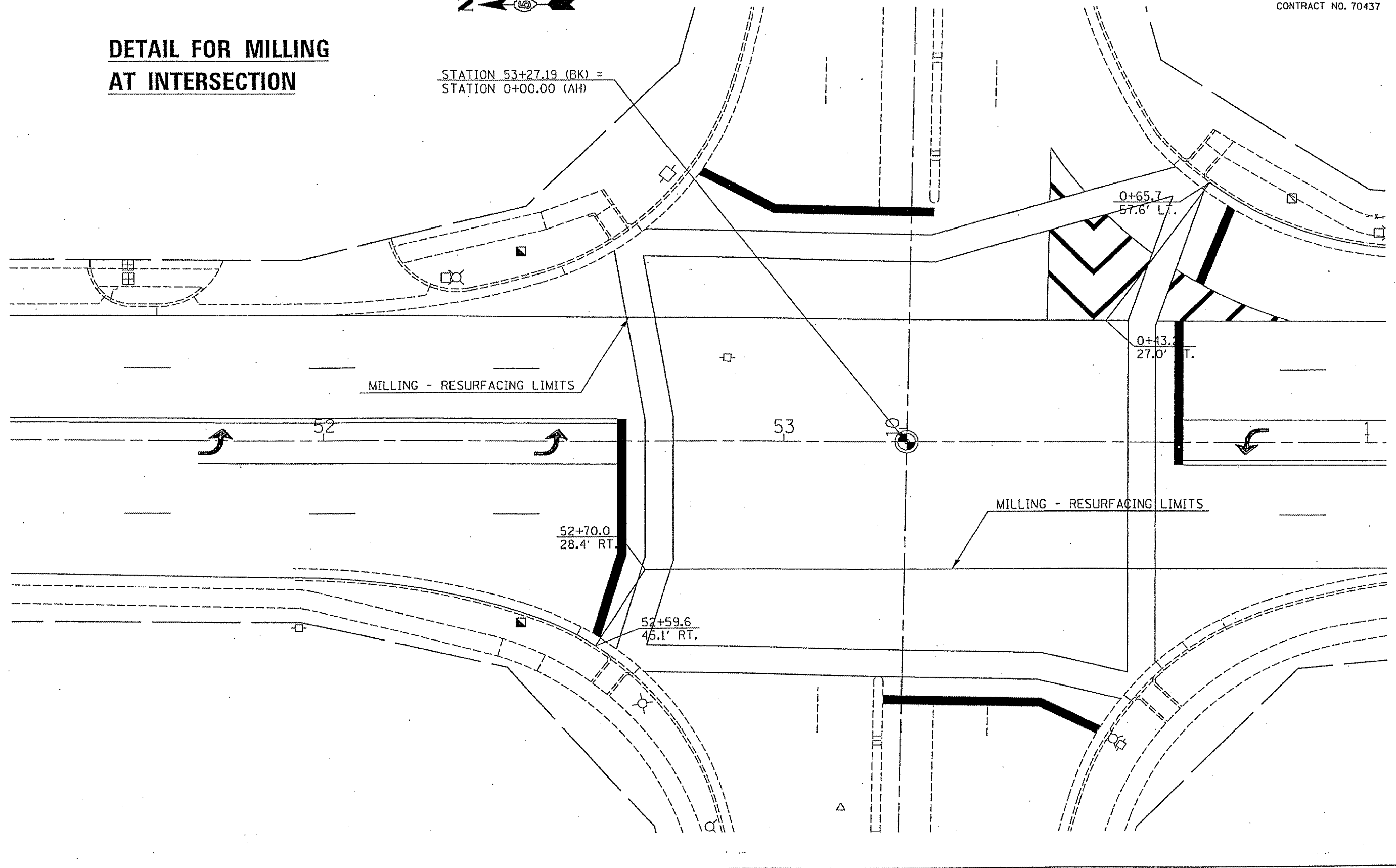

F.A.P. RTE.	SECTION	COUNTY	TOTAL SHEETS	SHEET NO.
811	(2250)I	CHAMPAIGN	22	16

CONTRACT NO. 70437

DETAIL FOR LOOP LOCATIONS MATTIS AVENUE (F.A.P. 811)

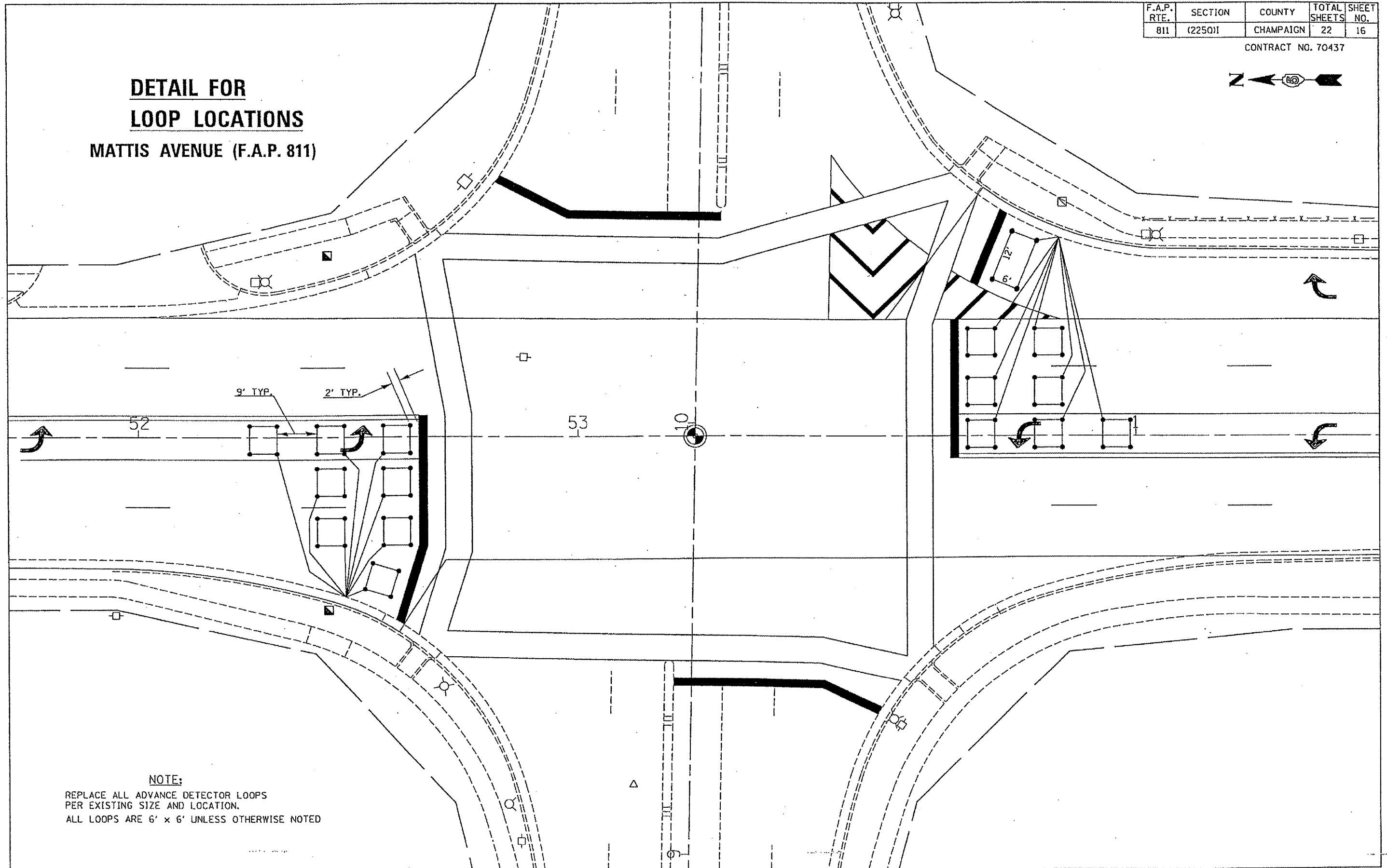
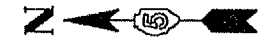

NOTE:
REPLACE ALL ADVANCE DETECTOR LOOPS
PER EXISTING SIZE AND LOCATION.
ALL LOOPS ARE 6' x 6' UNLESS OTHERWISE NOTED

TYPICAL APPLICATIONS OF PAVEMENT MARKINGS AND MARKERS

F.A.P. RTE.	SECTION	COUNTY	TOTAL SHEETS	SHEET NO.
811	(2250)I	CHAMPAIGN	22	17

CONTRACT NO. 70437

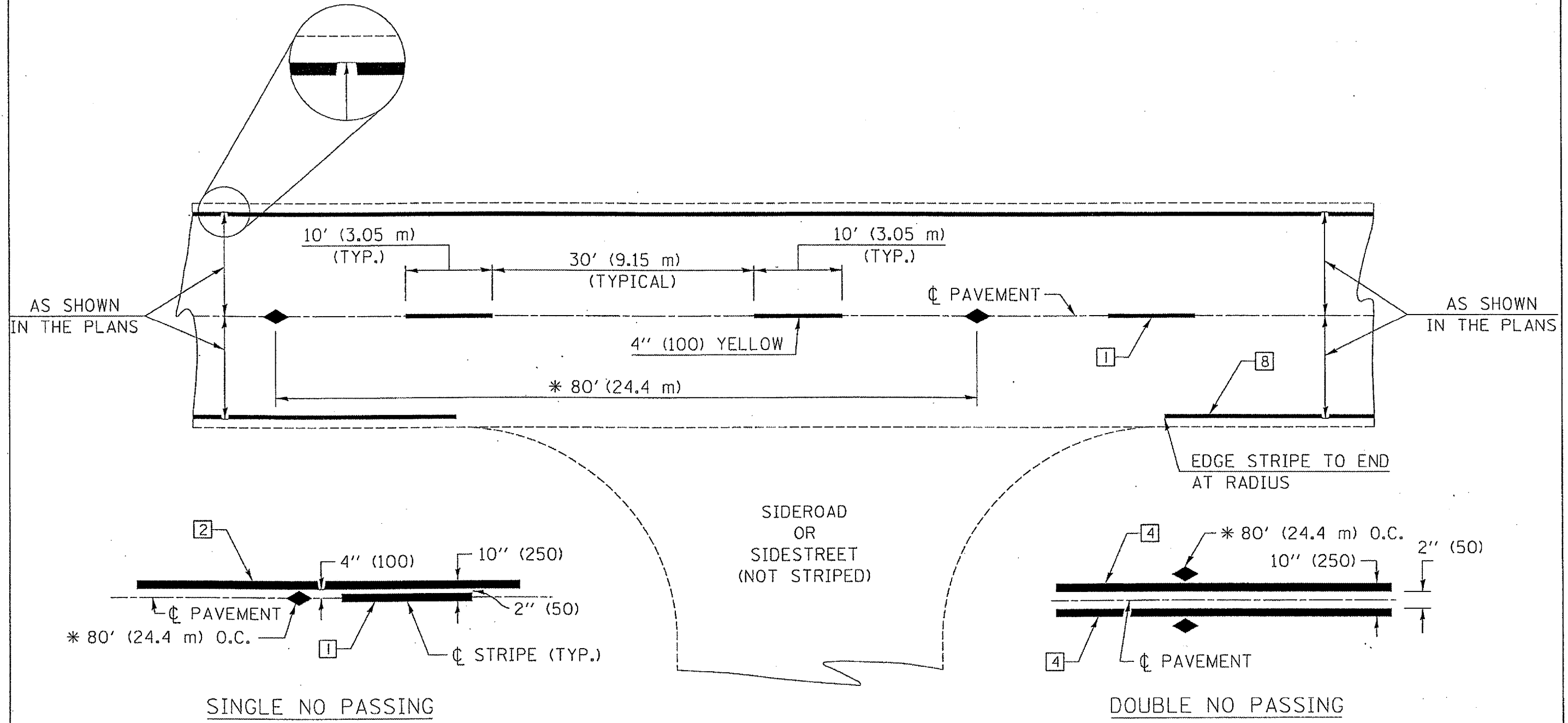

* REDUCE TO 40' (12.2 m) O.C. ON CURVES WITH POSTED OR ADVISORY SPEEDS OF 45 mph (70 km/h) OR LESS.

SHEET 1 OF 6

	NAME	DATE	REVISIONS	
DESIGNED	J.M.H.	5/85	NAME	DATE
CHECKED	FMS	6/85	GEOMETRICS/K.A.G.	07/02
CADD NO.	F-5.25	6/88	K.A.G.	08/04

ALL DIMENSIONS ARE IN INCHES (MILLIMETERS) UNLESS OTHERWISE SHOWN.

TYPICAL APPLICATIONS OF PAVEMENT MARKINGS AND MARKERS

F.A.P. RTE.	SECTION	COUNTY	TOTAL SHEETS	SHEET NO.
811	(22501)	CHAMPAIGN	22	18

CONTRACT NO. 70437

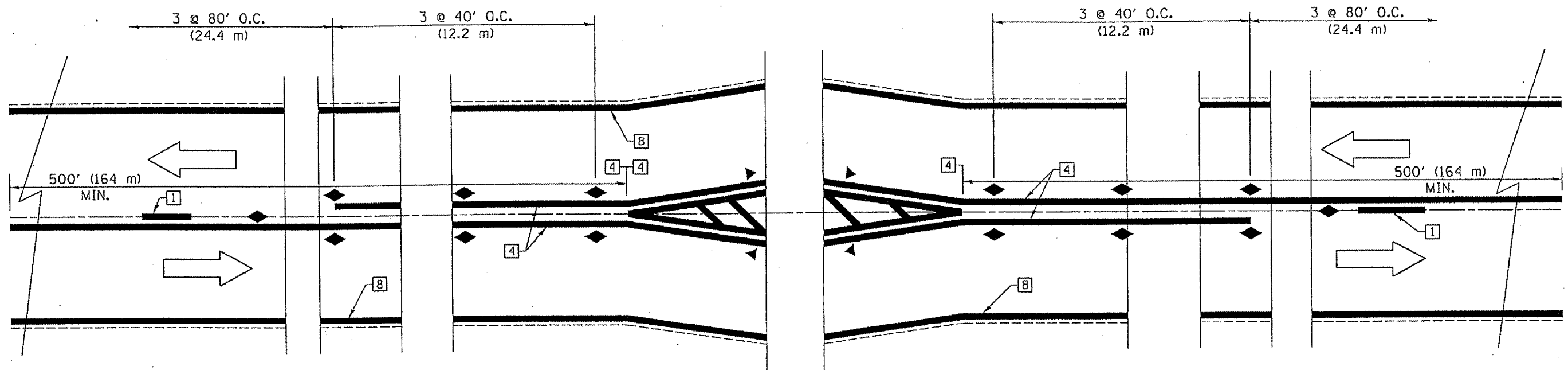

DETAIL OF RURAL LEFT TURN LANE

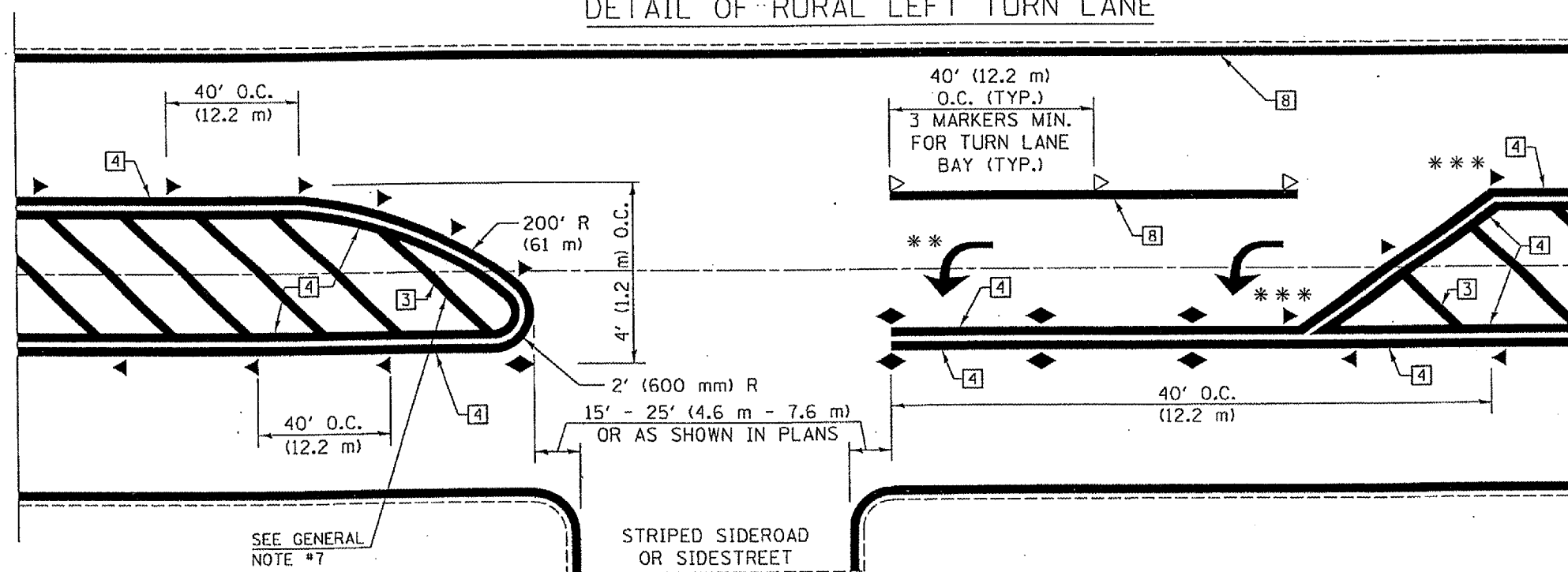

SEE GENERAL NOTE #7

STRIPED SIDEROAD OR SIDESTREET

SHEET 2 OF 6

*** REDUCE SPACING IF NECESSARY TO ASSURE MARKERS AT CORNER POINTS.

** TURN ARROWS SHALL BE PLACED AS SHOWN ON SHEET #4 OF #6.

	NAME	DATE	REVISIONS	
DESIGNED	J.M.H.	5/85	NAME	DATE
CHECKED	FMS	6/85	GEOMETRICS/K.A.G.	07/02
CADD NO.	F-5.25	6/88	K.A.G.	08/04

ALL DIMENSIONS ARE IN INCHES (MILLIMETERS) UNLESS OTHERWISE SHOWN.

TYPICAL APPLICATIONS OF PAVEMENT MARKINGS AND MARKERS

F.A.P. RTE.	SECTION	COUNTY	TOTAL SHEETS	SHEET NO.
811	(2250)I	CHAMPAIGN	22	19

CONTRACT NO. 70437

TYPICAL PAVEMENT MARKING LEGEND

- 1 4" (100) SKIP-DASH (YELLOW)
- 2 4" (100) SOLID (YELLOW)
- 3 12" (300) DIAGONAL (YELLOW)
- 4 4" (100) DOUBLE YELLOW (NARROW)
- 5 RESERVED
- 6 RESERVED
- 7 4" (100) SKIP-DASH (WHITE)
- 8 4" (100) SOLID (WHITE)
- 9 12" (300) DIAGONAL (WHITE)
- 10 6" (150) CROSS WALK (WHITE)
- 11 24" (600) STOP BAR (WHITE)
- 12 8" (200) SOLID (WHITE)
- 13 4" (100) LANE LINE EXTENSIONS (WHITE)
- 14 4" (100) PARKING WHITE

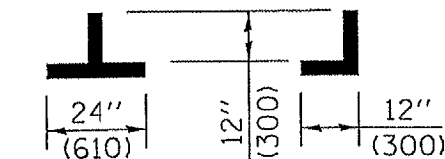
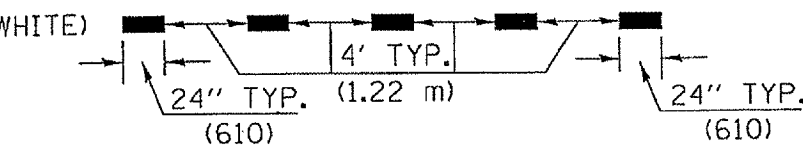
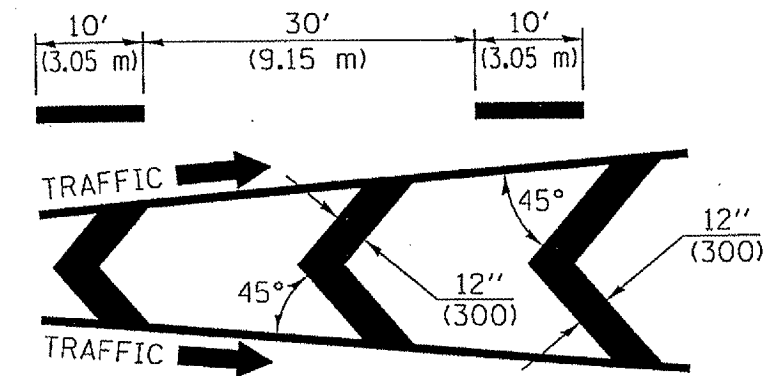
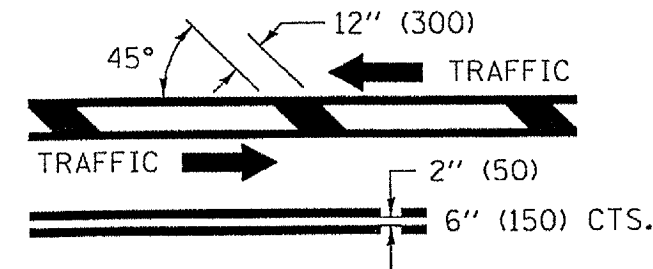
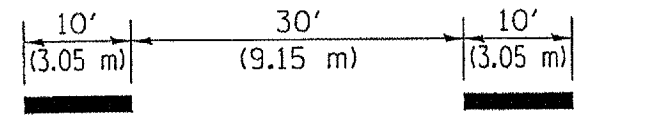

TYPICAL PAVEMENT MARKERS LEGEND

- ◆ TWO-WAY AMBER MARKER
- ▶ ONE-WAY AMBER MARKER
- ▷ ONE-WAY CRYSTAL MARKER

SHEET 3 OF 6

	NAME	DATE	REVISIONS	
DESIGNED	J.M.H.	5/85	NAME	DATE
CHECKED	FMS	6/88	GEOMETRICS/K.A.G.	07/02
CADD NO.	F-5.25	6/85	K.A.G.	08/04
	CTD	6/88		

ALL DIMENSIONS ARE IN INCHES (MILLIMETERS) UNLESS OTHERWISE SHOWN.

TYPICAL APPLICATIONS OF PAVEMENT MARKINGS AND MARKERS

F.A.P. RTE.	SECTION	COUNTY	TOTAL SHEETS	SHEET NO.
811	(22501)	CHAMPAIGN	22	20

CONTRACT NO. 70437

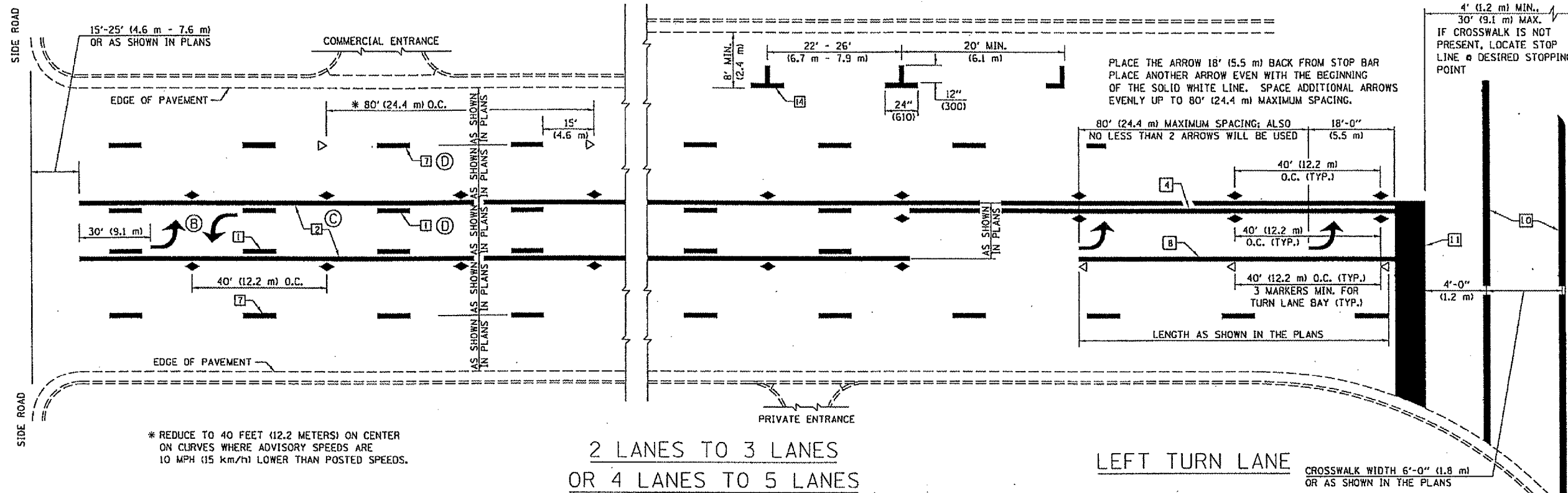

3 PAIRS MARKERS @ 40' (12.2 m) O.C.

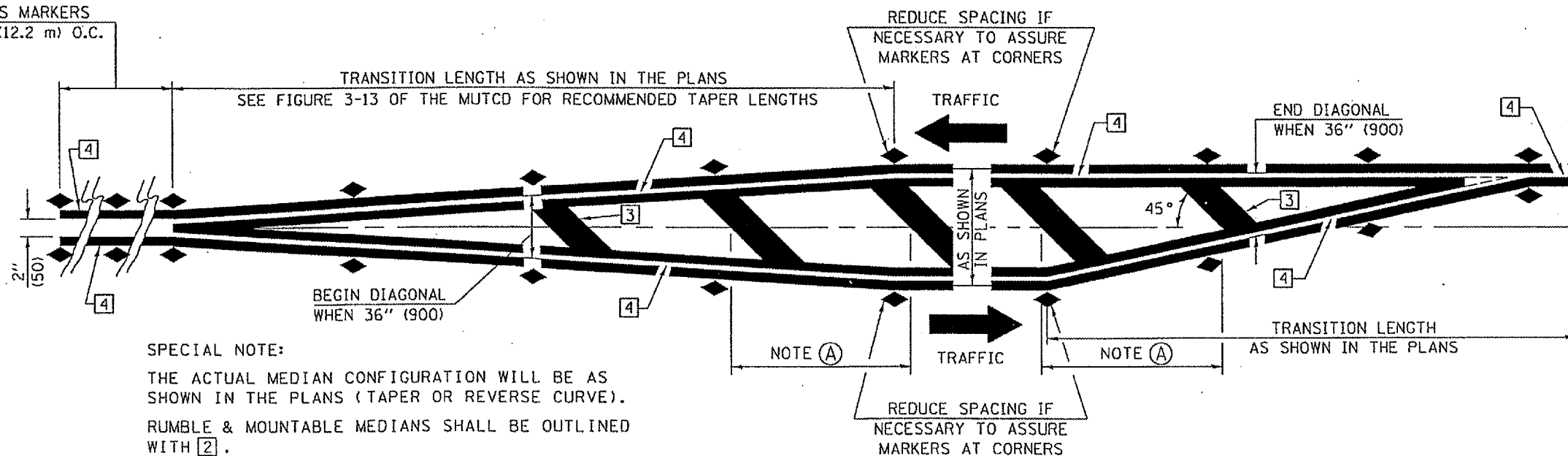

SHEET 4 OF 6

TYPICAL MEDIAN TRANSITIONS

NOTE (A)
SEE GENERAL NOTE #7

DESIGNED	NAME	DATE	REVISIONS	
J.M.H.	J.M.H.	5/85	NAME	DATE
FMS	FMS	6/85	GEOMETRICS/K.A.G.	07/02
CTD	CTD	6/88	K.A.G.	08/04
CADD NO.	F-5.25			

ALL DIMENSIONS ARE IN INCHES (MILLIMETERS) UNLESS OTHERWISE SHOWN.

TYPICAL APPLICATIONS OF PAVEMENT MARKINGS AND MARKERS

F.A.P. RTE.	SECTION	COUNTY	TOTAL SHEETS	SHEET NO.
811	(2250)I	CHAMPAIGN	22	21

CONTRACT NO. 70437

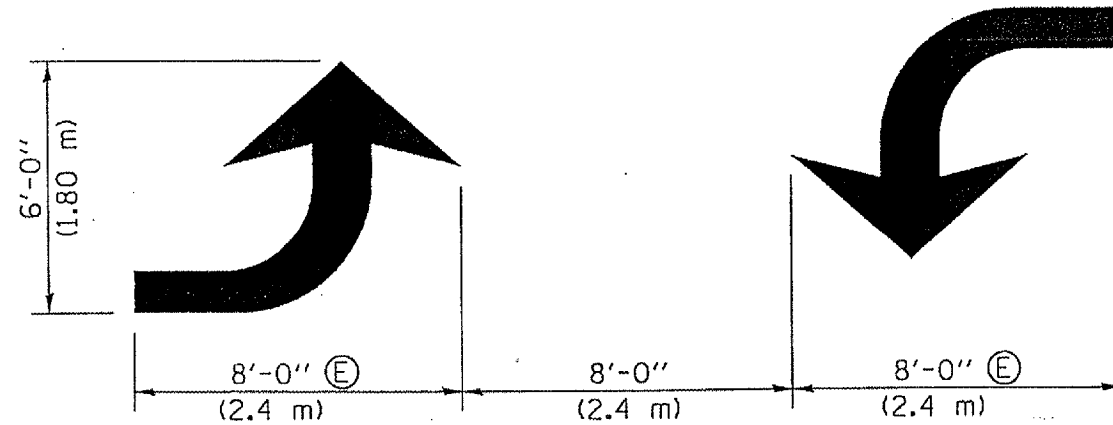

TYPICAL DOUBLE
TURN ARROWS (WHITE)

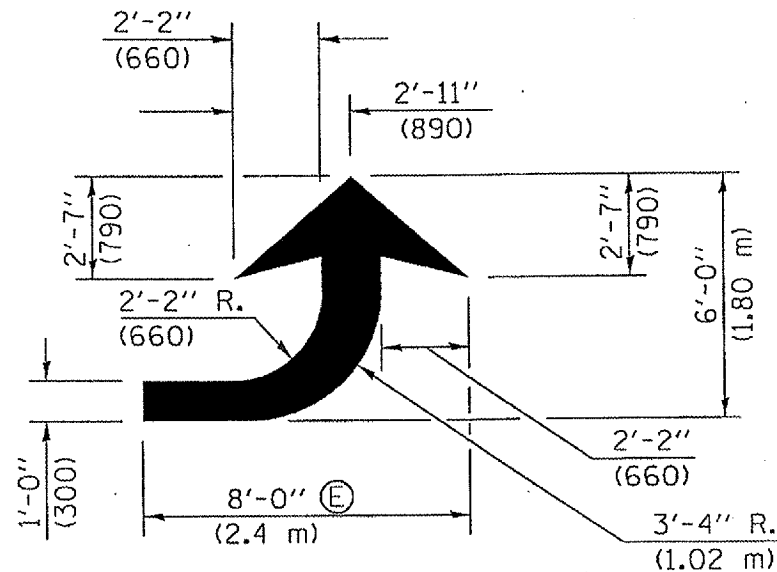

LEFT ARROW

REVERSE FOR RIGHT ARROW
AREA = 15.6 SQ. FT. (1.47 m²)
(WHITE)

SPECIAL NOTES:

- Ⓑ TURN ARROW PAIRS SHALL BE PLACED AT 250' (75 m) INTERVALS AND SHALL BE EVENLY SPACED BETWEEN BOTH ENDS OF THE BIDIRECTIONAL LEFT TURN LANE.
- Ⓒ THE SOLID YELLOW PAVEMENT MARKINGS [2] SHOULD GENERALLY START OR END NEAR THE RADIUS POINT OF EACH STREET RETURN EXCEPT WHERE ONE OR BOTH ENDS WOULD INCLUDE STOP BARS.
- Ⓓ THE SKIP-DASH PAVEMENT MARKINGS [1] OR [7] SHOULD BE CENTERED BETWEEN BOTH ENDS OF EACH CITY BLOCK AND SHALL BE PLACED SO THEY LINE UP ACROSS FROM EACH OTHER. SEE EXAMPLE ON SHEET 4 OF 6.
- Ⓔ TURN ARROW SIZE DEPENDS ON THE LOCATION.
RURAL LOCATION - LARGE ARROW SIZE
URBAN LOCATION - SMALL ARROW SIZE

SHEET 5 OF 6

	NAME	DATE	REVISIONS	
DESIGNED	J.M.H.	5/85	NAME	DATE
CHECKED	FMS	6/88	GEOMETRICS/K.A.G.	07/02
CADD NO.	F-5.25		K.A.G.	08/04

ALL DIMENSIONS ARE IN INCHES (MILLIMETERS)
UNLESS OTHERWISE SHOWN.

TYPICAL APPLICATIONS OF PAVEMENT MARKINGS AND MARKERS

F.A.P. RTE.	SECTION	COUNTY	TOTAL SHEETS	SHEET NO.
811	(2250)I	CHAMPAIGN	22	22

CONTRACT NO. 70437

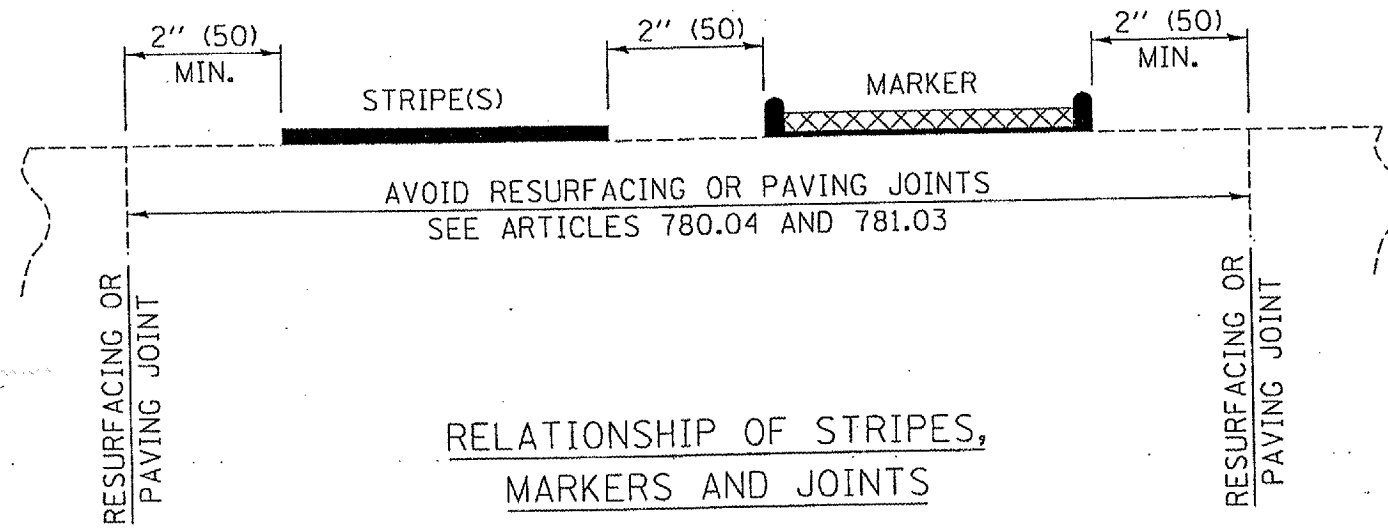

RELATIONSHIP OF STRIPES, MARKERS AND JOINTS

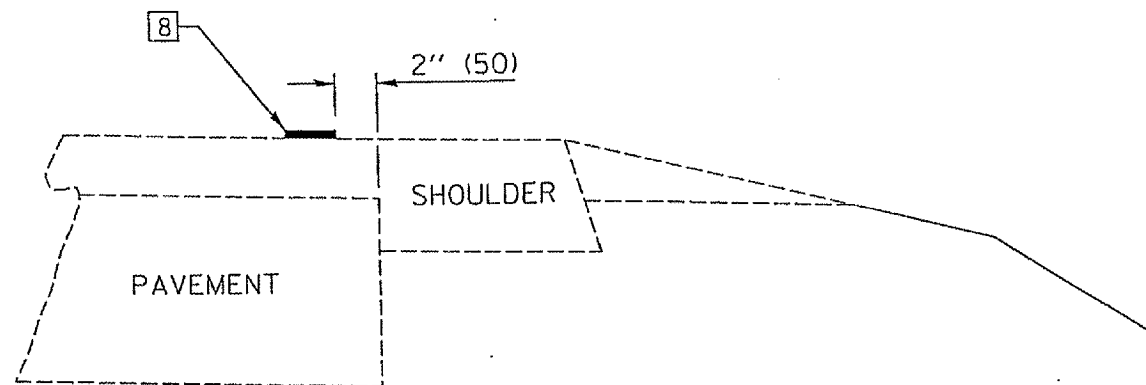

RELATIONSHIP OF EDGE STRIPE TO SAFETY SHOULDER OR PAVED SURFACE

GENERAL NOTES

1. WHEN MEDIANS ARE PRESENT, PAVEMENT MARKINGS ARE TO BE PLACED ADJACENT TO MEDIANS.
2. SCALE: NONE
3. SOME OF THE INFORMATION INCLUDED WITH THIS DETAIL MAY NOT BE APPLICABLE TO THIS IMPROVEMENT.
4. PAVEMENT MARKINGS ARE TO BE EXTENDED THROUGH OMISSIONS WHEN APPLICABLE.
5. A STRIPING KEY IS AVAILABLE ELSEWHERE AND SHALL BE SHOWN WHERE THE QUANTITIES ARE LISTED.
6. FINAL PAVEMENT MARKINGS SHALL BE IN PLACE PRIOR TO PLACING ANY RAISED REFLECTIVE PAVEMENT MARKERS.
7. THE FOLLOWING CRITERIA SHALL BE USED FOR SELECTING THE DIAGONAL PAVEMENT MARKING SPACING,
 < 30 MPH USE 15' (< 50 km/h USE 4.5 m)
 30-45 MPH USE 20' (50-75 km/h USE 6.0 m)
 > 45 MPH USE 30' (> 75 km/h USE 9.0 m)

SHEET 6 OF 6

	NAME	DATE	REVISIONS	
DESIGNED	J.M.H.	5/85	NAME	DATE
CHECKED	FMS	6/85	GEOMETRICS/K.A.G.	07/02
CADD NO.	F-5.25	6/88	K.A.G.	08/04

ALL DIMENSIONS ARE IN INCHES (MILLIMETERS) UNLESS OTHERWISE SHOWN.