

LOCATION MAP #1 IL 1, FROM THE SOUTHERN EDGE OF RIDGEFARM TO THE NORTHERN EDGE OF PARIS VERMILION & EDGAR COUNTIES /RURAL 2-LANE

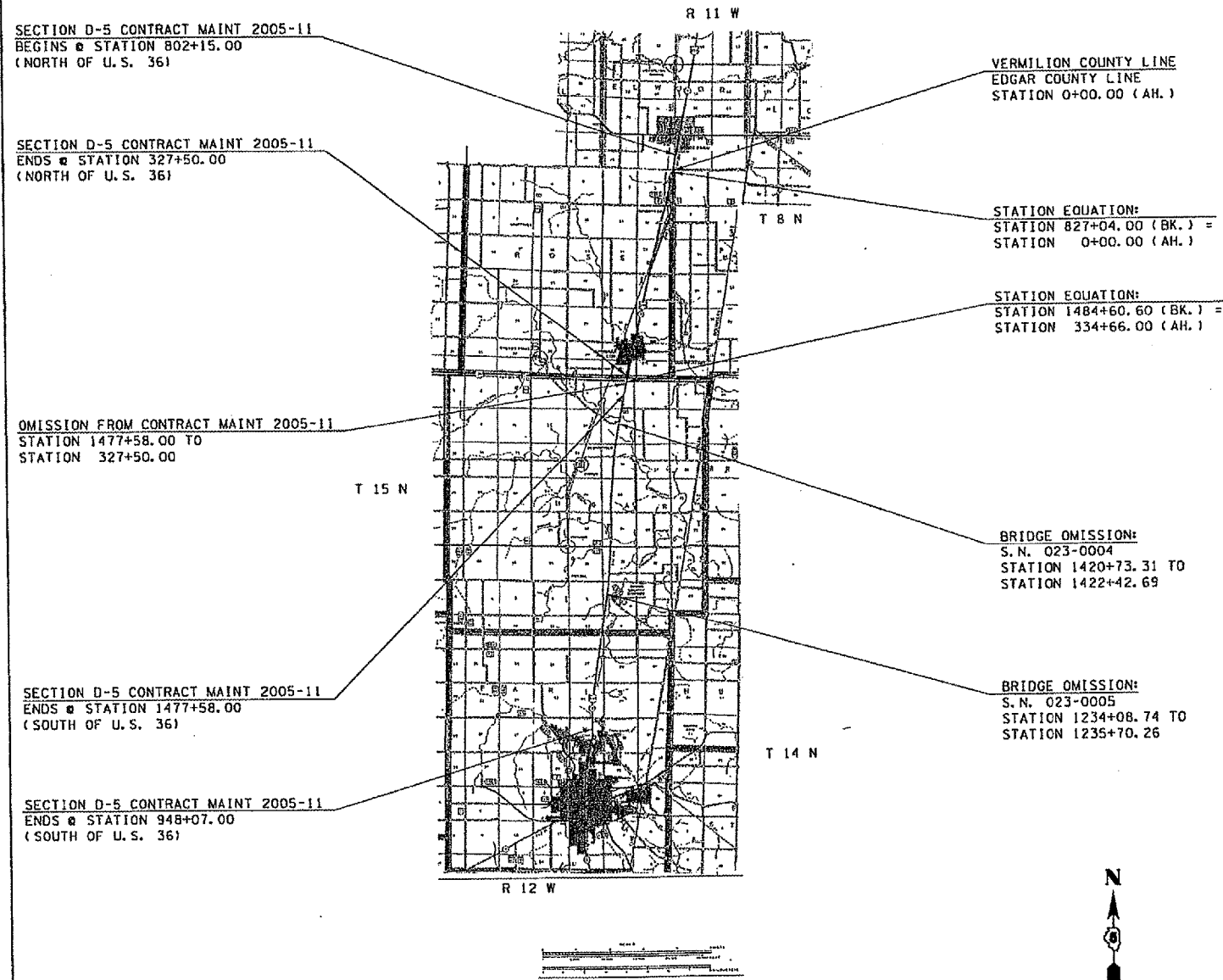

TOTAL LENGTH OF SECTION = 89,608.60 FT. = 16.971 MILES
NET LENGTH OF SECTION = 87,859.10 FT. = 16.640 MILES

LOCATION MAP #2 IL 1, FROM NCL OF PARIS TO SCL OF PARIS

EDGAR COUNTY /RURAL 2-LANE & URBAN MULTI-LANE

F.A. RYE. VAR.	SECTION	COUNTY	TOTAL SHEETS	SHEET NO.
	*	VARIOUS	25	3

D-5 CONTRACT MAINT 2005-11
CONTRACT NO. 70450

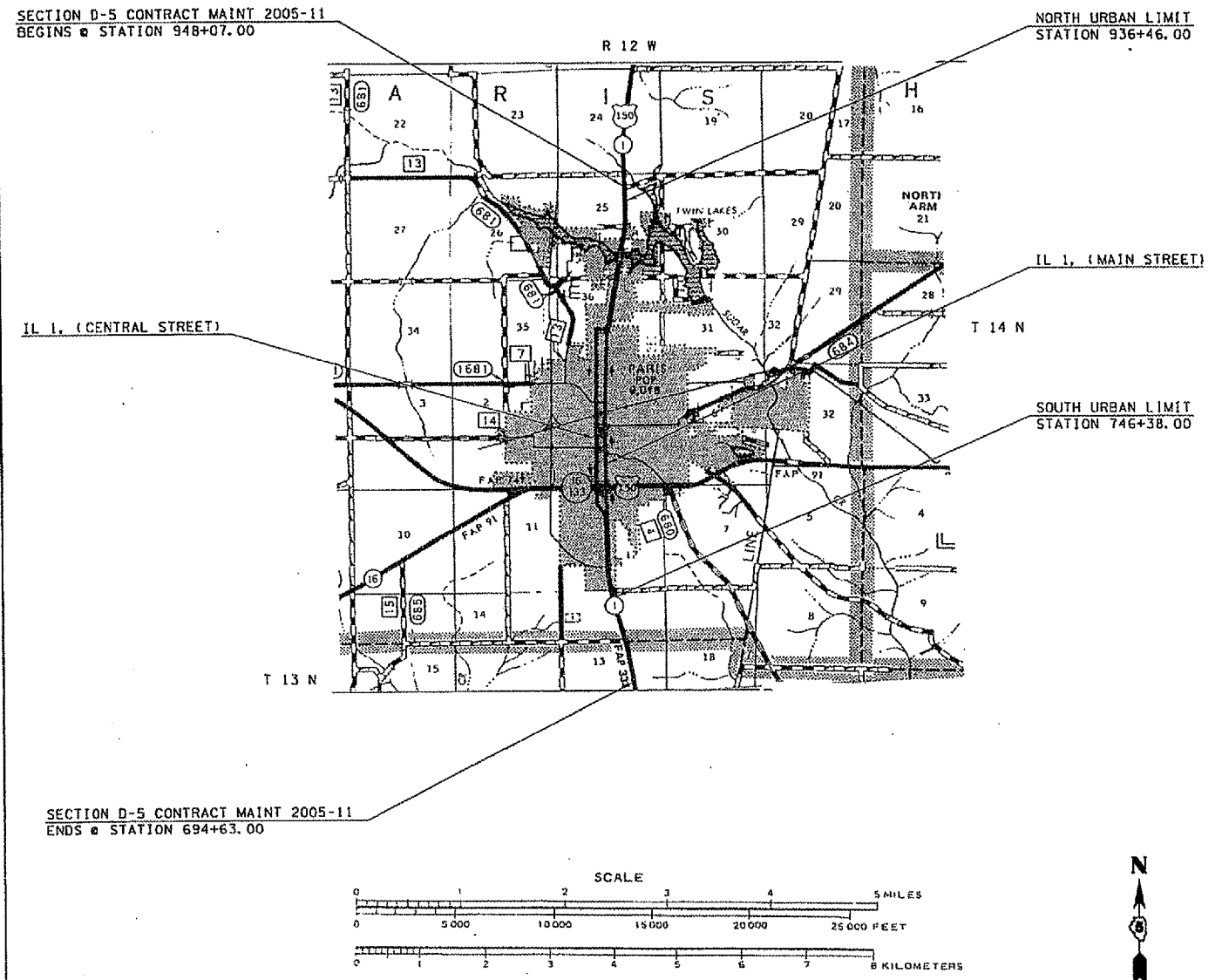

TOTAL LENGTH OF SECTION = 25,344.00 FT. = 4.800 MILES
NET LENGTH OF SECTION = 25,344.00 FT. = 4.800 MILES