

F.A. RTE.	SECTION	COUNTY	TOTAL SHEETS	SHEET NO.
VAR.	-	VARIOUS	25	6

• D-5 CONTRACT MAINT 2005-11
CONTRACT NO. 70450

LOCATION MAP #5 IL ROUTE 49 FROM INTERSECTION WITH IL RTE. 16 SOUTH TO NORTH OF INTERSECTION WITH F.A.I. 70

COLES & CLARK COUNTIES /RURAL 2-LANE

SECTION D-5 CONTRACT MAINT 2005-11
ENDS @ STATION 90+82.00

STATION EQUATION:
STATION 574+75.00 (BK.) =
STATION 575+25.00 (AH.)

COLES - CLARK
COUNTY LINE
STATION 656+61.00

SECTION D-5 CONTRACT MAINT 2005-11
BEGINS @ STATION 881+41.00

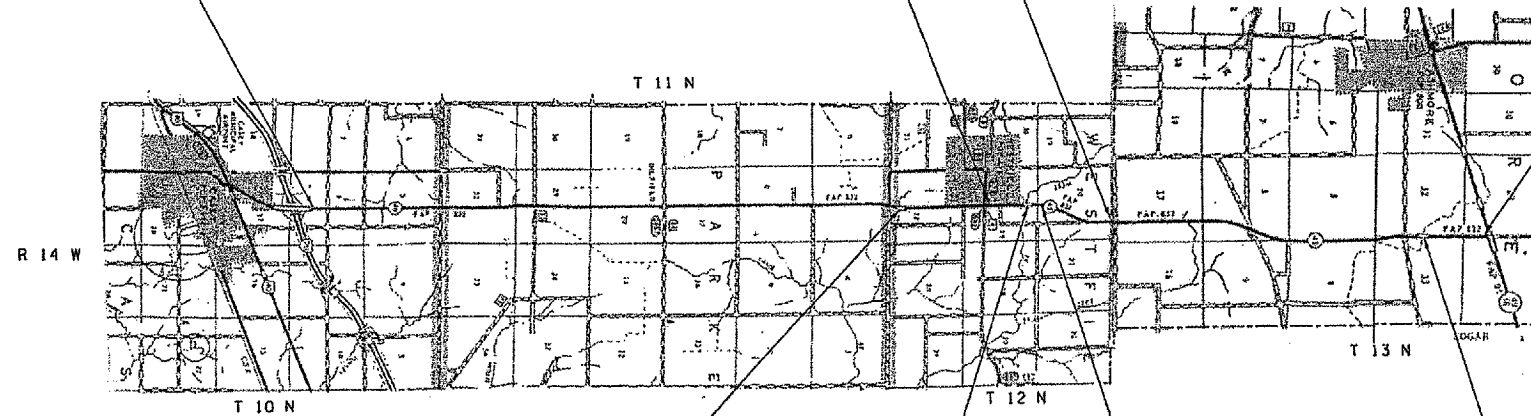

BRIDGE OMISSION:
S.N. 012-0061
STATION 502+91.02 TO
STATION 503+57.02

BRIDGE OMISSION:
S.N. 012-0066
STATION 593+60.00 TO
STATION 595+52.00

STATION EQUATION:
STATION 615+02.00 (BK.) =
STATION 614+52.00 (AH.)

BRIDGE OMISSION:
S.N. 015-0071
STATION 846+80.67 TO
STATION 847+85.33



TOTAL LENGTH OF SECTION = 79,059.00 FT. = 14.973 MILES
NET LENGTH OF SECTION = 78,696.34 FT. = 14.905 MILES