

F.A.P. RTE.	SECTION	COUNTY	TOTAL SHEETS	SHEET NO.
662	*	SANGAMON	18	1

* D6 MEDIAN REPAIR 2005

STATE OF ILLINOIS
DEPARTMENT OF TRANSPORTATION
DIVISION OF HIGHWAYS

PROPOSED HIGHWAY PLANS

FAP ROUTE 662(IL 4), 71(IL 54) & 75(IL 29)
SECTION D6 MEDIAN REPAIR 2005

SANGAMON COUNTY
C-96-514-05

D-96-509-05

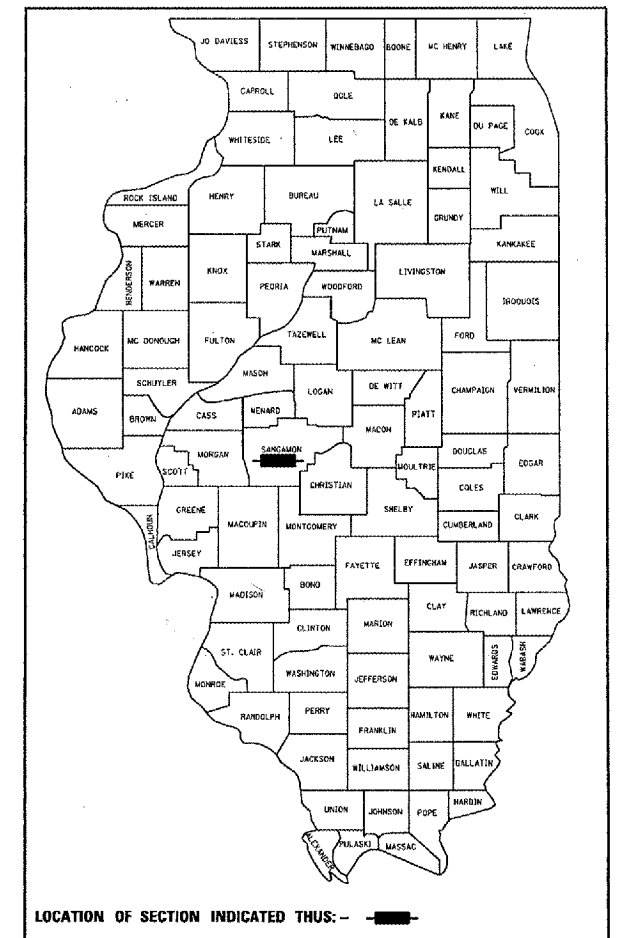

LOCATION OF SECTION INDICATED THIS: — ■ —

INDEX OF SHEETS

1	COVER SHEET
2	GENERAL NOTES
3 - 5	SUMMARY OF QUANTITIES
6 - 7	SCHEDULE OF QUANTITIES
8	LEGEND FOR TRAFFIC SIGNAL DETAILS
9	IL 4\BRUNS LANE PLAN SHEET LOCATION NO.1
10 - 11	TRAFFIC SIGNAL DETECTOR LOOP DETAILS
12	IL 4\ISLES PLAN SHEET LOCATION NO.2
13	IL 54 PLAN SHEET LOCATION NO.3
14 - 18	IL 29 PLAN SHEET LOCATION NO.4

STANDARDS

- 420001 - 05
- 421001 - 01
- 421101 - 05
- 442001 - 02
- 606001 - 02
- 606301 - 02
- 701001 - 01
- 701006 - 02
- 701101 - 01
- 701106 - 01
- 701400 - 02
- 701406 - 04
- 701601 - 04
- 701701 - 04
- 702001 - 05
- 813001 - 01
- 814001
- 877001 - 02
- 878001 - 03
- 880006
- 886001
- 886006
- 701401-03

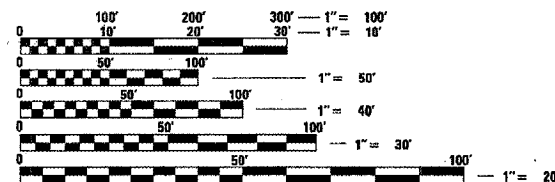

FULL SIZE PLANS HAVE BEEN PREPARED USING STANDARD ENGINEERING SCALES. REDUCED SIZED PLANS WILL NOT CONFORM TO STANDARD SCALES. IN MAKING MEASUREMENTS ON REDUCED PLANS, THE ABOVE SCALES MAY BE USED.

J.U.L.I.E.
JOINT UTILITY LOCATION INFORMATION FOR EXCAVATION
1-800-892-0123

CONTRACT NO. 72950

LOCATION NO. 1
IL 4 AT BRUNS LN IN SPRINGFIELD
(DIP CORRECTION)

LOCATION NO. 2
IL 4 AT ISLES AVE IN SPRINGFIELD
STA 395+21.28 TO
STA 395+37.66
(CONC. ISLAND REPAIR)

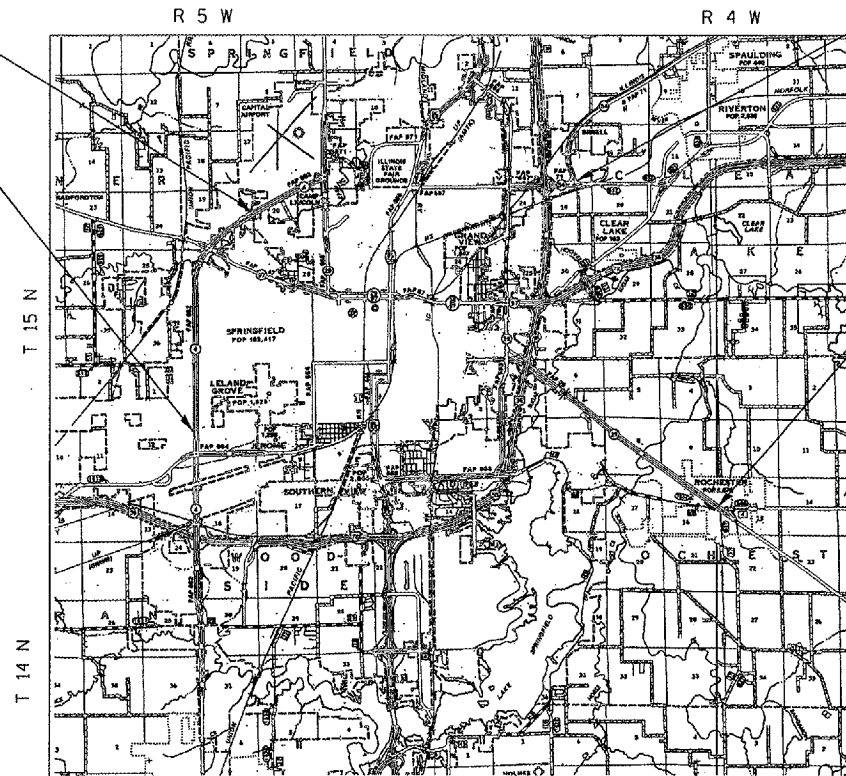

Curb & Gutter / Median Repair / Dip Correction

LOCATION NO. 1 = 50.00 FEET = 0.009 MILES
LOCATION NO. 2 = 16.38 FEET = 0.003 MILES
LOCATION NO. 3 = 513.00 FEET = 0.097 MILES
LOCATION NO. 4 = 2341.87 FEET = 0.444 MILES
TOTAL LENGTH = 2921.25 FEET = 0.553 MILES

LOCATION NO. 3
IL 54 AT SANGAMON AVE
E OF I-55
(CONC. MEDIAN &
ISLAND REPAIR)

LOCATION NO. 4
IL 29 FROM W OF ROCKET DR
TO JOHN ST IN ROCHESTER
(CONC. MEDIAN REPAIR)

STATE OF ILLINOIS
DEPARTMENT OF TRANSPORTATION
DIVISION OF HIGHWAYS

SUBMITTED FEB 10 20 05
Christ M Reed
DISTRICT ENGINEER

March 25 20 05
Mike Hene
ENGINEER OF DESIGN AND ENVIRONMENT

March 25 20 05
Victor Madler
DIRECTOR, DIVISION OF HIGHWAYS

PRINTED BY THE AUTHORITY
OF THE STATE OF ILLINOIS

PROJECT ENGINEER: JOHN C. NEGANGARD (217) 782-6990
SENIOR SQUAD ENGINEER: VINCE J. MADONIA (217) 785-9046

F.A.P. RTE.	SECTION	COUNTY	TOTAL SHEETS	SHEET NO.
662	*	SANGAMON	18	2
STA.		TO STA.		
FED. ROAD DIST. NO.		ILLINOIS	FED. AID PROJECT	
• D6 MEDIAN REPAIR 2005				

GENERAL NOTES

- 1) ALL ELEVATION REFER TO USGS MEAN SEA LEVEL DATUM.
- 2) WHERE SECTION OR SUBSECTION MONUMENTS ARE ENCOUNTERED, THE ENGINEER SHALL BE NOTIFIED BEFORE SUCH MONUMENTS ARE REMOVED. THE CONTRACTOR SHALL PROTECT AND CAREFULLY PRESERVE ALL PROPERTY MARKERS AND MONUMENTS UNTIL THE OWNER AND AUTHORIZED SURVEYOR OR AGENT HAS WITNESSED OR OTHERWISE REFERENCED THEIR LOCATION. IF THE ENGINEER DECIDES TO HAVE THE CONTRACTOR RESET THE MONUMENT, THIS WORK WILL BE PAID FOR IN ACCORDANCE WITH ARTICLE 109.04.
- 3) THE CONTRACTOR SHALL CONTACT J.U.L. I.E. PRIOR TO ANY EXCAVATION TO HAVE ALL PUBLIC AND PRIVATE UTILITIES LOCATED.
- 4) THE CONTRACTOR SHALL BE RESPONSIBLE FOR PROTECTING UTILITY PROPERTY FROM CONSTRUCTION OPERATIONS AS OUTLINED IN ARTICLE 107.26 OF THE STANDARD SPECIFICATIONS. THE J.U.L. I.E. NUMBER IS (800) 892-0123. A MINIMUM OF 48 HOURS ADVANCE NOTICE IS REQUIRED. SEE SPECIAL PROVISIONS FOR STATUS OF UTILITIES, WITH UTILITY COMPANIES LISTED.
- 5) ANY REFERENCE TO THE STANDARDS THROUGHOUT THE PLANS SHALL BE INTERPRETED TO BE THE LATEST STANDARDS OF THE DEPARTMENT AS INCLUDED IN THE PLANS.
- 6) ALL DETAILS IN THE PLANS SHALL GOVERN CONSTRUCTION OF THIS PROJECT, AND IN CASE OF CONFLICT WITH ANY STANDARD DRAWINGS INCLUDED, THE SAID DETAILS SHALL TAKE PRECEDENCE AND GOVERN.
- 7) THE NECESSARY EARTH EXCAVATION FOR THE PROPOSED CONCRETE ISLAND AND MEDIAN REPAIRS WILL NOT BE PAID FOR SEPARATELY, BUT WILL BE CONSIDERED AS PART OF THE OTHER BID ITEMS FOR THE ASSOCIATED WORK. NO ADDITIONAL COMPENSATION WILL BE ALLOWED.

- 8) PROPOSED TIE BARS (NO. 6 @ 24" CTS.) SHALL BE INSTALLED WHEN INSTALLING PROPOSED CONCRETE PAVEMENT, CURB AND GUTTER, OR SOLID CONCRETE MEDIAN ADJACENT TO EXISTING PAVEMENT, AND WILL NOT BE MEASURED AND PAID FOR SEPARATELY, BUT WILL BE CONSIDERED AS PART OF THE OTHER BID ITEMS FOR THE ASSOCIATED WORK. NO ADDITIONAL COMPENSATION WILL BE ALLOWED.
- 9) IN AREAS WHERE PROPOSED CURB AND GUTTER, OR SOLID CONCRETE MEDIANS ARE TO BE CONSTRUCTED, THE NEW CURB HEIGHT AND TYPE SHALL MATCH THE EXISTING TYPE. IF THE EXISTING GUTTER AREA HAS BEEN RESURFACED, THEN THE NEW CURB HEIGHT SHOULD BE ADJUSTED AND THE GUTTER PAN RAISED TO MATCH THE RESURFACED ELEVATION AS DIRECTED BY THE ENGINEER. THIS WORK WILL BE PAID FOR AT THE CONTRACT UNIT BID PRICE OF THE PAY ITEMS INCLUDED IN THE PLANS. NO ADDITIONAL COMPENSTAIION WILL BE ALLOWED FOR THESE ADJUSTMENTS.

COMMITMENTS

- 1) THE FIELD/RESIDENT ENGINEER SHALL CONTACT STUDIES & PLANS CONCERNING ANY MAJOR PLAN CHANGES TO MAKE SURE NO COMMITMENTS (NOT LISTED) WERE MADE AFFECTING THE DESIGN, AND ALLOW IMPROVEMENTS IN THE DESIGN FOR FUTURE PROJECTS.

DISTRICT SIX		
EXAMINED	<u>January 31</u>	<u>20 05</u>
	<i>Soni Hanir</i>	
	OPERATIONS ENGINEER	
EXAMINED	<u>FEB 1</u>	<u>20 05</u>
	<i>W.B. Frey</i>	
	PROGRAM IMPLEMENTATION ENGINEER	
EXAMINED	<u>FEBRUARY 10</u>	<u>20 05</u>
	<i>William E. Motta</i>	
	PROGRAM DEVELOPMENT ENGINEER	

REVISIONS	
NAME	DATE

ILLINOIS DEPARTMENT OF TRANSPORTATION

GENERAL NOTES

SCALE: VERT.
DATE: HORIZ.

DRAWN BY BDK
CHECKED BY JCN

F.A.P. RTE.	SECTION	COUNTY	TOTAL SHEETS	SHEET NO.
662		SANGAMON	18	3
STA.		TO STA.		
FED. ROAD DIST. NO.	ILLINOIS	FED. AID PROJECT		
• D6 MEDIAN REPAIR 2005				

ILLINOIS DEPARTMENT OF TRANSPORTATION
SUMMARY OF QUANTITIES

URBAN

CODE NO.	ITEM	UNIT	TOTAL	CONSTRUCTION TYPE CODE - I000
				100% State
20201500	SUB-BASE GRANULAR MATERIAL, TYPE B	TON	37	37
42000400	PORTLAND CEMENT CONCRETE PAVEMENT, 9"	SQ YD	32	32
44000100	PAVEMENT REMOVAL	SQ YD	17	17
44000500	COMBINATION CURB AND GUTTER REMOVAL	FOOT	2191	2191
44002020	CONCRETE MEDIAN SURFACE REMOVAL	SQ. FT	5377	5377
44200547	CLASS A PATCHES, TYPE IV, 9 INCH	SQ YD	78	78
44213000	PATCHING REINFORCEMENT	SQ YD	78	78
44213200	SAW CUTS	FOOT	56	56
60260300	INLETS TO BE ADJUSTED WITH NEW TYPE I FRAME, OPEN LID	EACH	1	1
60605900	COMBINATION CONCRETE CURB AND GUTTER, TYPE B-9.12	FOOT	906	906
60608600	COMBINATION CONCRETE CURB AND GUTTER, TYPE M-6.06	FOOT	144	144

PLOT DATE = 2/07/2005
 FILE NAME = I:\PROJECTS\2005\72950\summary.dgn
 PLOT SCALE = 100.000' / IN.
 REFERENCE = #REF#

REVISIONS	
NAME	DATE

ILLINOIS DEPARTMENT OF TRANSPORTATION

SUMMARY OF QUANTITIES

SCALE: VERT.
 HORIZ.
 DATE

DRAWN BY BDK
 CHECKED BY JRK

F.A.P. RTE.	SECTION	COUNTY	TOTAL SHEETS	SHEET NO.
662	•	SANGAMON	18	4
STA.		TO STA.		
FED. ROAD DIST. NO.	ILLINOIS	FED. AID PROJECT		

ILLINOIS DEPARTMENT OF TRANSPORTATION
SUMMARY OF QUANTITIES

CODE NO.	ITEM	UNIT	TOTAL	URBAN
				CONSTRUCTION TYPE CODE - 1000
				100% STATE
60610400	COMBINATION CONCRETE CURB AND GUTTER, TYPE M-6.24	FOOT	111	111
60610900	COMBINATION CONCRETE CURB AND GUTTER, TYPE M-6.24 (VAR WIDTH GUTTER FLAG)	FOOT	17	17
60618300	CONCRETE MEDIAN SURFACE, 4 INCH	SQ. FT	1552	1552
60620800	CONCRETE MEDIAN, TYPE SB-9.12	SQ. FT	2495	2495
60622400	CONCRETE MEDIAN, TYPE SM-6.06	SQ. FT	2098	2098
60625900	P. C. C. RAMPED MEDIAN TERMINAL	EACH	5	5
67100100	MOBILIZATION	L SUM	1	1
70100305	TRAFFIC CONTROL AND PROTECTION, STANDARD 701400	L SUM	1	1
70100800	TRAFFIC CONTROL AND PROTECTION, STANDARD 701401	L SUM	1	1
70102630	TRAFFIC CONTROL AND PROTECTION, STANDARD 701601	L SUM	1	1
70102635	TRAFFIC CONTROL AND PROTECTION, STANDARD 701701	L SUM	1	1
70103815	TRAFFIC CONTROL SURVEILLANCE	CAL DA	15	15

• 06 MEDIAN REPAIR 2005

PLOT DATE = 2/9/2005
FILE NAME = C:\N\1135650905\summary.dgn
PLOT SCALE = 1/8"=1'-0"
REFERENCE = #REF#

REVISIONS	
NAME	DATE

ILLINOIS DEPARTMENT OF TRANSPORTATION

SUMMARY OF QUANTITIES

SCALE: VERT.
DATE: HORIZ.

DRAWN BY BDK
CHECKED BY JRK

F.A.P. RTE.	SECTION	COUNTY	TOTAL SHEETS	SHEET NO.
662		SANGAMON	18	5
STA.		TO STA.		
FED. ROAD DIST. NO.	ILLINOIS	FED. AID PROJECT		
• D6 MEDIAN REPAIR 2005				

ILLINOIS DEPARTMENT OF TRANSPORTATION
SUMMARY OF QUANTITIES

CODE NO.	ITEM	UNIT	TOTAL	URBAN CONSTRUCTION TYPE CODE - 1000	
				100% State	
* 81012600	CONDUIT IN TRENCH, 2" DIA., PVC	FOOT	7	7	
* 81021550	CONDUIT, AUGERED 2" DIA., PVC	FOOT	38	38	
* 87502700	TRAFFIC SIGNAL POST, ALUMINUM 16 FT.	EACH	1	1	
* 87800100	CONCRETE FOUNDATION, TYPE A	FOOT	3	3	
* 88200100	TRAFFIC SIGNAL BACKPLATE	EACH	1	1	
* 88600100	DETECTOR LOOP, TYPE 1	FOOT	104	104	
* 89501150	RELOCATE EXISTING TRAFFIC SIGNAL POST	EACH	1	1	
* 89502350	REMOVE AND REINSTALL ELECTRIC CABLE FROM CONDUIT	FOOT	116	116	
* 89502375	REMOVE EXISTING TRAFFIC SIGNAL EQUIPMENT	EACH	1	1	
X7015005	CHANGEABLE MESSAGE SIGN	CAL DA	20	20	
* X8801463	SIGNAL HEAD, POLYCARBONATE, LED, 3-FACE, 1-4 SECTION, 2-5 SECTION, BRACKET MOUNTED	EACH	1	1	

* SPECIALTY ITEMS

REVISIONS		ILLINOIS DEPARTMENT OF TRANSPORTATION SUMMARY OF QUANTITIES SCALE: VERT. HORIZ. DATE	DRAWN BY BDK CHECKED BY JRK
NAME	DATE		

F.A.P. RTE.	SECTION	COUNTY	TOTAL SHEETS	SHEET NO.
662	-	SANGAMON	18	6
STA.		TO STA.		
FED. ROAD DIST. NO.	ILLINOIS	FED. AID PROJECT		
• 06 MEDIAN REPAIR 2005				

LOCATION NO. 2 (IL 4 @ ILES AVE.)

PAY CODE	ITEM	UNITS	QTY
20201500	SUB-BASE GRANULAR MATERIAL, TY B	TON	7
42000400	PCC PAVEMENT, 9"	SQ YD	7
44000100	PAVEMENT REMOVAL	SQ YD	17
44000500	COMBINATION CURB & GUTTER REMOVAL	FOOT	43
44002020	CONCRETE MEDIAN SURFACE REMOVAL	SQ FT	60
60608500	COMBINATION CONCRETE CURB & GUTTER, TY M-6.06	FOOT	11
60610400	COMBINATION CONCRETE CURB & GUTTER, TY M-6.24	FOOT	11
60610900	COMBINATION CONCRETE CURB & GUTTER, TY M-6.24 (VAR WIDTH GUTTER)	FOOT	17
60618300	CONCRETE MEDIAN SURFACE, 4"	SQ FT	64
81012600	CONDUIT IN TRENCH, 2" DIA., PVC	FOOT	7
81021550	CONDUIT, AUGERED 2" DIA., PVC	FOOT	38
87502700	TRAFFIC SIGNAL POST, ALUMINUM 16 FT.	EACH	1
87800100	CONCRETE FOUNDATION, TYPE A	FOOT	3
88200100	TRAFFIC SIGNAL BACKPLATE	EACH	1
89502350	REMOVE AND REINSTALL ELECTRIC CABLE FROM CONDUIT	FOOT	116
89502375	REMOVE EXISTING TRAFFIC SIGNAL EQUIPMENT	EACH	1
X8801463	SIGNAL HEAD, POLYCARBONATE, LED, 3-FACE, 1-4 SECTION, 2-5 SECTION, BRACKET MOUNTED	EACH	1

LOCATION NO. 1 (IL 4 @ BRUNS LN)

PAY CODE	ITEM	UNITS	QTY
20201500	SUB-BASE GRANULAR MATERIAL, TYPE B	TON	20
44000500	COMBINATION CURB AND GUTTER REMOVAL	FOOT	100
44002020	CONCRETE MEDIAN SURFACE REMOVAL	SQ FT	493
44200547	CLASS A PATCHES, TYPE IV, 9 INCH	SQ YD	78
44213200	SAW CUTS	FOOT	56
44213000	PATCHING REINFORCEMENT	SQ YD	78
60610400	COMBINATION CONCRETE CURB AND GUTTER, TYPE M-6.24	FOOT	100
60618300	CONCRETE MEDIAN SURFACE, 4 INCH	SQ FT	493
88600100	DETECTOR LOOP, TYPE I	FOOT	104

PLOT DATE = 2/6/2005
 FILE NAME = \\s060908\shw\shw\shw\shw.dgn
 PLOT SCALE = 1/8"=1'-0"
 REFERENCE = #REF#

REVISIONS	
NAME	DATE

ILLINOIS DEPARTMENT OF TRANSPORTATION

SCHEDULE OF QUANTITIES

SCALE: VERT.
 HORIZ.
 DATE

DRAWN BY BDK
 CHECKED BY

Rev.

F.A.P. RTE.	SECTION	COUNTY	TOTAL SHEETS	SHEET NO.
662		SANGAMON	18	7
STA.		TO STA.		
FED. ROAD DIST. NO.	ILLINOIS	FED. AID PROJECT		
• D6 MEDIAN REPAIR 2005				

LOCATION NO. 3 (IL 54 @ SANGAMON AVE.)

PAY CODE #	ITEM	UNITS	Median A	Median B	Island C	TOTAL
44000500	COMBINATION CURB & GUTTER REMOVAL	FOOT	268	54	133	455
44002020	CONCRETE MEDIAN SURFACE REMOVAL	SQ. FT	1521	229	995	2745
60603600	COMBINATION CONCRETE CURB & GUTTER, TY M-6.06	FOOT			133	133
60618300	CONCRETE MEDIAN SURFACE, 4 INCH	SQ. FT			995	995
60622400	CONCRETE MEDIAN, TYPE SM-6.06	SQ. FT	1834	264		2098
60625900	PC. C. RAMPED MEDIAN TERMINAL	EACH		1		1

LOCATION NO. 4 (IL 29 IN ROCHESTER)

PAY CODE #	ITEM	UNITS	QUANTITY
20201500	SUB-BASE GRANULAR MATERIAL, TY B	TON	10
42000400	PCC PAVEMENT, 9"	SQ. YD	25
60260300	INLETS TO BE ADJUSTED WITH NEW TYPE 1 FRAME, OPEN LID	EACH	1
44000500	COMBINATION CURB & GUTTER REMOVAL	FOOT	1593
44002020	CONCRETE MEDIAN SURFACE REMOVAL	SQ. FT.	2079
60605900	COMBINATION CONCRETE CURB AND GUTTER, TY B-9.12	FOOT	906
60620800	CONCRETE MEDIAN, TYPE SB-9.12	SQ. FT	2495
60625900	PC. C. RAMPED MEDIAN TERMINAL	EACH	4

PLOT DATE = 2/10/2005
 FILE NAME = C:\A\110509080\attached\plan.dgn
 PLOT SCALE = 1/8"=1'-0"
 REFERENCE = #REF#

REVISIONS	
NAME	DATE

Rev.

ILLINOIS DEPARTMENT OF TRANSPORTATION

SCHEDULE OF QUANTITIES

SCALE: VERT. _____
 HORIZ. _____
 DATE _____

DRAWN BY BDK
 CHECKED BY _____

CONTRACT NO. 72950				
F.A.P. RTE.	SECTION	COUNTY	TOTAL SHEETS	SHEET NO.
662	*	SANGAMON	18	8
STA.		TO STA.		
FED. ROAD DIST. NO.	ILLINOIS	FED. AID PROJECT		

* D6 MEDIAN REPAIR 2005

TRAFFIC SIGNAL PLAN LEGEND

EXISTING	PROPOSED	DESCRIPTION
		SIGNAL HEAD
		SIGNAL HEAD WITH BACKPLATE
		TEMPORARY SIGNAL HEAD
		PEDESTRIAN SIGNAL HEAD
		PEDESTRIAN PUSHBUTTON DETECTOR
		DETECTOR LOOP
		QUADRAPOLE DETECTOR LOOP
		SIGNAL POST
		ALUMINUM MAST ARM ASSEMBLY AND POLE
		STEEL MAST ARM ASSEMBLY AND POLE
		WOOD POLE
		WOOD POLE WITH GUY
		SERVICE INSTALLATION
		CONTROLLER
		HANDHOLE
		HEAVY DUTY HANDHOLE
		DOUBLE HANDHOLE
		JUNCTION BOX
		GULFBOX JUNCTION
		AERIAL CABLE
		CONDUIT
		CONDUIT SPLICE
		SPAN WIRE / TETHER WIRE
		SIDEWALK REMOVAL IN SO M (SO FT)
		PC CONC SDWLK 100 mm IN SO M (SO YD)
		PC CONC SDWLK 100 mm SPECIAL IN SO M (SO YD)

TRAFFIC SIGNAL WIRING DIAGRAM LEGEND

EXISTING	PROPOSED	DESCRIPTION
		200 mm (8") SIGNAL SECTION
		300 mm (12") SIGNAL SECTION
		DIRECTIONAL SIGNAL SECTION
		225 mm (9") PEDESTRIAN SIGNAL FACE
		300 mm (12") PEDESTRIAN SIGNAL FACE
		SIGNAL FACE WITH BACKPLATE
		PROGRAMMED SIGNAL SECTION
		SIGNAL SECTION WITH LOUVRE
		DUAL-INDICATION SIGNAL SECTION
		INDUCTION DETECTOR LOOP
		QUADRAPOLE DETECTOR LOOP
		DIRECT-CONNECTED LOOP LEAD-IN (TWISTED)
		ELECTRIC CABLE DENOTING NUMBER OF CONDUCTORS
		ELECTRIC CABLE TO BE REMOVED
		ELECTRIC CABLE IDENTIFIER TAPE CODES (R= RED W= WHITE Y= YELLOW G= GREEN B= BLUE O= ORANGE)
		PEDESTRIAN PUSHBUTTON DETECTOR
		VIDEO DETECTION CAMERA
		EMERGENCY VEHICLE PREEMPTOR



REVISIONS	
NAME	DATE

ILLINOIS DEPARTMENT OF TRANSPORTATION
LEGEND FOR TRAFFIC SIGNAL DETAILS

SCALE: VERT. DRAWN BY
 HORIZ. CHECKED BY WCD
 DATE: DECEMBER 3, 1999

DETLOOP

F.A.P. RTE.	SECTION	COUNTY	TOTAL SHEETS	SHEET NO.
662	*	SANGAMON	18	10
STA.		TO STA.		
FED. ROAD DIST. NO.	ILLINOIS	FED. AID PROJECT		

• D6 MEDIAN REPAIR 2005

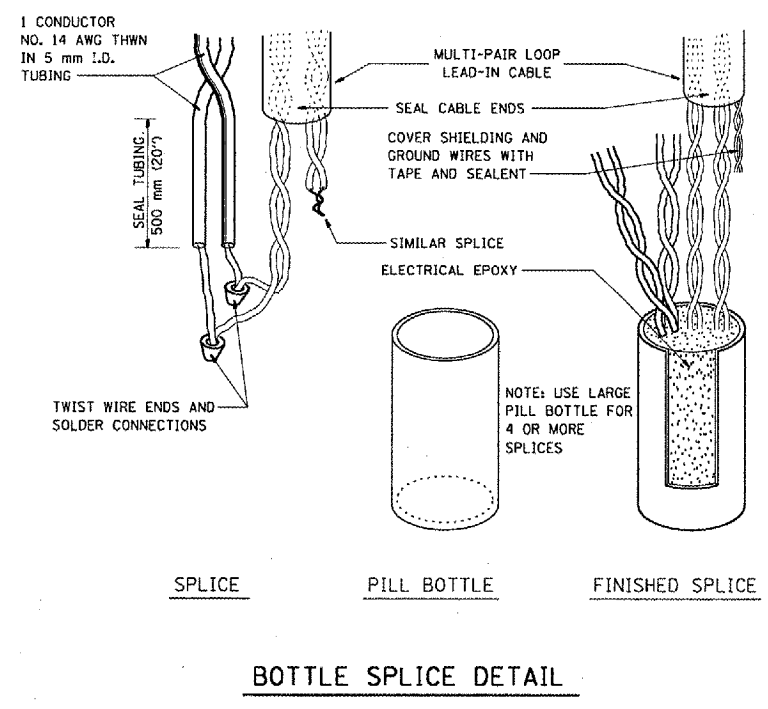
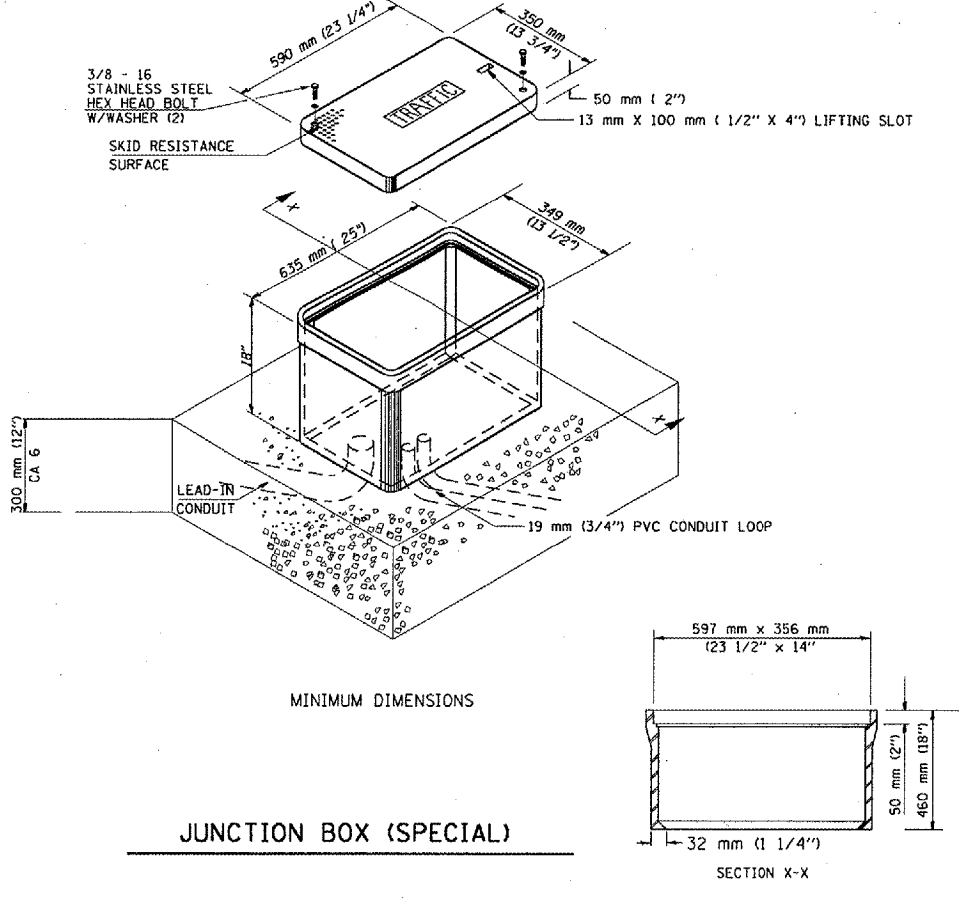
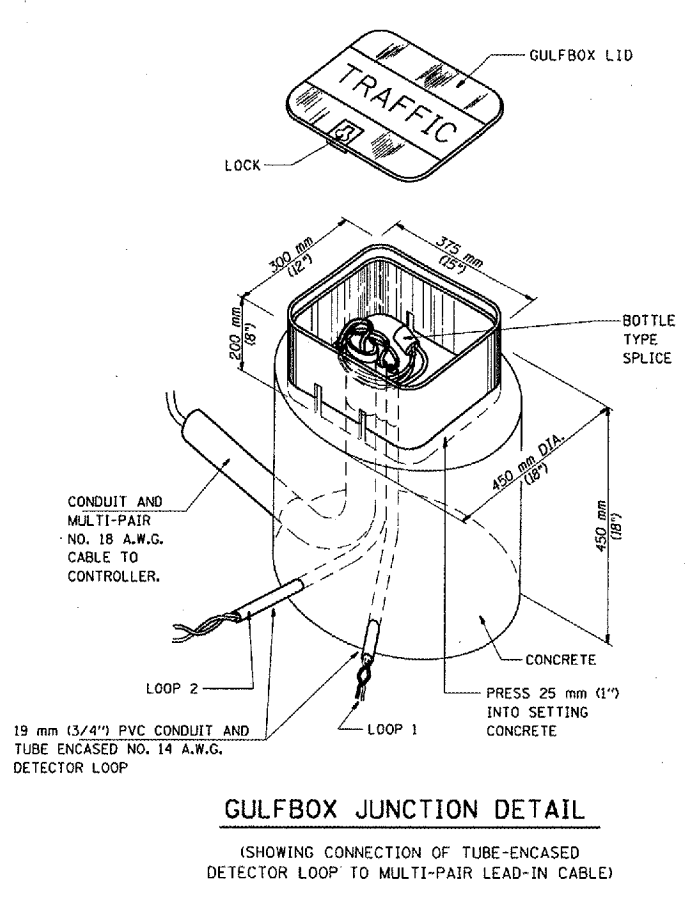
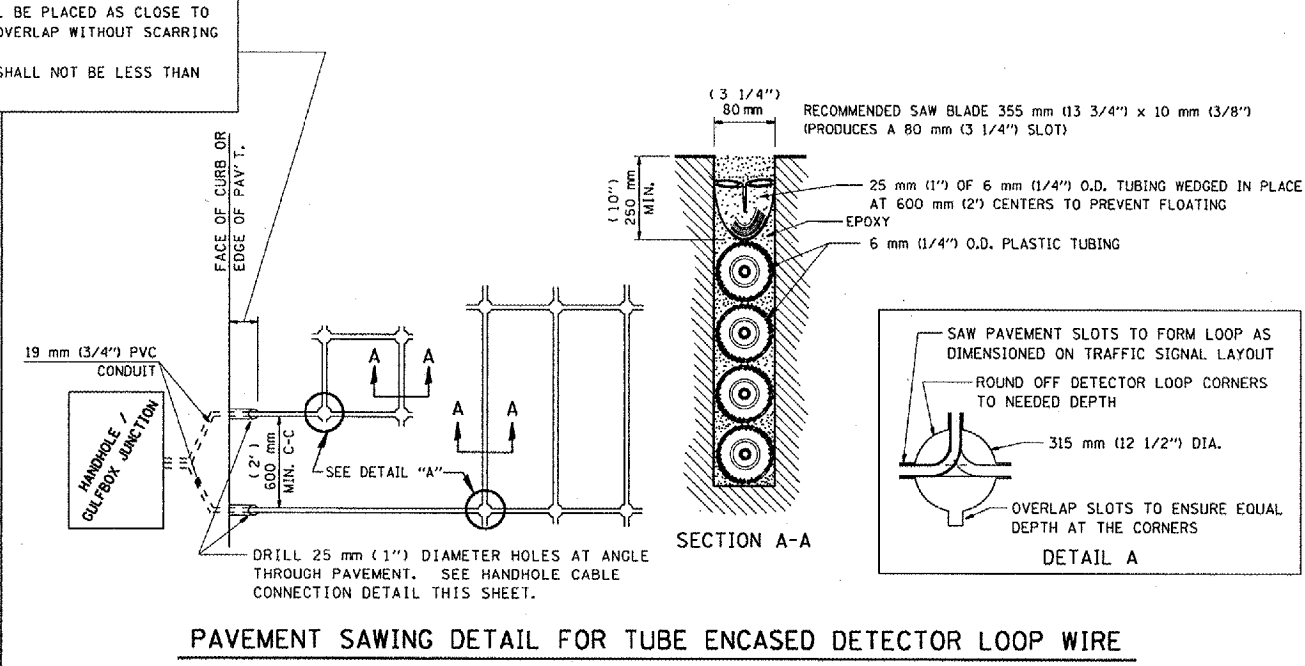
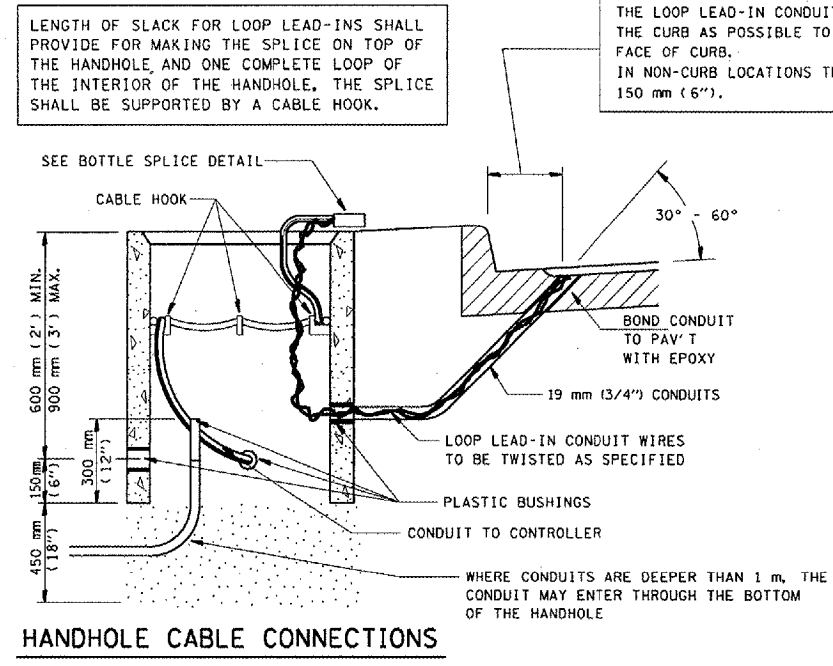

DETLOOP

REVISIONS	
NAME	DATE

ILLINOIS DEPARTMENT OF TRANSPORTATION

TRAFFIC SIGNAL DETECTOR LOOP DETAILS

SCALE: VERT. HORIZ.
DATE: MARCH 12, 1999

DRAWN BY WCD
CHECKED BY

F.A.P. RTE.	SECTION	COUNTY	TOTAL SHEETS	SHEET NO.
662		SANGAMON	18	12
STA. _____		TO STA. _____		
FED. ROAD DIST. NO. ILLINOIS FED. AID PROJECT				

D6 MEDIAN REPAIR 2005

PROPOSED CABLE DIAGRAM

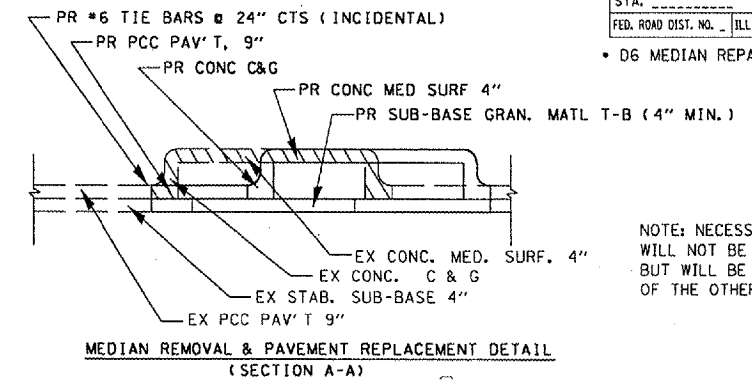
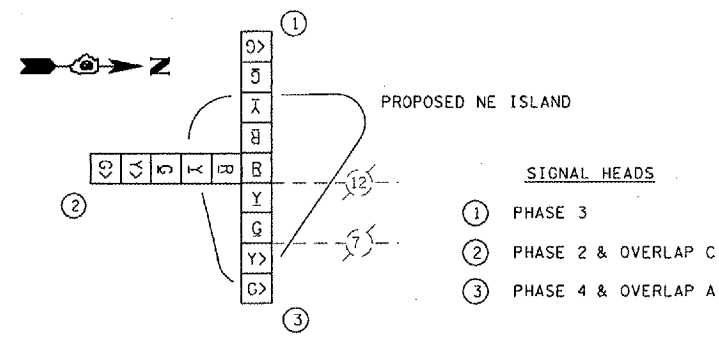

NOTE: NECESSARY EARTH EXCAVATION WILL NOT BE PAID FOR SEPARATELY, BUT WILL BE CONSIDERED AS PART OF THE OTHER BID ITEMS.

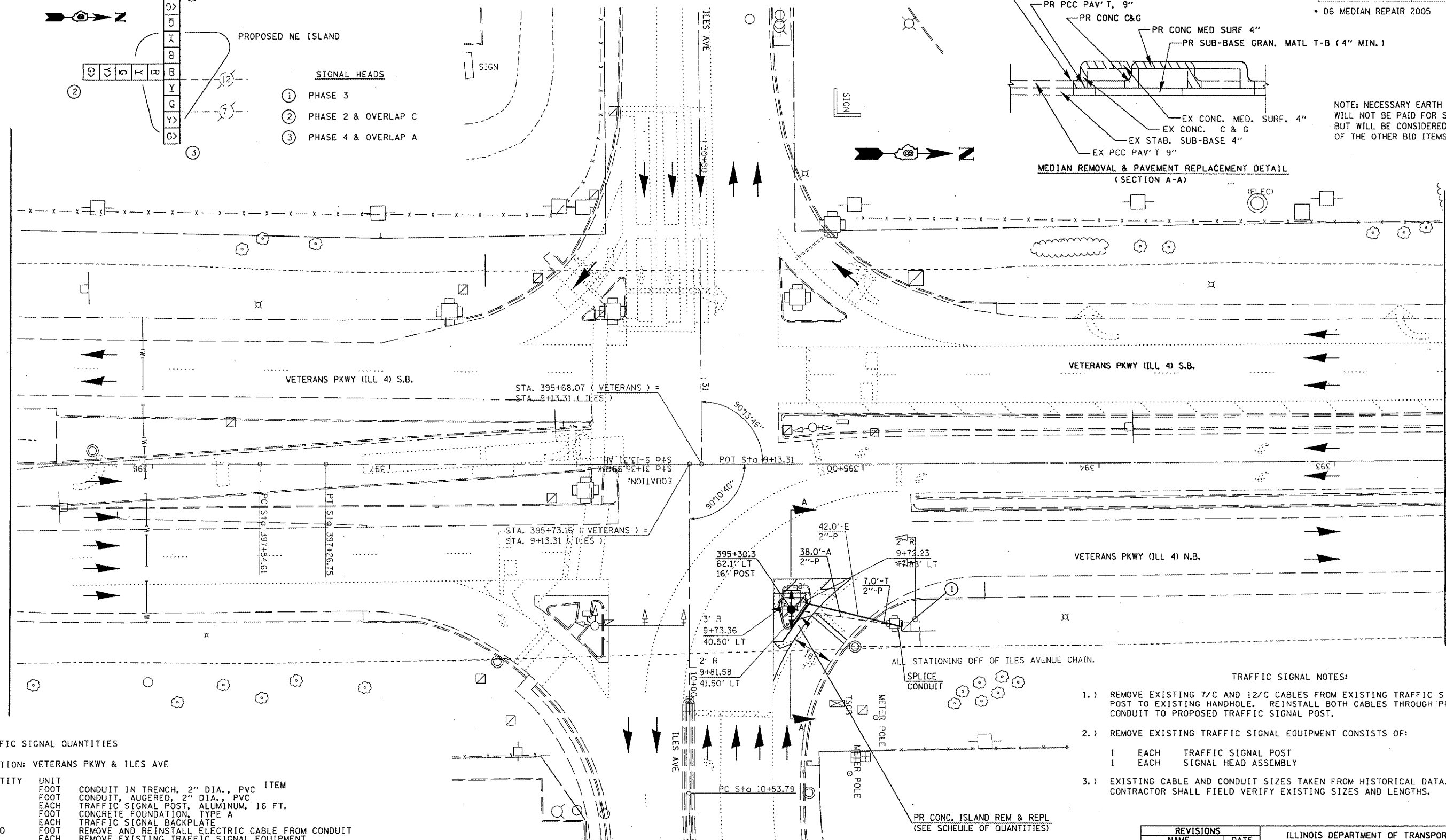

TRAFFIC SIGNAL NOTES:

- 1.) REMOVE EXISTING 7/C AND 12/C CABLES FROM EXISTING TRAFFIC SIGNAL POST TO EXISTING HANDHOLE. REINSTALL BOTH CABLES THROUGH PROPOSED CONDUIT TO PROPOSED TRAFFIC SIGNAL POST.
- 2.) REMOVE EXISTING TRAFFIC SIGNAL EQUIPMENT CONSISTS OF:
 - 1 EACH TRAFFIC SIGNAL POST
 - 1 EACH SIGNAL HEAD ASSEMBLY
- 3.) EXISTING CABLE AND CONDUIT SIZES TAKEN FROM HISTORICAL DATA. CONTRACTOR SHALL FIELD VERIFY EXISTING SIZES AND LENGTHS.

TRAFFIC SIGNAL QUANTITIES

LOCATION: VETERANS PKWY & ILES AVE

QUANTITY	UNIT	DESCRIPTION
7.0	FOOT	CONDUIT IN TRENCH, 2" DIA., PVC ITEM
38.0	FOOT	CONDUIT, AUGERED, 2" DIA., PVC
1.0	EACH	TRAFFIC SIGNAL POST, ALUMINUM, 16 FT.
3.0	FOOT	CONCRETE FOUNDATION, TYPE A
1.0	EACH	TRAFFIC SIGNAL BACKPLATE
116.0	FOOT	REMOVE AND REINSTALL ELECTRIC CABLE FROM CONDUIT
1.0	EACH	REMOVE EXISTING TRAFFIC SIGNAL EQUIPMENT
1.0	EACH	SIGNAL HEAD, POLYCARBONATE, L.E.D., 3-FACE, 1-4 SECTION, 2-5 SECTION, BRACKET MOUNTED

REVISIONS	
NAME	DATE

ILLINOIS DEPARTMENT OF TRANSPORTATION
LOCATION NO. 2
Plan Sheet
IL 4 @ ILES AVENUE
 SCALE: VERT. _____ HORIZ. _____
 DATE _____ DRAWN BY BDK
 CHECKED BY JCN

PLOT DATE = 2/22/2005
 FILE NAME = 433725.dwg
 PLOT SCALE = 43.3725 / IN.
 REFERENCE = #REF#

CONTRACT NO. 72590				
F.A.P. RTE.	SECTION	COUNTY	TOTAL SHEETS	SHEET NO.
662		SANGAMON	18	13
STA.		TO STA.		
FED. ROAD DIST. NO.		ILLINOIS	FED. AID PROJECT	
• 06 MEDIAN REPAIR 2005				



PR. CONC MEDIAN REM & REPL
(SEE SCHEDULE OF QUANTITIES -
MEDIAN "B")

PR. CONC MEDIAN REM & REPL
(SEE SCHEDULE OF QUANTITIES -
MEDIAN "A")

PR. RAMPED
MEDIAN TERMINAL

PR. ISLAND REM & REPL
(SEE SCHEDULE OF QUANTITIES -
ISLAND "C")

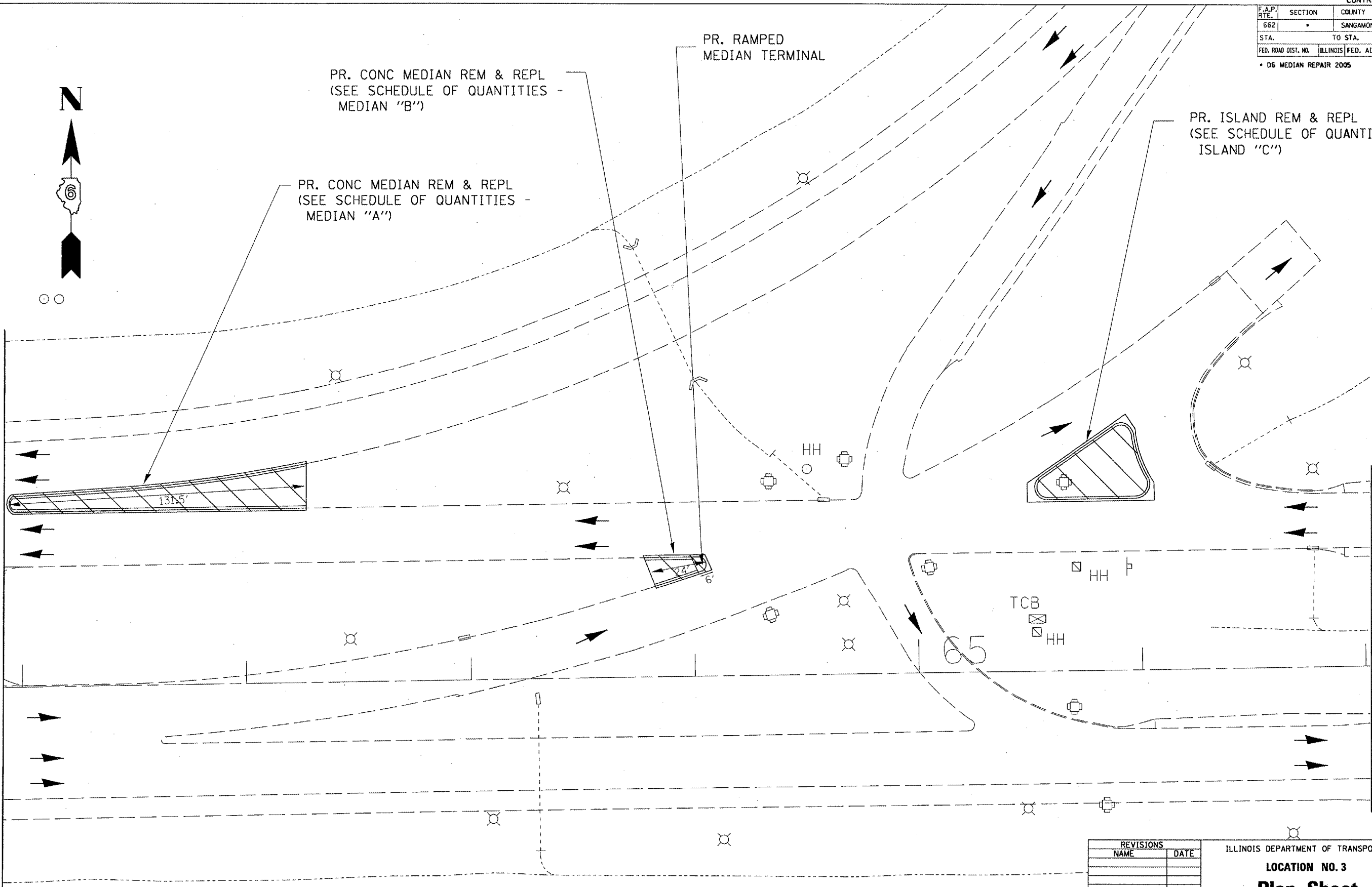

PLOT DATE = 2/8/2005
FILE NAME = c:\projects\662\06\0610\05\061010.dgn
PLOT SCALE = 43.3725 / IN.
REFERENCE = REF#

REVISIONS	
NAME	DATE

ILLINOIS DEPARTMENT OF TRANSPORTATION
LOCATION NO. 3
Plan Sheet
IL 54
SCALE: VERT. _____
 HORIZ. _____
DATE _____
DRAWN BY: BOK
CHECKED BY: JCN

F.A.P. RTE.	SECTION	COUNTY	TOTAL SHEETS	SHEET NO.
662		SANGAMON	18	14
STA.		TO STA.		
FED. ROAD DIST. NO.		ILLINOIS FED. AID PROJECT		

• D6 MEDIAN REPAIR 2005

CONCRETE CURB & GUTTER REMOVAL & REPLACEMENT

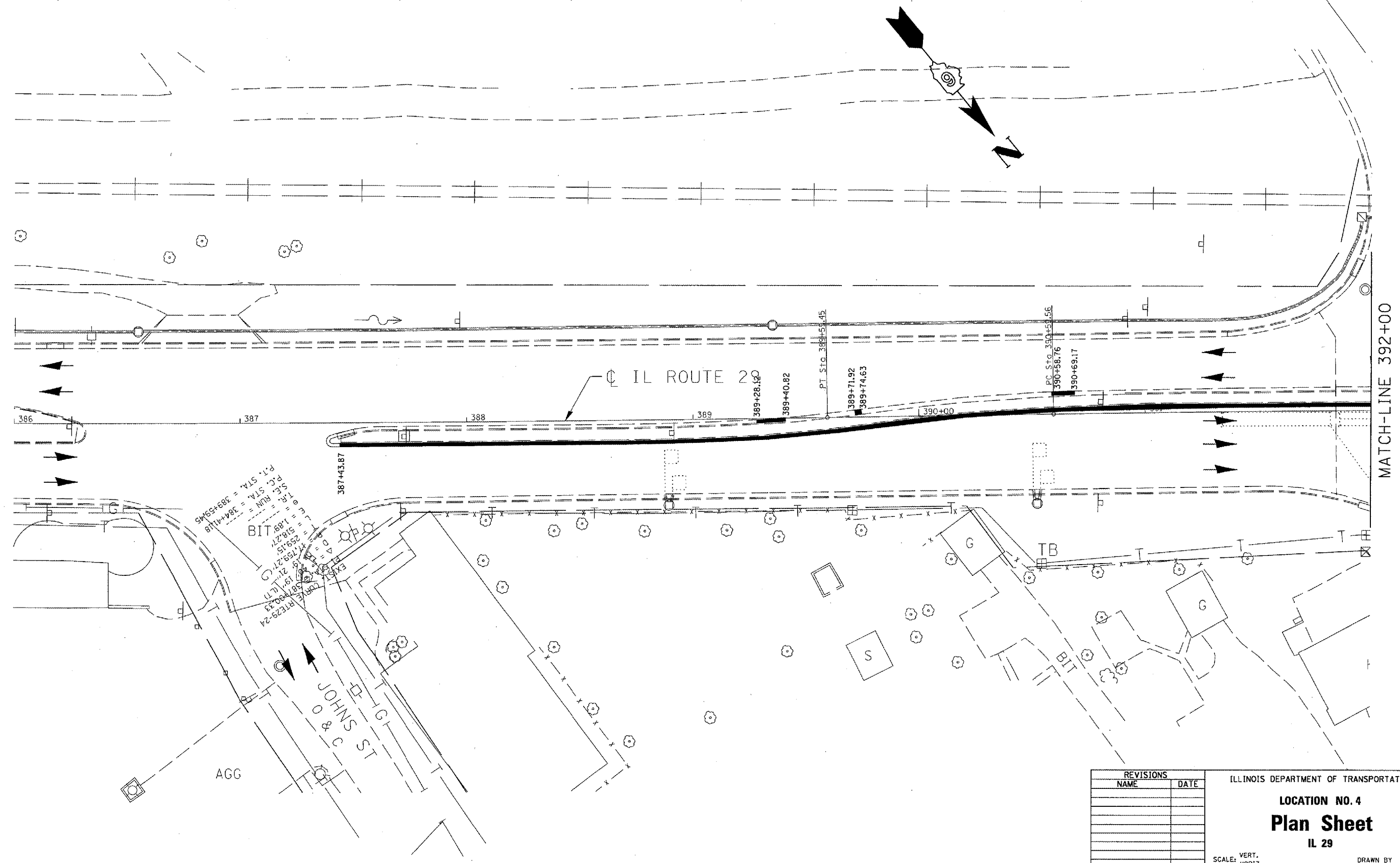

P.C. STA. = 384+41.18
 S.C. STA. = 384+41.18
 T.R. = 1.89
 E.A. = 58.21
 P.I. = 71.92
 P.T. STA. = 389+74.63
 BIT
 AGG

REVISIONS	
NAME	DATE

ILLINOIS DEPARTMENT OF TRANSPORTATION

LOCATION NO. 4

Plan Sheet

IL 29

SCALE: VERT. _____
 HORIZ. _____

DATE _____

DRAWN BY BDK
 CHECKED BY JCN

PLOT DATE = 2/6/2005
 PLOT SCALE = 43.375' / IN.
 REFERENCE = #REF#

F.A.P. RTE.	SECTION	COUNTY	TOTAL SHEETS	SHEET NO.
662	*	SANGAMON	18	15
STA.		TO STA.		
FED. ROAD DIST. NO.		ILLINOIS FED. AID PROJECT		

* D6 MEDIAN REPAIR 2005

CONCRETE CURB & GUTTER REMOVAL & REPLACEMENT

CONCRETE C & G AND MEDIAN SURFACE REMOVAL
PR SOLID CONCRETE MEDIAN TY SB-9.12; PCC PAVEMENT 9"; OR PCC RAMPED MEDIAN
TERMINAL REPLACEMENT

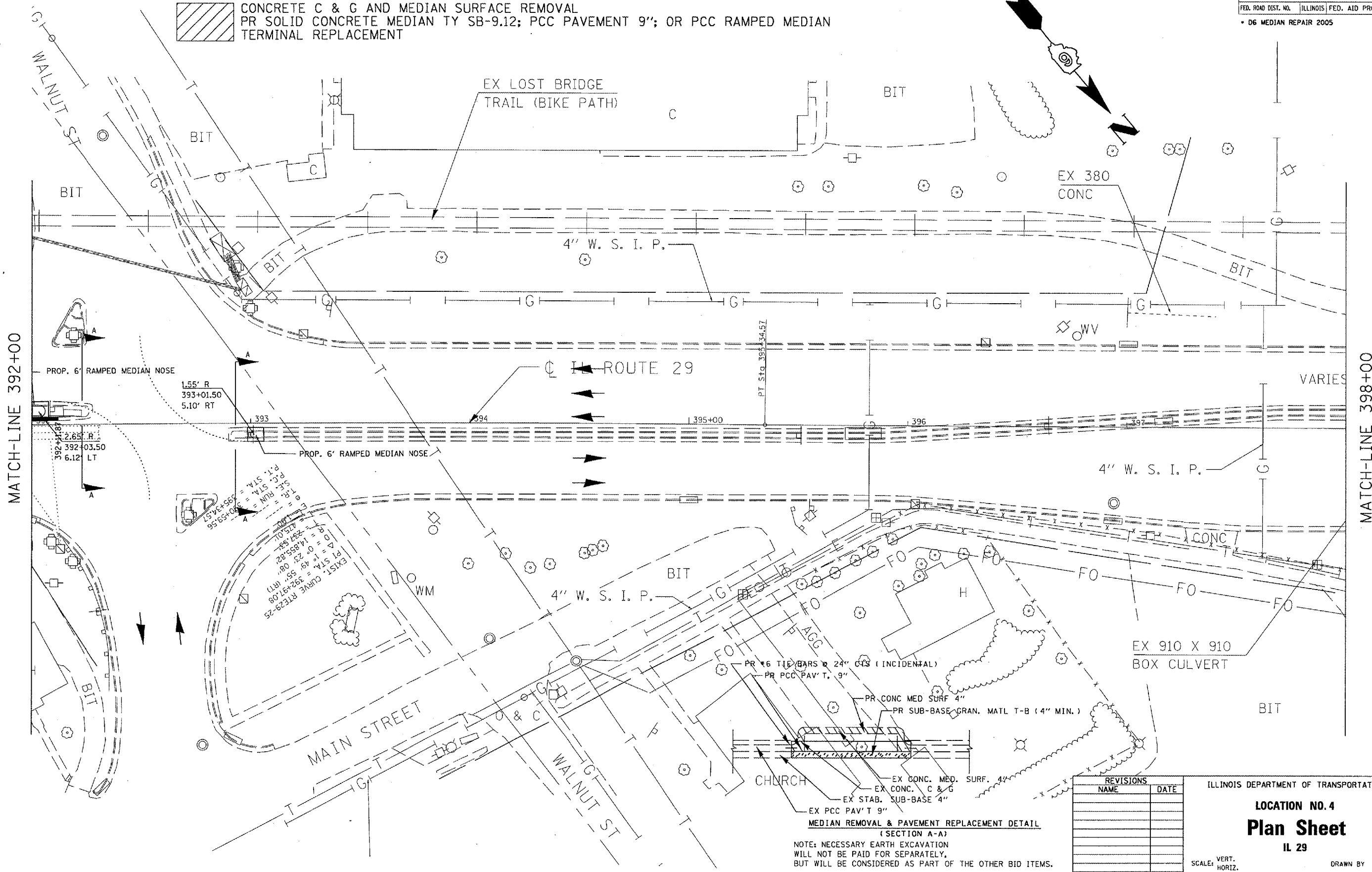

MATCH-LINE 392+00

MATCH-LINE 398+00

REVISIONS	
NAME	DATE

ILLINOIS DEPARTMENT OF TRANSPORTATION
LOCATION NO. 4
Plan Sheet
IL 29
SCALE: VERT. _____
 HORIZ. _____
DATE _____
DRAWN BY: BOK
CHECKED BY: JCN

MEDIAN REMOVAL & PAVEMENT REPLACEMENT DETAIL
(SECTION A-A)
NOTE: NECESSARY EARTH EXCAVATION
WILL NOT BE PAID FOR SEPARATELY,
BUT WILL BE CONSIDERED AS PART OF THE OTHER BID ITEMS.

PLOT DATE = 2/18/2005
PLOT SCALE = 41.3725" / IN.
REFERENCE = #REF*

F.A.P. RTE.	SECTION	COUNTY	TOTAL SHEETS	SHEET NO.
662	*	SANGAMON	18	16
STA.		TO STA.		
FED. ROAD DIST. NO.		ILLINOIS FED. AID PROJECT		

• 06 MEDIAN REPAIR 2005

CONCRETE CURB & GUTTER REMOVAL & REPLACEMENT

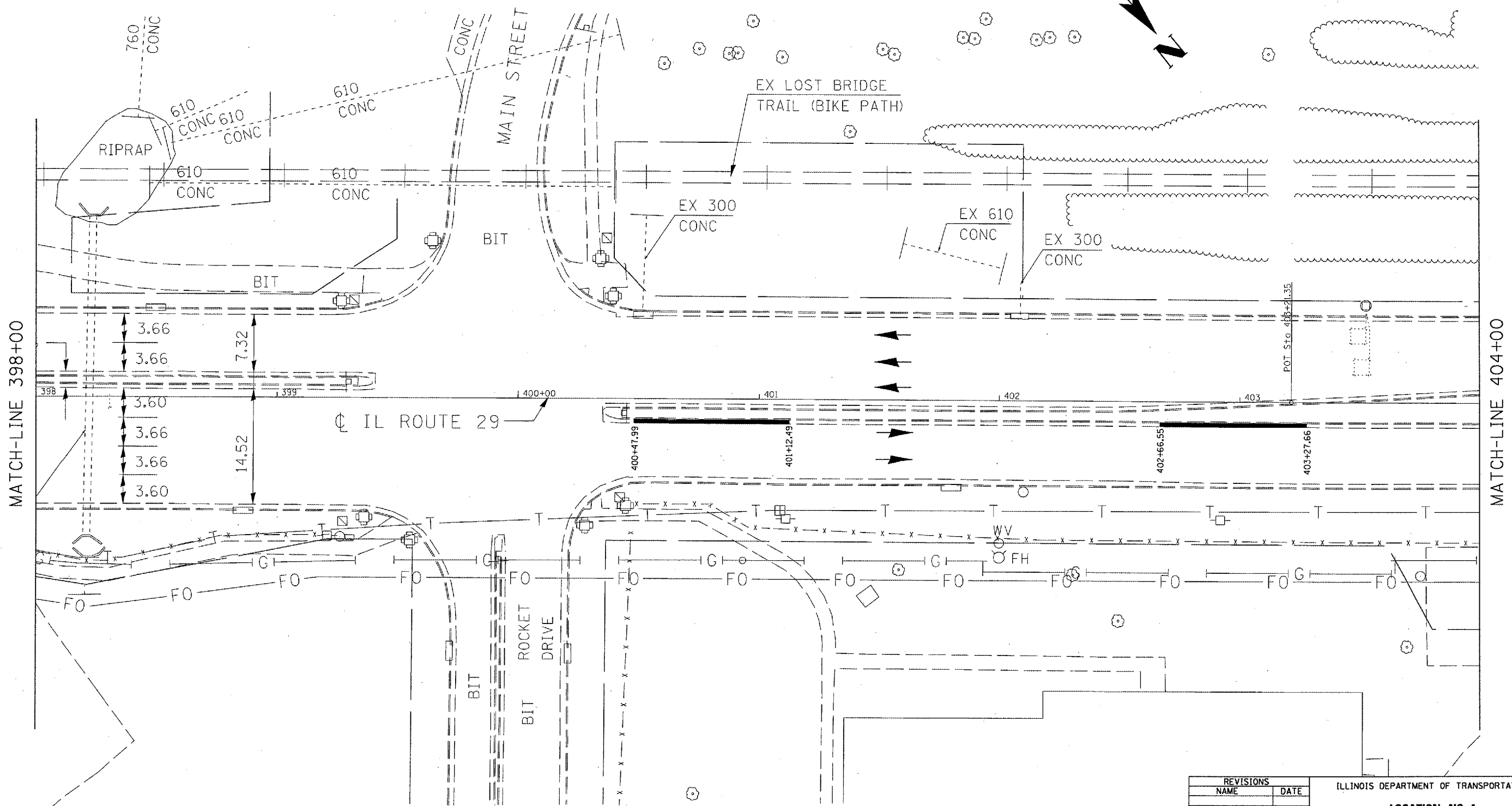

MATCH-LINE 398+00

MATCH-LINE 404+00



REVISIONS	
NAME	DATE

ILLINOIS DEPARTMENT OF TRANSPORTATION
LOCATION NO. 4
Plan Sheet
 IL 29
 SCALE: VERT. / HORIZ.
 DATE / DATE
 DRAWN BY: BDK
 CHECKED BY: JCN

PLT DATE = 2/2/2005
 FILE NAME = C:\Users\jcn\Documents\72950\72950.dgn
 PLOT SCALE = 43.3725 / IN.
 REFERENCE = REF#

F.A.P. RTE.	SECTION	COUNTY	TOTAL SHEETS	SHEET NO.
662		SANGAMON	18	17
STA.	TO STA.			
FED. ROAD DIST. NO.	ILLINOIS	FED. AID PROJECT		

• 06 MEDIAN REPAIR 2005

 CONCRETE CURB & GUTTER REMOVAL & REPLACEMENT
 EX CONCRETE C & G AND MEDIAN SURFACE REMOVAL
 PR SOLID CONCRETE MEDIAN TY SB-9.12; OR PCC RAMPED MEDIAN
 TERMINAL REPLACEMENT

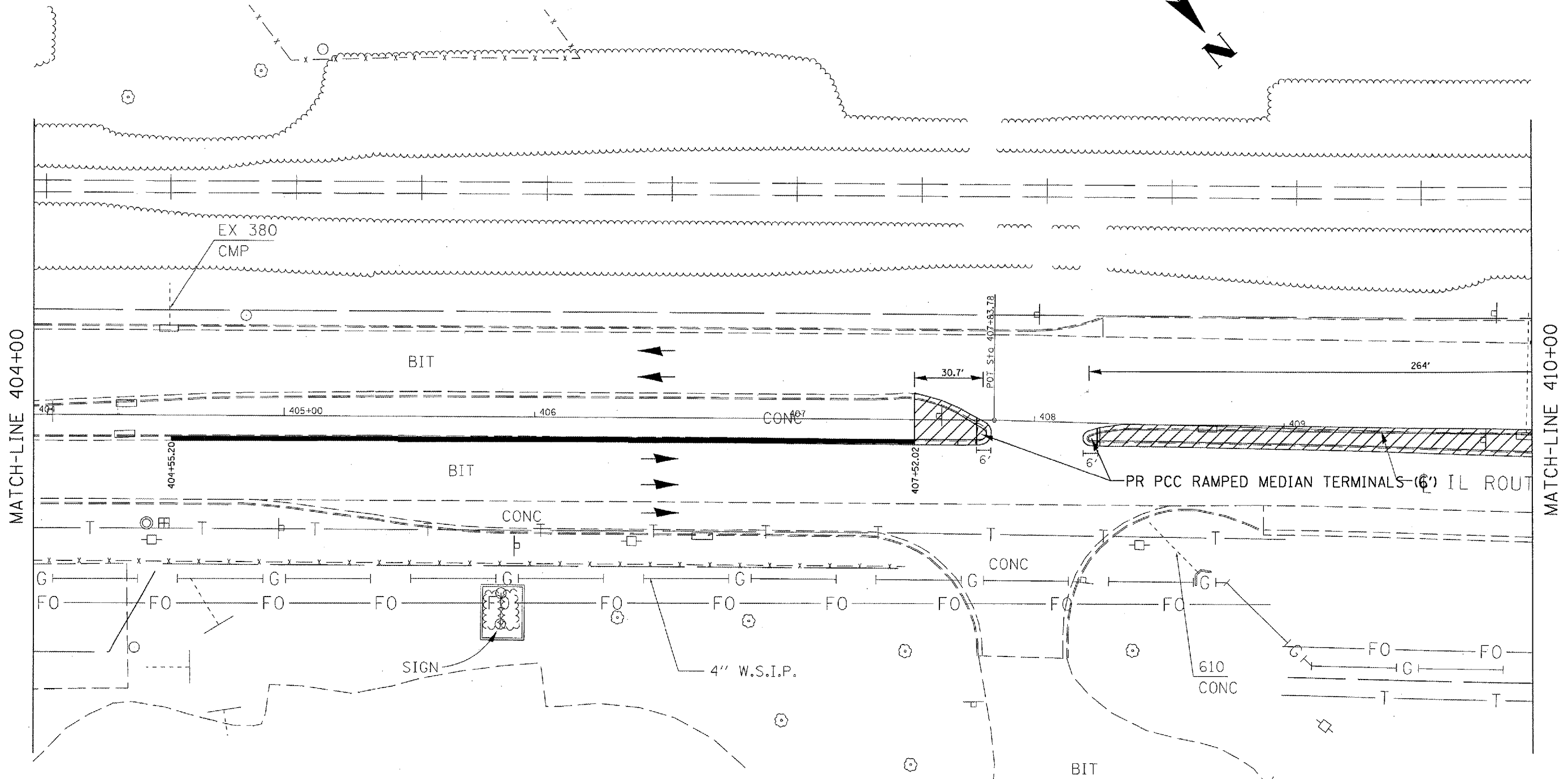
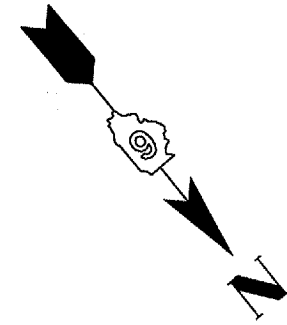

PLOT DATE = 2/19/2005
 PLOT SCALE = 43.3725' / IN.
 REFERENCE = #REF#

REVISIONS	
NAME	DATE

ILLINOIS DEPARTMENT OF TRANSPORTATION
LOCATION NO. 4
Plan Sheet
 IL 29
 SCALE: VERT. _____
 HORIZ. _____
 DATE _____
 DRAWN BY BDK
 CHECKED BY JCN

F.A.P. RTE.	SECTION	COUNTY	TOTAL SHEETS	SHEET NO.
662	*	SANGAMON	18	18
STA.		TO STA.		
FED. ROAD DIST. NO.		ILLINOIS FED. AID PROJECT		

* D6 MEDIAN REPAIR 2005

CONCRETE CURB & GUTTER REMOVAL & REPLACEMENT



EX CONCRETE C & G AND MEDIAN SURFACE REMOVAL
PR SOLID CONCRETE MEDIAN TY SB-9.12 REPLACEMENT

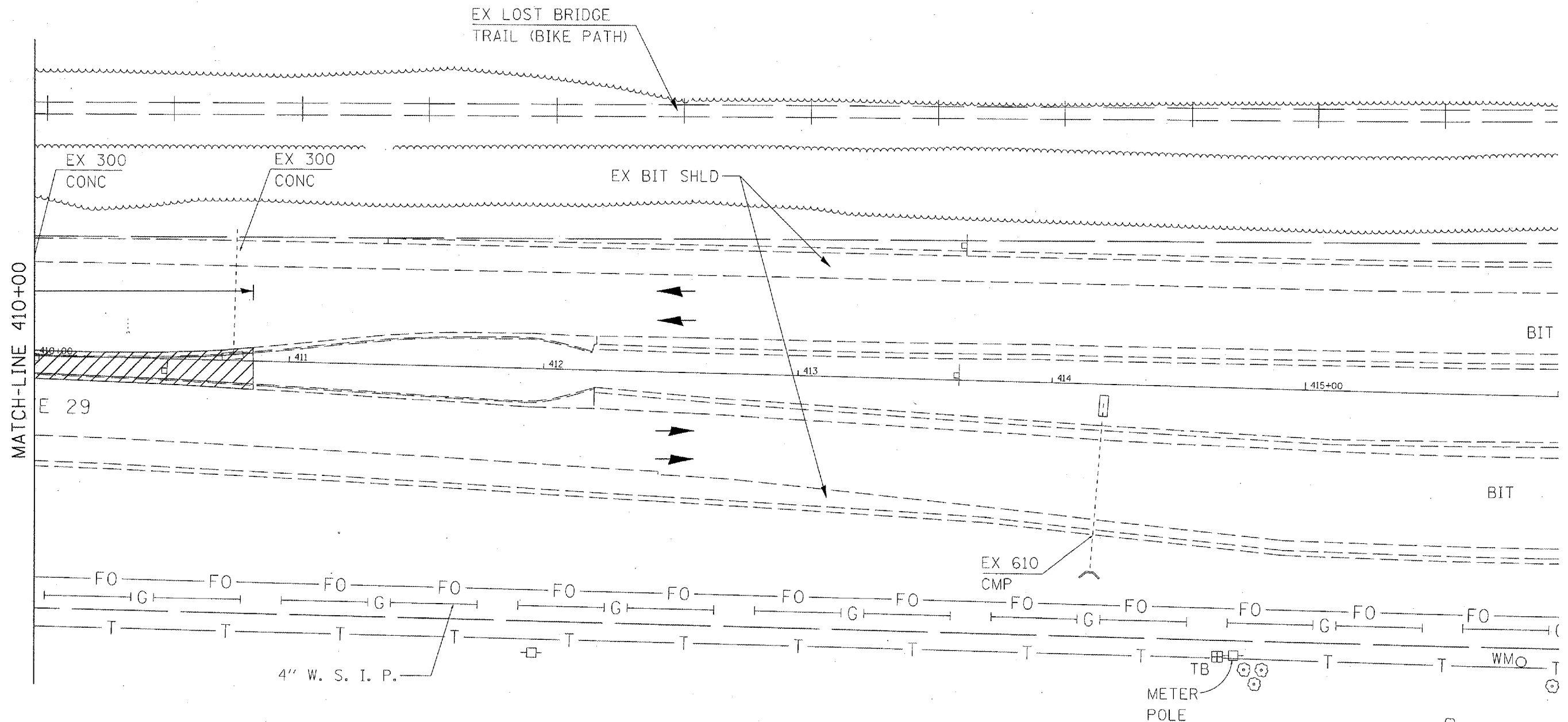
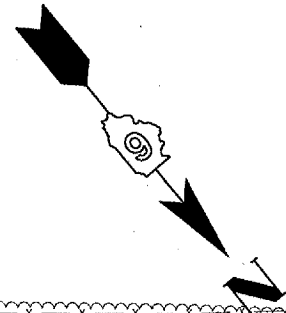

MATCH-LINE 410+00

PLOT DATE = 2/10/2005
 FILE NAME = C:\Users\jshelton\Documents\72950\72950.dgn
 PLOT SCALE = 43.3735' / IN.
 REFERENCE = #REF#

REVISIONS	
NAME	DATE

ILLINOIS DEPARTMENT OF TRANSPORTATION

LOCATION NO. 4

Plan Sheet

IL 29

SCALE: VERT. _____
HORIZ. _____

DATE _____

DRAWN BY: BDK
CHECKED BY: JCN