

steffenmk  
 10/26/2004  
 c:\projects\74048d\c102904pa.dgn

FAP NO.	SECTION	COUNTY	TOTAL SHEETS	SHEET NO.
821	*	JEFFERSON	11	5

CONTRACT NO. 74048  
 (13-2)RS-2,13ZRS-3

CURVE DATA  
 P.I. STA= 537+55.20  
 $\Delta = 24^{\circ} 34' 00.00''$  LT  
 $D = 2^{\circ} 20' 00.00''$   
 $R = 2,455.53$   
 $T = 534.64$   
 $L = 1,052.86$   
 $E = 57.53$   
 $S.E. =$   
 P.C. STA= 532+20.56  
 P.T. STA= 542+73.42

CURVE DATA  
 P.I. STA= 555+72.53  
 $\Delta = 20^{\circ} 52' 55.00''$  RT  
 $D = 1^{\circ} 07' 60.00''$   
 $R = 5,055.51$   
 $T = 931.60$   
 $L = 1,842.52$   
 $E = 85.12$   
 $S.E. =$   
 P.C. STA= 546+40.93  
 P.T. STA= 564+83.45

PROJECT BEGINS  
 STA. 543+46

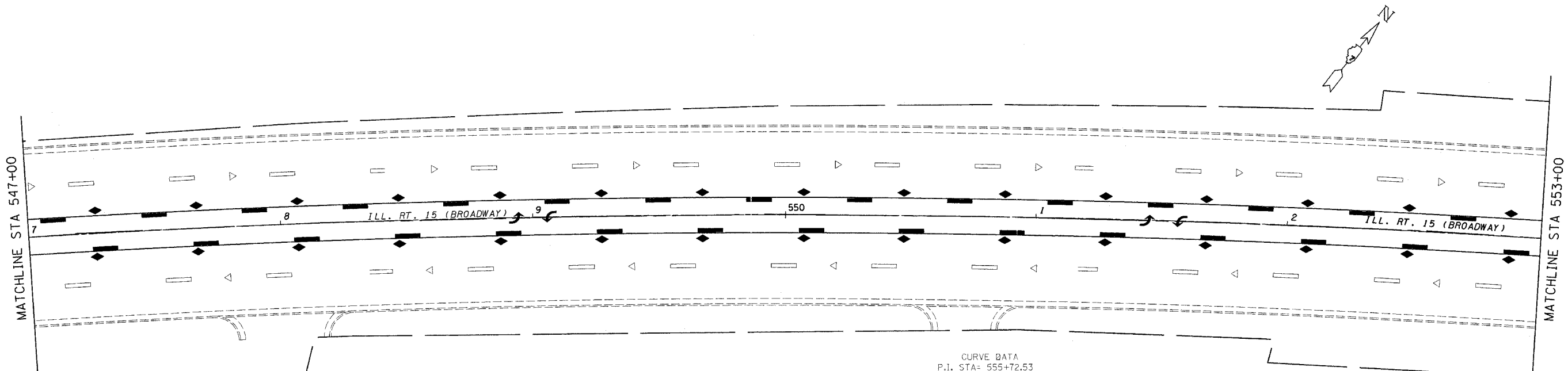
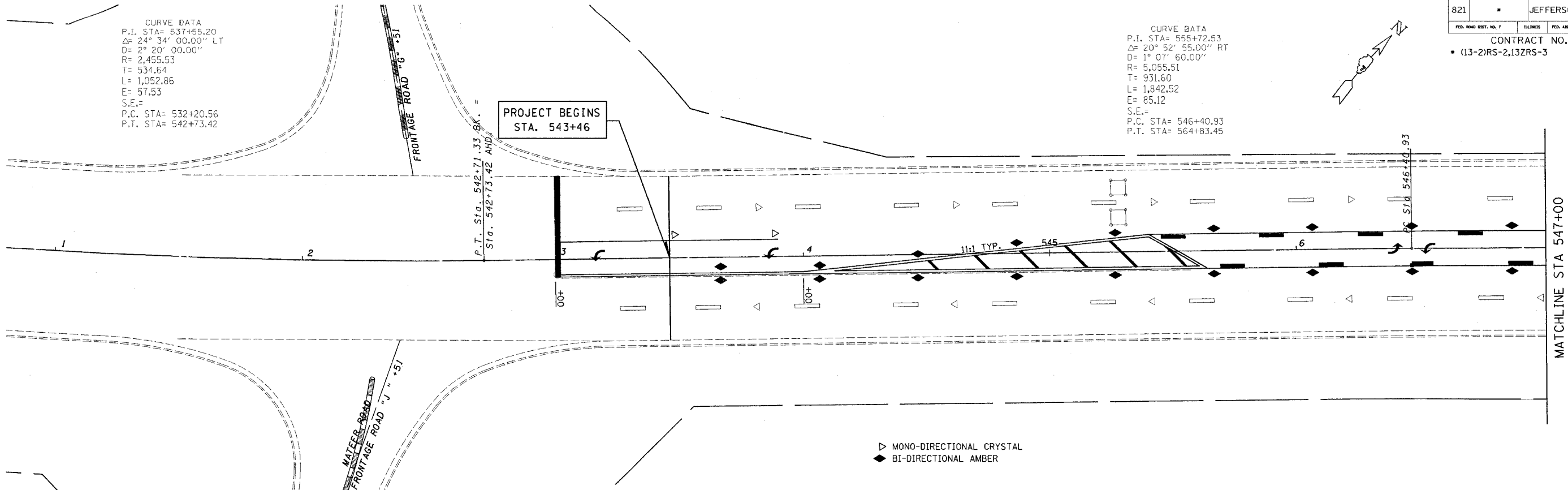

CURVE DATA  
 P.I. STA= 555+72.53  
 $\Delta = 20^{\circ} 52' 55.00''$  RT  
 $D = 1^{\circ} 07' 60.00''$   
 $R = 5,055.51$   
 $T = 931.60$   
 $L = 1,842.52$   
 $E = 85.12$   
 $S.E. =$   
 P.C. STA= 546+40.93  
 P.T. STA= 564+83.45

REVISIONS	
NAME	DATE

ILLINOIS DEPARTMENT OF TRANSPORTATION  
**STA. 543 + 46**  
**TO**  
**STA. 553 + 00**  
 SCALE: VERT. \_\_\_\_\_  
 HORIZ. \_\_\_\_\_  
 DATE \_\_\_\_\_  
 DRAWN BY \_\_\_\_\_  
 CHECKED BY \_\_\_\_\_