

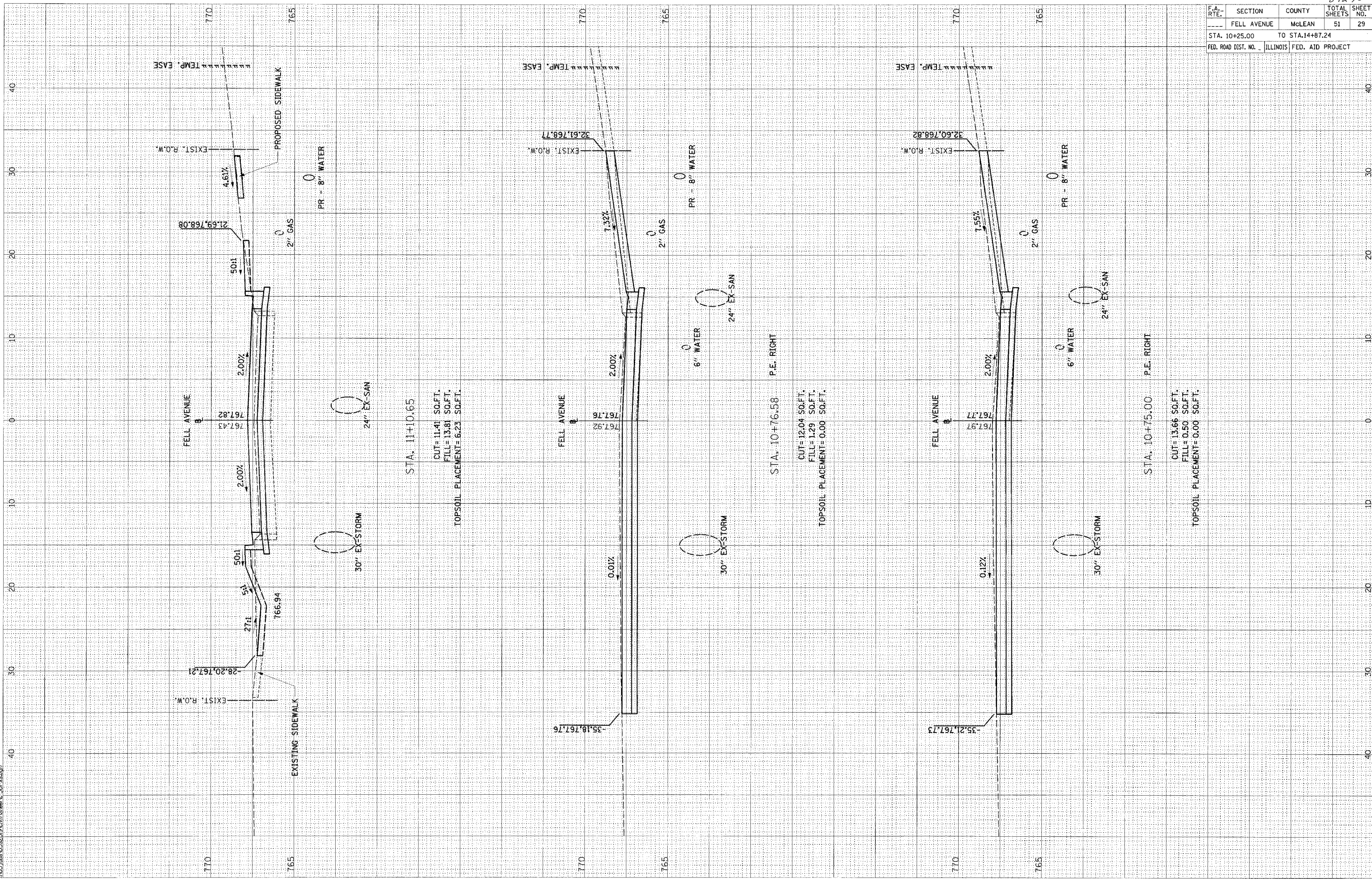

02/03/2005
 A:\03\052\0520\95\W\10\SheetC-30-165.dgn



F.A. RTE.	SECTION	COUNTY	TOTAL SHEETS	SHEET NO.
	FELL AVENUE	MCLEAN	51	29
STA. 10+25.00		TO STA. 14+87.24		
FED. ROAD DIST. NO.	ILLINOIS	FED. AID PROJECT		

87270