

ROUTE NO.	SECTION	COUNTY	TOTAL SHEETS	SHEET NO.
355	03-00201-03-FP	LIVINGSTON	5	1

PROJECT NO. SR-355(119)

STATE OF ILLINOIS  
DEPARTMENT OF TRANSPORTATION

PLANS FOR  
PROPOSED LOCAL AGENCY IMPROVEMENT  
SURFACE TRANSPORTATION PROGRAM

F.A.S. ROUTE 355, CH 16, SECTION 03-00201-03-FP  
PROJECT NO. SR-355(119)  
JOB NO. C-93-065-04

UTILITIES

CONTACT J.U.L.I.E. 800-892-0123 BEFORE DIGGING

DESIGN CRITERIA

STRUCTURAL DESIGN TRAFFIC (S.D.T.):  
YEAR 2015: PV 792, SU 63, MU 45  
MINIMUM SOIL SUPPORT: IBR = 3.00  
T.F. = 0.196; Dt = 3.2

TYPE	DEPTH	a
PROPOSED BASE STABILIZATION	9"	0.23
NEW BINDER, SUPERPAVE N50	2 1/4"	0.32
NEW SURFACE, SUPERPAVE N50	1 1/4"	0.40

INDEX OF SHEETS

- COVER SHEET, STANDARDS, & SUMMARY OF QUANTITIES
- TYPICAL CROSS-SECTION & Details
- TRANSITION DETAILS
- GUARDRAIL SCHEDULE
- SCHEDULE OF RESURFACING QUANTITIES

STATE STANDARDS DETAILS

- 630001-05 STEEL PLATE BEAM GUARDRAIL
- 630101-05 GUARDRAIL MOUNTED ON EXISTING CULVERTS
- 631026-02 TRAFFIC BARRIER TERMINAL TYPE 5 & 5A
- 701201-02 LANE CLOSURE 2L, 2W, DAY ONLY ON-RD TO 24" OFF RD FOR SPEEDS > 45 MPH
- 701301-02 LANE CLOSURE 2L, 2W SHORT TIME OPERATIONS
- 701306-01 LANE CLOSURE 2L, 2W SLOW MOVING OPERATIONS FOR SPEED > 45 MPH
- 701311-02 LANE CLOSURE 2L, 2W MOVING OPERATIONS-DAY ONLY FOR SPEEDS > 45 MPH
- 702001-05 TRAFFIC CONTROL DEVICES
- BLR 21-6 TYPICAL APPLICATION OF TRAFFIC CONTROL DEVICES FOR CONSTRUCTION ON RURAL LOCAL HIGHWAYS
- BLR 22-4 TYPICAL APPLICATION OF TRAFFIC CONTROL DEVICES FOR CONSTRUCTION ON RURAL LOCAL HIGHWAYS (ROAD CLOSED TO THRU TRAFFIC)
- BLR 23-1 TRAFFIC BARRIER TERMINAL TYPE 1
- BLR 24-1 MAILBOX TURNOUT FOR LOCAL ROADS

SUMMARY OF QUANTITIES

CONST. CODE I000

ITEM NO.	ITEM	UNIT	QUANTITIES
35200500	CEMENT	100 WT	5,968.0
40600100	BITUMINOUS MATERIALS (PRIME COAT)	GALLON	2,907.0
40600300	AGGREGATE (PRIME COAT)	TON	78.0
40800010	BITUMINOUS MATERIALS (PRIME COAT)	GALLON	58.0
40800040	INCIDENTAL BITUMINOUS SURFACING	TON	120.0
* 44000030	BITUMINOUS SURFACE REMOVAL (VARIABLE DEPTH)	SQ YD	86.0
* 48101200	AGGREGATE SHOULDERS, TYPE B	TON	1,470.0
58100200	WATERPROOFING MEMBRANE SYSTEM	SQ YD	364.0
* 63000135	STEEL PLATE BEAM GUARD RAIL, TYPE B (SPECIAL)	FOOT	100.0
* 63300405	REMOVAL AND REINSTALLATION OF EXISTING TRAFFIC BARRIER TERMINAL, TYPE 1	EACH	2.0
* 63300575	REMOVE AND RE-ERECT RAIL ELEMENT OF EXISTING GUARD RAIL	FOOT	1,281.0
* 70101800	TRAFFIC CONTROL AND PROTECTION (SPECIAL)	L SUM	1.0
70300100	SHORT-TERM PAVEMENT MARKING	FOOT	5,007.0
70301000	WORK ZONE PAVEMENT MARKING REMOVAL	SQ FT	555.0
78001110	PAINT PAVEMENT MARKING - LINE 4"	FOOT	4,171.0
* LR355000	PROCESSING STABILIZED BASE COURSE	SQ YD	43,406.0
* LR355215	BITUMINOUS MATERIALS (BASE COURSE)	GALLON	101,959.0
* X4066414	BITUMINOUS CONCRETE SURFACE COURSE, SUPERPAVE, MIX "C", N50	TON	2,865.0
* X4066614	BITUMINOUS CONCRETE BINDER COURSE, SUPERPAVE, IL-19.0, N50	TON	5,000.0
* Z0055300	RUMBLE STRIP	EACH	4.0

\* SEE SPECIAL PROVISIONS

PROJECT NO. SR-355(119)  
JOB NO. C-93-065-04  
CONTRACT NO. 87292  
DESIGN ADT= 900 / YR 2015  
CONST. TYPE CODE I000

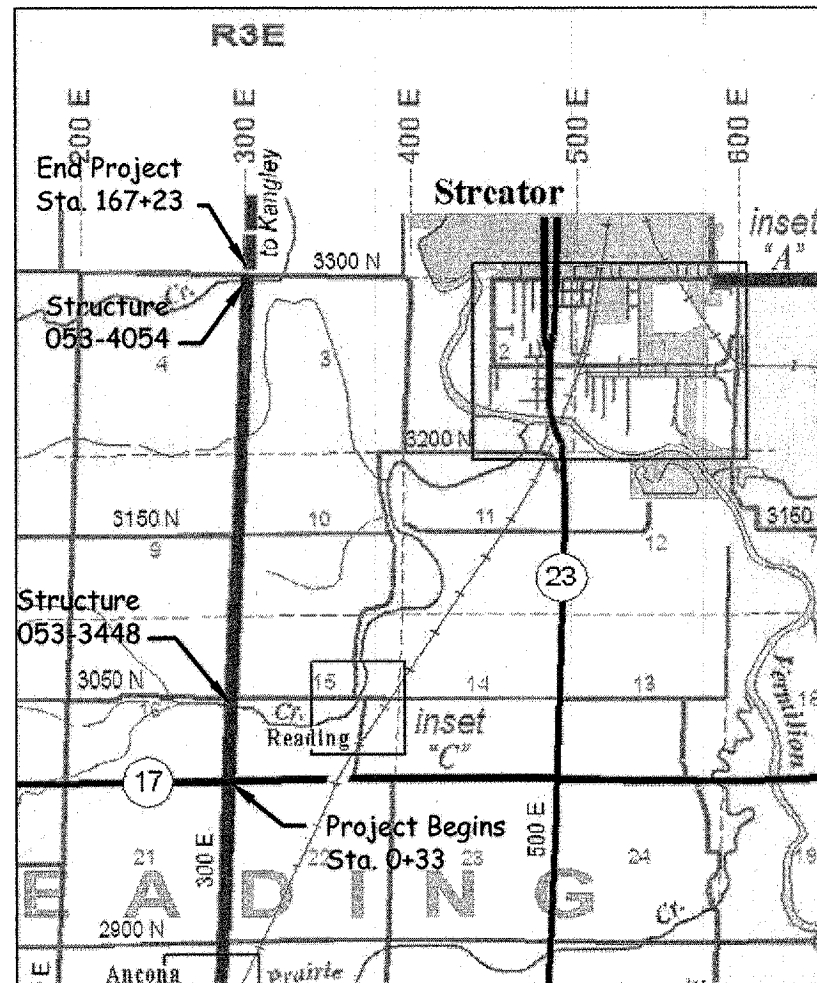

GROSS LENGTH = 16,690' = 3.161 MILES  
NET LENGTH = 16,690' = 3.161 MILES

THIS PROJECT CONSISTS OF BASE STABILIZING NINE INCHES DEEP FOR THE ENTIRE SECTION. THE REMAINING WORK SHALL INCLUDE BITUMINOUS CONCRETE BINDER COURSE, BITUMINOUS CONCRETE SURFACE COURSE, MIX "C", N50, AND AGGREGATE SHOULDERS BEGINNING AT A POINT NEAR THE INTERSECTION OF ILLINOIS STATE 17 AND COUNTY HIGHWAY 16(3000N, 300E) EXTENDING NORTHERLY TO THE INTERSECTION OF C.H. 16 AND THE LIVINGSTON/LASALLE COUNTY LINE (3300N, 300E)

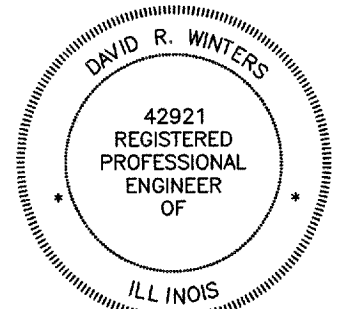

THESE PLANS WERE MADE BY ME OR BY A MEMBER OF MY STAFF WORKING UNDER MY PERSONAL SUPERVISION.

02/09/05  
DATE  
COUNTY ENGINEER, P.E. NO. 42921  
EXPIRATION DATE 11/30/2005

"THE ACCEPTANCE OF THIS PROJECT IS BASED ON THE MINIMUM DESIGN CRITERIA UNDER 3R GUIDELINES."

APPROVED	02/09/2005	LIVINGSTON COUNTY OFFICIAL
PASSED	02/09/2005	DISTRICT ENGINEER OF LOCAL ROADS & STREETS
APPROVED	02/09/2005	DISTRICT ENGINEER STATE OF ILLINOIS DEPARTMENT OF TRANSPORTATION

Z:\COWork\ROAD Projects\00201FP3-Kangley\Plans\Plans.dwg, 2/9/2005 8:33:42 AM