

F.A.P. RTE.	SECTION	COUNTY	TOTAL SHEETS	SHEET NO.
749	122RS-3	*	54	32
STA. 760+00		TO STA. 790+00		
FED. ROAD DIST. NO.		ILLINOIS FED. AID PROJECT		
CONTRACT NO. 90769				
* DOUGLAS, COLES & EDGAR				

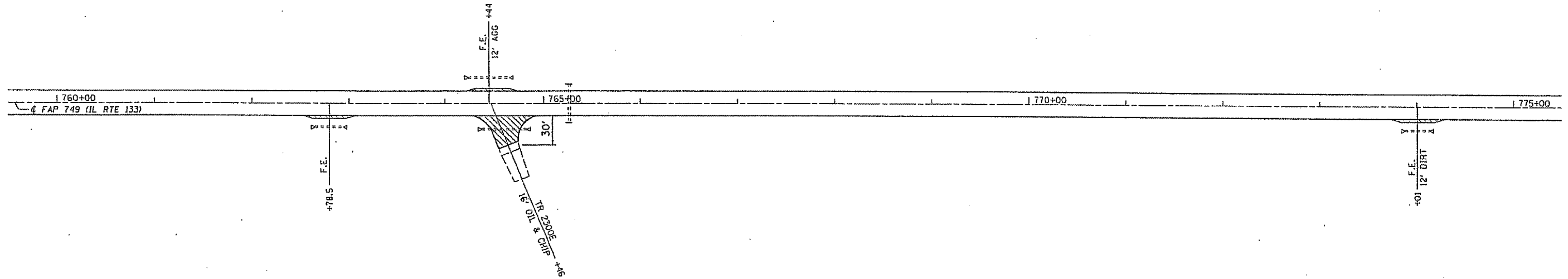

INCIDENTAL BITUMINOUS SURFACING

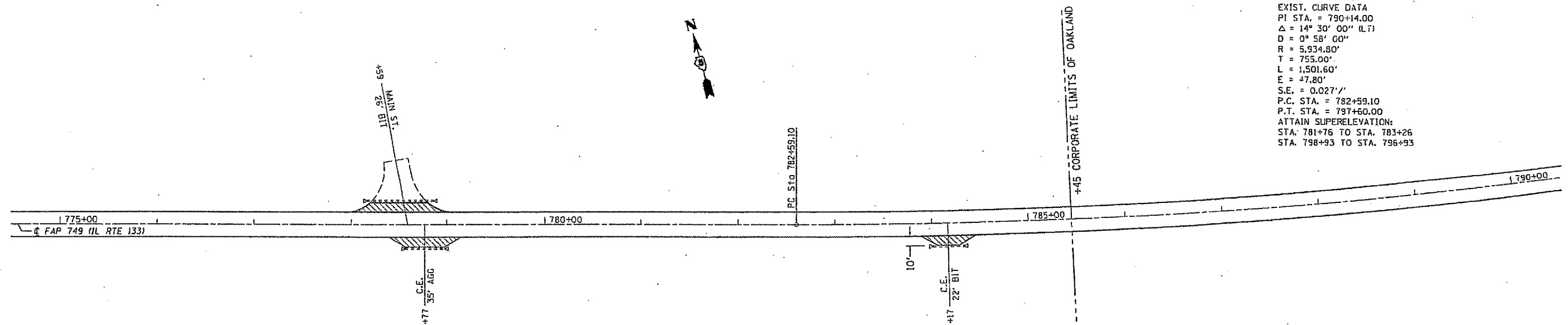

EXIST. CURVE DATA
 PI STA. = 790+14.00
 $\Delta = 14^{\circ} 30' 00''$ (L.T.)
 $D = 0^{\circ} 58' 00''$
 $R = 5,934.80'$
 $T = 755.00'$
 $L = 1,501.60'$
 $E = 47.80'$
 $S.E. = 0.027\%$
 P.C. STA. = 782+59.10
 P.T. STA. = 797+60.00
 ATTAIN SUPERELEVATION:
 STA. 781+76 TO STA. 783+26
 STA. 798+93 TO STA. 796+93

INCIDENTAL BITUMINOUS SURFACING

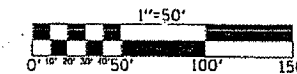

ILLINOIS DEPARTMENT OF TRANSPORTATION
PLAN VIEW
 F.A.P. ROUTE 749 (IL RTE 133)
 SECTION 122RS-3
 DOUGLAS, COLES & EDGAR COUNTY

SCALE: DATE 04/28/04

DRAWN BY: CADD
 CHECKED BY: