

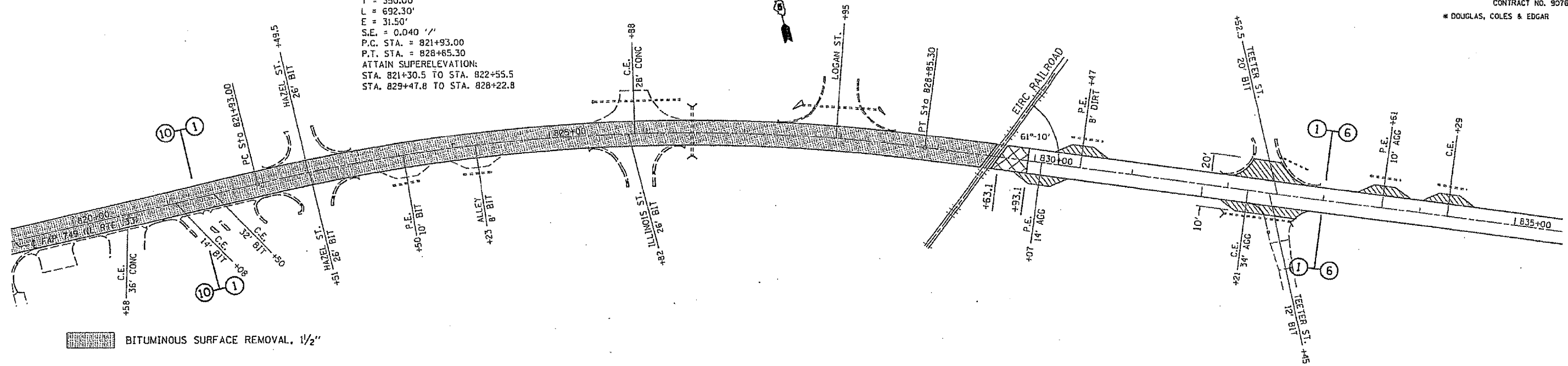

CITY OF OAKLAND

EXIST. CURVE DATA
 PI STA. = 825+43.00
 $\Delta = 20^\circ 34' 00''$ (RT)
 $D = 2^\circ 58' 15''$
 $R = 1,929.10'$
 $T = 350.00'$
 $L = 692.30'$
 $E = 31.50'$
 $S.E. = 0.040 \text{ \%/}$
 P.C. STA. = 821+93.00
 P.T. STA. = 828+85.30
 ATTAIN SUPERELEVATION:
 STA. 821+30.5 TO STA. 822+55.5
 STA. 829+47.8 TO STA. 828+22.8

F.A.P. RTE.	SECTION	COUNTY	TOTAL SHEETS	SHEET NO.
749	122RS-3	#	54	34
STA. 820+00		TO STA. 850+00		
FED. ROAD DIST. NO.		ILLINOIS	FED. AID PROJECT	
CONTRACT NO. 90769				
* DOUGLAS, COLES & EDGAR				

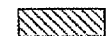

-  BITUMINOUS SURFACE REMOVAL, 1/2"
-  BITUMINOUS SURFACE REMOVAL - BUTT JOINT
-  INCIDENTAL BITUMINOUS SURFACING

EXIST. CURVE DATA
 PI STA. = 842+89.90
 $\Delta = 21^\circ 15' 00''$ (LT)
 $D = 2^\circ 41' 12''$
 $R = 2,132.20'$
 $T = 400.00'$
 $L = 790.70'$
 $E = 37.20'$
 $S.E. = 0.056 \text{ \%/}$
 P.C. STA. = 838+89.90
 P.T. STA. = 846+80.60
 ATTAIN SUPERELEVATION:
 STA. 837+39.9 TO STA. 839+64.9
 STA. 848+30.6 TO STA. 846+05.6

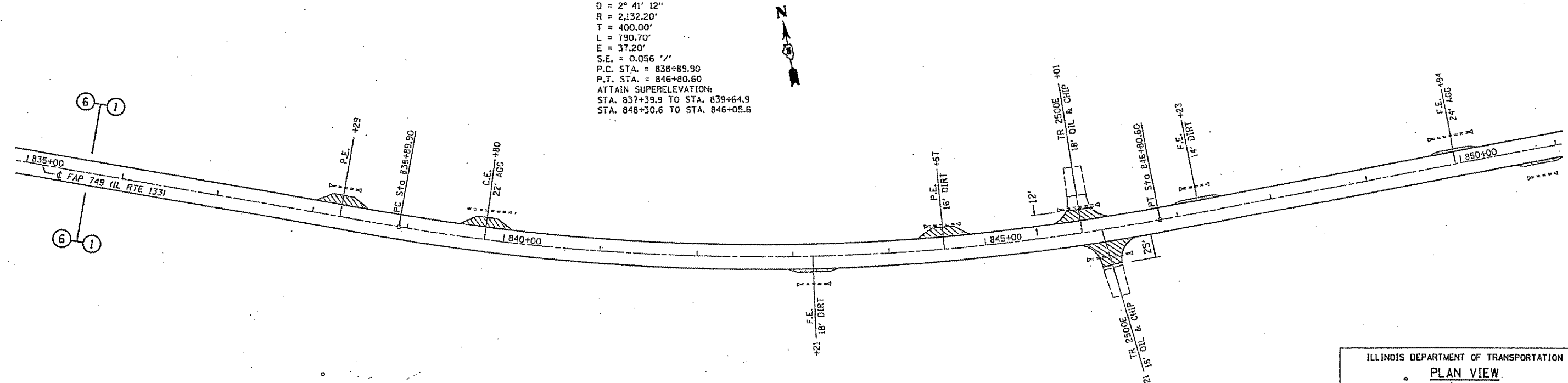

-  INCIDENTAL BITUMINOUS SURFACING

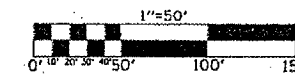

ILLINOIS DEPARTMENT OF TRANSPORTATION
PLAN VIEW
 F.A.P. ROUTE 749 (IL RTE 133)
 SECTION 122RS-3
 DOUGLAS, COLES & EDGAR COUNTY
 SCALE: DATE 04/28/04 DRAWN BY: CADD CHECKED BY: