

STEEL PLATE BEAM GUARDRAIL, TYPE A - 63000000

| STATION | STATION | LENGTH |
|--------------------|--------------|--------|
| RT OUT 449+27.00 | TO 450+89.50 | 162.5 |
| RT MED 448+54.50 | TO 450+79.50 | 225.0 |
| TOTAL = 387.5 FEET | | |

TRAFFIC BARRIER TERMINAL TYPE 1, SPECIAL (FLARED) - 63100169

| STATION | STATION | EACH |
|------------------|--------------|------|
| RT OUT 448+77.00 | TO 449+27.00 | 1 |
| RT MED 448+04.50 | TO 450+79.50 | 1 |
| TOTAL = 2 EACH | | |

TRAFFIC BARRIER TERMINAL, TYPE 2 - 63100045

| STATION | STATION | EACH |
|------------------|--------------|------|
| RT OUT 450+89.50 | TO 451+02.75 | 1 |
| RT MED 450+79.50 | TO 450+92.75 | 1 |
| TOTAL = 2 EACH | | |

| F.A.I. RTE. | SECTION | COUNTY | TOTAL SHEETS | SHEET NO. |
|-------------|---------|--------|--------------|-----------|
| 72 | | MACON | 135 | 28 |

STATION EQUATION: BK =
PC STA. 266+09.55 AH, STA. 266+09.55 AH

FED. ROAD DIST. NO. ILLINOIS FED. AID PROJECT
• (58-62.58-62-1.58-63)RS
CONTRACT NO. 90879
** STA. 240+00 TO STA. 270+00 (F.A.I. 72 WB)
STA. 440+00 TO STA. 470+00 (F.A.I. 72 EB)
1"=100'

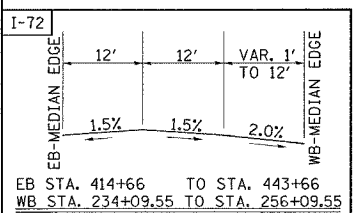
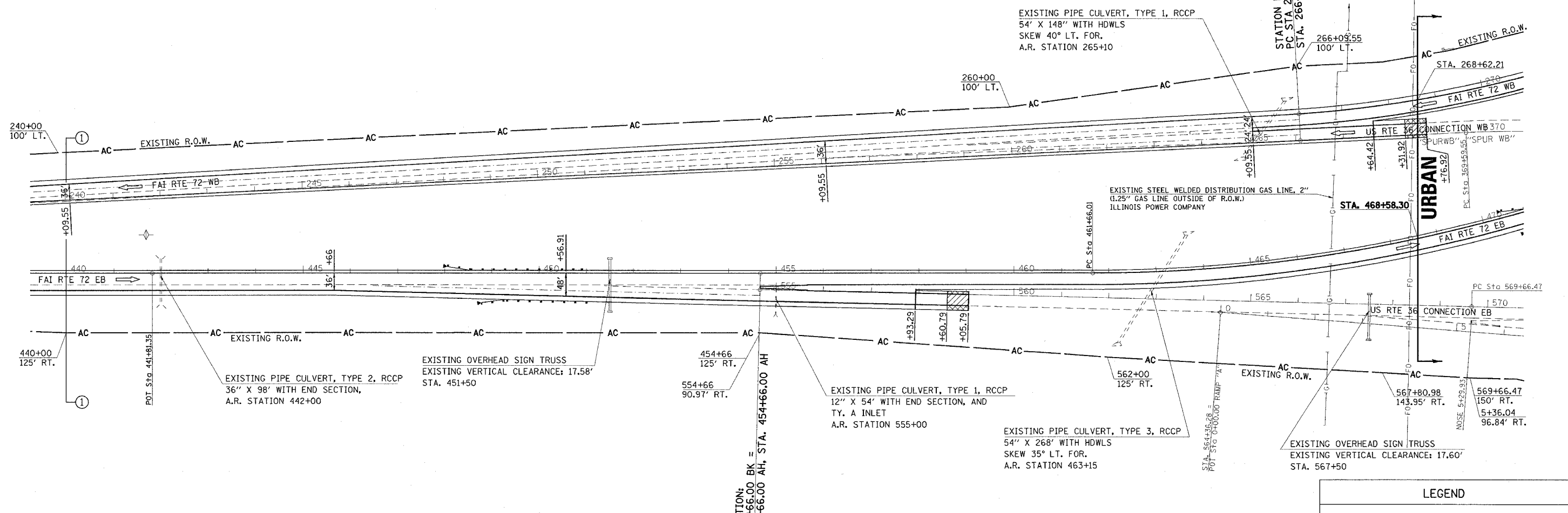
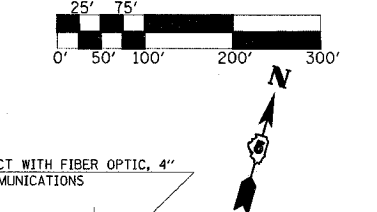

TYPICAL CROSS-SECTIONS

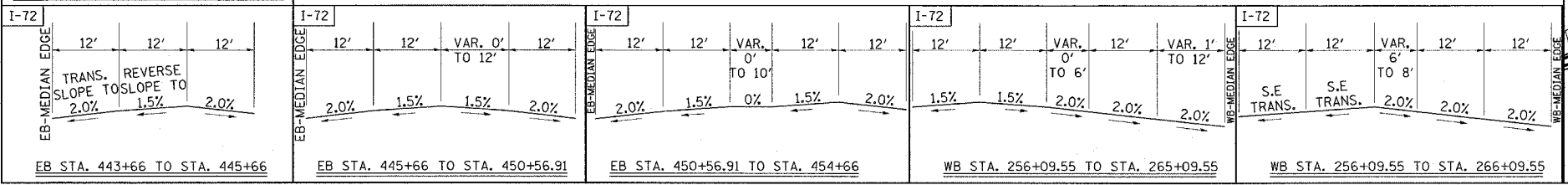

SEC. 14, T. 16 N., R. 1 E., 3RD P.M.

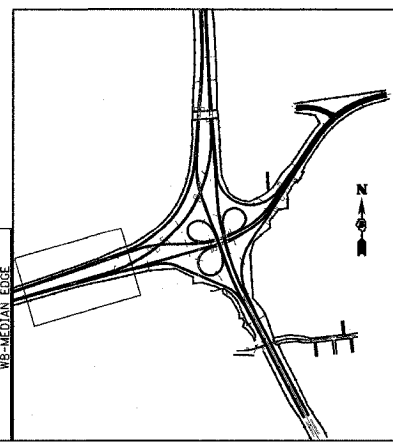

LEGEND

- BITUMINOUS SURFACE REMOVAL-BUTT JOINT
- P.C.C. SURFACE REMOVAL-BUTT JOINT

PLAN NOTE

UPON COMPLETION OF THE PROJECT, THE VERTICAL CLEARANCE OF ALL AFFECTED OVERHEAD SIGN TRUSSES SHALL BE VERIFIED AND REPORTED TO THE BUREAU OF OPERATIONS

ILLINOIS DEPARTMENT OF TRANSPORTATION

| REVISIONS | |
|-----------|------|
| NAME | DATE |
| | |
| | |
| | |
| | |
| | |
| | |
| | |
| | |
| | |
| | |

SCALE: _____ DATE _____ DRAWN BY _____ CHECKED BY _____

STA. 440+00 TO 470+00