

F.A.I. RTE.	SECTION	COUNTY	TOTAL SHEETS	SHEET NO.
72		MACON	135	34
STA. 607+00		TO STA. 637+00		
FED. ROAD DIST. NO. ILLINOIS FED. AID PROJECT				
• 58161,62,62-1,63IRS				

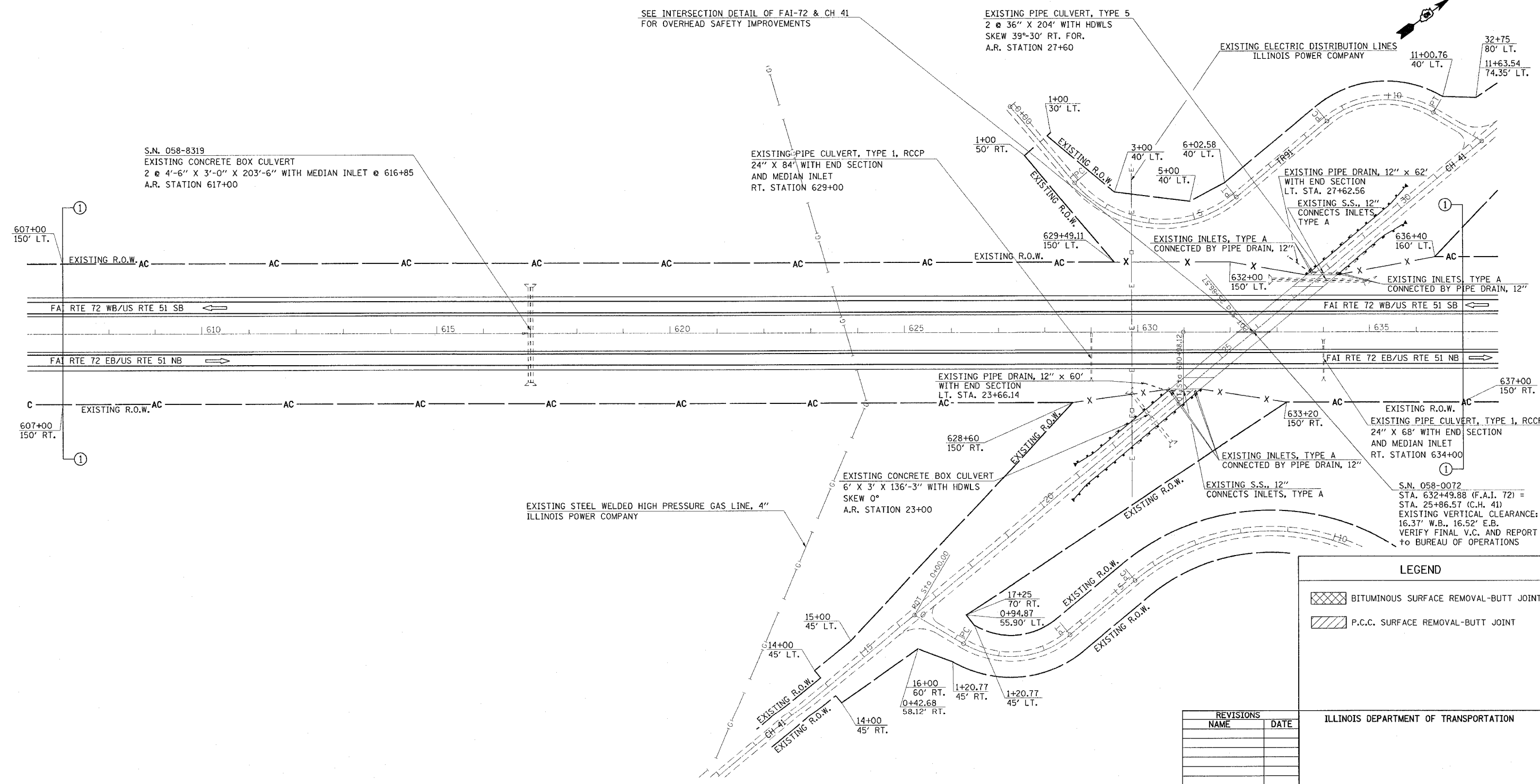
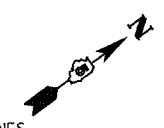
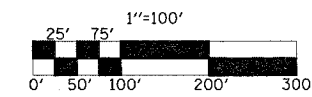

SEE INTERSECTION DETAIL OF FAI-72 & CH 41 FOR OVERHEAD SAFETY IMPROVEMENTS

S.N. 058-8319
EXISTING CONCRETE BOX CULVERT
2 @ 4'-6" X 3'-0" X 203'-6" WITH MEDIAN INLET @ 616+85
A.R. STATION 617+00

EXISTING PIPE CULVERT, TYPE 1, RCCP
24" X 84" WITH END SECTION AND MEDIAN INLET
RT. STATION 629+00

EXISTING PIPE CULVERT, TYPE 5
2 @ 36" X 204" WITH HOWLS
SKEW 39°-30' RT. FOR.
A.R. STATION 27+60

EXISTING ELECTRIC DISTRIBUTION LINES
ILLINOIS POWER COMPANY

EXISTING PIPE DRAIN, 12" X 62"
WITH END SECTION
LT. STA. 27+62.56
EXISTING S.S., 12"
CONNECTS INLETS,
TYPE A

EXISTING PIPE DRAIN, 12" X 60"
WITH END SECTION
LT. STA. 23+66.14

EXISTING CONCRETE BOX CULVERT
6' X 3' X 136'-3" WITH HDWLS
SKEW 0°
A.R. STATION 23+00

EXISTING STEEL WELDED HIGH PRESSURE GAS LINE, 4"
ILLINOIS POWER COMPANY

S.N. 058-0072
STA. 632+49.88 (F.A.I. 72) =
STA. 25+86.57 (C.H. 41)
EXISTING VERTICAL CLEARANCE:
16.37' W.B., 16.52' E.B.
VERIFY FINAL V.C. AND REPORT
TO BUREAU OF OPERATIONS

LEGEND

- BITUMINOUS SURFACE REMOVAL-BUTT JOINT
- P.C.C. SURFACE REMOVAL-BUTT JOINT

REVISIONS	
NAME	DATE

ILLINOIS DEPARTMENT OF TRANSPORTATION

SCALE: _____ DRAWN BY _____
DATE _____ CHECKED BY _____

SEC. 1, T. 16 N., R. 1 E., 3RD P.M.

SEC. 6, T. 16 N., R. 2 E., 3RD P.M.

STA. 607+00 TO 637+00