

TRAFFIC CONTROL STAGE II

STRUCTURE NUMBER 058-0074 E.B.
STRUCTURE NUMBER 058-0075 W.B.

F.A.I. SHEETS	SECTION	COUNTY	TOTAL SHEETS	SHEET NO.
72		MACON	135	68

STA. 732+00 TO STA. 747+00
FED. ROAD DIST. NO. ILLINOIS FED. AID PROJECT

(58-62,58-62-1,58-63)RS
CONTRACT NO. 90879

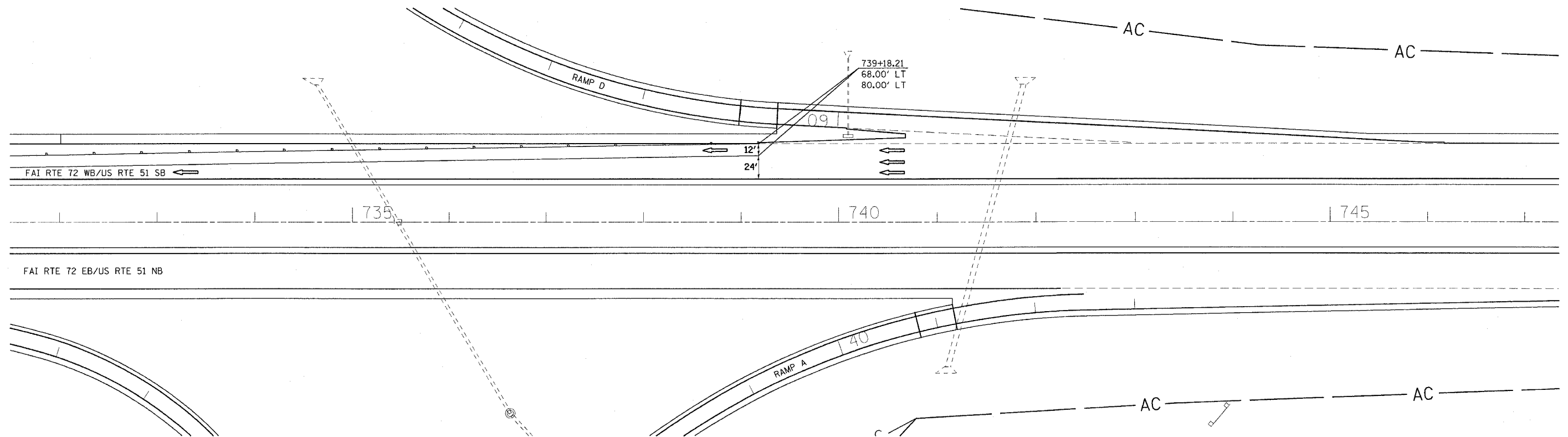
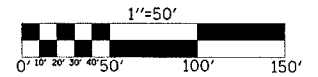

NOTES:

TRAFFIC DETAILS NOT SHOWN ARE TO CONFORM WITH STANDARD 701402 AND STANDARD 701411 AND SPECIAL FREEWAY DETAIL.

DIRECTION INDICATOR BARRICADES REQUIRED IN ALL LANE CLOSER TAPERS WHEN USING STANDARD 701401 AND 701402 AND SPECIAL FREEWAY DETAIL.

MESSAGE BOARD MAY BE ADJUSTED TO MEET FIELD CONDITIONS.

RESIDENT ENGINEER AND TRAFFIC CONTROL SUPERVISOR WILL PROVIDE APPROPRIATE MESSAGE FOR THE CHANGEABLE MESSAGE SIGN.

PAVEMENT MARKING REMOVAL	STATION TO STATION	SQ. FT.
	LT 732+00.00 TO LT 739+18.21	239
	LT 732+00.00 TO LT 739+18.21	239
	TOTAL	478

TEMPORARY PAINT PAVEMENT MARKING LINE 4"	STATION TO STATION	FOOT
	LT 732+00.00 TO LT 739+18.21	718 WHITE
	LT 732+00.00 TO LT 739+18.21	718 WHITE
	TOTAL	1436

REVISIONS	
NAME	DATE

ILLINOIS DEPARTMENT OF TRANSPORTATION

TRAFFIC CONTROL - STAGE II

F.A.I. ROUTE 72

SECTION (58-62,58-62-1,58-63)RS

MACON COUNTY

VERT. SCALE: 1" = 50'
HORIZ. SCALE: 1" = 50'
DATE 10/22/03

DRAWN BY CADD
CHECKED BY