

F.A.I. RTE.	SECTION	COUNTY	TOTAL SHEETS	SHEET NO.
72	*	MACON	135	83

(58-62,58-62-1,58-63)RS  
CONTRACT NO. 90879

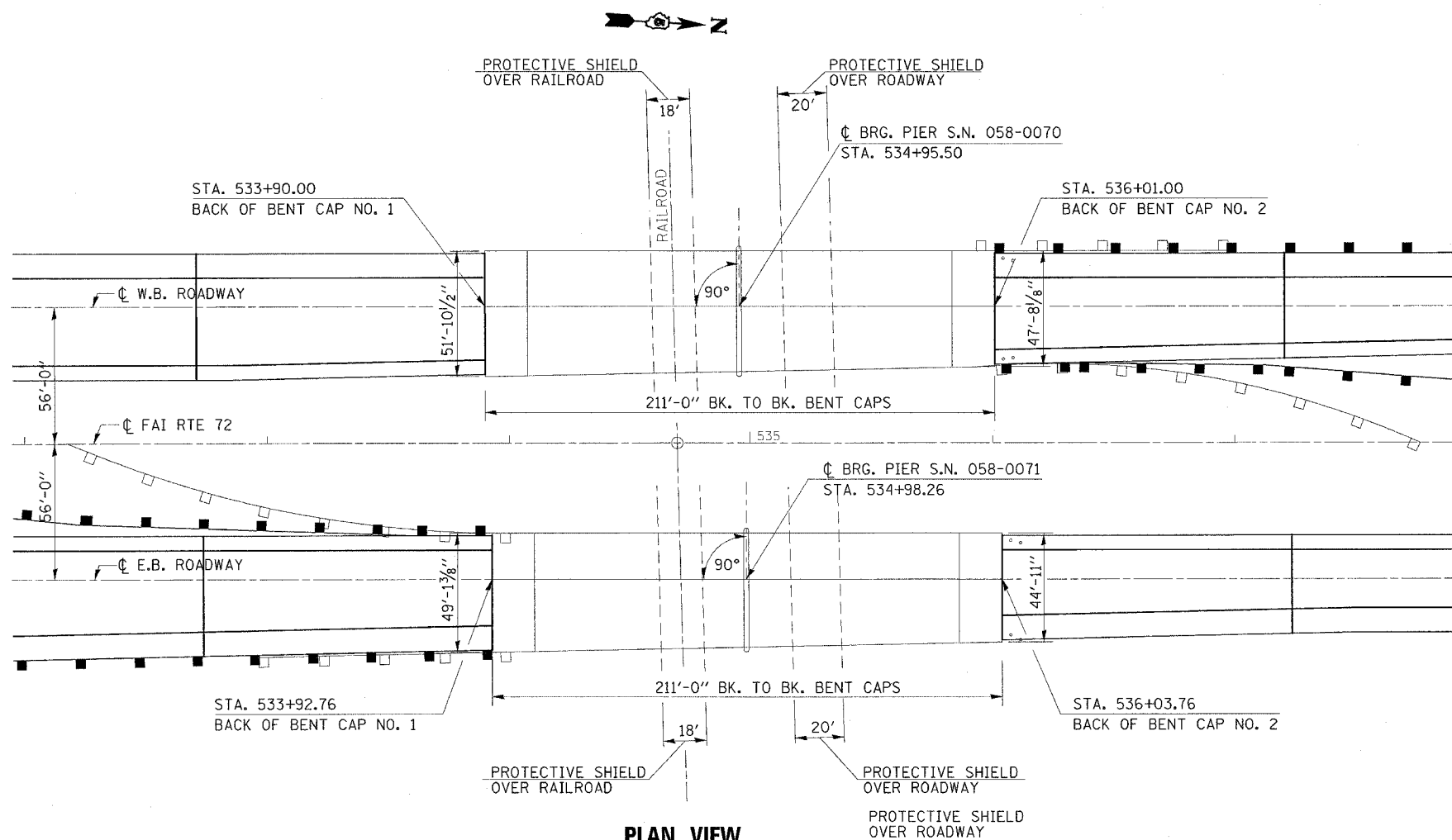

**PLAN VIEW**  
S. N. 058-0070 W. B.  
S. N. 058-0071 E. B.

**GENERAL NOTES**

PLAN DIMENSIONS AND DETAILS RELATIVE TO THE STRUCTURE HAVE BEEN TAKEN FROM EXISTING PLANS AND ARE SUBJECT TO NOMINAL CONSTRUCTION VARIATIONS. IT SHALL BE THE CONTRACTOR'S RESPONSIBILITY TO VERIFY SUCH DIMENSIONS AND DETAILS IN THE FIELD AND MAKE THE NECESSARY APPROVED ADJUSTMENTS PRIOR TO CONSTRUCTION OR ORDERING OF MATERIALS. SUCH VARIATIONS SHALL NOT BE CAUSE FOR ADDITIONAL COMPENSATION FOR A CHANGE IN THE SCOPE OF WORK, HOWEVER, THE CONTRACTOR WILL BE PAID FOR THE QUANTITY ACTUALLY FURNISHED AT THE CONTRACT UNIT PRICE FOR THE WORK.

NOTE: SEE EXISTING ROADWAY INFORMATION SYSTEM DETAIL AND SPECIAL PROVISION.

**TOTAL BILL OF MATERIALS**

ITEM	UNITS	TOTAL	S. N. 058-0070	S. N. 058-0071
BITUMINOUS CONCRETE REMOVAL (DECK)	SQ YD	3,095.0	1,553.0	1,542.0
FLOOR DRAINS	EACH	24.0	12.0	12.0
BRIDGE DECK GROOVING	SQ YD	2,002.0	1,033.0	969.0
BRIDGE DECK HYDRO-SCARIFICATION	SQ YD	2,096.0	1,080.0	1,016.0
DECK SLAB REPAIR (FULL DEPTH, TYPE I)	SQ YD	12.0	6.0	6.0
DECK SLAB REPAIR (FULL DEPTH, TYPE II)	SQ YD	17.0	11.0	6.0
BRIDGE DECK MICROSILICA CONCRETE OVERLAY 2 1/4"	SQ YD	2,096.0	1,080.0	1,016.0
PROTECTIVE SHIELD	SQ YD	410.0	199.0	211.0
APPROACH SLAB REPAIR (PARTIAL)	SQ YD	9.0	3.0	6.0

S.N. 058-0070  
S.N. 058-0071