

F.A.I. RTE.	SECTION	COUNTY	TOTAL SHEETS	SHEET NO.
72	*	MACON	135	108

(58-62,58-62-1,58-63)RS  
 CONTRACT NO. 90879  
**SHEET 13 of 16**

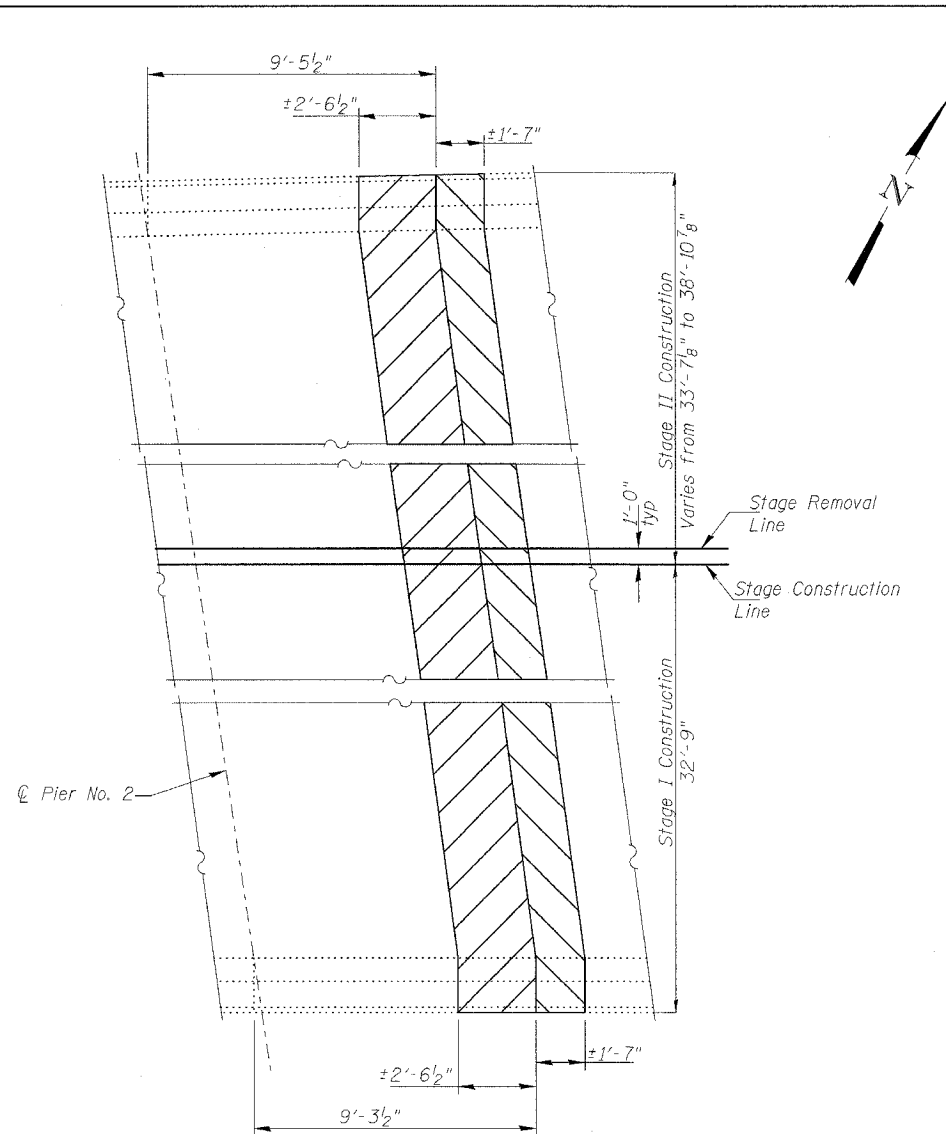

**EXISTING PARTIAL PLAN**  
 JOINT AT LINK

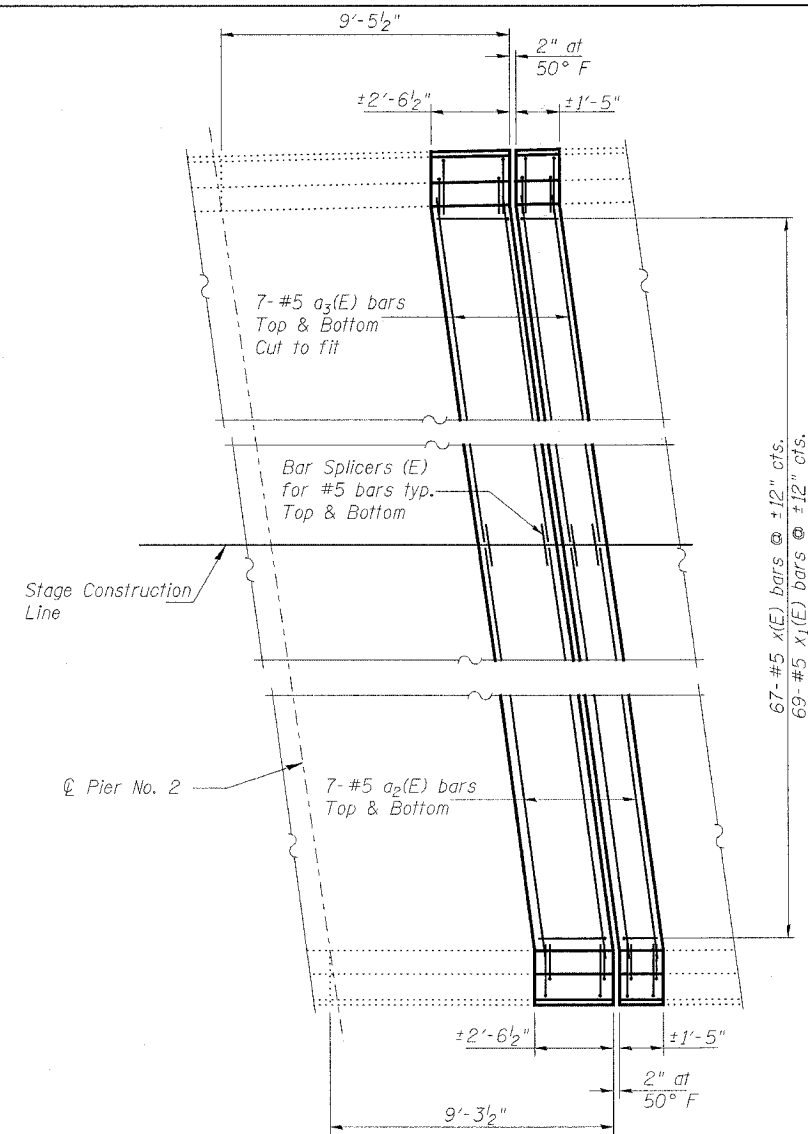

**PROPOSED PARTIAL PLAN**  
 JOINT AT LINK

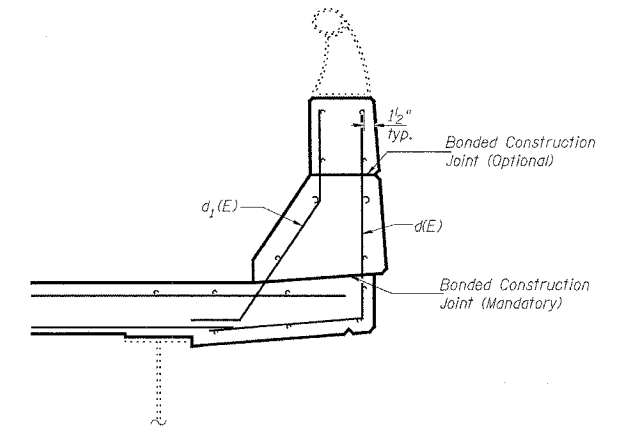

**SECTION THRU PARAPET**

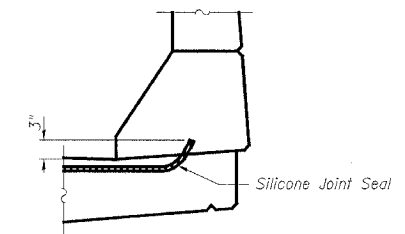

**TYPICAL END OF SEAL TREATMENT AT EXPANSION JOINT**

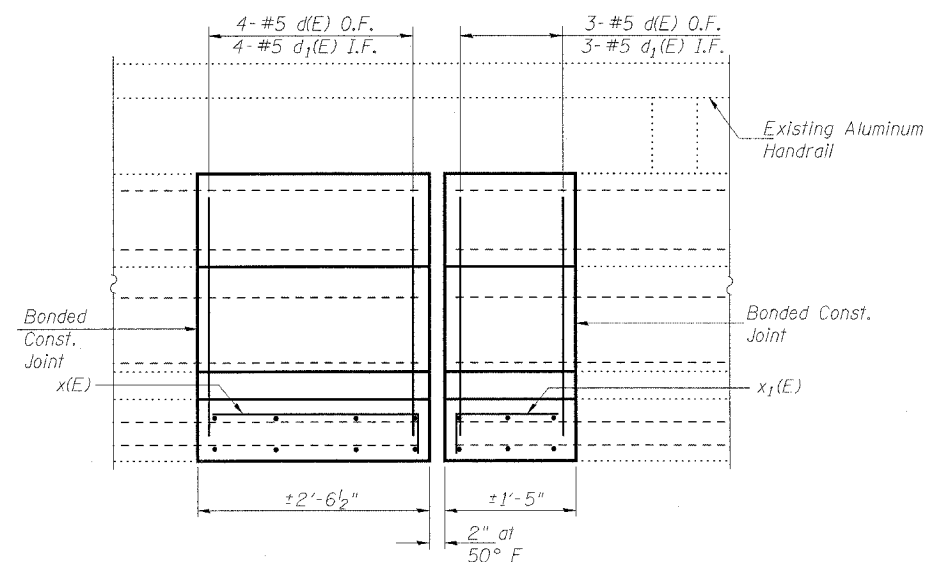

**PARAPET ELEVATION AT LINK**

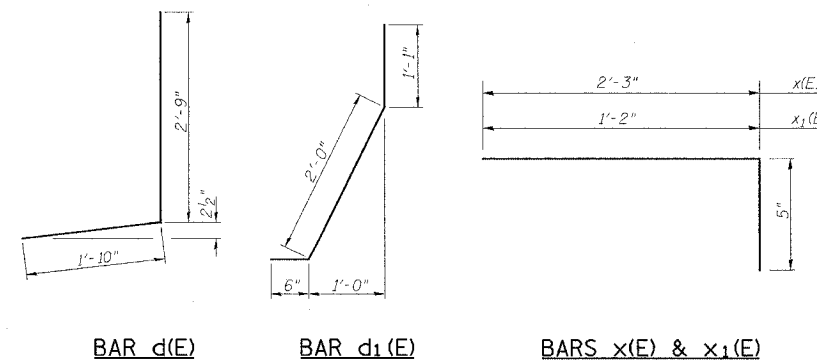

**BILL OF MATERIAL**

Bar No.	Size	Length	Shape
a2(E) 14	#5	32'-3"	—
a3(E) 14	#5	38'-8"	—
d(E) 14	#5	4'-7"	J
d1(E) 14	#5	3'-7"	J
x(E) 67	#5	2'-8"	—
x1(E) 69	#5	1'-7"	—
Reinforcement Bars, Epoxy Coated			Pound 1460
Concrete Superstructure			Cu. Yd. 8.1

Reinforcement bars designated (E) shall be epoxy coated.  
 Hatched area indicates Concrete Removal.  
 I.F. = Inside Face  
 O.F. = Outside Face

**JOINT REPAIR AT LINK**  
**F.A.I. ROUTE 72 SEC. 58-63HVB**  
**MACON COUNTY**  
**S.N. 058-0075**