







F.A. RTE.	SECTION	COUNTY	TOTAL SHEETS	SHEET NO.
*	D2-00088-00-BR	MORGAN	76	18
STA. 165+00		TO STA. 180+00		
FED. ROAD DIST. NO.	ILLINOIS	FED. AID PROJECT		
* COUNTY HIGHWAY 19 (FAS 611)				
CONTRACT NO. 93388				

MORGAN COUNTY
SEC 7, T 16 N, R 9 W, 3RD PM

- LEGEND**
-  PERIMETER EROSION BARRIER
 -  EROSION CONTROL BLANKET
 -  AGGREGATE DITCH
 -  TEMPORARY DITCH CHECK
 -  INLET & PIPE PROTECTION
 -  STANDARD DITCH - FLOW LINE AND DIRECTION
 -  SPECIAL DITCH - FLOW LINE AND DIRECTION
 -  PROPOSED RIPRAP PLACEMENT

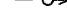

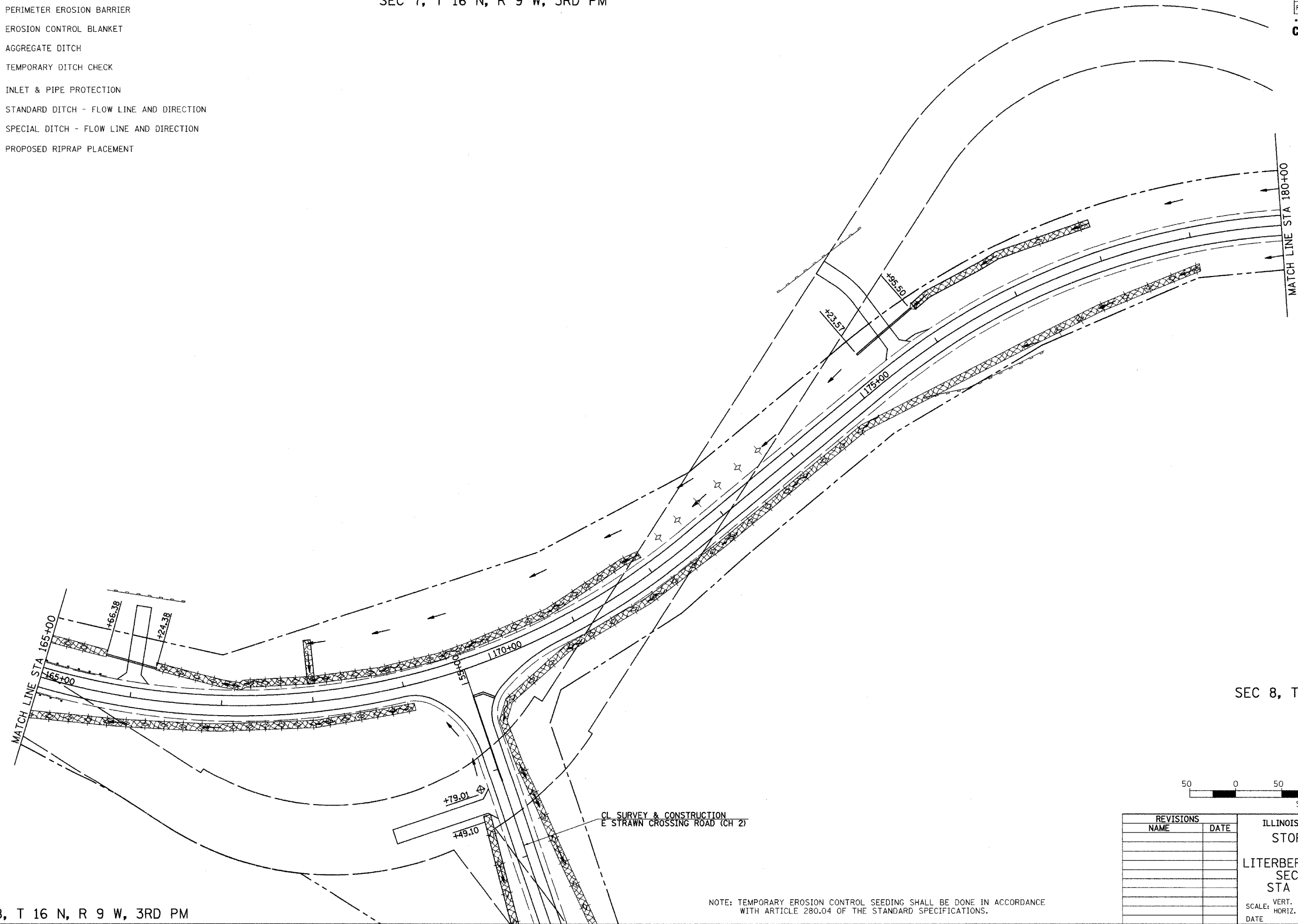
SEC 8, T 16 N, R 9 W, 3RD PM

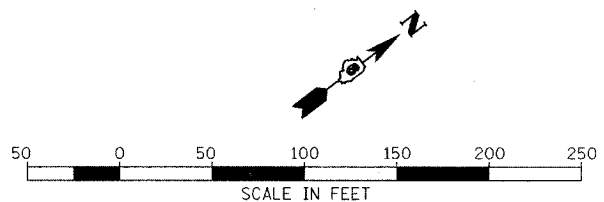

SEC 18, T 16 N, R 9 W, 3RD PM

21985002

NOTE: TEMPORARY EROSION CONTROL SEEDING SHALL BE DONE IN ACCORDANCE WITH ARTICLE 280.04 OF THE STANDARD SPECIFICATIONS.

REVISIONS	
NAME	DATE

ILLINOIS DEPARTMENT OF TRANSPORTATION
STORM WATER POLLUTION PREVENTION PLAN
 LITERBERRY-PRENTICE ROAD (CH 19)
 SECTION 02-00088-00-BR
 STA 165+00 TO STA 180+00

SCALE: VERT. _____
 HORIZ. _____
 DATE _____

DRAWN BY _____
 CHECKED BY _____