

F.A. RTE.	SECTION	COUNTY	TOTAL SHEETS	SHEET NO.
• 02-00088-00-BF	MORGAN		76	42
STA. 148+00.00		TO STA. 151+13.00		
FED. ROAD DIST. NO.		ILLINOIS FED. AID PROJECT		
COUNTY HIGHWAY 19		CHAS. 611A		

CONTRACT NO. 93388

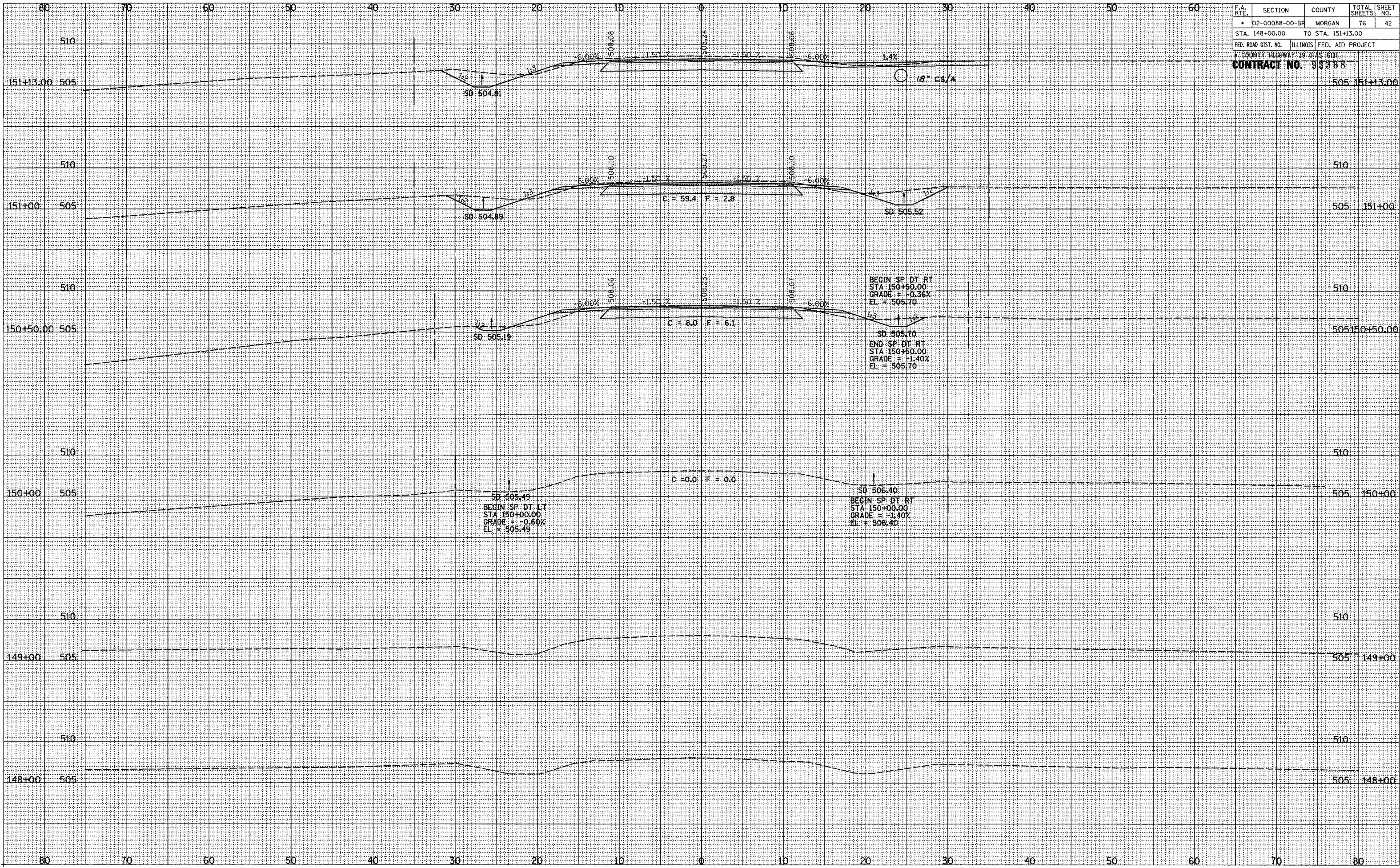

ROADWAY CROSS SECTIONS LITERBERRY-PRENTICE ROAD (CH 19)

SURVEYED	PLOTTED	TEMPLATE	AREAS CHECKED

SURVEYED	PLOTTED	TEMPLATE	AREAS CHECKED