

F.A. RTE.	SECTION	COUNTY	TOTAL SHEETS	SHEET NO.
D2-00088-00-BR		MORGAN	76	49
STA. 161+00.00		TO STA. 162+00.00		
FED. ROAD DIST. NO.		ILLINOIS FED. AID PROJECT		
COUNTY HIGHWAY 19 (FAS 3611)		CONTRACT NO. 93388		

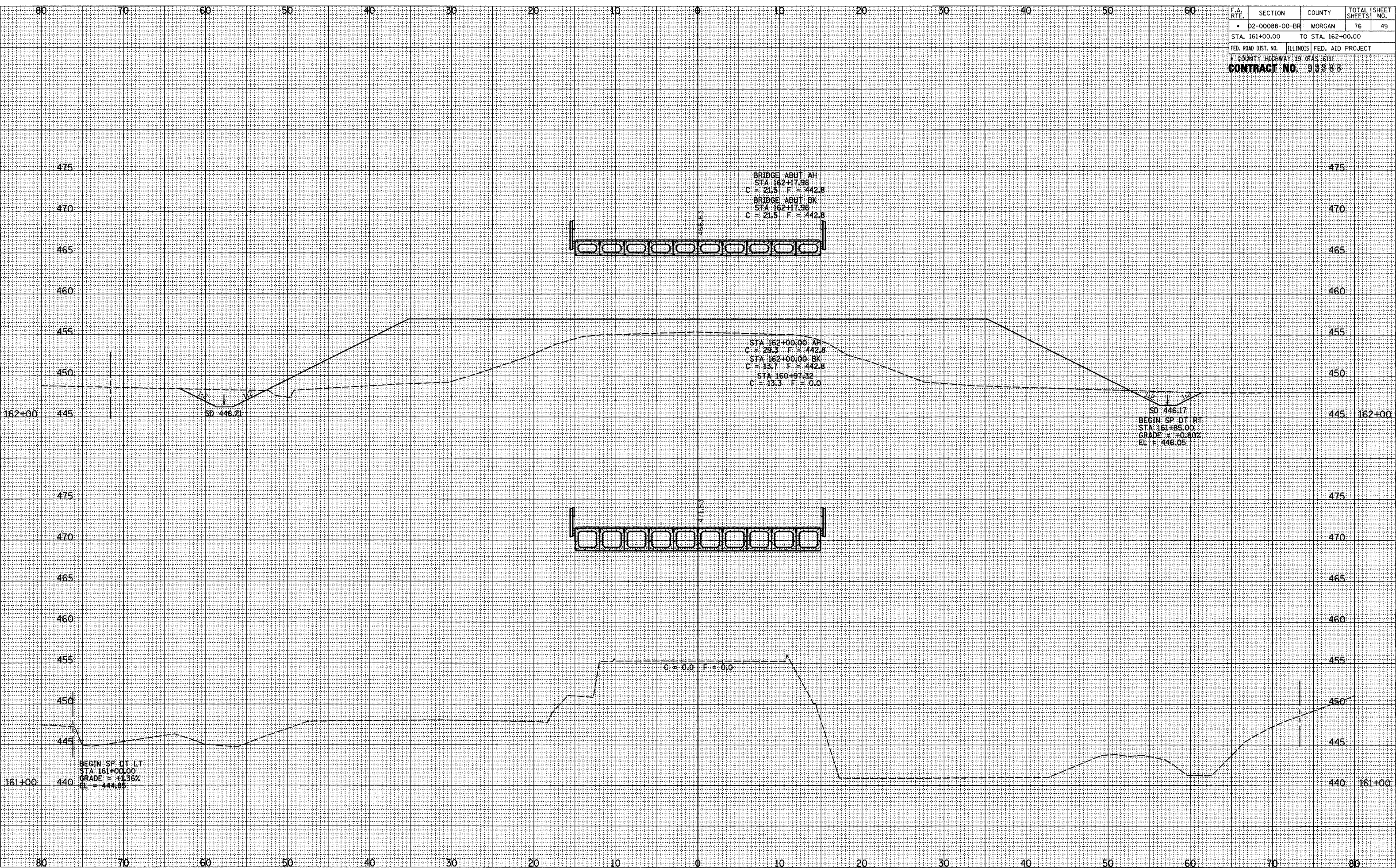

ROADWAY CROSS SECTIONS LITERBERRY-PRENTICE ROAD (CH 19)

SURVEYED  
 SURVEY  
 NOTE BOOK  
 NO.

SURVEYED  
 SURVEY  
 NOTE BOOK  
 NO.