

F.A. RTE.	SECTION	COUNTY	TOTAL SHEETS	SHEET NO.
D2-00088-00-BR		MORGAN	76	54
STA. 169+69.00		TO STA.		
FED. ROAD DIST. NO.	ILLINOIS	FED. AID PROJECT		
CONTRACT NO. 93388				

NO.	AREAS CHECKED	NOTE BOOK	TEMPLATE	FLOTTED	SURVEY

NO.	AREAS CHECKED	NOTE BOOK	TEMPLATE	FLOTTED	SURVEY

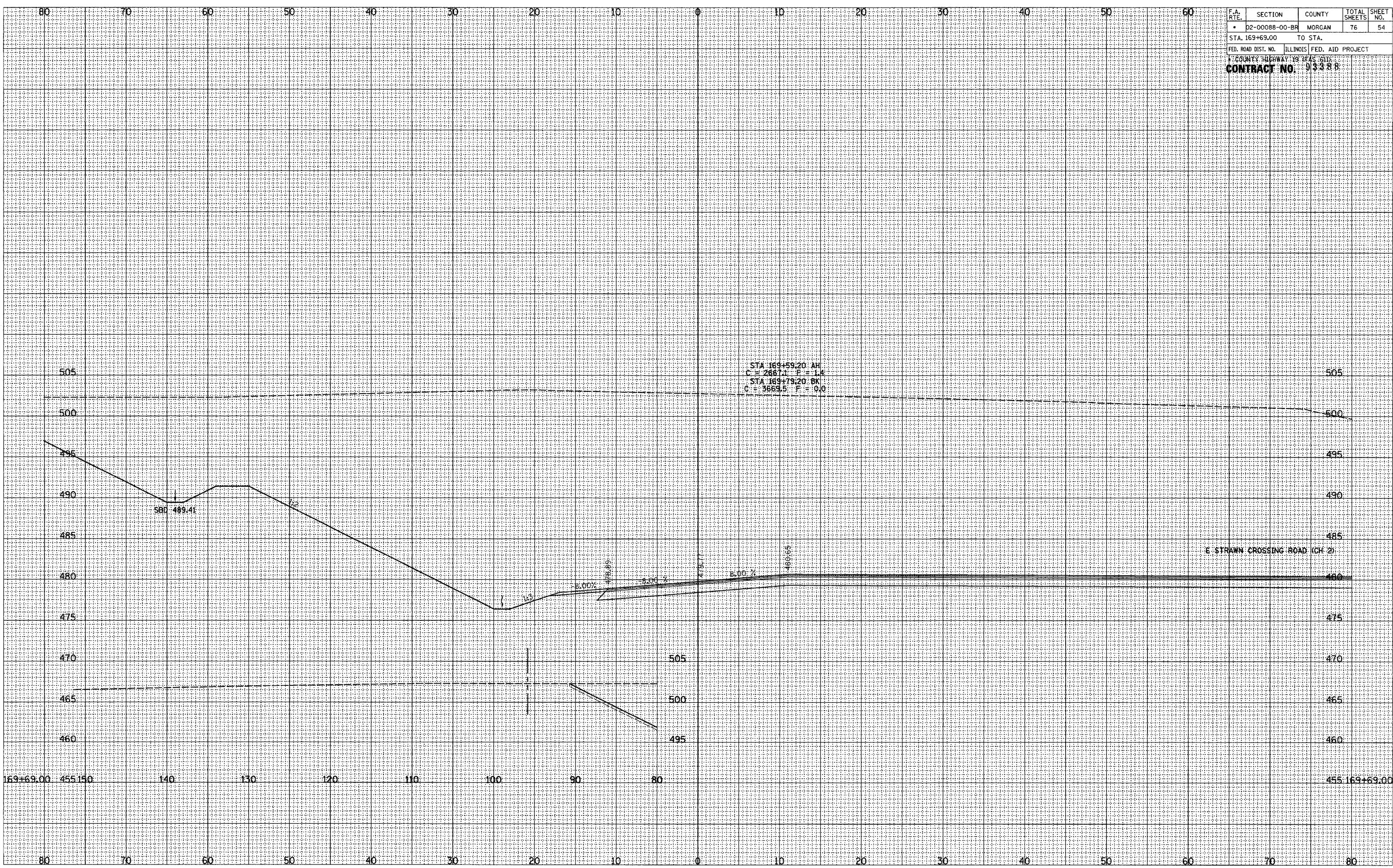

ROADWAY CROSS SECTIONS LITERBERRY-PRENTICE ROAD (CH 19)