

F.A. RTE.	SECTION	COUNTY	TOTAL SHEETS	SHEET NO.
•	02-00088-00-BR	MORGAN	76	56
STA. 171+00.00		TO STA.		
FED. ROAD DIST. NO.		ILLINOIS FED. AID PROJECT		
COUNTY HIGHWAY NO.		ILLINOIS		
CONTRACT NO.		93388		

SURVEYED	DATE
BY	
NOTE BOOK	
NO.	
AREAS CHECKED	

SURVEYED	DATE
BY	
NOTE BOOK	
NO.	
AREAS CHECKED	

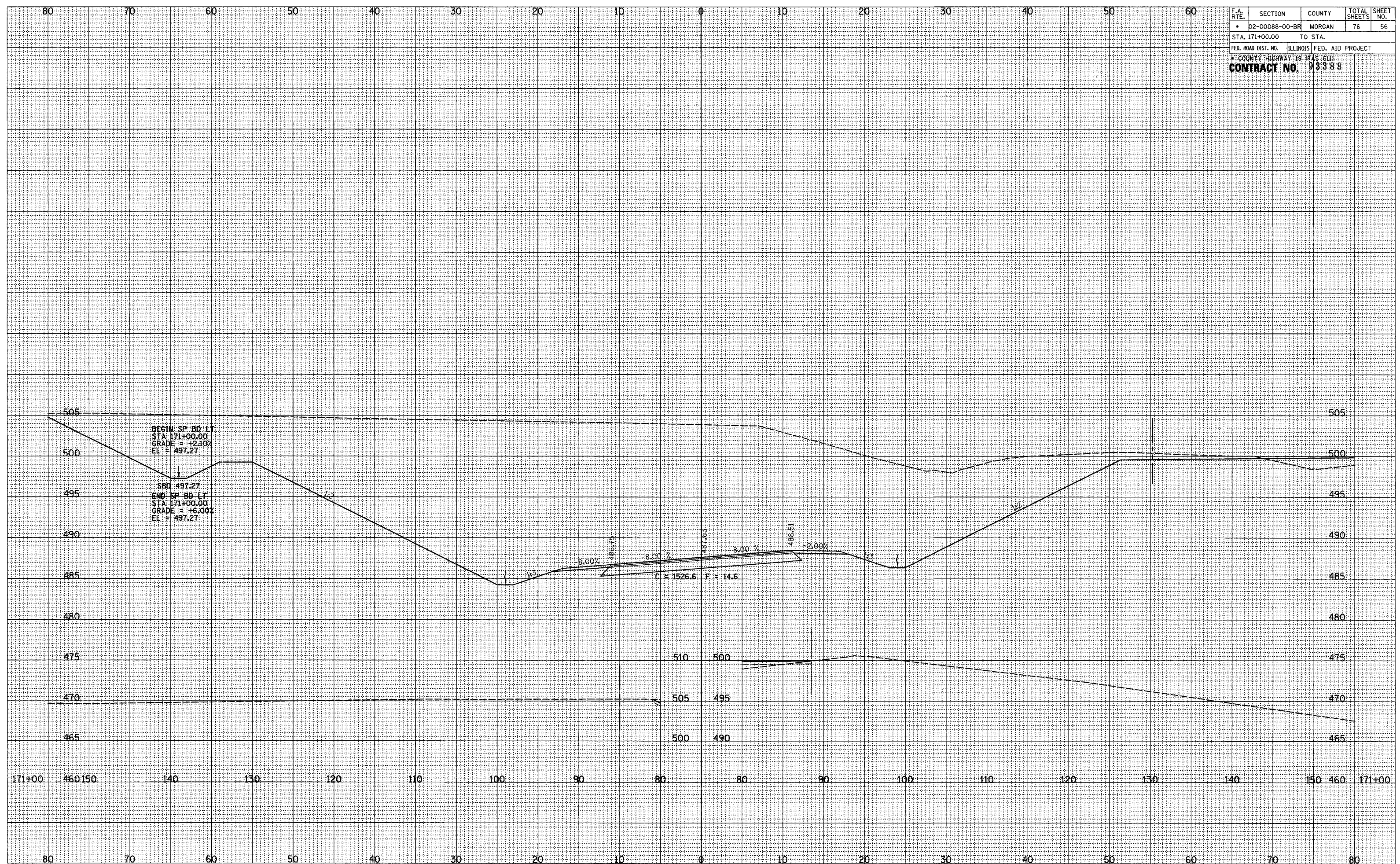

ROADWAY CROSS SECTIONS LITERBERRY-PRENTICE ROAD (CH 19)