

F.A. RTE.	SECTION	COUNTY	TOTAL SHEETS	SHEET NO.
• D2-00088-00-BR	MORGAN		76	61
STA. 180+50.00		TO STA. 182+00.00		
FED. ROAD DIST. NO. ILLINOIS FED. AID PROJECT				
F. COUNTY HIGHWAY: 19 (AS 61)				
<b>CONTRACT NO. 33388</b>				

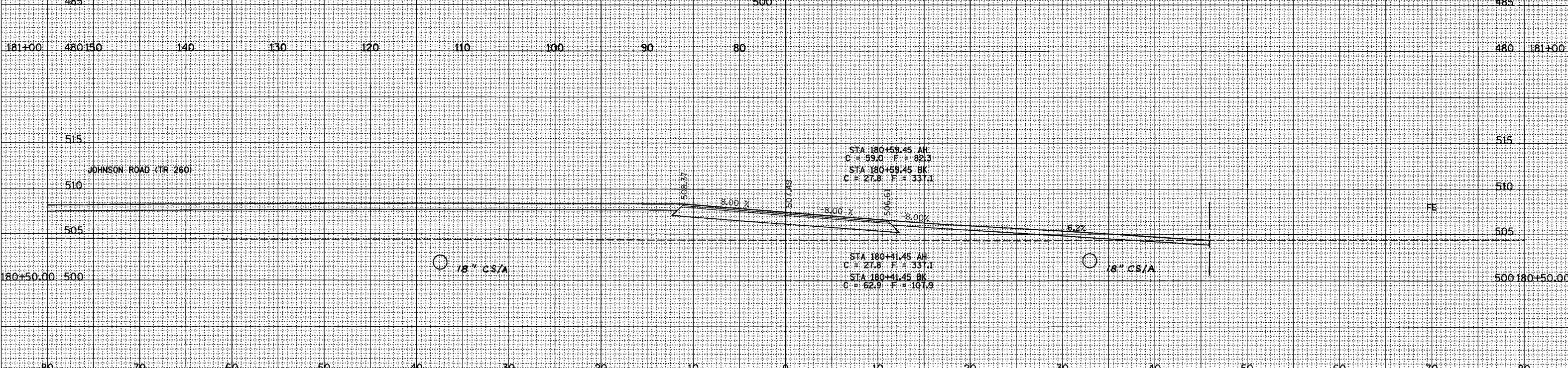
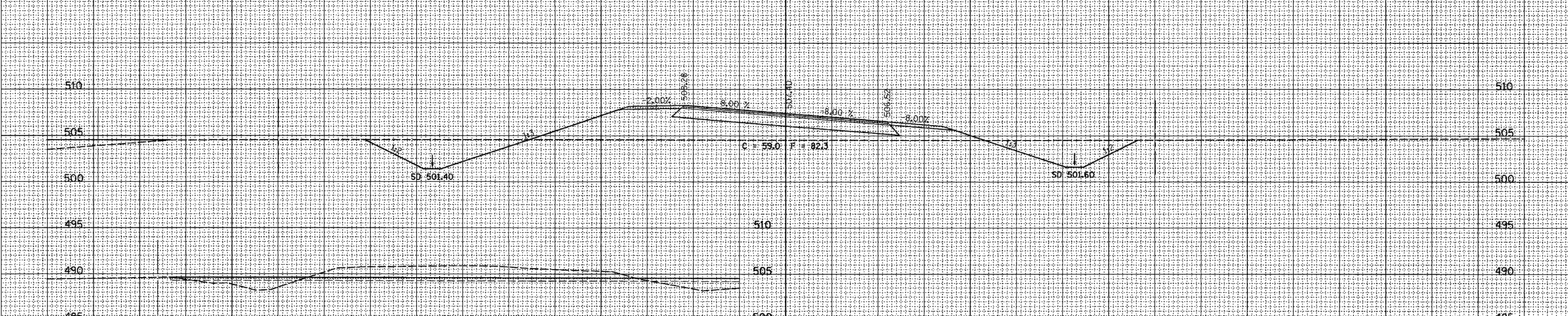
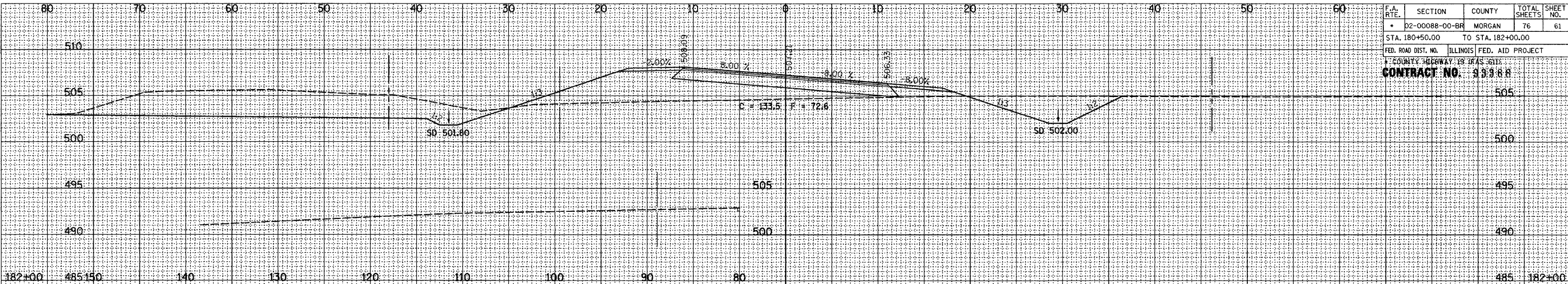

ROADWAY CROSS SECTIONS LITERBERRY-PRENTICE ROAD (CH 19)

SURVEYED BY: [ ]  
 CHECKED BY: [ ]  
 DATE: [ ]  
 SCALE: [ ]  
 SHEET NO.: [ ]

SURVEYED BY: [ ]  
 CHECKED BY: [ ]  
 DATE: [ ]  
 SCALE: [ ]  
 SHEET NO.: [ ]