

F.A.P. RTE.	SECTION	COUNTY	TOTAL SHEETS	SHEET NO.
774		EFFINGHAM	273	36
FED. ROAD DIST. NO. 7		ILLINOIS	FED. AID PROJECT	

*107WRS-1, 107BY, 107BY-1 & 107B-2
CONTRACT NO. 94827

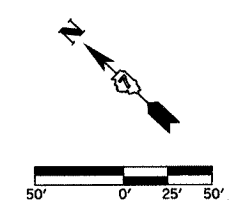

- SHEET NOTES:**
- FROM STA. 40+10 TO END OF PROJECT THE CONTRACTOR IS TO CONFINE CONSTRUCTION TO ONE SIDE OF THE ROAD AT A TIME
 - FROM STA. 40+10.00 TO STA. 46+80.05: THE FOLLOWING CONSTRUCTION TO BE PERFORMED UNDER TRAFFIC UTILIZING FLAGGERS. DURING STAGE I MILL EXISTING PAVEMENT, APPLY LEVELING BINDER AND SURFACE COURSE IN CONJUNCTION WITH WIDENING AND CURB AND GUTTER ON SOUTH SIDE OF IL RTE 32/33.
 - REMOVE WOODBIRD AND WOODLAND DRIVE PAVEMENT DURING STAGE I. SEE SHEET 73 FOR REMOVAL LIMITS.

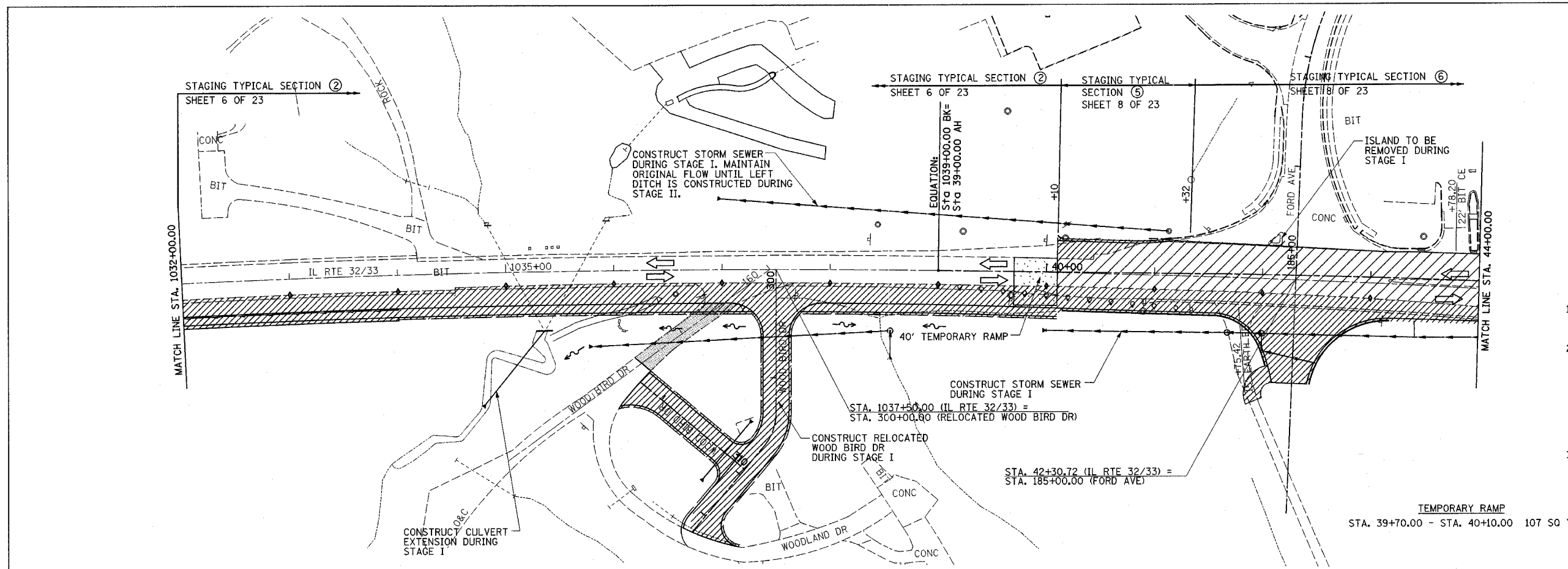
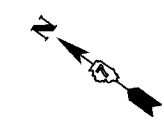
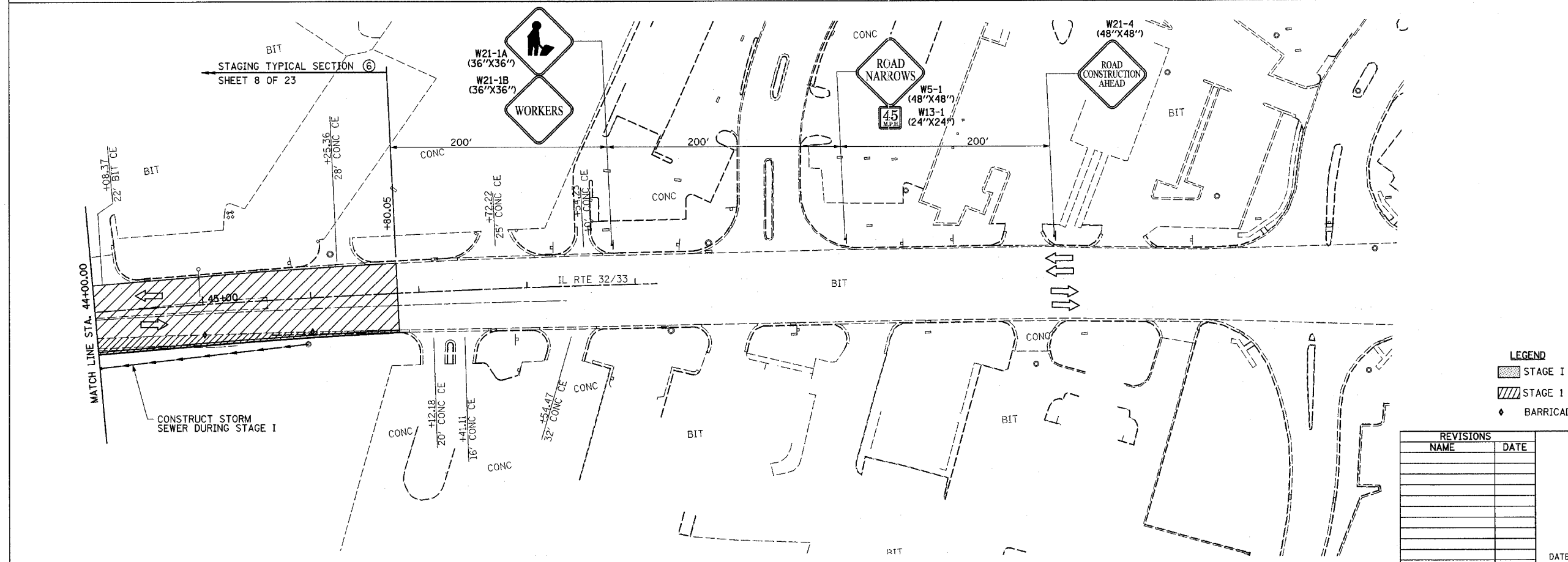

- LEGEND**
- STAGE I REMOVAL
 - STAGE I CONSTRUCTION
 - BARRICADES, TYPE II

REVISIONS	
NAME	DATE

ILLINOIS DEPARTMENT OF TRANSPORTATION

**TRAFFIC CONTROL
 STAGE I CONSTRUCTION
 SHEET 5 OF 23**

DATE 8/02

DRAWN BY ASB
 CHECKED BY RDW