

STATE OF ILLINOIS
DEPARTMENT OF TRANSPORTATION

| | | | | | |
|-----------------------|----------------------------|-----------|--------------|-------|-------------|
| ROUTE NO. | SECTION | COUNTY | TOTAL SHEETS | SHEET | SHEET NO. 2 |
| FAP 774 | 107B-2 | EFFINGHAM | 273 | 257 | 8 SHEETS |
| FED. ROAD DIST. NO. 7 | ILLINOIS FED. AID PROJECT- | | | | |

CONTRACT NO. 94827

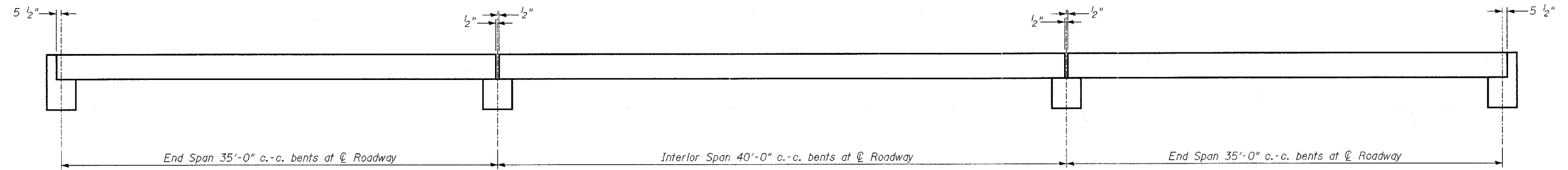

TYPICAL ELEVATION

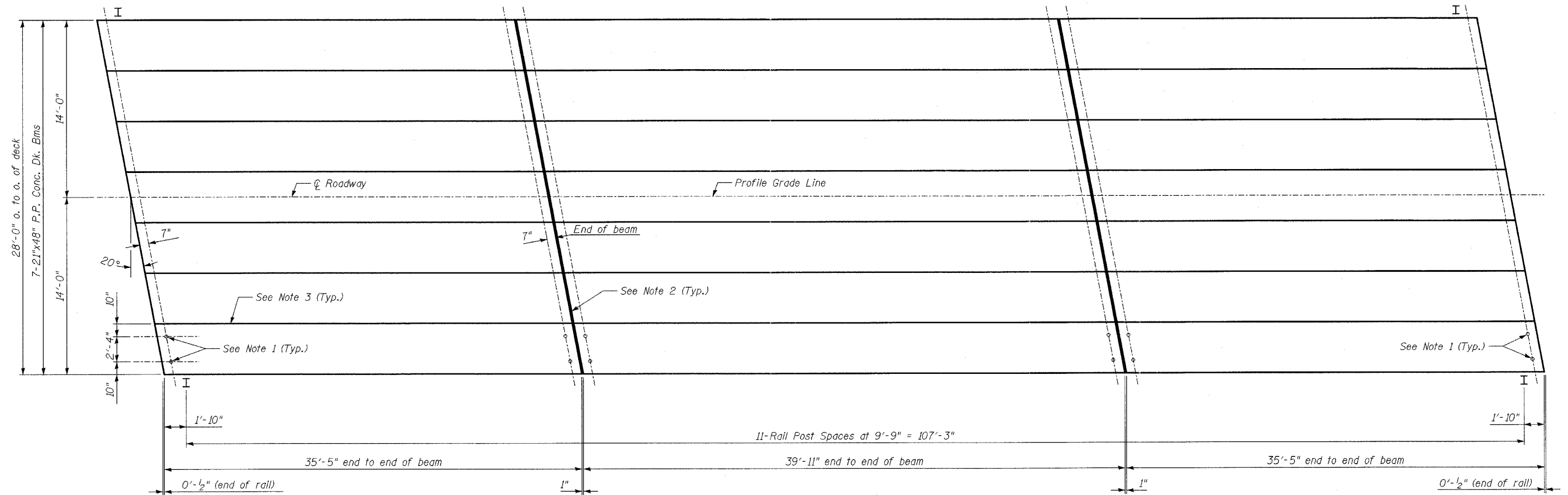

PLAN

NOTES

1. After beams have been erected, holes shall be drilled into substructure and anchor dowels placed. Dowel holes shall be filled with non-shrink grout to top of beam and allowed to cure min. 24 hrs. prior to grouting to shear keys.
2. Nominal 1" joint at Q pier to be filled with P.C. mortar mixture. Non-shrink grout may be used at contractor's option.
3. Longitudinal keys shall be grouted.

| | |
|----------|-----|
| DESIGNED | TMM |
| CHECKED | KCM |
| DRAWN | CAR |
| CHECKED | TMM |

P.P.C. DECK BEAM SUPERSTRUCTURE
1200th STREET OVER GREEN CREEK
FAP RTE. 774, SECTION 107B-2
EFFINGHAM COUNTY
STATION 204+33.91
S.N. 025-3309