

STATE OF ILLINOIS  
DEPARTMENT OF TRANSPORTATION  
DIVISION OF HIGHWAYS

VILLAGE OF CAHOKIA

FAU 9197 (JEROME LANE)  
SEC 02-00040-00-RS  
PROJECT NO. M-5011 (185)  
ST. CLAIR COUNTY

JOB NO. C-98-349-04



#5 BANK SQUARE  
E. ST. LOUIS, IL 62203  
PH: 618.398.0890  
F: 618.398.1339  
HILLSBORO, IL  
MARION, IL  
SPRINGFIELD, IL

CONSULTANTS

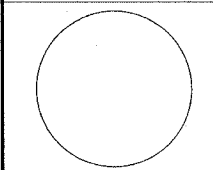

SIGNATURE

DATE

LICENSE EXPIRES

JEROME LANE RESURFACING  
FALLING SPRINGS ROAD  
TO NASH STREET  
VILLAGE OF CAHOKIA  
ST. CLAIR COUNTY, IL.

MARK	DATE	DESCRIPTION
DESIGN:		
S.M.B.	DRAWN:	CHECK:
	S.D.D.	M.R.A.

SHEET TITLE  
COVER SHEET

SHEET NO. 1

SHEET 1 OF 7

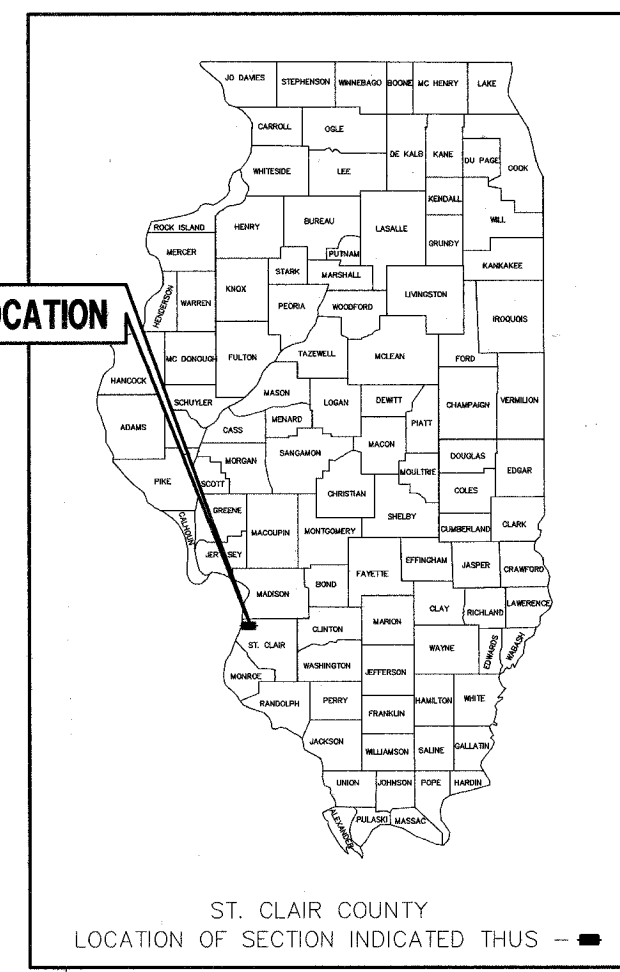

PROJECT LOCATION

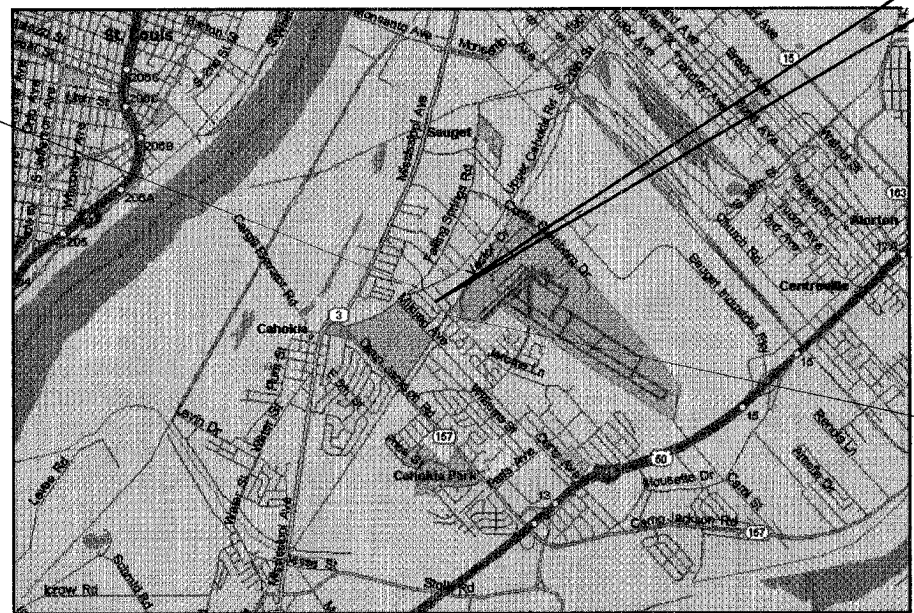

STA. 10+31.94  
BEGIN PROJECT

STA. 26+51.26  
END PROJECT

ST. CLAIR COUNTY  
LOCATION OF SECTION INDICATED THUS --

INDEX OF SHEETS

- 1 COVER SHEET
- 2 TYPICAL SECTION & GENERAL NOTES
- 3 PLAN AND PROFILE
- 4 PLAN AND PROFILE
- 5 PLAN AND PROFILE
- 6 PLAN AND PROFILE
- 7 PAVEMENT MARKING PLAN

LIST OF STANDARDS

- 000001-04 STANDARD SYMBOLS, ABBREVIATIONS AND PATTERNS
- 001006 DECIMAL OF AN INCH AND OF A FOOT
- 442201-01 CLASS C AND D PATCHES
- 702001-05 TRAFFIC CONTROL DEVICES
- 701501-03 URBAN LANE CLOSURE 2L, 2W UNDIVIDED
- 780001-01 TYPICAL PAVEMENT MARKING

MICROFILMED \_\_\_\_\_  
REEL NUMBER \_\_\_\_\_  
AWARDED \_\_\_\_\_  
RESIDENT ENGINEER \_\_\_\_\_

ASBUILT CHANGES WERE MADE  
ON THE FOLLOWING SHEETS:

UTILITY OWNERS

- WATER: COMMONFIELDS OF CAHOKIA  
PUBLIC WORKS DISTRICT  
2525 MOUSETTE LANE  
CAHOKIA, ILLINOIS 62206  
618/332-6620
- GAS: AMEREN-IP COMPANY  
330 NORTH 29TH ST.  
EAST ST. LOUIS, ILLINOIS 62202  
800/755-5000
- ELECTRIC: AMEREN-UE COMPANY  
500 EAST BROADWAY  
EAST ST. LOUIS, ILLINOIS 62203  
618/482-2214
- TELEPHONE: ILLINOIS BELL TELEPHONE COMPANY  
203 GOETHE  
COLLINSVILLE, ILLINOIS 62234  
618/346-6400
- CABLE T.V.: CHARTER COMMUNICATIONS  
508 NIAGRA  
EAST ALTON, ILLINOIS 62024  
618/875-4155

JULIE - (800) 892-0123  
JOINT UTILITY LOCATION INFORMATION  
FOR EXCAVATION  
E. ST. LOUIS TOWNSHIP  
CITY OF E. ST. LOUIS, IL.

LOCATION MAP

NO SCALE  
NET LENGTH OF PROJECT = 1619.32 L.F. = 0.307 MILES

VILLAGE OF CAHOKIA

- MAYOR: FRANK BERGMAN  
CITY CLERK: NORMA JONES  
CITY TREASURER: NICHOLAS PAPPAS
- TRUSTEES:  
KEVIN T. MALONE  
VIRGINIA EDWARDS  
JOHN TORRY  
LEROY DARNELL  
JAMES TRAITEUR  
KENNETH SPISAK III

DESIGN FUNCTIONAL CLASSIFICATION MINOR ARTERIAL TS-3  
DESIGN TRAFFIC 7770 ADT (2025)  
DESIGN SPEED 35 MPH

APPROVED 2-10-2005  
*Frank Bergman*  
FRANK BERGMAN, MAYOR, VILLAGE OF CAHOKIA

PASSED 2-24-05 2005  
*Jennifer Oberlin*  
DISTRICT LOCAL ROADS AND STREETS ENGINEER

APPROVED 2-24-05 2005  
*Mary C. Lamie*  
MARY C. LAMIE, P.E.  
DEPUTY DIRECTOR OF HIGHWAYS  
REGION FIVE ENGINEER

STATE OF ILLINOIS  
DEPARTMENT OF TRANSPORTATION



*Michael R. Arnold*  
MICHAEL R. ARNOLD  
ILLINOIS P.E. NO. 048888  
EXPIRES: 11-30-05  
DATE 2-11-05

### GENERAL NOTES

THIS SECTION SHALL BE CONSTRUCTED IN ACCORDANCE WITH THE PLANS. THE "STANDARD SPECIFICATIONS FOR ROAD AND BRIDGE CONSTRUCTION" ADOPTED JANUARY 1, 2002 AND THE SPECIAL PROVISIONS.

CONTRACTOR TO SAW-CUT ALL EXISTING PAVEMENT A DEPTH OF 1-1/2" IN ALL AREAS WHERE IT ABUTTS PROPOSED PAVEMENT. SAW CUTS SHALL BE INCLUDED IN THE UNIT PRICE FOR BITUMINOUS CONCRETE SURFACE COURSE.

ALL STATIONING REFERS TO THE CENTERLINE OF NEW CONSTRUCTION.

ANY STANDARD NUMBER LISTED SHALL BE INTERPRETED TO MEAN THE COPY OF THE STANDARD INCLUDED IN THE PLANS.

THE LOCATIONS AND/OR DEPTHS OF UNDERGROUND UTILITIES SHOWN HAVE BEEN TAKEN FROM AVAILABLE RECORD INFORMATION FURNISHED BY THE UTILITY OWNERS AND MUST BE CONSIDERED APPROXIMATE. FIELD MARKING OF FACILITIES IN CRITICAL AREAS MAY BE OBTAINED BY PROVIDING A MINIMUM OF 48 HOURS ADVANCE NOTICE TO J.U.L.I.E. @ (800) 892-0123.

AGENCIES KNOWN TO HAVE UNDERGROUND FACILITIES WITHIN THE LIMITS OF THIS IMPROVEMENT ARE LISTED ON SHEET 1 OF THESE PLANS.

THE FOLLOWING CONSTANTS WERE USED IN THE CALCULATIONS OF QUANTITIES FOR THIS PROJECT:

- BITUMINOUS CONCRETE SURFACE COURSE, SUPERPAVE, MIX D, N70 (1-1/2") -- 112 LBS./SQ. YD./INCH THICKNESS
- BITUMINOUS MATERIALS (PRIME COAT) -- 0.10 GAL./SQ. YD.
- AGGREGATE (PRIME COAT) -- 5 LBS./SQ. YD.

DISPOSAL OF ALL MATERIAL FROM DEMOLITION (PAVEMENT REMOVAL, ETC.) SHALL BE INCIDENTAL TO THE CONTRACT AND IN ACCORDANCE WITH ALL STATE AND LOCAL CODES.



#5 BANK SQUARE  
E. ST. LOUIS, IL 62203  
PH: 618.398.0890  
F: 618.398.1339  
  
HILLSBORO, IL  
MARION, IL  
SPRINGFIELD, IL

CONSULTANTS

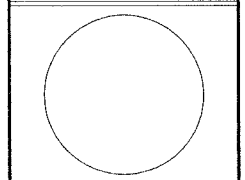

SIGNATURE \_\_\_\_\_  
DATE \_\_\_\_\_  
LICENSE EXPIRES \_\_\_\_\_

JEROME LANE RESURFACING  
 FALLING SPRINGS ROAD  
 TO NASH STREET  
 VILLAGE OF CAHOKIA  
 ST. CLAIR COUNTY, IL.

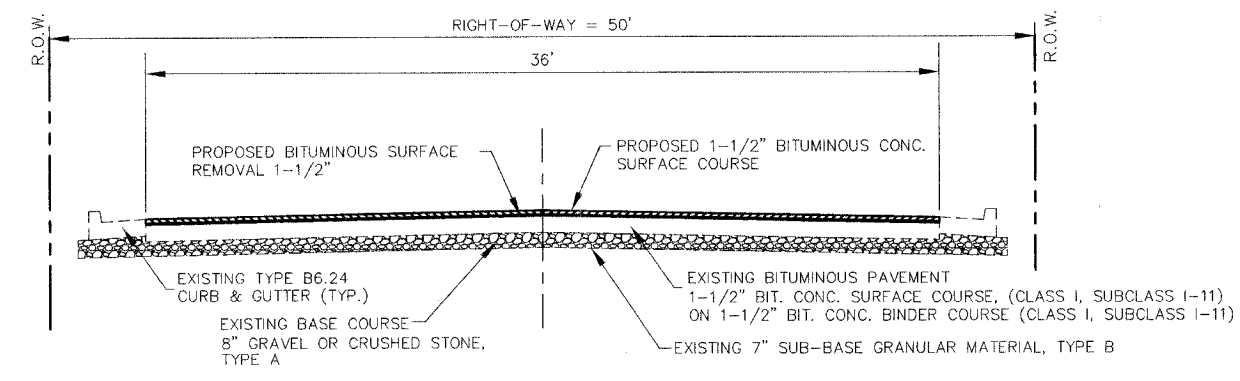

**TYPICAL SECTION—STA. 13+15.55 TO STA. 26+51.26**

NO SCALE

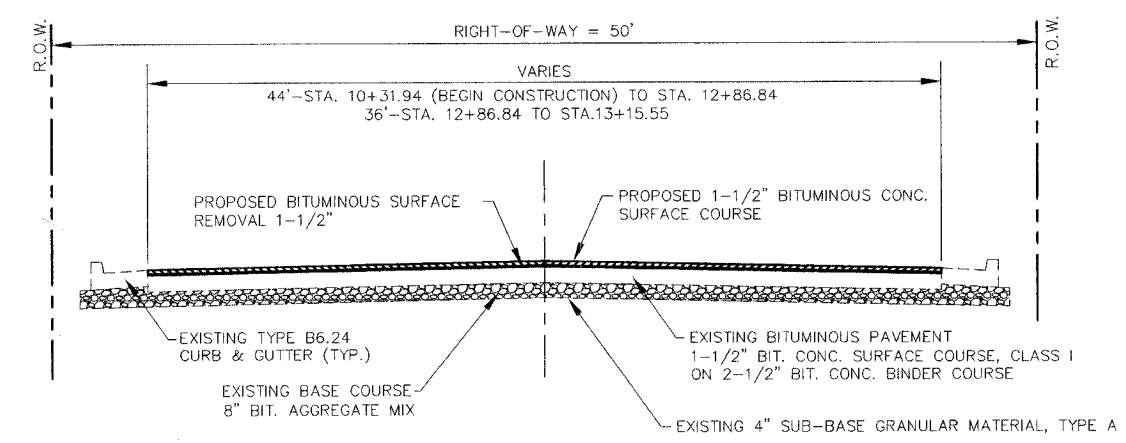

**TYPICAL SECTION—STA. 10+31.94 TO STA. 13+15.55**

NO SCALE

MIXTURE REQUIREMENTS — SUPERPAVE PROJECT

ROUTE	JEROME LANE
SECTION	02-00040-00-RS
COUNTY	ST. CLAIR
CONTRACT	97246

DESCRIPTION: JEROME LANE FROM FALLING SPRINGS ROAD TO NASH STREET  
20 YR. ESAL'S: 1.65

MIXTURE USE	SURFACE
AC/PG	PG 64-22
RAP % (MAX.)	10%
DESIGN AIR VOIDS	4.0% @ Ndes=70
MIX COMPOSITION (GRADATION MIXTURE)	
FRICTION AGG	MIXTURE D

### SUMMARY OF QUANTITIES

CODE NO.	ITEM	UNIT	TOTAL
44000006	BITUMINOUS SURFACE REMOVAL, 1-1/2"	SQ. YD.	8146
X4066426	BITUMINOUS CONCRETE SURFACE COURSE, SUPERPAVE, MIX D, N70 (1-1/2")	TON	684
40600100	BITUMINOUS MATERIAL (PRIME COAT)	GAL	815
40800300	AGGREGATE (PRIME COAT)	TON	21
44201859	CLASS D PATCHES, TYPE I, 18"	SQ. YD.	4.6
44201863	CLASS D PATCHES, TYPE II, 18"	SQ. YD.	41.2
44201867	CLASS D PATCHES, TYPE III, 18"	SQ. YD.	34.5
72000100	SIGN PANEL, TYPE I	SQ. FT.	6.25
78000200	THERMOPLASTIC PAVEMENT MARKING LINE, 4"	FT.	660
78000400	THERMOPLASTIC PAVEMENT MARKING LINE, 6"	FT.	315
78000600	THERMOPLASTIC PAVEMENT MARKING LINE, 12"	FT.	150
78000850	THERMOPLASTIC PAVEMENT MARKING LINE, 24"	FT.	54
78000100	THERMOPLASTIC PAVEMENT MARKING LETTERS AND SYMBOLS	SQ. FT.	61.2
70101700	TRAFFIC CONTROL AND PROTECTION	L. SUM	1
Z0048665	RAILROAD PROTECTIVE LIABILITY INSURANCE	L. SUM	1

MARK	DATE	DESCRIPTION
DESIGN:	S.M.B.	S.D.D.
DRAWN:	S.D.D.	CHECK:
		M.R.A.

SHEET TITLE  
**TYPICAL SECTION & GENERAL NOTES**

CONSULTANTS



SIGNATURE \_\_\_\_\_  
DATE \_\_\_\_\_  
LICENSE EXPIRES \_\_\_\_\_

JEROME LANE RESURFACING  
FALLING SPRINGS ROAD  
TO NASH STREET  
VILLAGE OF CAHOKIA  
ST. CLAIR COUNTY, ILLINOIS

MARK	DATE	DESCRIPTION
PROJECT NO:	210-2334	
DESIGN:	S.M.B.	DRAWN: S.D.D. CHECK: M.R.A.

SHEET TITLE  
**PLAN AND PROFILE**

SHEET NO. **3**  
SHEET 3 OF 7

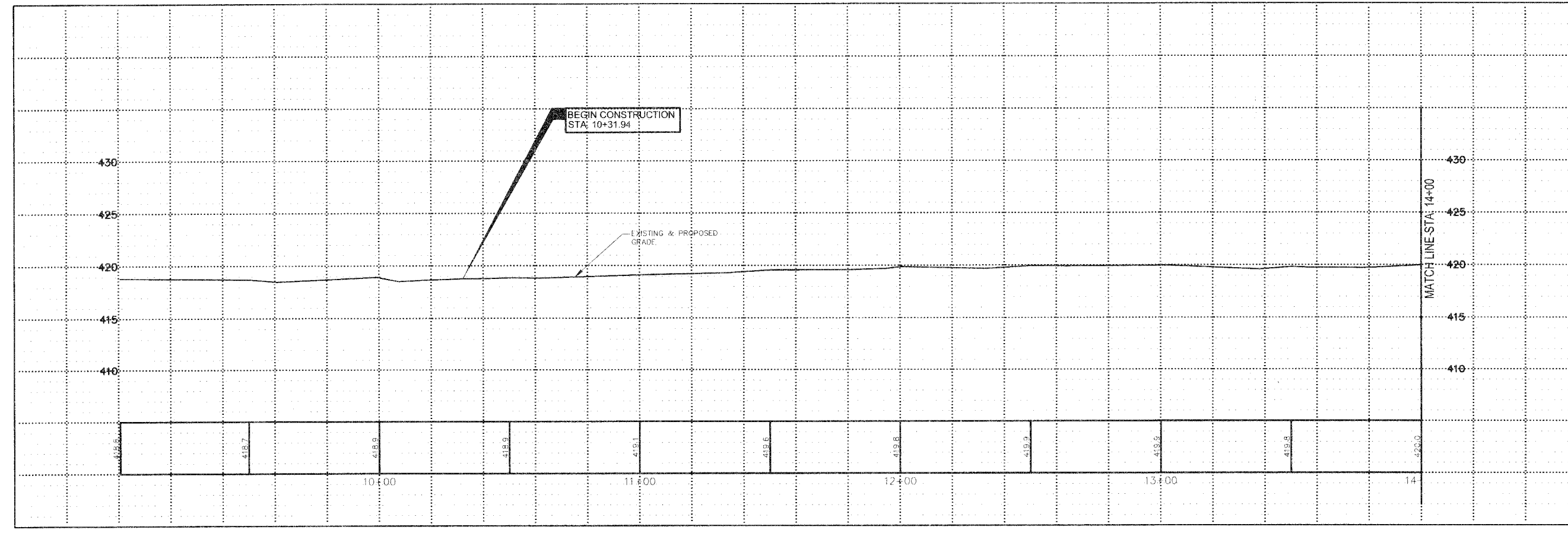
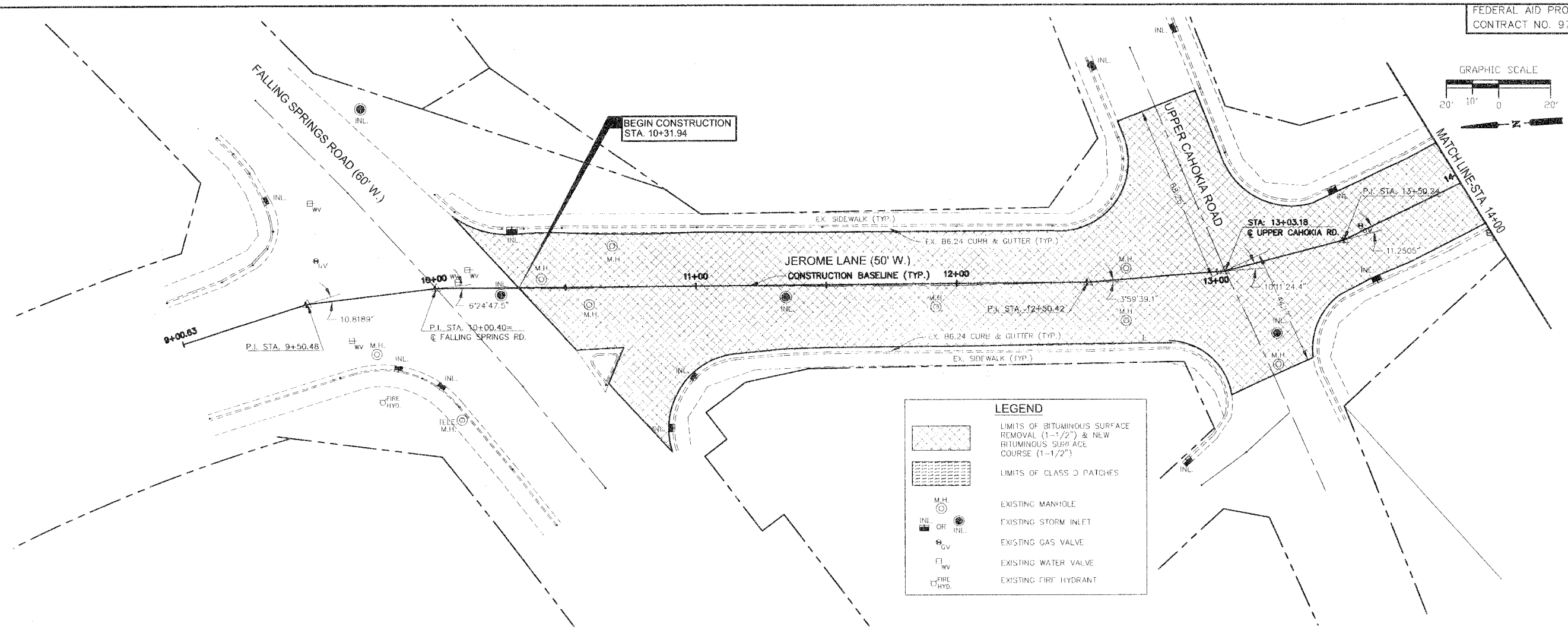

CONSULTANTS

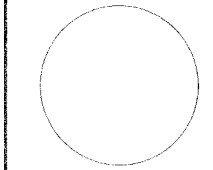

SIGNATURE

DATE

LICENSE EXPIRES

JEROME LANE RESURFACING  
FALLING SPRINGS ROAD  
TO NASH STREET  
VILLAGE OF CAHOKIA  
ST. CLAIR COUNTY, ILLINOIS

MARK	DATE	DESCRIPTION
PROJECT NO.	210-2334	
DESIGN:	DRAWN:	CHECK:
S.M.B.	S.D.D.	M.R.A.

SHEET TITLE  
**PLAN AND PROFILE**

SHEET NO.  
**4**  
SHEET 4 OF 7

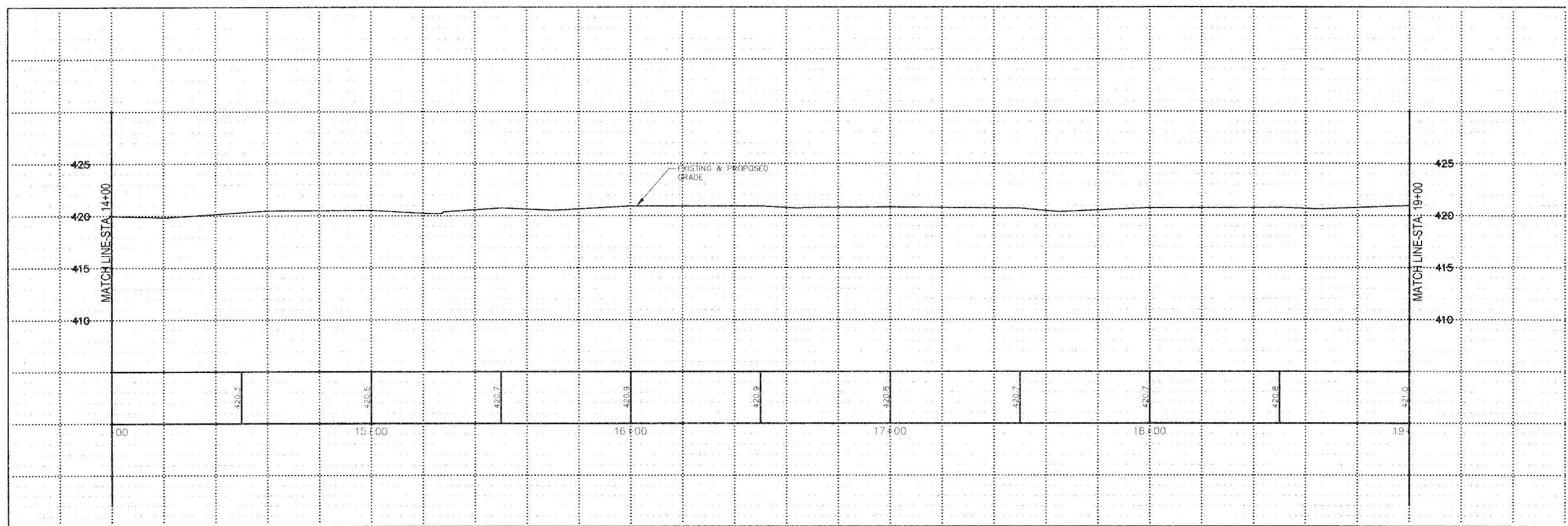
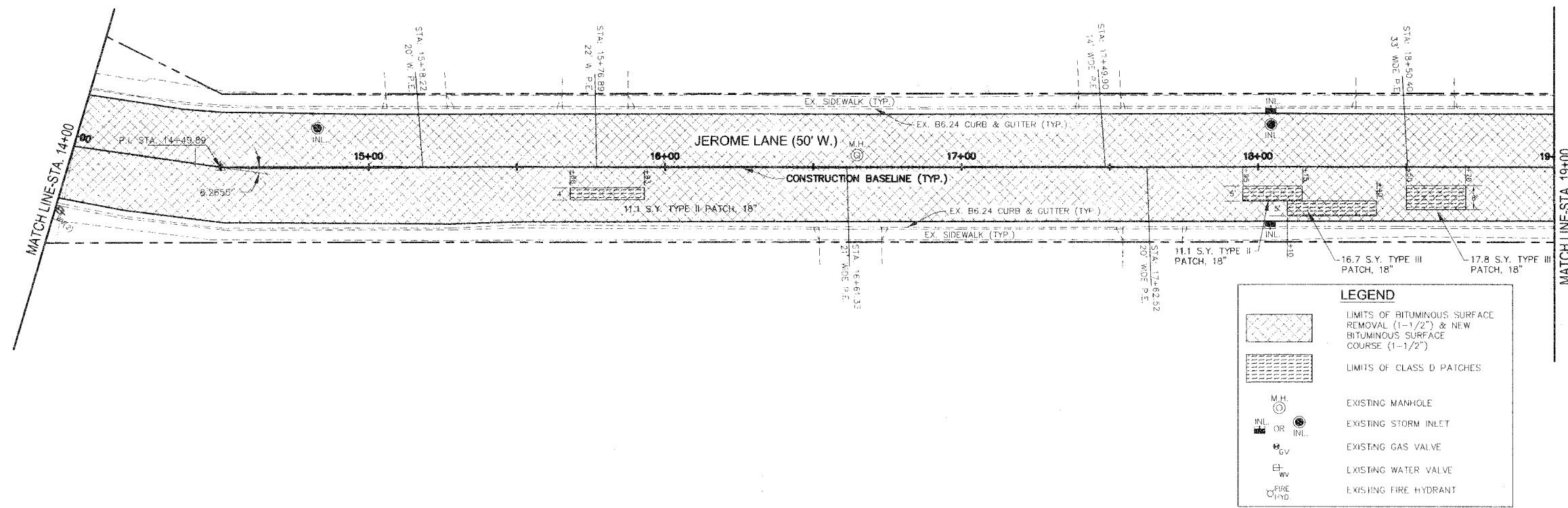
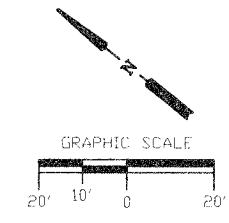

CONSULTANTS

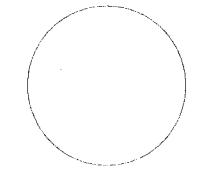

SIGNATURE

DATE

LICENSE EXPIRES

JEROME LANE RESURFACING  
FALLING SPRINGS ROAD  
TO NASH STREET  
VILLAGE OF CAHOKIA  
ST. CLAIR COUNTY, ILLINOIS

MARK	DATE	DESCRIPTION
PROJECT NO:	210-2334	
DESIGN:		
S.M.B.	S.D.D.	CHECK: M.R.A.

SHEET TITLE

PLAN AND  
PROFILE

SHEET NO.

5

SHEET 5 OF 7

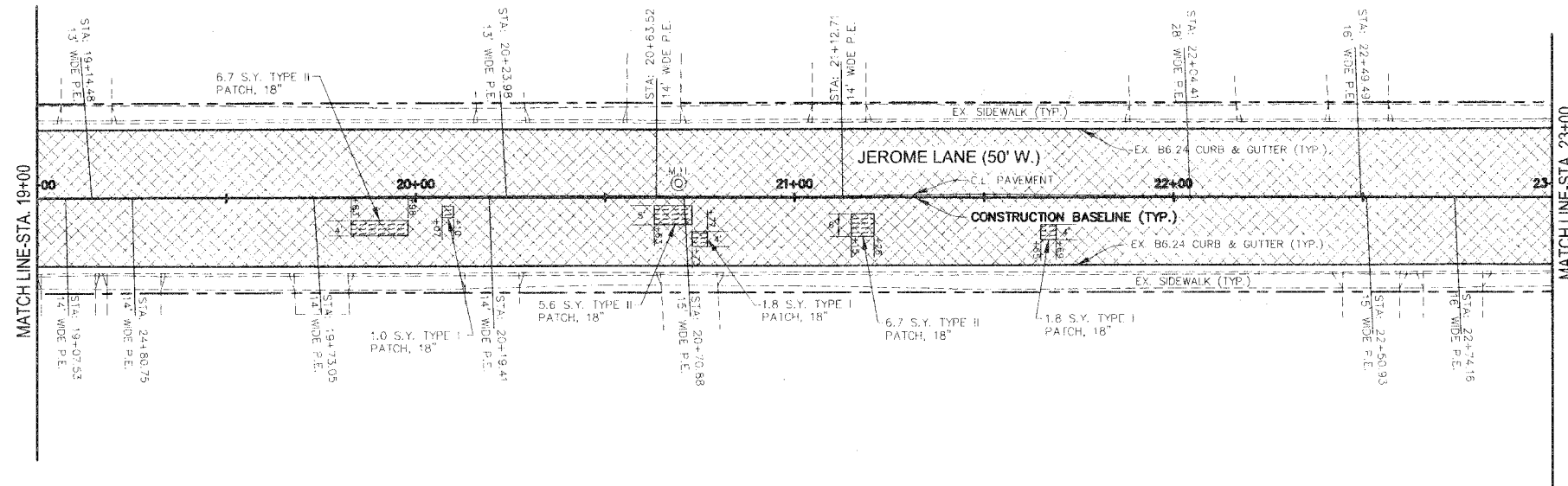
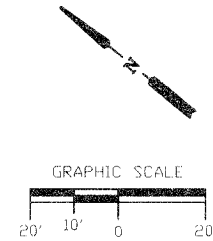

**LEGEND**

	LIMITS OF BITUMINOUS SURFACE REMOVAL (1-1/2") & NEW BITUMINOUS SURFACE COURSE (1-1/2")
	LIMITS OF CLASS D PATCHES
	EXISTING MANHOLE
	EXISTING STORM INLET
	EXISTING GAS VALVE
	EXISTING WATER VALVE
	EXISTING FIRE HYDRANT

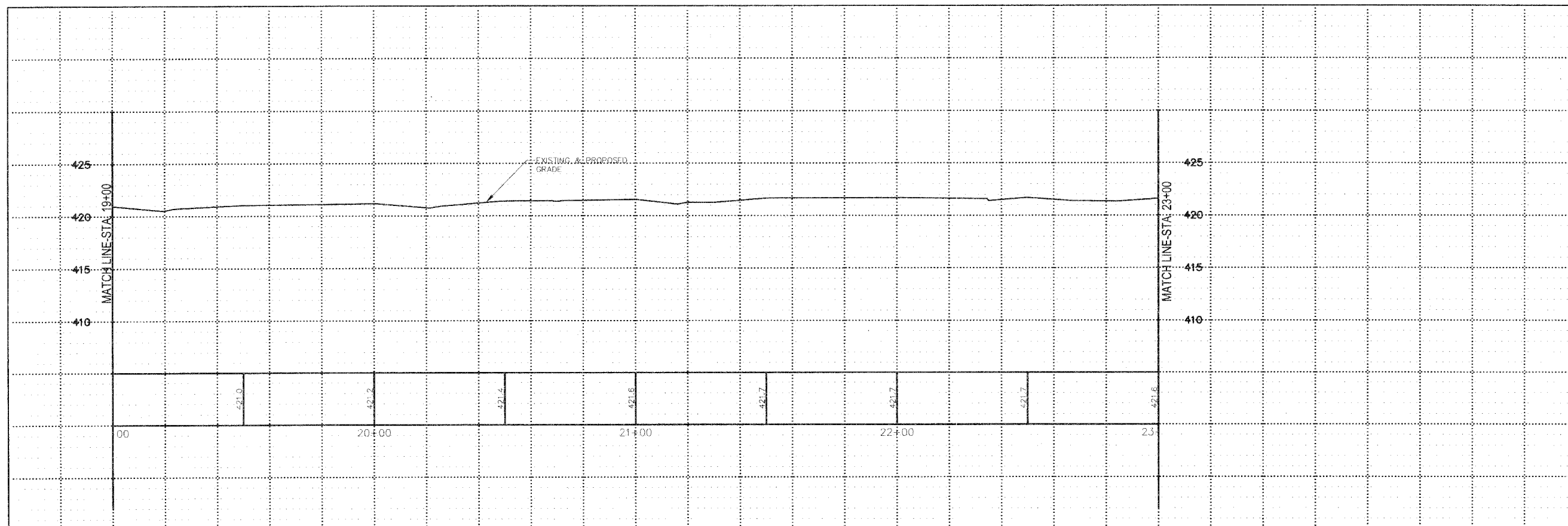

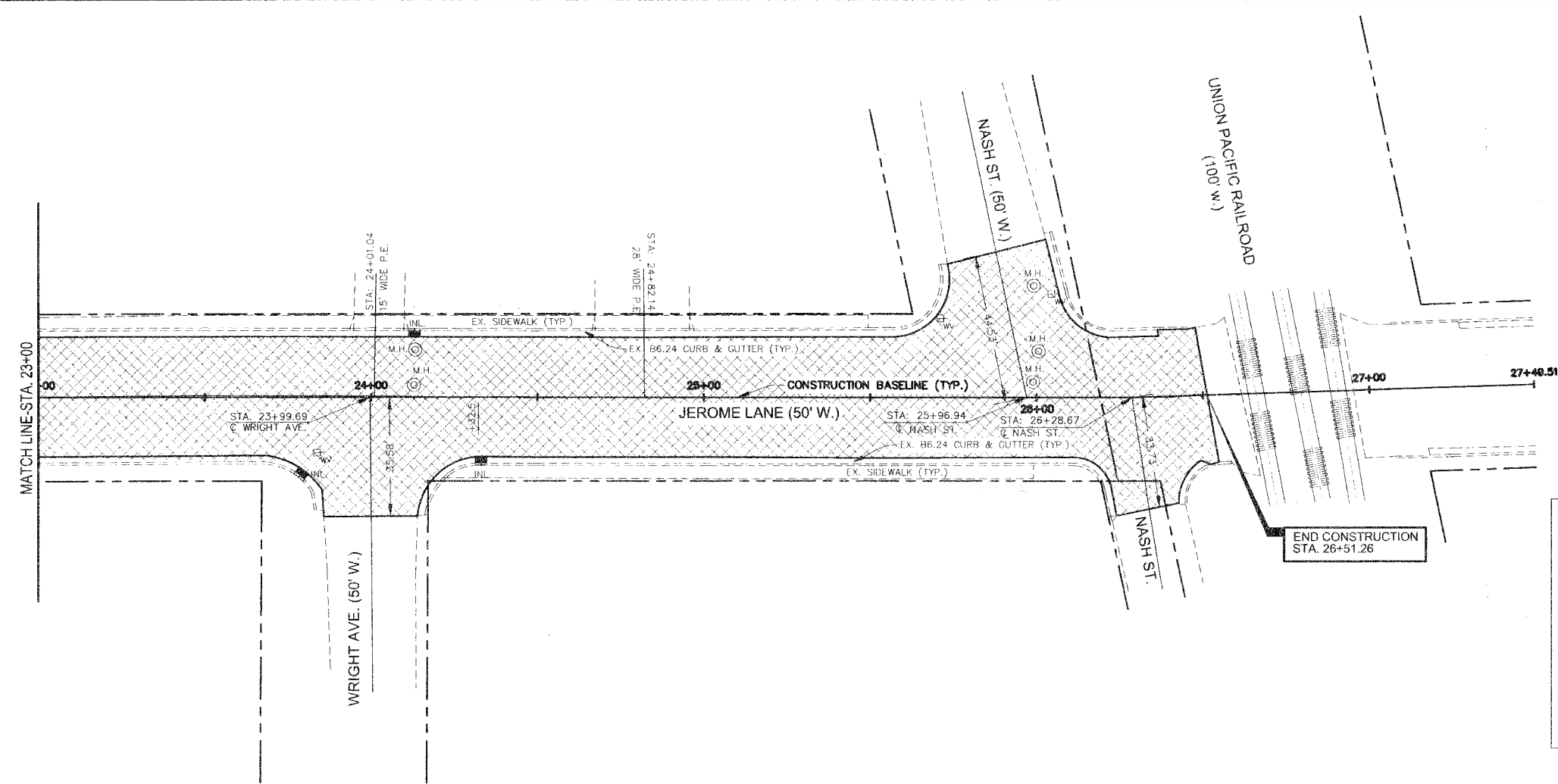
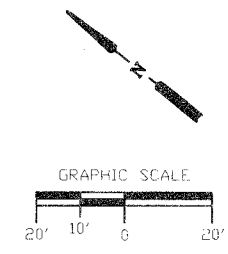

**LEGEND**

- LIMITS OF BITUMINOUS SURFACE REMOVAL (1-1/2") & NEW BITUMINOUS SURFACE COURSE (1-1/2")
- LIMITS OF CLASS D PATCHES
- EXISTING MANHOLE
- EXISTING STORM INLET
- EXISTING GAS VALVE
- EXISTING WATER VALVE
- EXISTING FIRE HYDRANT

CONSULTANTS

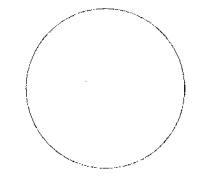

SIGNATURE \_\_\_\_\_  
DATE \_\_\_\_\_  
LICENSE EXPIRES \_\_\_\_\_

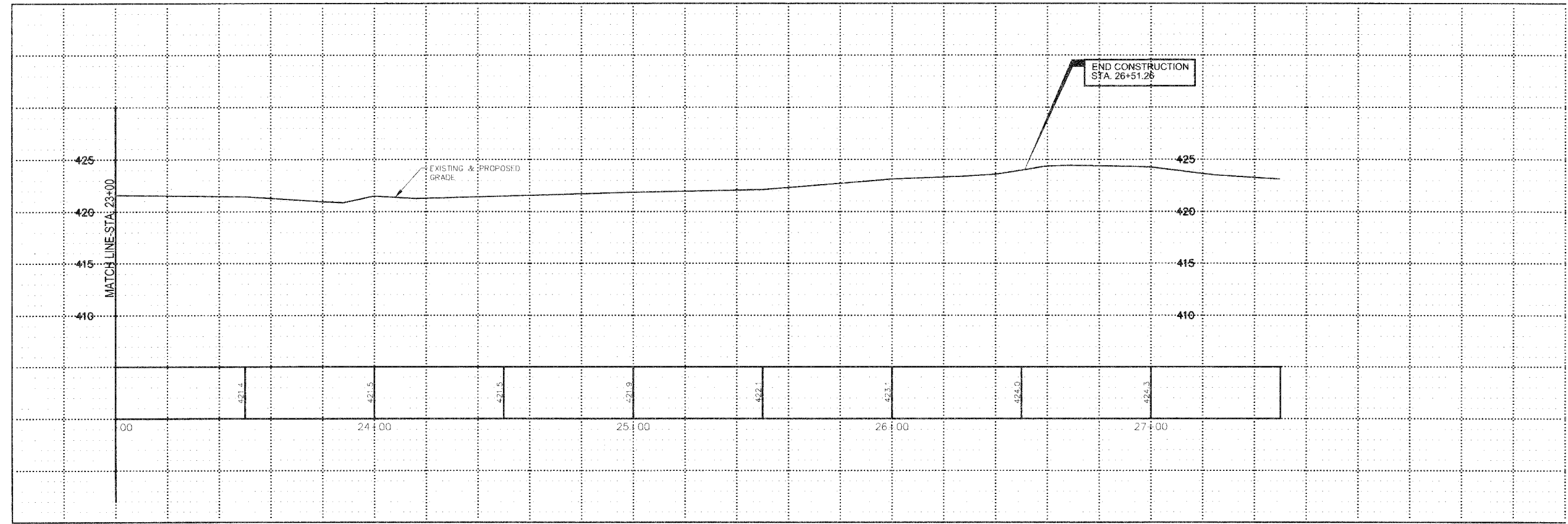

JEROME LANE RESURFACING  
FALLING SPRINGS ROAD  
TO NASH STREET  
VILLAGE OF CAHOKIA  
ST. CLAIR COUNTY, ILLINOIS

MARK	DATE	DESCRIPTION
PROJECT NO.	210-2334	
DESIGN:	S.M.B.	DRAWN: S.D.D. CHECK: M.R.A.

SHEET TITLE  
**PLAN AND PROFILE**



CONSULTANTS

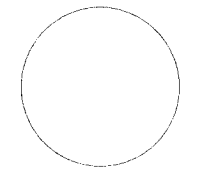

SIGNATURE

DATE

LICENSE EXPIRES

JEROME LANE RESURFACING  
FALLING SPRINGS ROAD  
TO NASH STREET  
VILLAGE OF CAHOKIA  
ST. CLAIR COUNTY, IL.

MARK	DATE	DESCRIPTION
PROJECT NO:	210-2334	
DESIGN:	S.M.B.	S.D.D.
DRAWN:	S.D.D.	M.R.A.
CHECK:		

SHEET TITLE  
**PAVEMENT MARKING PLAN**

SHEET NO. **7**  
SHEET 7 OF 7

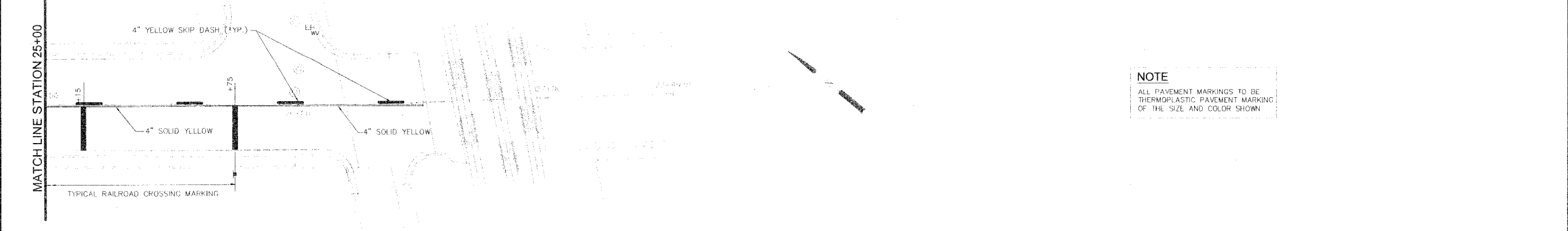
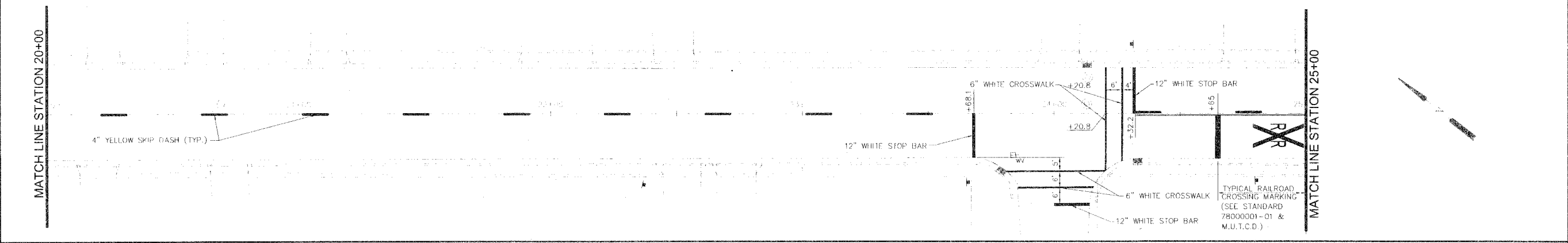
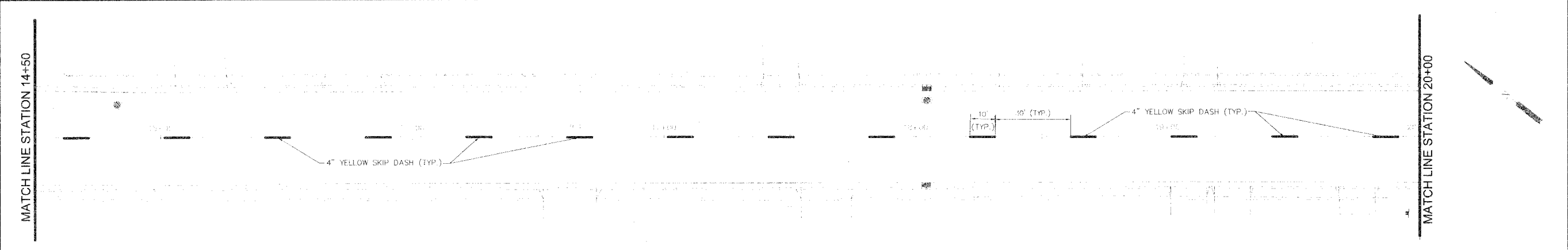
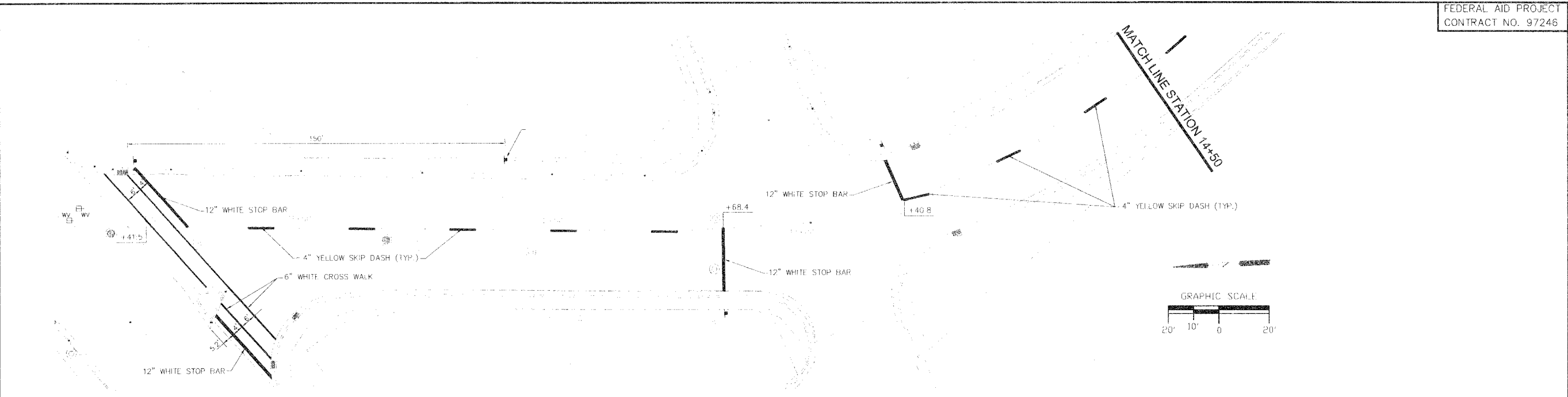

**NOTE**  
ALL PAVEMENT MARKINGS TO BE THERMOPLASTIC PAVEMENT MARKING OF THE SIZE AND COLOR SHOWN