

STATE OF ILLINOIS
 DEPARTMENT OF TRANSPORTATION

DATE	BY	CHKD	APP'D
10/24/05	MB	MB	MB
SHEET NO. 20 30 SHEETS			

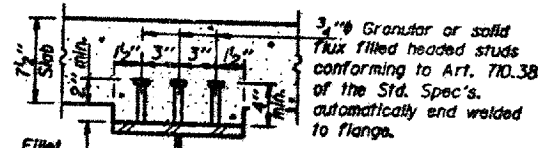
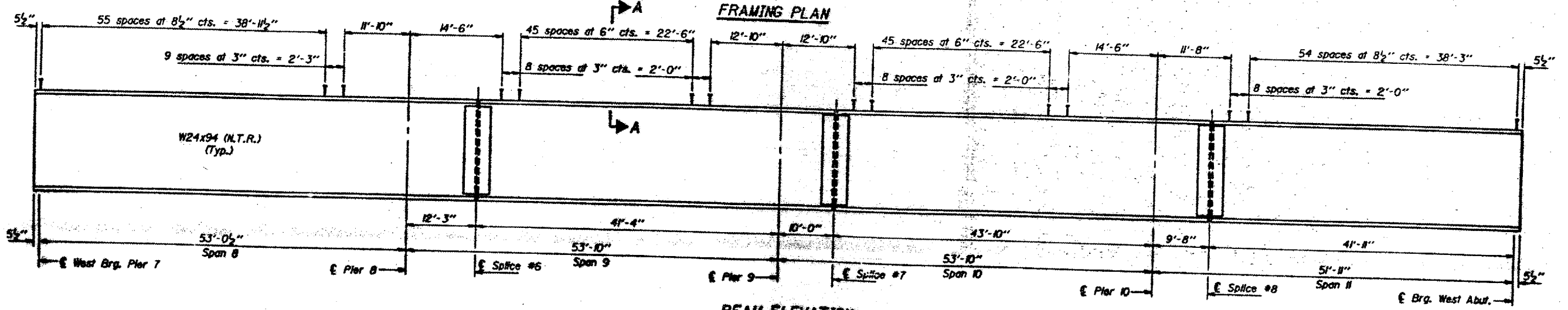
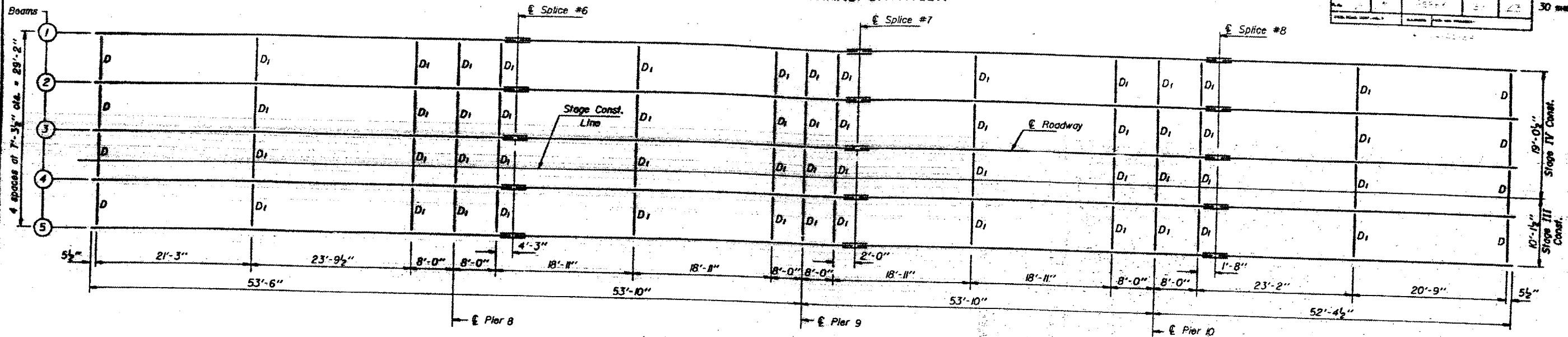

Notes: N.T.R. denotes the members subject to "Notch Toughness Requirements."
 See sheet #17 for the diaphragm and splice details.
 The end diaphragms D between Beams 3 and 4 shall be connected during Stage IV Construction.
 Number of shear studs required for Spans 8 thru 11 = 3780.

DESIGNED	K. R. Ghanta	DATE	10/24/05
CHECKED	Domina Balon	APPROVED	MB
DRAWN	Mercado	APPROVED	MB
CHECKED	MB		

FOR INFORMATION ONLY:
 BRIDGE NO. 3 STRUCTURE 073-0023
 STRUCTURAL STEEL - SPANS 8 THRU 11
 F.A. RTE. 865 SEC. 104BC-BR
 PERRY COUNTY
 STA. 904+29.00