

FEB 15, 2005 11:48 AM DPE  
 I:\AIRPORTS\STLOUIS\837-04RFD\AIRPORT\SHEETS\R-302XS.DWG - STA. 1+75 TO STA. 2+25

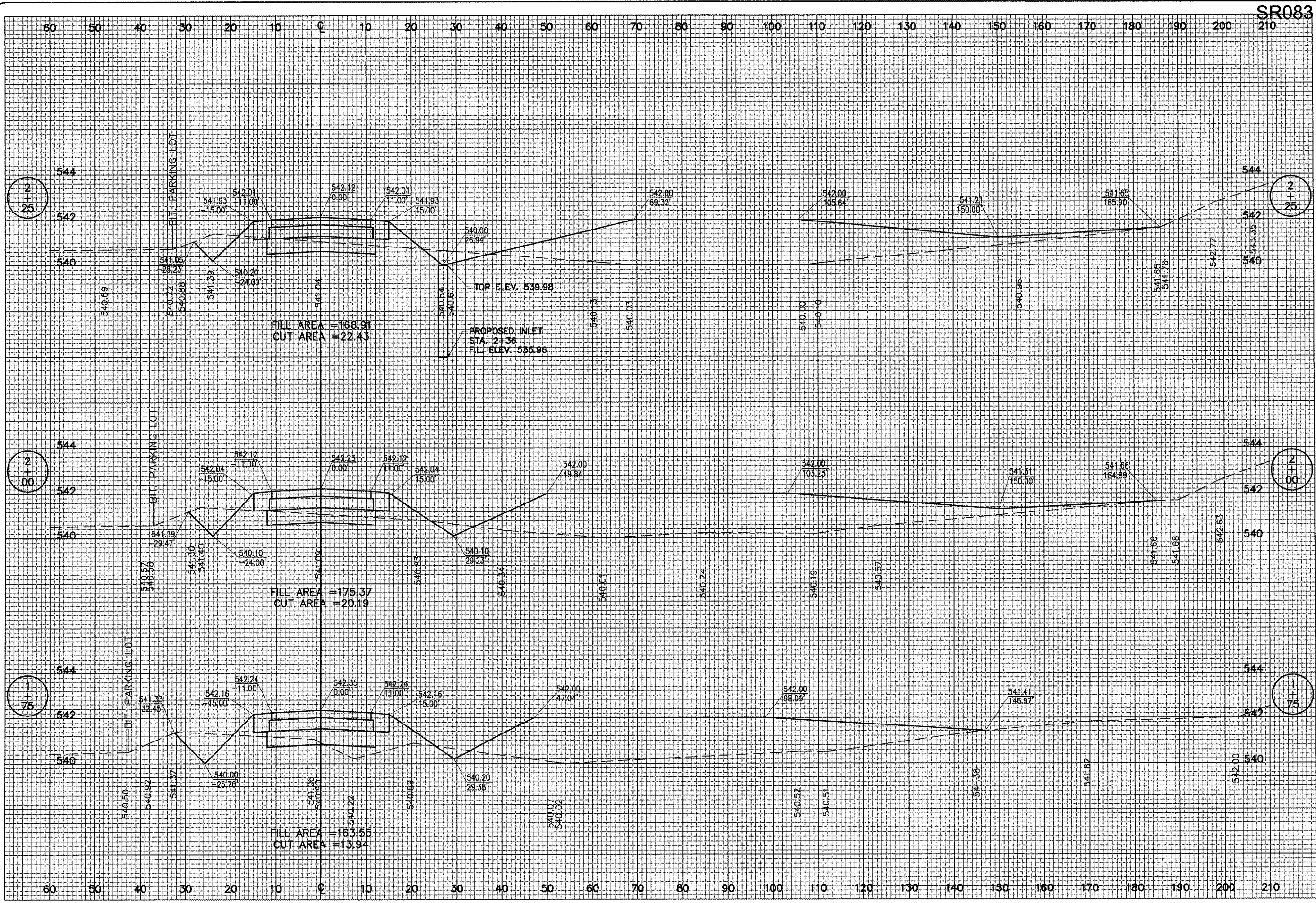

SR083

DATE	REVISION	BY

ST. LOUIS REGIONAL AIRPORT  
 EAST ALTON, ILLINOIS  
 IL. PROJ.: ALN-3355

HEI Project No. 837-04RDD	DATE	6/23/04
Drawings R-302XS.DWG	TITLE	LAYOUT
Scale 1"=10'H, 1"=2'Y	DRAWN	TLW
DATE	REVIEWED	WJM



CONSTRUCT T-HANGER ACCESS ROAD  
 PROPOSED CROSS-SECTIONS STA. 1+75 TO STA. 2+25